

EFFECTIVE DATE: 10-24-90

FORM MUST BE TYPED

State of Kansas

FORM MUST BE SIGNED

FORM C-1 4/90

NOTICE OF INTENTION TO DRILL

ALL BLANKS MUST BE FILLED

Must be approved by the K.C.C. five (5) days prior to commencing well

Expected Spud Date November 1, 1990 month day year

C W/2 SW NE Sec 28 Twp 9 S, Rg 20 East West

OPERATOR: License # 7973 Name: AL-LA-LYN OIL, INC. Address: 614 W. 10th City/State/Zip: Ellis, Kansas 67637 Contact Person: Richard Romine Phone: 913-737-4260

3300 feet from South line of Section 2310 feet from East line of Section (Note: Locate well on Section Plat on Reverse Side)

CONTRACTOR: License #: 5302 Name: RED TIGER DRILLING

County: Rooks Lease Name: Jackson Well #: 1 Field Name: Unknown Is this a Prorated Field? yes X no Target Formation(s): Arbuckle Nearest lease or unit boundary: 330 Ground Surface Elevation: N/A Domestic well within 330 feet: yes X no Municipal well within one mile: yes X no Depth to bottom of fresh water: 75 Depth to bottom of usable water: 1100 Surface Pipe by Alternate: 1 X 2 Length of Surface Pipe Planned to be set: 200 Length of Conductor pipe required: N/A Projected Total Depth: 3800 Formation at Total Depth: Arbuckle Water Source for Drilling Operations: well X farm pond other DWR Permit #: N/A Will Cores Be Taken?: yes X no If yes, proposed zone:

Well Drilled For: Well Class: Type Equipment:

X Oil Inj Infield X Mud Rotary Gas Storage Pool Ext. Air Rotary OWWO Disposal X Wildcat Cable Seismic; # of Holes

If OWWO: old well information as follows:

Operator: Well Name: Comp. Date: Old Total Depth

Directional, Deviated or Horizontal wellbore? yes X no

If yes, total depth location:

AFFIDAVIT

The undersigned hereby affirms that the drilling, completion and eventual plugging of this well will comply with K.S.A. 55-101, et. seq.

It is agreed that the following minimum requirements will be met:

- 1. The appropriate district office shall be notified before setting surface pipe;
2. The minimum amount of surface pipe as specified above shall be set by circulating cement to the top; in all cases surface pipe shall be set through all unconsolidated materials plus a minimum of 20 feet into the underlying formation;
3. If the well is dry, a plugging proposal shall be submitted to the district office. An agreement between the operator and the district office on plug length and placement is necessary prior to plugging;
4. The appropriate district office will be notified before well is either plugged or production casing is cemented in;
5. If an Alternate II completion, production pipe shall be cemented from below any usable water to surface within 120 days of spud date. In all cases, notify district office prior to any cementing.

I hereby certify that the statements made herein are true and to the best of my knowledge and belief.

Date: 10-18-90 Signature of Operator or Agent: Dan Brennan Title: Rig Coordinator BY: RED TIGER DRILLING COMPANY

FOR KCC USE: API # 15- 163-23125-00-00 Conductor pipe required None feet Minimum surface pipe required 200 feet per Alt. (2) Approved by: mla 10-19-90 EFFECTIVE DATE: 10-24-90 This authorization expires: 4-19-91 (This authorization void if drilling not started within 6 months of effective date.) Spud date: Agent:

RECEIVED STATE CORPORATION COMMISSION OCT 19 1990 CONSERVATION DIVISION Wichita, Kansas

REMEMBER TO:

- File Drill Pit Application (form CDP-1) with Intent to Drill;
- File Completion Form ACO-1 within 120 days of spud date;
- File acreage attribution plat according to field proration orders;
- Notify appropriate district office 48 hours prior to workover or re-entry;
- Submit plugging report (CP-4) after plugging is completed;
- Obtain written approval before disposing or injecting salt water.

**PLAT OF ACREAGE ATTRIBUTABLE TO A WELL**

State Corporation Commission, Conservation Division  
200 Colorado Derby Bldg. Wichita, Kansas 67202

OPERATOR <u>AL-LA-LYN OIL, INC.</u>	LOCATION OF WELL:
LEASE _____	<u>3300</u> feet north of SE corner
WELL NUMBER <u>1</u>	<u>2310</u> feet west of SE corner
FIELD <u>Unknown</u>	Sec. <u>28</u> T <u>9</u> R <u>20W</u> E <u>W</u>
	COUNTY _____ Rooks
NO. OF ACRES ATTRIBUTABLE TO WELL <u>80</u>	IS SECTION <u>x</u> REGULAR _____ IRREGULAR?
DESCRIPTION OF ACREAGE <u>W/2 SW NE</u>	IF IRREGULAR, LOCATE WELL FROM NEAREST CORNER BOUNDARY.

**NOTE:** If plat depicted is insufficient for your circumstances, you may attach your own scaled or surveyed plat.

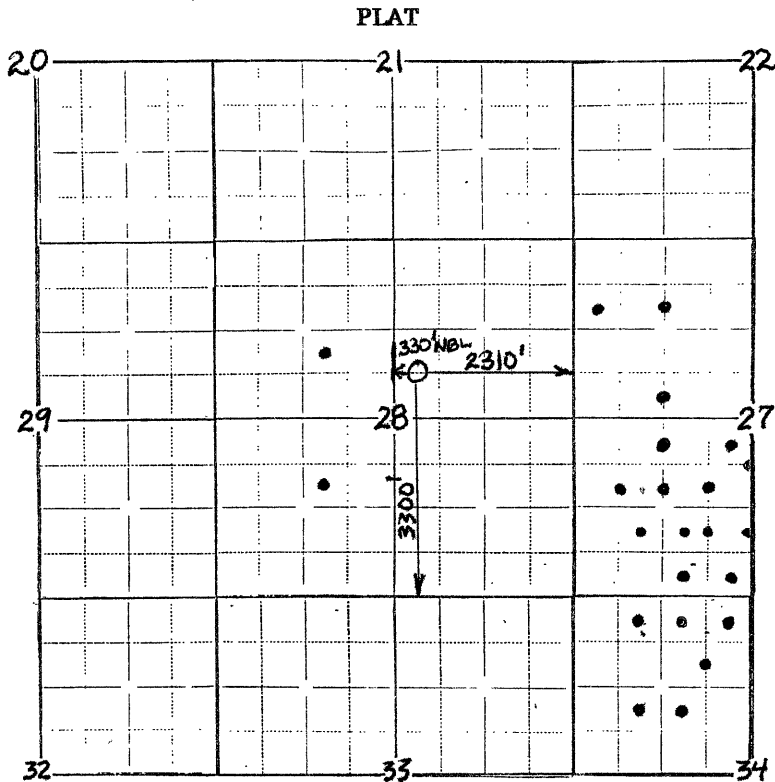

In plotting the proposed location of the well, you must show:

- 1) The manner in which you are using the depicted plat by identifying section lines, i.e. 1 section, 1 section with 8 surrounding partial sections, 4 sections, 16 sections, etc.;
- 2) the well's location relative to the location of other wells producing from the same common source of supply in adjoining drilling units, pursuant to K.A.R. 82-3-108, 82-3-207, 82-3-312, or special orders of the Commission;
- 3) the distance of the proposed drilling location from the section's east and south lines; and
- 4) the distance to the nearest lease or unit boundary line.

I hereby certify that the statements made herein are true and to the best of my knowledge and belief.

Signature of Operator or Agent *D'Ann Duennan*  
 Date 10-18-90 Title Rig Coordinator  
 BY: RED TIGER DRILLING COMPANY