

STATE CORPORATION COMMISSION OF KANSAS
OIL & GAS CONSERVATION DIVISION

WELL COMPLETION OR RECOMPLETION FORM
ACO-1 WELL HISTORY

DESCRIPTION OF WELL AND LEASE

Operator: license # 4742
name Texaco Inc. for Texaco Producing Inc.
address P.O. Box 2420
City/State/Zip Tulsa, OK 74102

Operator Contact Person D.L. Richter
Phone (918) 560-7331

Contractor: license # N/A
name

Wellsite Geologist N/A
Phone

PURCHASER Mobil Pipe Line Co.

Designate Type of Completion
 New Well Re-Entry Workover

Oil SWD Temp Abd
 Gas Inj Delayed Comp.
 Dry Other (Core, Water Supply etc.)

Old well info as follows:
Operator Texaco Inc. for Texaco Producing Inc.
Well Name John Towns #6
Comp. Date 10-31-86 Old Total Depth 3,794'
8-4-66

WELL HISTORY

Drilling Method: Mud Rotary Air Rotary Cable
7-28-66 (original well) 8-4-66 (original well) 8-16-86 10/31/86
Spud Date Date Reached TD Re-Completion Date
3,794' 3,752'
Total Depth PBDT

Amount of Surface Pipe Set and Cemented at 8-5/8" @ 293' feet

Multiple Stage Cementing Collar Used? Yes No

If Yes, Show Depth Set feet

If alternate 2 completion, cement circulated
from 0' feet depth to 293' w/ 150 SX cmt

API NO. 15 -
County Rooks
SE SW SE Sec 18 Twp 9S Rge 20 East West

Completed before 8-16-66

330 Ft North from Southeast Corner of Section
1650 Ft West from Southeast Corner of Section
(Note: locate well in section plat below)

Lease Name John Towns Well# 6

Field Name GRA-Rook

Producing Formation LKC-Plattsmouth

Elevation: Ground KB 2.260'

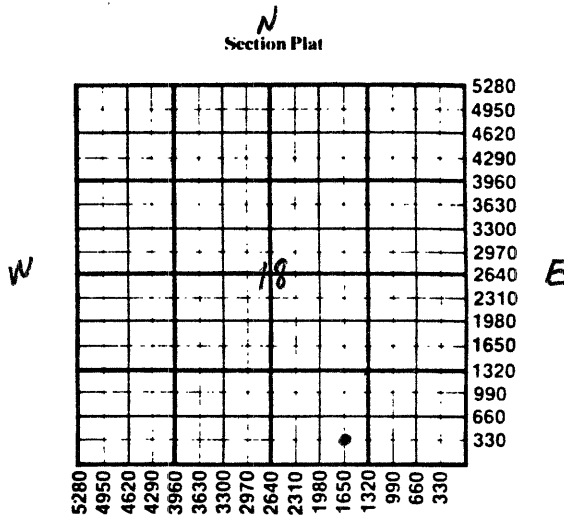

WATER SUPPLY INFORMATION

Source of Water: N/A

Division of Water Resources Permit #

Groundwater Ft North From Southeast Corner and (Well) Ft. West From Southeast Corner of Sec Twp Rge East West

Surface Water Ft North From Southeast Corner and (Stream, Pond etc.) Ft West From Southeast Corner Sec Twp Rge East West

Other (explain) (purchased from city, R.W.D.#)

Disposition of Produced Water: Disposal Repressuring

Docket #

INSTRUCTIONS: This form shall be completed in duplicate and filed with the Kansas Corporation Commission, 200 Colorado Derby Building, Wichita, Kansas 67202, within 90 days after completion or recompletion of any well. Rules 82-3-130 and 82-3-107 apply.

Information on side two of this form will be held confidential for a period of 12 months if requested in writing and submitted with the form. See rule 82-3-107 for confidentiality in excess of 12 months.

One copy of all wireline logs and drillers time log shall be attached with this form. Submit CP-4 form with all plugged wells. Submit CP-111 form with all temporarily abandoned wells.

All requirements of the statutes, rules, and regulations promulgated to regulate the oil and gas industry have been fully complied with and the statements herein are complete and correct to the best of my knowledge.

Signature M.E. Mills, Jr. 11-18-86
Title Acting Asst. District Manager Date 11-17-86

Subscribed and sworn to before me this 18th day of November 86

Notary Public Deborah M. Coburn
Date Commission Expires 8-3-88

K.C.C. OFFICE USE ONLY
F Letter of Confidentiality Attached
C Wireline Log Received
C Drillers Timelog Received
Distribution
 KCC SWD/Rep NGPA
 KGS Plug Other (Specify)

NOV 21 11-21-86

SIDE TWO

Operator Name Texaco Inc. for Texaco Producing Inc. Lease Name John Towns Well# 6 SEC 18 TWP 9S RGE 20 East West

WELL LOG

INSTRUCTIONS: Show important tops and base of formations penetrated. Detail all cores. Report all drill stem tests giving interval tested, time tool open and closed, flowing and shut-in pressures, whether shut-in pressure reached static level, hydrostatic pressures, bottom hole temperature, fluid recovery, and flow rates if gas to surface during test. Attach extra sheet if more space is needed. Attach copy of log.

Drill Stem Tests Taken Yes No
 Samples Sent to Geological Survey Yes No
 Cores Taken Yes No

Formation Description
 Log Sample

Name Top Bottom

N/A - OWWO

CASING RECORD <input type="checkbox"/> new <input type="checkbox"/> used							
Report all strings set - conductor, surface, intermediate, production, etc.							
Purpose of string	size hole drilled	size casing set (in O.D.)	weight lbs/ft.	setting depth	type of cement	# sacks used	type and percent additives
Surface	12-1/4"	8-5/8"	28	293'		150	
Production	7-5/8"	5-1/2"	17&14.5	3,790'		150	

PERFORATION RECORD		Acid, Fracture, Shot, Cement Squeeze Record	
shots per foot	specify footage of each interval perforated	(amount and kind of material used)	Depth
3	3,430-36'	1,000 g., 15% NEA	3430-36'

TUBING RECORD	size	set at	packer at	Liner Run <input type="checkbox"/> Yes <input type="checkbox"/> No
----------------------	------	--------	-----------	--

Date of First Production 8-16-66	Producing method <input type="checkbox"/> flowing <input checked="" type="checkbox"/> pumping <input type="checkbox"/> gas lift <input type="checkbox"/> Other (explain)
-------------------------------------	---

Estimated Production Per 24 Hours	Oil	Gas	Water	Gas-Oil Ratio	Gravity
10-31-86	6 Bbls	None MCF	26 Bbls	CFPB	

Disposition of gas: vented sold used on lease

METHOD OF COMPLETION
 open hole perforation other (specify) _____

Dually Completed.
 Commingled

PRODUCTION INTERVAL
 3,431-71'