

STATE CORPORATION COMMISSION OF KANSAS
OIL & GAS CONSERVATION DIVISION
WELL COMPLETION OR RECOMPLETION FORM
ACO-1 WELL HISTORY

DESCRIPTION OF WELL AND LEASE

Operator: license # 5430
name ENERGY THREE, INC.
address P. O. Box 1505
GREAT BEND, KANSAS 67530
City/State/Zip

Operator Contact Person CHARLES DIXON
Phone AC316-792-5968

Contractor: license # 5836
name BIG THREE DRILLING, INC.

Wellsite Geologist CHRIS PETERS
Phone AC316-264-7433

Designate Type of Completion
 New Well Re-Entry Workover
 Oil SWD Temp Abd
 Gas Inj Delayed Comp.
 Dry Other (Core, Water Supply etc.)

if OWWO: old well info as follows:
Operator
Well Name
Comp. Date Old Total Depth

WELL HISTORY

Drilling Method: Mud Rotary Air Rotary Cable
10-18-85 10-24-85 12-11-85
Spud Date Date Reached TD Completion Date
3818 3788
Total Depth PBTD

Amount of Surface Pipe Set and Cemented at 933 feet
Multiple Stage Cementing Collar Used? Yes No
If Yes, Show Depth Set feet

If alternate 2 completion, cement circulated
from feet depth to w SX cmt

API NO. 15 163-22,786 -00-00
County ROOKS
SW NE NW Sec 22 Twp 9S Rge 19 East
(location)
4290 Ft North from Southeast Corner of Section
3630 Ft West from Southeast Corner of Section
(Note: locate well in section plat below)

Lease Name BARTOS Well # 2
Field Name JELINEK
DISPOSING LOWER ARBUCKLE
Forming Formation
Elevation: Ground 2140' KB 2145'

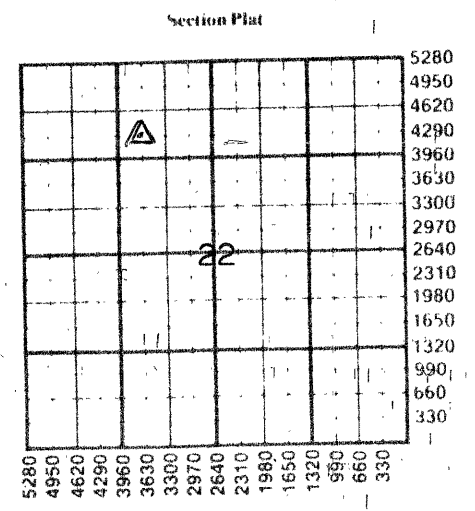

WATER SUPPLY INFORMATION

Source of Water:
Division of Water Resources Permit #
Groundwater Ft North From Southeast Corner and
(Well) Ft. West From Southeast Corner of
Sec Twp Rge East West
 Surface Water 3300 Ft North From Southeast Corner and
(Stream, Pond etc.) 2970 Ft West From Southeast Corner
Sec Twp Rge East West
22 9S 19
Other (explain) (purchased from city, R.W.D.#)

Disposition of Produced Water: Disposal
Repressuring
Docket #

INSTRUCTIONS: This form shall be completed in duplicate and filed with the Kansas Corporation Commission, 200 Colorado Derby Building, Wichita, Kansas 67202, within 90 days after completion or recompletion of any well. Rules 82-3-130 and 82-3-107 apply.
Information on side two of this form will be held confidential for a period of 12 months if requested in writing and submitted with the form. See rule 82-3-107 for confidentiality in excess of 12 months.
One copy of all wireline logs and drillers time log shall be attached with this form. Submit CP-4 form with all plugged wells. Submit CP-111 form with all temporarily abandoned wells.

All requirements of the statutes, rules, and regulations promulgated to regulate the oil and gas industry have been fully complied with and the statements herein are complete and correct to the best of my knowledge.

Signature *Charles Dixon*
Title EXECUTIVE VICE-PRESIDENT Date 12-10-85

Subscribed and sworn to before me this 10TH day of DECEMBER, 1985
Notary Public *Howard D. Ewert*
Date Commission Expires DECEMBER 15, 1988
NOTARY PUBLIC - State of Kansas
HOWARD D. EWERT
My Cert. Exp. 12-15-88

K.C.C. OFFICE USE ONLY
F Letter of Confidentiality Attached
C Wireline Log Received
C Drillers Timelog Received
Distribution
 KCC SWD/Rep NGPA
 KGS Plug
RECEIVED
STATE CORPORATION COMMISSION
DEC 1 1985
Form ACO-1
(This form supercedes previous forms ACO-1 & C-10)
Wichita, Kansas

WELL LOG

INSTRUCTIONS: Show important tops and base of formations penetrated. Detail all cores. Report all drill stem tests giving interval tested, time tool open and closed, flowing and shut-in pressures, whether shut-in pressure reached static level, hydrostatic pressures, bottom hole temperature, fluid recovery, and flow rates if gas to surface during test. Attach extra sheet if more space is needed. Attach copy of log.

Drill Stem Tests Taken Yes No
 Samples Sent to Geological Survey Yes No
 Cores Taken Yes No

Formation Description
 Log Sample

D.S.T. # 1: FROM 3556' TO 3585'
 TIMES = 30 - 45 - 45 - 60
 RECOVERED 15' DRILLING MUD W/ SPOTS OF OIL IN TOOL. XXXXX
 INIT. FLOW PRESS. = PLUGGED
 FINAL FLOW PRESS. = 43 - 50
 INITIAL SHUTIN PRESS. 195#
 FINAL SHUTIN PRESS. 101#

D.S.T. # 2: FROM 3556' TO 3590'
 TIMES = 30 - 60 - 10 - PACKER FAILED
 INIT. FLOW PRESS. = 43 - 57
 FINAL FLOW PRESS. = 57 - ---
 INITIAL SHUTIN PRESS. 818 #
 FINAL SHUTIN PRESS. --

D.S.T. # 3: FROM 3584' TO 3592'
 TIMES = 30 - 60 - 45 - 90
 RECOVERED 60' MUDDY OIL (80% OIL) AND 60' SLIGHTLY OIL CUT MUDDY WATER (40% WATER)
 INITIAL FLOW PRESS. = 43 - 50
 FINAL FLOW PRESS. = 57 - 79
 INITIAL SHUTIN PRESS. 818 #
 FINAL SHUTIN PRESS. 841 #

Name	Top	Bottom
TOPEKA	3090'	(- 945)
HEEBNER	3295'	(- 1150)
LANS.-KC	3336'	(- 1191)
ARBUCKLE	3572'	(- 1427)
(LOG T.D.)	3811'	

CASING RECORD <input checked="" type="checkbox"/> new <input type="checkbox"/> used							
Report all strings set - conductor, surface, intermediate, production, etc.							
Purpose of string	size hole drilled	size casing set (in O.D.)	weight lbs/ft.	setting depth	type of cement	# sacks used	type and percent additives
SURFACE	12 1/4"	8 5/8"	23#	933'	60/40 POZMIX	350	3% C.C. & 2% GEL.
PRODUCTION	7 7/8"	5 1/2"	14#	3810'	60/40 POZMIX	125	2% C.C. & 3% GEL.
PERFORATION RECORD				Acid, Fracture, Shot, Cement Squeeze Record			
shots per foot	specify footage of each interval perforated			amount and kind of material used			Depth
4	3755 - 3775			2500 GAL. 28% REGULAR ACID			PERF. @ 3755' TO 3775'
TUBING RECORD				Liner Run <input type="checkbox"/> Yes <input type="checkbox"/> No			
Date of First Production 12 - 12 - 85		Producing method <input type="checkbox"/> flowing <input type="checkbox"/> pumping <input type="checkbox"/> gas lift <input type="checkbox"/> Other (explain)		size		set at	
Estimated Production Per 24 Hours		Oil Bbls	Gas MCF	Water Bbls	Gas-Oil Ratio	Gravity CFPB	

METHOD OF COMPLETION
 open hole perforation
 other (specify) _____
 Dually Completed.
 Commingled

PRODUCTION INTERVAL