

For KCC Use: 7-7-07  
Effective Date: 7-7-07  
District # \_\_\_\_\_  
SGA?  Yes  No

KANSAS CORPORATION COMMISSION  
OIL & GAS CONSERVATION DIVISION  
**NOTICE OF INTENT TO DRILL**

Form C-1  
December 2002  
Form must be Typed  
Form must be Signed  
All blanks must be Filled

Must be approved by KCC five (5) days prior to commencing well

Expected Spud Date 7/5/07  
month day year

OPERATOR: License# 31629 ✓  
Name: NASH OIL & GAS INC.  
Address: P O BOX 8747  
City/State/Zip: PRATT, KS 67124  
Contact Person: JERRY NASH  
Phone: 620-672-3800

CONTRACTOR: License# 33843 ✓  
Name: TERRA DRILLING LLC

Well Drilled For:	Well Class:	Type Equipment:
<input checked="" type="checkbox"/> Oil	<input type="checkbox"/> Enh Rec	<input type="checkbox"/> Infield
<input checked="" type="checkbox"/> Gas	<input type="checkbox"/> Storage	<input checked="" type="checkbox"/> Pool Ext.
<input type="checkbox"/> OWO	<input type="checkbox"/> Disposal	<input type="checkbox"/> Wildcat
<input type="checkbox"/> Seismic; # of Holes _____	<input type="checkbox"/> Other _____	<input type="checkbox"/> Cable
<input type="checkbox"/> Other _____		

If OWWO: old well information as follows:  
Operator: \_\_\_\_\_  
Well Name: \_\_\_\_\_  
Original Completion Date: \_\_\_\_\_ Original Total Depth: \_\_\_\_\_

Directional, Deviated or Horizontal wellbore?  Yes  No  
If Yes, true vertical depth: \_\_\_\_\_  
Bottom Hole Location: \_\_\_\_\_  
KCC DKT #: \_\_\_\_\_

Spot \_\_\_\_\_ East  
E/2 - SE/4 - \_\_\_\_\_ Sec. 15 Twp. 27S S. R. 12W  West  
2145 feet from  N /  S Line of Section  
810 feet from  E /  W Line of Section  
Is SECTION  Regular  Irregular?

(Note: Locate well on the Section Plat on reverse side)  
County: PRATT  
Lease Name: BARKER Well #: 1  
Field Name: BARNES EXTENSION

Is this a Prorated / Spaced Field?  Yes  No  
Target Formation(s): MISSISSIPPI  
Nearest Lease or unit boundary: 2145'

Ground Surface Elevation: 1830 feet MSL  
Water well within one-quarter mile:  Yes  No  
Public water supply well within one mile:  Yes  No

Depth to bottom of fresh water: 160' ✓  
Depth to bottom of usable water: 180' ✓  
Surface Pipe by Alternate:  1  2

Length of Surface Pipe Planned to be set: 450' ✓  
Length of Conductor Pipe required: N/A  
Projected Total Depth: 4400' ✓  
Formation at Total Depth: ARBUCKLE

Water Source for Drilling Operations:  
 Well  Farm Pond Other \_\_\_\_\_  
DWR Permit #: \_\_\_\_\_

(Note: Apply for Permit with DWR )  
Will Cores be taken?  Yes  No  
If Yes, proposed zone: \_\_\_\_\_

**AFFIDAVIT**

The undersigned hereby affirms that the drilling, completion and eventual plugging of this well will comply with K.S.A. 55 et. seq.  
It is agreed that the following minimum requirements will be met:

1. Notify the appropriate district office **prior** to spudding of well;
2. A copy of the approved notice of intent to drill **shall be posted** on each drilling rig;
3. The minimum amount of surface pipe as specified below **shall be set** by circulating cement to the top; in all cases surface pipe **shall be set** through all unconsolidated materials plus a minimum of 20 feet into the underlying formation.
4. If the well is dry hole, an agreement between the operator and the district office on plug length and placement is necessary **prior to plugging**;
5. The appropriate district office will be notified before well is either plugged or production casing is cemented in;
6. If an ALTERNATE II COMPLETION, production pipe shall be cemented from below any usable water to surface within **120 days** of spud date.  
Or pursuant to Appendix "B" - Eastern Kansas surface casing order #133,891-C, which applies to the KCC District 3 area, alternate II cementing must be completed within 30 days of the spud date or the well shall be plugged. **In all cases, NOTIFY district office** prior to any cementing.

I hereby certify that the statements made herein are true and to the best of my knowledge and belief.

Date: 6/28/07 Signature of Operator or Agent: [Signature] Title: PRESIDENT

**For KCC Use ONLY**  
API # 15 - 151-22275-0000  
Conductor pipe required None feet  
Minimum surface pipe required 200 feet per Alt. 1  
Approved by: [Signature] 7-2-07  
This authorization expires: 1-2-08  
(This authorization void if drilling not started within 6 months of approval date.)  
Spud date: \_\_\_\_\_ Agent: \_\_\_\_\_

**Remember to:**

- File Drill Pit Application (form CDP-1) with Intent to Drill;
- File Completion Form ACO-1 within 120 days of spud date;
- File acreage attribution plat according to field prorations orders;
- Notify appropriate district office 48 hours prior to workover or re-entry;
- Submit plugging report (CP-4) after plugging is completed;
- Obtain written approval before disposing or injecting salt water.
- If this permit has expired (See: authorized expiration date) please check the box below and return to the address below.

Well Not Drilled - Permit Expired  
Signature of Operator or Agent: \_\_\_\_\_  
Date: \_\_\_\_\_

Mail to: KCC - Conservation Division, 130 S. Market - Room 2078, Wichita, Kansas 67202

RECEIVED  
KANSAS CORPORATION COMMISSION  
JUN 29 2007  
CONSERVATION DIVISION  
WICHITA, KS

15  
27  
12W

**IN ALL CASES PLOT THE INTENDED WELL ON THE PLAT BELOW**

*Plat of acreage attributable to a well in a prorated or spaced field*

**If the intended well is in a prorated or spaced field, please fully complete this side of the form.** If the intended well is in a prorated or spaced field complete the plat below showing that the well will be properly located in relationship to other wells producing from the common source of supply. Please show all the wells and within 1 mile of the boundaries of the proposed acreage attribution unit for gas wells and within 1/2 mile of the boundaries of the proposed acreage attribution unit for oil wells.

API No. 15 - 151-22275-0000  
Operator: NASH OIL & GAS INC.  
Lease: BARKER  
Well Number: 1  
Field: BARNES EXTENSION  
Number of Acres attributable to well: \_\_\_\_\_  
QTR / QTR / QTR of acreage: E/2 - SE/4 - \_\_\_\_\_

Location of Well: County: PRATT  
2145 feet from  N /  S Line of Section  
810 feet from  E /  W Line of Section  
Sec. 15 Twp. 27S S. R. 12W  East  West

Is Section:  Regular or  Irregular

**If Section is Irregular, locate well from nearest corner boundary.**  
Section corner used:  NE  NW  SE  SW

**PLAT**

*(Show location of the well and shade attributable acreage for prorated or spaced wells.)  
(Show footage to the nearest lease or unit boundary line.)*

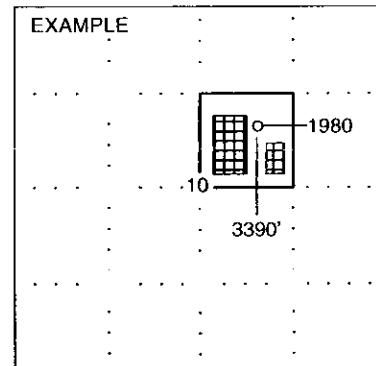
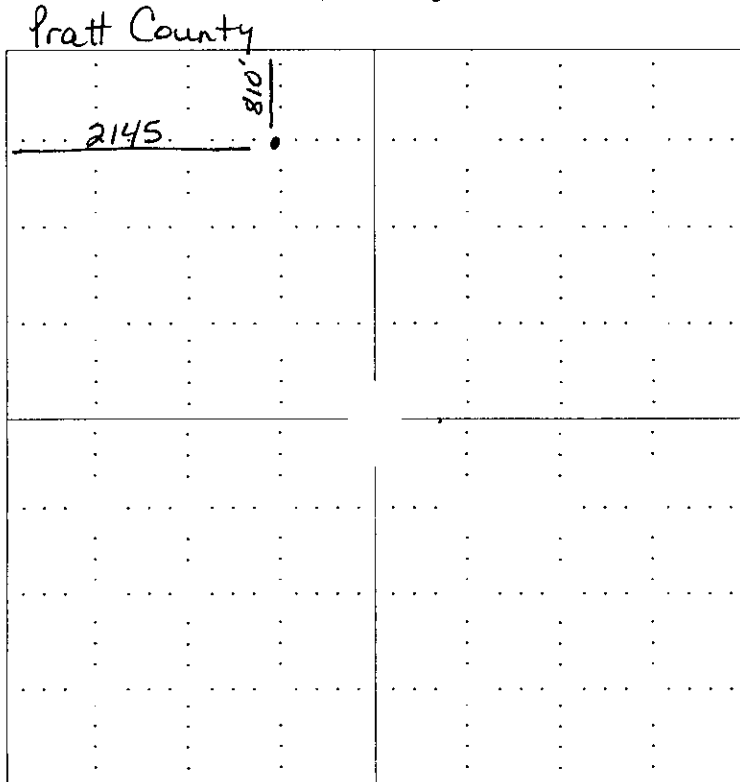

SEWARD CO.

RECEIVED  
KANSAS CORPORATION COMMISSION

**NOTE: In all cases locate the spot of the proposed drilling location.**

**In plotting the proposed location of the well, you must show:**

1. The manner in which you are using the depicted plat by identifying section lines, i.e. 1 section, 1 section with 8 surrounding sections, 4 sections, etc.
2. The distance of the proposed drilling location from the section's south / north and east / west.
3. The distance to the nearest lease or unit boundary line.
4. If proposed location is located within a prorated or spaced field a certificate of acreage attribution plat must be attached: (CO-7 for oil wells; CG-8 for gas wells).

JUN 29 2007

KANSAS CORPORATION COMMISSION  
 OIL & GAS CONSERVATION DIVISION  
**APPLICATION FOR SURFACE PIT**

Form CDP-1  
 April 2004  
 Form must be Typed

Submit in Duplicate

Operator Name: <b>Nash Oil &amp; Gas Inc.</b>		License Number: <b>31629</b>
Operator Address: <b>P O Box 8747, Pratt, KS 67124</b>		
Contact Person: <b>Jerry Nash</b>		Phone Number: ( <b>620</b> ) <b>672</b> - <b>3800</b>
Lease Name & Well No.: <b>Barker #1</b>		Pit Location (QQQQ): <b>E/2 SE/4</b>
Type of Pit: <input type="checkbox"/> Emergency Pit <input type="checkbox"/> Burn Pit <input type="checkbox"/> Settling Pit <input checked="" type="checkbox"/> Drilling Pit <input type="checkbox"/> Workover Pit <input type="checkbox"/> Haul-Off Pit <small>(If WP Supply API No. or Year Drilled)</small>	Pit is: <input type="checkbox"/> Proposed <input type="checkbox"/> Existing If Existing, date constructed: _____ Pit capacity: _____ (bbls)	Sec. <b>15</b> Twp. <b>27S</b> R. <b>12</b> <input type="checkbox"/> East <input checked="" type="checkbox"/> West <b>2145</b> Feet from <input type="checkbox"/> North / <input checked="" type="checkbox"/> South Line of Section <b>810</b> Feet from <input checked="" type="checkbox"/> East / <input type="checkbox"/> West Line of Section <b>Pratt</b> County
Is the pit located in a Sensitive Ground Water Area? <input checked="" type="checkbox"/> Yes <input type="checkbox"/> No		Chloride concentration: _____ mg/l <small>(For Emergency Pits and Settling Pits only)</small>
Is the bottom below ground level? <input checked="" type="checkbox"/> Yes <input type="checkbox"/> No	Artificial Liner? <input type="checkbox"/> Yes <input checked="" type="checkbox"/> No	How is the pit lined if a plastic liner is not used?
Pit dimensions (all but working pits): <b>100</b> Length (feet) <b>100</b> Width (feet) <b>N/A: Steel Pits</b> Depth from ground level to deepest point: <b>4</b> (feet)		
If the pit is lined give a brief description of the liner material, thickness and installation procedure.		Describe procedures for periodic maintenance and determining liner integrity, including any special monitoring.
Distance to nearest water well within one-mile of pit <b>1425</b> feet    Depth of water well <b>91</b> feet		Depth to shallowest fresh water <b>61</b> feet. Source of information: _____ measured    _____ well owner    _____ electric log <b>(2)</b> KDWR
<b>Emergency, Settling and Burn Pits ONLY:</b> Producing Formation: _____ Number of producing wells on lease: _____ Barrels of fluid produced daily: _____ Does the slope from the tank battery allow all spilled fluids to flow into the pit? <input type="checkbox"/> Yes <input type="checkbox"/> No		<b>Drilling, Workover and Haul-Off Pits ONLY:</b> Type of material utilized in drilling/workover: <b>Drilling Mud</b> Number of working pits to be utilized: <b>2</b> Abandonment procedure: <b>Haul of water, let pit dry &amp; fill with dirt</b> _____ Drill pits must be closed within 365 days of spud date.
I hereby certify that the above statements are true and correct to the best of my knowledge and belief.		
_____ Date <b>5/22/07</b>		RECEIVED KANSAS CORPORATION COMMISSION _____ Signature of Applicant or Agent <b>JUN 29 2007</b>
<b>KCC OFFICE USE ONLY</b>		
Date Received: <b>6/29/07</b> Permit Number: _____    Permit Date: <b>6/29/07</b> Lease Inspection: <input checked="" type="checkbox"/> Yes <input type="checkbox"/> No <span style="float: right;">Line B on file RTASAC</span>		

15-151-22275-0000



Kathleen Sebelius, Governor  
Thomas E. Wright, Chairman  
Robert E. Krehbiel, Commissioner  
Michael C. Moffet, Commissioner

June 29, 2007

Mr. Jerry Nash  
Nash Oil & Gas, Inc.  
PO Box 8747  
Pratt, KS 67124

RE: Drilling Pit Application  
Barker Lease Well No. 1  
SE/4 Sec. 15-27S-12W  
Pratt County, Kansas

Dear Mr. Nash:

District staff has inspected the above referenced location and has determined that the reserve pit shall be constructed **without slots**, the bottom shall be flat and reasonably level, and **lined with bentonite or native clay**. The free fluids must be removed. The fluids are to be removed from the reserve pit as soon as the Hutchinson Salt section has been drilled through and displacement of the fluids into the reserve pit has occurred. The fluids should be removed again as soon as practical after drilling operations have ceased.

**If production casing is set all completion fluids shall be removed from the working pits daily. NO completion fluids or non-exempt wastes shall be placed in the reserve pit.**

The fluids should be taken to an authorized disposal well. Please call the District Office at (620) 225-8888 when the fluids have been removed. Please file form CDP-5, Exploration and Production Waste Transfer, within 30 days of fluid removal. Conservation division forms are available through our office and on the KCC web site: [www.kcc.state.ks.us/conservation/forms](http://www.kcc.state.ks.us/conservation/forms).

**A copy of this letter should be posted in the doghouse along with the approved Intent to Drill.**

If you have any questions or concerns please feel free to contact the undersigned at the above address.

Sincerely,

Kathy Haynes  
Environmental Protection and Remediation Department

Cc: File