

For KCC Use:
 Effective Date: 7-7-07
 District # 4
 SGA? Yes No

KANSAS CORPORATION COMMISSION
 OIL & GAS CONSERVATION DIVISION
NOTICE OF INTENT TO DRILL

Form C-1
 December 2002
Form must be Typed
Form must be Signed
All blanks must be Filled

Must be approved by KCC five (5) days prior to commencing well

Expected Spud Date July 10, 2007
month day year

Spot East
SE NE NW Sec. 13 Twp. 6 S. R. 26 West
920 feet from N / S Line of Section
2610 feet from E / W Line of Section

OPERATOR: License# 33335
 Name: IA Operating, Inc.
 Address: 900 N Tyler Rd #14
 City/State/Zip: Wichita KS 67212
 Contact Person: Hal Porter or Bob Swann
 Phone: 316-721-0036

Is SECTION Regular Irregular?
 (Note: Locate well on the Section Plat on reverse side)

CONTRACTOR: License# 30606
 Name: Murfin Drilling Company, Inc.

County: Sheridan
 Lease Name: Johnson Unit Well #: 13-1
 Field Name: Wildcat

Well Drilled For: Oil Gas OWWO Seismic; # of Holes Other
 Enh Rec Storage Disposal
 Well Class: Infield Pool Ext. Wildcat Other
 Type Equipment: Mud Rotary Air Rotary Cable

Is this a Prorated / Spaced Field? Yes No
 Target Formation(s): LKC
 Nearest Lease or unit boundary: 330 feet (Unit)

If OWWO: old well information as follows:
 Operator: _____
 Well Name: _____
 Original Completion Date: _____ Original Total Depth: _____

Ground Surface Elevation: 2610 approx feet MSL
 Water well within one-quarter mile: Yes No
 Public water supply well within one mile: Yes No

Directional, Deviated or Horizontal wellbore? Yes No
 If Yes, true vertical depth: _____
 Bottom Hole Location: _____
 KCC DKT #: _____

Depth to bottom of fresh water: 280
 Depth to bottom of usable water: 1400
 Surface Pipe by Alternate: 1 2

Length of Surface Pipe Planned to be set: 330
 Length of Conductor Pipe required: None
 Projected Total Depth: 4000

Formation at Total Depth: Marmaton
 Water Source for Drilling Operations:
 Well Farm Pond Other X

DWR Permit #: _____
 (Note: Apply for Permit with DWR)
 Will Cores be taken? Yes No
 If Yes, proposed zone: _____

Declaration of Pooling Attached.

AFFIDAVIT

RECEIVED
 KANSAS CORPORATION COMMISSION

The undersigned hereby affirms that the drilling, completion and eventual plugging of this well will comply with K.S.A. 55 et. seq.
 It is agreed that the following minimum requirements will be met:

JUN 29 2007

1. Notify the appropriate district office **prior** to spudding of well;
2. A copy of the approved notice of intent to drill **shall be** posted on each drilling rig;
3. The minimum amount of surface pipe as specified below **shall be set** by circulating cement to the top; in all cases surface pipe **shall be set** through all unconsolidated materials plus a minimum of 20 feet into the underlying formation.
4. If the well is dry hole, an agreement between the operator and the district office on plug length and placement is necessary **prior to plugging**;
5. The appropriate district office will be notified before well is either plugged or production casing is cemented in;
6. If an ALTERNATE II COMPLETION, production pipe shall be cemented from below any usable water to surface within **120 days** of spud date. Or pursuant to Appendix "B" - Eastern Kansas surface casing order #133,891-C, which applies to the KCC District 3 area, alternate II cementing must be completed within 30 days of the spud date or the well shall be plugged. **In all cases, NOTIFY district office** prior to any cementing.

I hereby certify that the statements made herein are true and to the best of my knowledge and belief.
 Date: June 28, 2007 Signature of Operator or Agent: [Signature] Title: President

For KCC Use ONLY
 API # 15 - 051-25658-0000
 Conductor pipe required None feet
 Minimum surface pipe required 330 feet per Alt. 10
 Approved by: [Signature]
 This authorization expires: 1-2-08
 (This authorization void if drilling not started within 6 months of approval date.)
 Spud date: _____ Agent: _____

Remember to:
 - File Drill Pit Application (form CDP-1) with Intent to Drill;
 - File Completion Form ACO-1 within 120 days of spud date;
 - File acreage attribution plat according to field proration orders;
 - Notify appropriate district office 48 hours prior to workover or re-entry;
 - Submit plugging report (CP-4) after plugging is completed;
 - Obtain written approval before disposing or injecting salt water.
 - If this permit has expired (See: authorized expiration date) please check the box below and return to the address below.
 Well Not Drilled - Permit Expired
 Signature of Operator or Agent: _____
 Date: _____

Mail to: KCC - Conservation Division, 130 S. Market - Room 2078, Wichita, Kansas 67202

13
 6
 26W

IN ALL CASES PLOT THE INTENDED WELL ON THE PLAT BELOW

Plat of acreage attributable to a well in a prorated or spaced field

If the intended well is in a prorated or spaced field, please fully complete this side of the form. If the intended well is in a prorated or spaced field complete the plat below showing that the well will be properly located in relationship to other wells producing from the common source of supply. Please show all the wells and within 1 mile of the boundaries of the proposed acreage attribution unit for gas wells and within 1/2 mile of the boundaries of the proposed acreage attribution unit for oil wells.

API No. 15 - 051-256580000
 Operator: IA Operating, Inc.
 Lease: Johnson Unit
 Well Number: 13-1
 Field: Wildcat
 Number of Acres attributable to well: _____
 QTR / QTR / QTR of acreage: SE - NE - NW

Location of Well: County: Sheridan
920 feet from N / S Line of Section
2610 feet from E / W Line of Section
 Sec. 13 Twp. 6 S. R. 26 East West

Is Section: Regular or Irregular

If Section is Irregular, locate well from nearest corner boundary.

Section corner used: NE NW SE SW

PLAT

(Show location of the well and shade attributable acreage for prorated or spaced wells.)

(Show footage to the nearest lease or unit boundary line.)

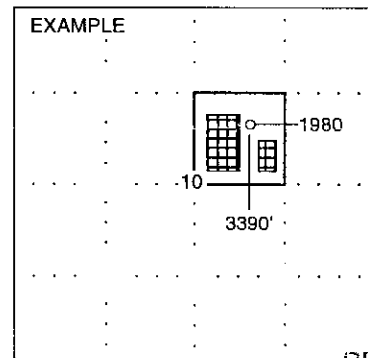
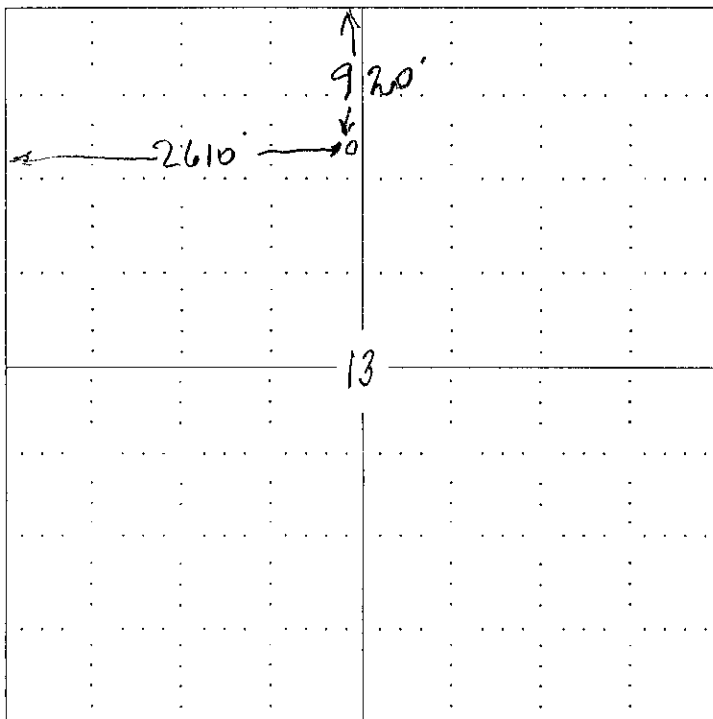

RECEIVED
 KANSAS CORPORATION COMMISSION
 SEWARD CO.

JUN 29 2007

In plotting the proposed location of the well, you must show:

1. The manner in which you are using the depicted plat by identifying section lines, i.e. 1 section, 1 section with 8 surrounding sections, 4 sections, etc.
2. The distance of the proposed drilling location from the section's south / north and east / west.
3. The distance to the nearest lease or unit boundary line.
4. If proposed location is located within a prorated or spaced field a certificate of acreage attribution plat must be attached: (C0-7 for oil wells; CG-8 for gas wells).

CONSERVATION DIVISION
 WICHITA, KS

**KANSAS CORPORATION COMMISSION
OIL & GAS CONSERVATION DIVISION
APPLICATION FOR SURFACE PIT**

Form CDP-1
April 2004
Form must be Typed

Submit in Duplicate

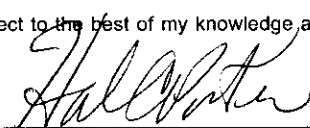
Operator Name: IA Operating, Inc.		License Number: 33335
Operator Address: 900 N Tyler Rd #14, Wichita KS 67212		
Contact Person: Hal Porter or Bob Swann		Phone Number: (316) 721 - 0036
Lease Name & Well No.: Johnson Unit 13-1		Pit Location (QQQQ): SE . NE . NW .
Type of Pit: <input type="checkbox"/> Emergency Pit <input type="checkbox"/> Burn Pit <input type="checkbox"/> Settling Pit <input checked="" type="checkbox"/> Drilling Pit <input type="checkbox"/> Workover Pit <input type="checkbox"/> Haul-Off Pit <small>(If WP Supply API No. or Year Drilled)</small>	Pit is: <input checked="" type="checkbox"/> Proposed <input type="checkbox"/> Existing If Existing, date constructed: _____ Pit capacity: 600 (bbls)	Sec. 13 Twp. 6S R. 26 <input type="checkbox"/> East <input checked="" type="checkbox"/> West 920 Feet from <input checked="" type="checkbox"/> North / <input type="checkbox"/> South Line of Section 2610 Feet from <input type="checkbox"/> East / <input checked="" type="checkbox"/> West Line of Section Sheridan _____ County
Is the pit located in a Sensitive Ground Water Area? <input type="checkbox"/> Yes <input checked="" type="checkbox"/> No		Chloride concentration: _____ mg/l <small>(For Emergency Pits and Settling Pits only)</small>
Is the bottom below ground level? <input checked="" type="checkbox"/> Yes <input type="checkbox"/> No	Artificial Liner? <input checked="" type="checkbox"/> Yes <input type="checkbox"/> No	How is the pit lined if a plastic liner is not used?
Pit dimensions (all but working pits): 100 Length (feet) 100 Width (feet) _____ N/A: Steel Pits Depth from ground level to deepest point: 4 (feet)		
If the pit is lined give a brief description of the liner material, thickness and installation procedure.		Describe procedures for periodic maintenance and determining liner integrity, including any special monitoring.
Distance to nearest water well within one-mile of pit 3011 feet Depth of water well 175 feet		Depth to shallowest fresh water unknown 85 feet. Source of information: _____ measured _____ well owner _____ electric log (3) KDWR
Emergency, Settling and Burn Pits ONLY: Producing Formation: _____ Number of producing wells on lease: _____ Barrels of fluid produced daily: _____ Does the slope from the tank battery allow all spilled fluids to flow into the pit? <input type="checkbox"/> Yes <input type="checkbox"/> No		Drilling, Workover and Haul-Off Pits ONLY: Type of material utilized in drilling/workover: bentonite Number of working pits to be utilized: 4 Abandonment procedure: allow to dry, backfill and level _____ Drill pits must be closed within 365 days of spud date.
I hereby certify that the above statements are true and correct to the best of my knowledge and belief.		RECEIVED KANSAS CORPORATION COMMISSION
<u>June 28, 2007</u> Date	 Signature of Applicant or Agent	JUN 29 2007 CONSERVATION DIVISION WICHITA, KS

15-051-25158000

KCC OFFICE USE ONLY			
Date Received: <u>6/29/07</u>	Permit Number: _____	Permit Date: <u>6/29/07</u>	Lease Inspection: <input type="checkbox"/> Yes <input checked="" type="checkbox"/> No

Mail to: KCC - Conservation Division, 130 S. Market - Room 2078, Wichita, Kansas 67202