

For KCC Use: 7-15-07
 Effective Date: _____
 District #: 1
 SGA? Yes No

KANSAS CORPORATION COMMISSION
 OIL & GAS CONSERVATION DIVISION

Form C-1
 December 2002
 Form must be Typed
 Form must be Signed
 All blanks must be Filled

NOTICE OF INTENT TO DRILL

Must be approved by KCC five (5) days prior to commencing well

Expected Spud Date August 31 2007
 month day year

OPERATOR: License# 32920 ✓
 Name: W.R. Williams, Inc.
 Address: P.O. Box 15163
 City/State/Zip: Amarillo, Texas 79105
 Contact Person: Rob Williams
 Phone: 806 374-4555

CONTRACTOR: License# 09975 33784 ✓
 Name: Cheyenne Drilling LP Trinidad Drilling LP

| | | | | | |
|----------------------------------------------------|-----------------------------------|---------------------------------------------|------------------------------------------------|------------------------------------------------|--------------------------------|
| Well Drilled For: | | Well Class: | | Type Equipment: | |
| <input type="checkbox"/> Oil | <input type="checkbox"/> Enh Rec | <input checked="" type="checkbox"/> Infield | <input checked="" type="checkbox"/> Mud Rotary | <input checked="" type="checkbox"/> Air Rotary | <input type="checkbox"/> Cable |
| <input checked="" type="checkbox"/> Gas | <input type="checkbox"/> Storage | <input type="checkbox"/> Pool Ext. | <input type="checkbox"/> Wildcat | <input type="checkbox"/> Other | |
| <input type="checkbox"/> OWWO | <input type="checkbox"/> Disposal | | | | |
| <input type="checkbox"/> Seismic; _____ # of Holes | | | | | |
| <input type="checkbox"/> Other | | | | | |

If OWWO: old well information as follows:
 Operator: _____
 Well Name: _____
 Original Completion Date: _____ Original Total Depth: _____

Directional, Deviated or Horizontal wellbore? Yes No
 If Yes, true vertical depth: _____
 Bottom Hole Location: _____
 KCC DKT #: _____

Spot _____ East
 _____ C SW Sec. 4 Twp. 22S S. R. 40 West
1320 feet from N / S Line of Section
1320 feet from E / W Line of Section
 Is SECTION Regular Irregular?

(Note: Locate well on the Section Plat on reverse side)
 County: Hamilton
 Lease Name: Prickett Well #: 1
 Field Name: Bradshaw

Is this a Prorated / Spaced Field? Yes No
 Target Formation(s): Upper Winfield
 Nearest Lease or unit boundary: 1320'

Ground Surface Elevation: 3559 feet MSL
 Water well within one-quarter mile: Yes No
 Public water supply well within one mile: Yes No
 Depth to bottom of fresh water: 200'
 Depth to bottom of usable water: 1150'

Surface Pipe by Alternate: 1 2
 Length of Surface Pipe Planned to be set: 250' RECEIVED
 Length of Conductor Pipe required: None KANSAS CORPORATION COMMISSION
 Projected Total Depth: 2790'
 Formation at Total Depth: Winfield JUL 09 2007

Water Source for Drilling Operations:
 Well Farm Pond Other Hauling CONSERVATION DIVISION WICHITA, KS
 DWR Permit #: _____

(Note: Apply for Permit with DWR)
 Will Cores be taken? Yes No
 If Yes, proposed zone: _____

PRORATED & SPACED HUBBARD

AFFIDAVIT

The undersigned hereby affirms that the drilling, completion and eventual plugging of this well will comply with K.S.A. 55 et. seq.
 It is agreed that the following minimum requirements will be met:

1. Notify the appropriate district office **prior** to spudding of well;
2. A copy of the approved notice of intent to drill **shall be** posted on each drilling rig;
3. The minimum amount of surface pipe as specified below **shall be set** by circulating cement to the top; in all cases surface pipe **shall be set** through all unconsolidated materials plus a minimum of 20 feet into the underlying formation.
4. If the well is dry hole, an agreement between the operator and the district office on plug length and placement is necessary **prior to plugging**;
5. The appropriate district office will be notified before well is either plugged or production casing is cemented in;
6. If an ALTERNATE II COMPLETION, production pipe shall be cemented from below any usable water to surface within **120 days** of spud date. Or pursuant to Appendix "B" - Eastern Kansas surface casing order #133,891-C, which applies to the KCC District 3 area, alternate II cementing must be completed within 30 days of the spud date or the well shall be plugged. **In all cases, NOTIFY district office** prior to any cementing.

I hereby certify that the statements made herein are true and to the best of my knowledge and belief.

Date: July 3, 2007 Signature of Operator or Agent: Rob Williams Title: President

For KCC Use ONLY
 API # 15 - 075-20834-0000
 Conductor pipe required None feet
 Minimum surface pipe required 220 feet per Alt. XO 2
 Approved by: Rob Williams 7-10-07
 This authorization expires: 1-10-08
 (This authorization void if drilling not started within 6 months of effective date.)
 Spud date: _____ Agent: _____

Remember to:

- File Drill Pit Application (form CDP-1) with Intent to Drill;
- File Completion Form ACO-1 within 120 days of spud date;
- File acreage attribution plat according to field proration orders;
- Notify appropriate district office 48 hours prior to workover or re-entry;
- Submit plugging report (CP-4) after plugging is completed;
- Obtain written approval before disposing or injecting salt water.
- If this permit has expired (See: authorized expiration date) please check the box below and return to the address below.

Well Not Drilled - Permit Expired
 Signature of Operator or Agent: _____
 Date: _____

4
 22
 40W

IN ALL CASES PLOT THE INTENDED WELL ON THE PLAT BELOW

Plat of acreage attributable to a well in a prorated or spaced field

If the intended well is in a prorated or spaced field, please fully complete this side of the form. If the intended well is in a prorated or spaced field complete the plat below showing that the well will be properly located in relationship to other wells producing from the common source of supply. Please show all the wells and within 1 mile of the boundaries of the proposed acreage attribution unit for gas wells and within 1/2 mile of the boundaries of the proposed acreage attribution unit for oil wells.

API No. 15 - 075-20834-0000
 Operator: W.R. Williams, Inc.
 Lease: Prickett
 Well Number: 1
 Field: Bradshaw
 Number of Acres attributable to well: 320
 QTR / QTR / QTR of acreage: _____ - _____ - S2

Location of Well: County: Hamilton
1320 feet from N / S Line of Section
1320 feet from E / W Line of Section
 Sec. 4 Twp. 22S S. R. 40 East West

Is Section: Regular or Irregular

If Section is Irregular, locate well from nearest corner boundary.

Section corner used: NE NW SE SW

PLAT

*(Show location of the well and shade attributable acreage for prorated or spaced wells.)
 (Show footage to the nearest lease or unit boundary line.)*

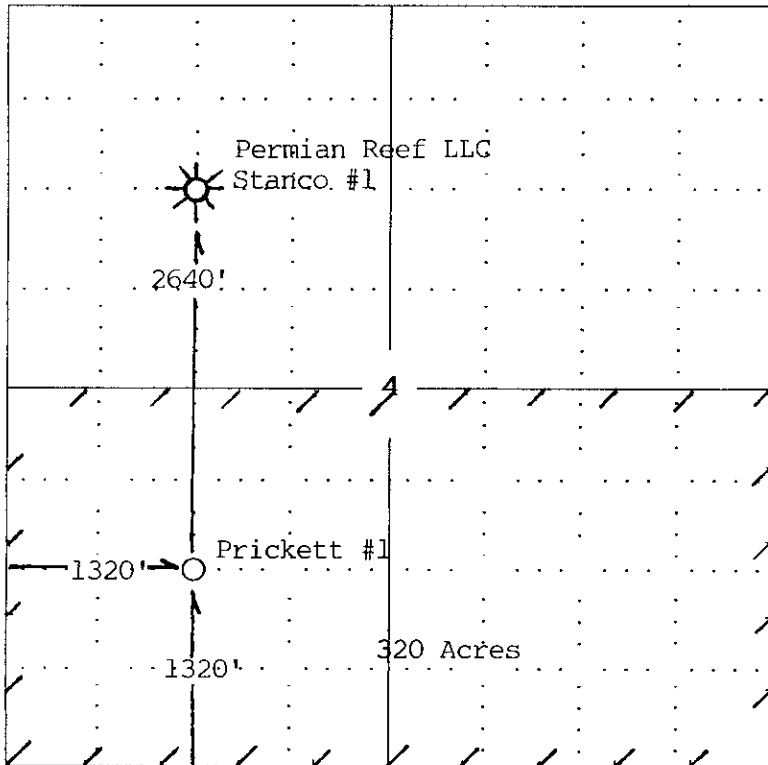

NOTE: In all cases locate the spot of the proposed drilling location.

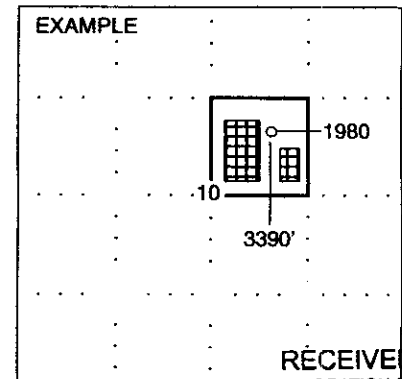

RECEIVED
 SEWARD CO. KANSAS CORPORATION COMMISSION

JUL 09 2007

CONSERVATION DIVISION
 WICHITA, KS

In plotting the proposed location of the well, you must show:

1. The manner in which you are using the depicted plat by identifying section lines, i.e. 1 section, 1 section with 8 surrounding sections, 4 sections, etc.
2. The distance of the proposed drilling location from the section's south / north and east / west.
3. The distance to the nearest lease or unit boundary line.
4. If proposed location is located within a prorated or spaced field a certificate of acreage attribution plat must be attached: (CO-7 for oil wells)

PLAT AND CERTIFICATION OF ACREAGE ATTRIBUTABLE TO A GAS WELL

Kansas Corporation Commission, Conservation Division
 Finney State Office Building, 130 South Market, Room 2078
 Wichita, Kansas 67202

API NUMBER 15- 075-20834-0000

LOCATION OF WELL: COUNTY Hamilton

OPERATOR W.R. Williams, Inc.

LEASE Prickett

1320 feet from south/north line of section

WELL NUMBER 1

1320 feet from east / west line of section

FIELD Bradshaw

SECTION 4 TWP 22 (S) RG 40 E/W (W)

NUMBER OF ACRES ATTRIBUTABLE TO WELL 320

IS SECTION X REGULAR or IRREGULAR

QTR/QTR/QTR OF ACREAGE - - S2

IF SECTION IS IRREGULAR, LOCATE WELL FROM NEAREST CORNER BOUNDARY. (check line below)

Section corner used: NE NW SE X SW

(Show the location of the well and shade attributable acreage for prorated or spaced wells).
 (Show the footage to the nearest lease or unit boundary line; and show footage to the nearest common source supply well).

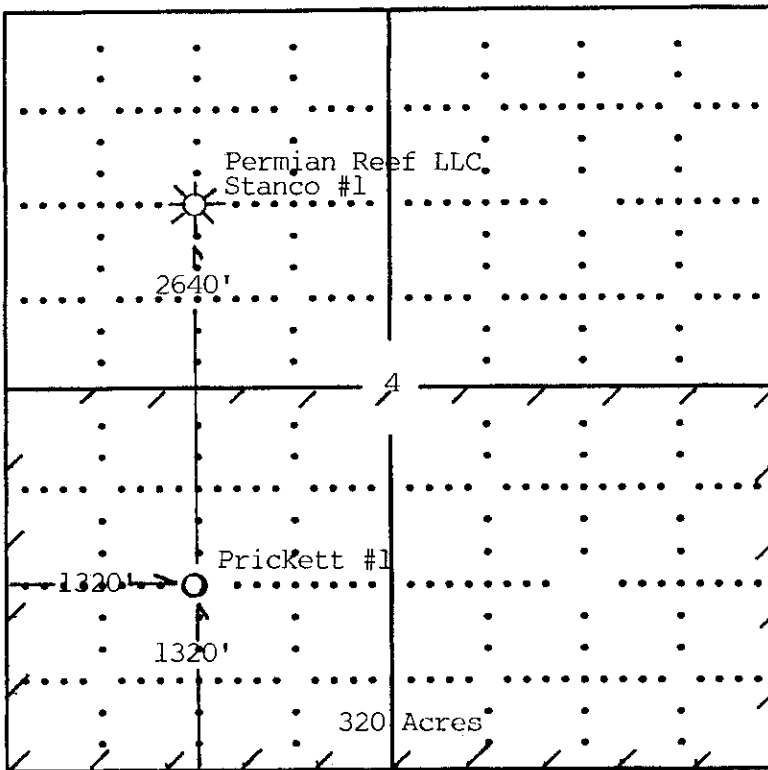

RECEIVED
 KANSAS CORPORATION COMMISSION

JUL 09 2007

CONSERVATION DIVISION
 WICHITA, KS

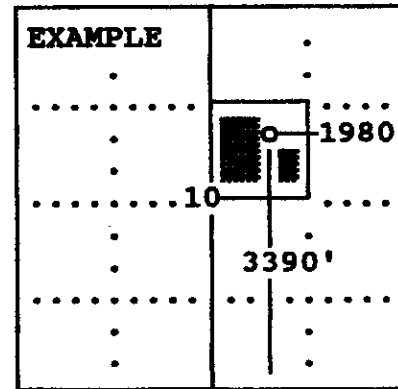

SEWARD CO.

The undersigned hereby certifies as President (title) for

W.R. Williams, Inc. (Co.), a duly authorized agent, that all

information shown hereon is true and correct to the best of my knowledge and belief, that all acreage claimed attributable to the well named herein is held by production from that well and hereby make application for an allowable to be assigned to the well upon the filing of this form and the State test, whichever is later.

Signature [Handwritten Signature]

Subscribed and sworn to before me on this 3rd day of July, 2007



[Handwritten Signature]
 Notary Public

My Commission expires

FORM CG-8 (12/94)

KANSAS CORPORATION COMMISSION
OIL & GAS CONSERVATION DIVISION
APPLICATION FOR SURFACE PIT

Form CDP-1
April 2004
Form must be Typed

Submit in Duplicate

| | | |
|----------------------------------------------------------------------------------------------------------------------------------------------------------------------------------------------------------------------------------------------------------------------------------------------------------------------------|-------------------------------------------------------------------------------------------------------------------------------------------------------------------------------------------------------------------------------------------------------------------------------------------------------------------|-----------------------------------------------------------------------------------------------------------------------------------------------------------------------------------------------------------------------------------------------------------------------------------------------------------------------------------------------------------------------------------|
| Operator Name: W.R. Williams, Inc. | | License Number: 32920 |
| Operator Address: P.O. Box 15163, Amarillo, Texas 79105 | | |
| Contact Person: Rob Williams | | Phone Number: (806) 374 -4555 |
| Lease Name & Well No.: Prickett #1 | | Pit Location (QQQQ): C SW |
| Type of Pit: <input type="checkbox"/> Emergency Pit <input type="checkbox"/> Burn Pit <input type="checkbox"/> Settling Pit <input checked="" type="checkbox"/> Drilling Pit <input type="checkbox"/> Workover Pit <input type="checkbox"/> Haul-Off Pit <small>(If WP Supply API No. or Year Drilled)</small> | Pit is: <input checked="" type="checkbox"/> Proposed <input type="checkbox"/> Existing If Existing, date constructed: _____ Pit capacity: 2670 (bbbls) | Sec. 4 Twp. 22S R. 40 <input type="checkbox"/> East <input checked="" type="checkbox"/> West 1320 Feet from <input type="checkbox"/> North / <input checked="" type="checkbox"/> South Line of Section 1320 Feet from <input type="checkbox"/> East / <input checked="" type="checkbox"/> West Line of Section Hamilton County |
| Is the pit located in a Sensitive Ground Water Area? <input type="checkbox"/> Yes <input checked="" type="checkbox"/> No | | Chloride concentration: _____ mg/l <small>(For Emergency Pits and Settling Pits only)</small> |
| Is the bottom below ground level? <input checked="" type="checkbox"/> Yes <input type="checkbox"/> No | Artificial Liner? <input type="checkbox"/> Yes <input checked="" type="checkbox"/> No | How is the pit lined if a plastic liner is not used? Bentonite from drilling fluids |
| Pit dimensions (all but working pits): 50 Length (feet) 75 Width (feet) _____ N/A: Steel Pits Depth from ground level to deepest point: 4 (feet) | | |
| If the pit is lined give a brief description of the liner material, thickness and installation procedure. | | Describe procedures for periodic maintenance and determining liner integrity, including any special monitoring. |
| Distance to nearest water well within one-mile of pit N/A feet Depth of water well _____ feet | Depth to shallowest fresh water 40 feet. Source of information: _____ measured _____ well owner _____ electric log <input checked="" type="checkbox"/> KDWR | |
| Emergency, Settling and Burn Pits ONLY: Producing Formation: _____ Number of producing wells on lease: _____ Barrels of fluid produced daily: _____ Does the slope from the tank battery allow all spilled fluids to flow into the pit? <input type="checkbox"/> Yes <input type="checkbox"/> No | Drilling, Workover and Haul-Off Pits ONLY: Type of material utilized in drilling/workover: Fresh Water Mud Number of working pits to be utilized: 0 Abandonment procedure: Evaporation & Backfilling _____ Drill pits must be closed within 365 days of spud date. | |
| RECEIVED | | |
| I hereby certify that the above statements are true and correct to the best of my knowledge and belief. KANSAS CORPORATION COMMISSION | | |
| July 3, 2007 Date | <i>Rob Williams</i> Signature of Applicant or Agent | JUL 09 2007 CONSERVATION DIVISION WICHITA, KS |

15-075-200834-0000

KCC OFFICE USE ONLY

Date Received: 7/9/07 Permit Number: _____ Permit Date: 7/9/07 Lease Inspection: Yes No