

* CORRECTED

For KCC Use: 4-17-07
Effective Date: 4-17-07
District # 1
SGA? Yes No

**KANSAS CORPORATION COMMISSION
OIL & GAS CONSERVATION DIVISION
NOTICE OF INTENT TO DRILL**

CORRECTED

Form C-1

December 2002

Form must be Typed

Form must be signed

All blanks must be Filled

Must be approved by KCC five (5) days prior to commencing well

Expected Spud Date 07/11/07
month day year

Spot: East West
NW - NW - SW Sec. 16 Twp. 33S R. 43

OPERATOR: License # 5447

2100.0 feet from N / S Line of Section

532.0 feet from E / W Line of Section

Name: OXY USA Inc.

Is SECTION X Regular _____ Irregular _____

Address: P.O. Box 2528

(Note: Locate well on the Section Plat on reverse side)

City/State/Zip: Liberal, KS 67905

County: Morton

Contact Person: Rafael Bacigalupo

Lease Name: Addington Trust B Well #: 1

Phone: (620) 629-4229

Field Name: Greenwood

CONTRACTOR: License # 33784

Is this a Prorated / Spaced Field? Yes No

Name: Trinidad Drilling Limited Partnership

Target Formation(s): Mississippian

Nearest Lease or unit Boundary: 532 FWL

Well Drilled For: Well Class: Type Equipment:

Ground Surface Elevation: 3624.4 feet MSL

Oil Enh Rec Infield Mud Rotary

Water well within one-quarter mile Yes No

Gas Storage Pool Ext Air Rotary

Public water supply well within one mile: Yes No

OWWO Disposal Wildcat Cable

Depth to bottom of fresh water: 280

Seismic: # of Holes Other

Depth to bottom of usable water: 280

Other

Surface Pipe by Alternate: 1 2

If OWWO: old well information as follows:

Length of Surface Pipe Planned to be set: 1750

Operator: _____

Length of Conductor Pipe Required: _____

Well Name: _____

Projected Total Depth: 5130

Original Completion Date: _____ Original Total Depth: _____

Formation at Total Depth: Chester

Directional, Deviated or Horizontal wellbore? Yes No

Water Source for Drilling Operations:

IF Yes, true vertical depth _____

Well Farm Pond Other _____

Bottom Hole Location _____

DWR Permit # _____

KCC DKT #: _____

(Note: Apply for Permit with DWR)

Will Cores be Taken? Yes No

If Yes, Proposed zone: _____

** WAS: Contractor 30006 Murkin Drilling Co., Inc
IS " 33784 Trinidad Drilling Limited Partnership*

AFFIDAVIT

The undersigned hereby affirms that the drilling, completion and eventual plugging of this well will comply with K.S.A. 55-101, et. Seq.
It is agreed that the following minimum requirements will be met:

RECEIVED
KANSAS CORPORATION COMMISSION

JUL 12 2007

1. Notify the appropriate district office **prior** to spudding of well;
2. A copy of the approved notice of intent to drill **shall be** posted on each drilling rig;
3. The minimum amount of surface pipe as specified below **shall be set** by circulating cement to the top; in all cases surface pipe **shall be set** through all unconsolidated materials plus a minimum of 20 feet into the underlying formation.
4. If the well is dry hole, an agreement between the operator and the district office on plug length and placement is necessary **prior to plugging**;
5. The appropriate district office will be notified before well is either plugged or production casing is cemented in;
6. If an ALTERNATE II COMPLETION, production pipe shall be cemented from below any usable water to surface within **120 days** of spud date. Or pursuant to Appendix "B" - Eastern Kansas surface casing order #133,891-C, which applies to the KCC District 3 area, alternate II cementing must be completed within 30 days of the spud date or the well shall be plugged. **In all cases, NOTIFY district office** prior to any cementing.

PRORATED & SPACED: Greenwood

I hereby certify that the statements made herein are true and to the best of my knowledge and belief.

Date: 04/09/07 Signature of Operator or Agent: _____ Title: Capital Project

For KCC Use ONLY

API # 15 - 129-21804-0000

Conductor pipe required None feet

Minimum Surface pipe required 300 feet per Alt. 1 A

Approved by: WHM 4-12-07 / RH 7-13-07

This authorization expires: 10-12-07

(This authorization void if drilling not started within 6 months of effective date.)

Spud date: _____ Agent: _____

Remember to:

- File Drill Pit Application (form CDP-1) with Intent to Drill;
- File Completion Form ACO-1 within 120 days of spud date;
- File acreage attribution plat according to field proation orders;
- Notify appropriate district office 48 hours prior to workover or re-entry;
- Submit plugging report (CP-4) after plugging is completed;
- Obtain written approval before disposing or injecting salt water.
- If this permit has expired (see: authorized expiration date) please check the box below and return to the address below.

Well Not Drilled - Permit Expired

Signature of Operator or Agent: _____

Date: _____

10-33-43W

IN ALL CASES PLOT THE INTENDED WELL ON THE PLAT BELOW

Plat of acreage attributable to a well in a prorated or spaced field

If the intended well is in a prorated or spaced field, please fully complete this side of the form. If the intended well is in a prorated or spaced field complete the plat below showing that the well will be properly located in relationship to other wells producing from the common source of supply. Please show all the wells and within 1 mile of the boundaries of the proposed acreage attribution unit for gas wells and within 1/2 mile of the boundaries of the proposed acreage attribution unit for oil wells.

API No. 15 - _____
 Operator: _____
 Lease: _____
 Well Number: _____
 Field: _____

Location of Well: County _____
 _____ feet from N / S Line of Section
 _____ feet from E / W Line of Section
 Sec. _____ Twp. _____ R. _____ East West

Number of Acres attributable to well: _____
 QTR / QTR / QTR of acreage: _____ - _____ - _____

Is Section Regular or Irregular

IF Section is Irregular, locate well from nearest corner boundary.

Section corner used: NE NW SE SW

PLAT

*(Show location of the well and shade attributable acreage for prorated or spaced wells.)
 (Show footage to the nearest lease or unit boundary line.)*

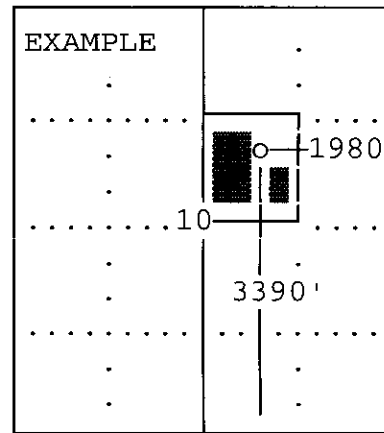
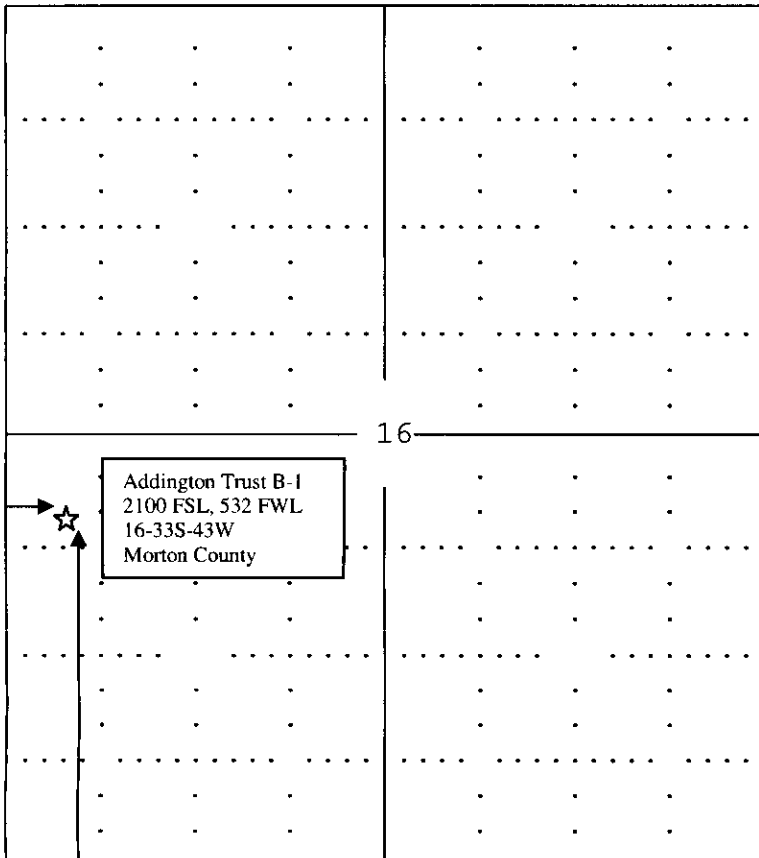

SEWARD CO.

Note: In all cases locate the spot of the proposed drilling location.

In plotting the proposed location of the well, you must show:

1. The manner in which you are using the depicted plat by identifying section lines, i.e. 1 section, 1 section with 8 surrounding sections, 4 sections, etc.
2. The distance of the proposed drilling location from the sections south / north and east / west.
3. The distance to the nearest lease or unit boundary line.
4. If proposed location is located within a prorated or spaced field a certificate of acreage attribution plat must be attached: (CO-7 for oil wells; CG-8 for gas wells).