



**IN ALL CASES PLOT THE INTENDED WELL ON THE PLAT BELOW**

Show the relationship to other wells or facilities proposed to be serviced by the intended cathodic borehole. Please show all the wells, existing cathodic boreholes, pipelines or facilities within 1/2 mile of the proposed borehole.

API NO. 15- 083-21533-0000  
 OPERATOR Northern Natural Gas LOCATION OF WELL: COUNTY Hodgeman  
 LEASE Hodgeman 560' feet from South/north line of section  
 WELL NUMBER 1 84' feet from east/West line of section  
 FACILITY NAME 796B-Holcomb SECTION 20 TWP 21S RG 23W

SPOT: QTR/QTR/QTR/QTR OF ACREAGE  
SW - SW - Sec20 - T21S-R23W

IS SECTION X REGULAR or IRREGULAR  
IF SECTION IS IRREGULAR, LOCATE WELL FROM NEAREST  
CORNER BOUNDARY.  
 Section corner used: NE NW SE SW

**PLAT**

(Show location of intended cathodic borehole.)  
 (Show footage from nearest lease, unit or outside section boundary line.)

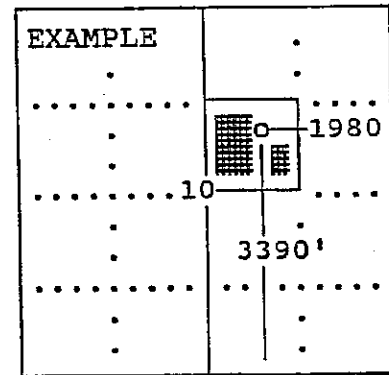
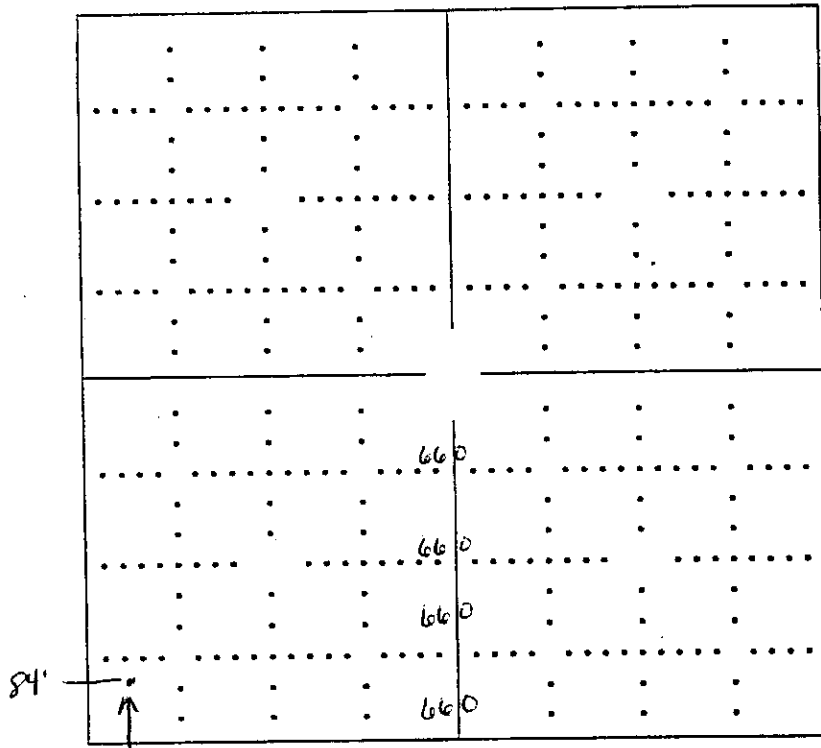

SEWARD CO.

HODGEMAN COUNTY KANSAS

In plotting the proposed location of the well, you must show:

- 1) The manner in which you are using the depicted plat by identifying section lines, i.e. 1 section, 1 section with 8 surrounding sections, 4 sections, etc.;
- 2) the distance of the proposed drilling location from the section's south/north and east/west; and
- 3) the distance to the nearest lease, unit or outside section boundary line.

RECEIVED  
 KANSAS CORPORATION COMMISSION

JUL 10 2007

CONSERVATION DIVISION  
 WICHITA, KS

**KANSAS CORPORATION COMMISSION  
OIL & GAS CONSERVATION DIVISION  
APPLICATION FOR SURFACE PIT**

Form GDP-1  
April 2004  
Form must be Typed

*Submit in Duplicate*

Operator Name: <b>Northern Natural Gas</b>		License Number: <b>32119</b>
Operator Address: <b>9480 West Hwy 50 Holcomb, KS 67881</b>		
Contact Person: <b>Monte Stebens</b>		Phone Number: ( <b>402</b> ) <b>530 - 6332</b>
Lease Name & Well No.: <b>Hodgeman #1</b>		Pit Location (QQQQ): <b>NW - SW - SW - SW</b>
Type of Pit: <input type="checkbox"/> Emergency Pit <input type="checkbox"/> Burn Pit <input type="checkbox"/> Settling Pit <input checked="" type="checkbox"/> Drilling Pit <input type="checkbox"/> Workover Pit <input type="checkbox"/> Haul-Off Pit <small>(If WP Supply API No. or Year Drilled)</small>	Pit is: <input checked="" type="checkbox"/> Proposed <input type="checkbox"/> Existing If Existing, date constructed: _____ Pit capacity: _____ (bbls)	Sec. <b>20</b> Twp. <b>215</b> R. <b>23</b> <input type="checkbox"/> East <input checked="" type="checkbox"/> West <b>560</b> Feet from <input type="checkbox"/> North / <input checked="" type="checkbox"/> South Line of Section <b>84</b> Feet from <input type="checkbox"/> East / <input checked="" type="checkbox"/> West Line of Section <b>Hodgeman</b> County
Is the pit located in a Sensitive Ground Water Area? <input type="checkbox"/> Yes <input checked="" type="checkbox"/> No		Chloride concentration: <b>NONE</b> mg/l <small>(For Emergency Pits and Settling Pits only)</small>
Is the bottom below ground level? <input checked="" type="checkbox"/> Yes <input type="checkbox"/> No	Artificial Liner? <input type="checkbox"/> Yes <input checked="" type="checkbox"/> No	How is the pit lined if a plastic liner is not used? <b>natural soils</b>
Pit dimensions (all but working pits): <b>30</b> Length (feet) <b>4</b> Width (feet)    _____ N/A: <b>Steel Pits</b> Depth from ground level to deepest point: <b>8</b> (feet)		
If the pit is lined give a brief description of the liner material, thickness and installation procedure.		Describe procedures for periodic maintenance and determining liner integrity, including any special monitoring.
Distance to nearest water well within one-mile of pit <b>NONE</b> feet    Depth of water well <b>32</b> feet		Depth to shallowest fresh water <b>23</b> feet. Source of information: _____ measured    _____ well owner    _____ electric log <input checked="" type="checkbox"/> <sup>1</sup> KDWR
<b>Emergency, Settling and Burn Pits ONLY:</b> Producing Formation: <b>Does not apply</b> Number of producing wells on lease: _____ Barrels of fluid produced daily: _____ Does the slope from the tank battery allow all spilled fluids to flow into the pit? <input type="checkbox"/> Yes <input type="checkbox"/> No		<b>Drilling, Workover and Haul-Off Pits ONLY:</b> Type of material utilized in drilling/workover: <b>Bentonite only</b> Number of working pits to be utilized: <b>1</b> Abandonment procedure: <b>Backfill</b> Drill pits must be closed within 365 days of spud date <b>RECEIVED</b> <b>KANSAS CORPORATION COMMISSION</b>
I hereby certify that the above statements are true and correct to the best of my knowledge and belief. <b>Energy Economics Agent, as consultant for Northern Natural Gas.</b> <b>JUL 10 2007</b> <b>7-9-07</b> Date  Signature of Applicant or Agent <b>CONSERVATION DIVISION WICHITA, KS</b>		

15-083-21533-0000

KCC OFFICE USE ONLY			
Date Received: <b>7/10/07</b>	Permit Number: _____	Permit Date: <b>7/10/07</b>	Lease Inspection: <input type="checkbox"/> Yes <input checked="" type="checkbox"/> No