

FOR KCC USE:

FORM CB-1 12/93

FORM MUST BE TYPED

FORM MUST BE SIGNED

ALL BLANKS MUST BE FILLED IN

EFFECTIVE DATE: 7-13-07

State of Kansas

DISTRICT # 1

CATHODIC PROTECTION BOREHOLE INTENT

SGA?...Yes-X.No

Must be approved by the K.C.C. sixty (60) days prior to commencing well.

Expected Spud (Starting) Date August 14, 2007
month day year

Spot (Location) R/O/A
SW - SW - SW Sec 20 Twp 21 S, Rg 23 East
560 feet from South North line of Section
184 feet from East / West line of Section
(Circle directions from nearest outside corner boundaries)

OPERATOR: License # 32119

IS SECTION X REGULAR _____ IRREGULAR?
(Spot well on the Section Plat on Reverse Side)
County: Hodgeman

Name: Northern Natural Gas

Address: 9480 West Highway 50

City/State/Zip: Holcomb, KS 67851

Lease Name: Hodgeman Well #: 2

Contact Person: Monte Stebens

Phone: 402-530-6332

Facility Name: 796B - Holcomb

Ground Surface Elevation: 2400 MSL

Cathodic Borehole Total Depth: 140 ft.

Depth to Bedrock: 250 ft.

CONTRACTOR: License #: 473

Name: Tyler Water Well, Inc.

WATER INFORMATION:

Aquifer Penetration: ... None X Single 23 Multiple

Depth to bottom of fresh water: 42

Depth to bottom of usable water: 750

Water well within one-quarter mile: ... yes X no

Public water supply well within one mile: ... yes X no

Water Source for Drilling Operations:

X well ... farm pond ... stream ... other

Water Well Location: Public water supply

from nearest town

DWR Permit #: N/A

Standard Dimension Ratio (SDR) is = 21

(cathodic surface csg. in inches / MWT in inches = SDR)

CONSTRUCTION FEATURES

Length of Cathodic Surface (Non-Metallic) Casing

Planned to be set: 20 ft.

Length of Conductor pipe (if any?): NONE ft.

Surface casing borehole must be 16" or more

Size of the borehole (I.D.): 9.75 inches

Cathodic surface casing size: 10.0 inches

Cathodic surface casing centralizers set at depths of: 20;

... ; ... ; ... ; ... ; ... ; ... ; ... ; ... ; ... ; ... ;

Cathodic surface casing will terminate at:
X Above surface ... Surface Vault ... Below Surface Vault

Pitless casing adaptor will be used: ... Yes No at Depth 0 ft.

Anode installation depths are: 50 ; 60 ; 70 ; 80 ;

90 ; 100 ; 110 ; 120 ; 130 ; 140 ; ... ; ... ; ... ;

Annular space between borehole and casing will be grouted

with: X Concrete ... Bentonite Cement

X Nest cement ... Bentonite clay

Anode vent pipe will be set at: 3 ft. above surface

Anode conductor (backfill) material TYPE: LORESCO SC-2

Depth to BASE of Backfill installation material: 140

Depth to TOP of Backfill installation material: 30

Max. TD = 140'

AFFIDAVIT

The undersigned hereby affirms that the drilling, completion and eventual plugging of this well will comply with K.S.A. 55-101, et. seq. It is agreed that the following minimum requirements will be met:

1. Notify the appropriate district office prior to spudding of and again before plugging well;
2. A copy of the approved notice of intent to drill shall be posted on each drilling rig;
3. The minimum amount of cathodic surface casing as specified below shall be set by grouting to the top.
4. An agreement between the operator and the district office on plugs and placement is necessary prior to plugging;
5. The appropriate district office will be notified before well is either plugged or casing is grouted in;
6. IN ALL CASES, NOTIFY DISTRICT OFFICE PRIOR TO ANY CEMENTING.

I hereby certify that the statements made herein are true and to the best of my knowledge and belief.

Date: 7-9-07 Signature of Operator or Agent: Jim Hubilun Title: V.P. Operations

Energy Economics Agent,
as consultant for
Northern Natural Gas.

FOR KCC USE:
API # 15- 083-21534-000
Conductor pipe required NONE feet
Minimum cathodic surface casing required 20 feet AH3
Approved by: RH 7-13-07

This authorization expires: 1-13-08
(This authorization void if drilling not started within
6 months of effective date.)
Spud date: _____ Agent: _____

RECEIVED
KANSAS CORPORATION COMMISSION

JUL 10 2007

CONSERVATION DIVISION
WICHITA, KS

REMEMBER TO:

- File Drill Pit Application (form CDP-1) with Intent to Install;
- File Completion Form CB-2 within 30 days of spud date;
- Notify appropriate district office 48 hours prior to workover or re-entry;
- Submit plugging report (CB-4) within 30 days after plugging is completed.

Mail to: KCC - Conservation Division, 130 S. Market - Room 2078, Wichita, Kansas 67202-1226.

IN ALL CASES PLOT THE INTENDED WELL ON THE PLAT BELOW

Show the relationship to other wells or facilities proposed to be serviced by the intended cathodic borehole. Please show all the wells, existing cathodic boreholes, pipelines or facilities within 1/2 mile of the proposed borehole.

API NO. 15- 083-21534-0000
 OPERATOR Northern Natural Gas
 LEASE Hodgeman
 WELL NUMBER 2
 FACILITY NAME 796B-Holcomb

LOCATION OF WELL: COUNTY Hodgeman
560' feet from south/north line of section
184' feet from east/west line of section
 SECTION 20 TWP 21S RG 23W

SPOT: QTR/QTR/QTR/QTR OF ACREAGE
SW - SW - Sec20 - T21S-R23W

IS SECTION X REGULAR or IRREGULAR
IF SECTION IS IRREGULAR, LOCATE WELL FROM NEAREST
CORNER BOUNDARY.

Section corner used: NE NW SE SW

PLAT

(Show location of intended cathodic borehole.)

(Show footage from nearest lease, unit or outside section boundary line.)

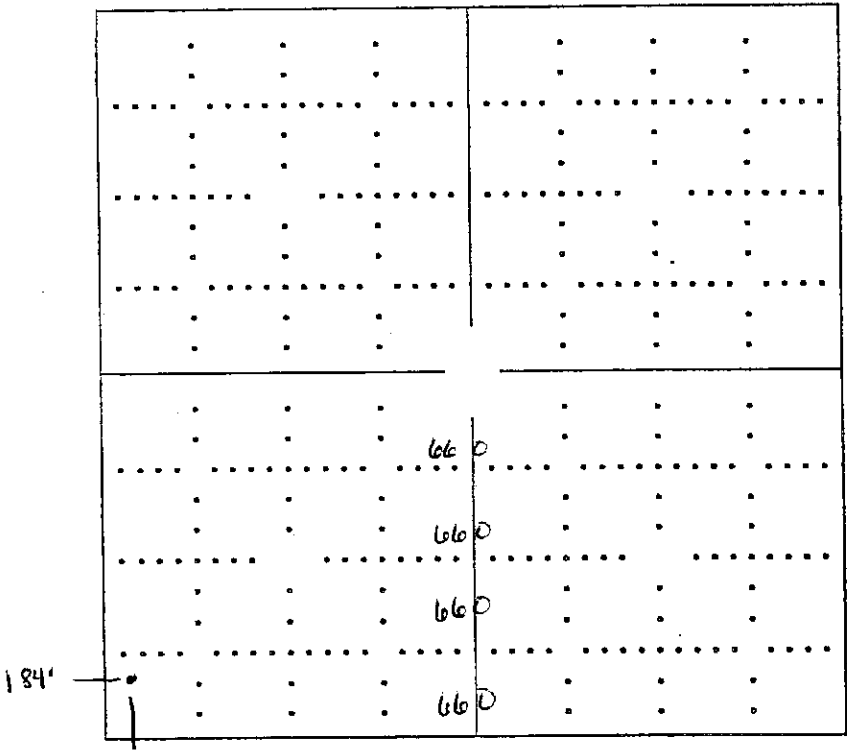

560' HODGEMAN COUNTY KANSAS

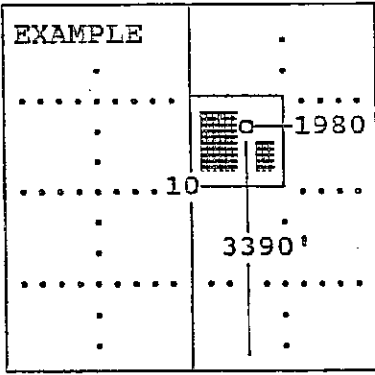

SEWARD CO.

In plotting the proposed location of the well, you must show:

- 1) The manner in which you are using the depicted plat by identifying section lines, i.e. 1 section, 1 section with 8 surrounding sections, 4 sections, etc.;
- 2) the distance of the proposed drilling location from the section's south/north and east/west; and
- 3) the distance to the nearest lease, unit or outside section boundary line.

RECEIVED
 KANSAS CORPORATION COMMISSION
 JUL 10 2007
 CONSERVATION DIVISION
 WICHITA, KS

**KANSAS CORPORATION COMMISSION
OIL & GAS CONSERVATION DIVISION
APPLICATION FOR SURFACE PIT**

Form CDP-1
April 2004
Form must be Typed

Submit in Duplicate

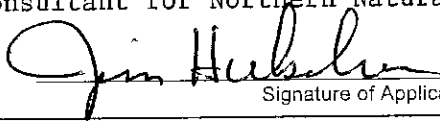
Operator Name: <u>Northern Natural Gas</u>		License Number: <u>32119</u>
Operator Address: <u>9480 West Hwy 50 Holcomb, KS 67881</u>		
Contact Person: <u>Monte Stebens</u>		Phone Number: (<u>402</u>) <u>530</u> - <u>6332</u>
Lease Name & Well No.: <u>Hodgeman #2</u>		Pit Location (QQQQ): <u>NW - SW - SW - SW</u> Sec. <u>20</u> Twp. <u>21</u> R. <u>23</u> <input type="checkbox"/> East <input checked="" type="checkbox"/> West <u>560</u> Feet from <input type="checkbox"/> North / <input checked="" type="checkbox"/> South Line of Section <u>184</u> Feet from <input type="checkbox"/> East / <input checked="" type="checkbox"/> West Line of Section <u>Hodgeman</u> County
Type of Pit: <input type="checkbox"/> Emergency Pit <input type="checkbox"/> Burn Pit <input type="checkbox"/> Settling Pit <input checked="" type="checkbox"/> Drilling Pit <input type="checkbox"/> Workover Pit <input type="checkbox"/> Haul-Off Pit <small>(If WP Supply API No. or Year Drilled)</small>	Pit is: <input checked="" type="checkbox"/> Proposed <input type="checkbox"/> Existing If Existing, date constructed: _____ Pit capacity: _____ (bbls)	
Is the pit located in a Sensitive Ground Water Area? <input type="checkbox"/> Yes <input checked="" type="checkbox"/> No		Chloride concentration: <u>NONE</u> mg/l <small>(For Emergency Pits and Settling Pits only)</small>
Is the bottom below ground level? <input checked="" type="checkbox"/> Yes <input type="checkbox"/> No	Artificial Liner? <input type="checkbox"/> Yes <input checked="" type="checkbox"/> No	How is the pit lined if a plastic liner is not used? <u>natural soils</u>
Pit dimensions (all but working pits): <u>30</u> Length (feet) <u>4</u> Width (feet) _____ N/A: Steel Pits Depth from ground level to deepest point: <u>8</u> (feet)		
If the pit is lined give a brief description of the liner material, thickness and installation procedure.		Describe procedures for periodic maintenance and determining liner integrity, including any special monitoring.
Distance to nearest water well within one-mile of pit <u>NONE 3005</u> feet Depth of water well <u>32</u> feet		Depth to shallowest fresh water <u>23</u> 18 feet. Source of information: _____ measured _____ well owner _____ electric log <input checked="" type="checkbox"/> <input checked="" type="checkbox"/> (K)DWR
Emergency, Settling and Burn Pits ONLY: Producing Formation: <u>Does not apply</u> Number of producing wells on lease: _____ Barrels of fluid produced daily: _____ Does the slope from the tank battery allow all spilled fluids to flow into the pit? <input type="checkbox"/> Yes <input type="checkbox"/> No		Drilling, Workover and Haul-Off Pits ONLY: Type of material utilized in drilling/workover: <u>Bentonite only</u> Number of working pits to be utilized: <u>1</u> Abandonment procedure: <u>Backfill</u> _____ Drill pits must be closed within 365 days of spud date.
I hereby certify that the above statements are true and correct to the best of my knowledge and belief. Energy Economics Agent, as consultant for Northern Natural Gas.		RECEIVED KANSAS CORPORATION COMMISSION JUL 10 2007 CONSERVATION DIVISION WICHITA, KS
<u>7-9-07</u> Date		 Signature of Applicant or Agent
KCC OFFICE USE ONLY		
Date Received: <u>7/10/07</u>	Permit Number: _____	Permit Date: <u>7/10/07</u> Lease Inspection: <input type="checkbox"/> Yes <input checked="" type="checkbox"/> No

15-083-21534-0020