

For KCC Use: 7-23-07  
 Effective Date: 3  
 District # 3  
 SGA?  Yes  No

KANSAS CORPORATION COMMISSION  
 OIL & GAS CONSERVATION DIVISION

Form C-1  
 December 2002  
**Form must be Typed**  
**Form must be Signed**  
**All blanks must be Filled**

**NOTICE OF INTENT TO DRILL**

Must be approved by KCC five (5) days prior to commencing well

Expected Spud Date 7/24/07  
 month day year

OPERATOR: License# 33539  
 Name: Cherokee Wells, LLC  
 Address: 4916 Camp Bowie Blvd., Suite 204  
 City/State/Zip: Fort Worth, TX 76107  
 Contact Person: Tracy Miller  
 Phone: 620-378-3650

CONTRACTOR: License# 33072  
 Name: Well Refined Drilling

|  |                                   |  |
|--|-----------------------------------|--|
| Well Drilled For:                            | Well Class:                       | Type Equipment:                                |
| <input type="checkbox"/> Oil                 | <input type="checkbox"/> Enh Rec  | <input checked="" type="checkbox"/> Infield    |
| <input checked="" type="checkbox"/> Gas      | <input type="checkbox"/> Storage  | <input type="checkbox"/> Mud Rotary            |
| <input type="checkbox"/> OWWO                | <input type="checkbox"/> Disposal | <input checked="" type="checkbox"/> Air Rotary |
| <input type="checkbox"/> Seismic: # of Holes | <input type="checkbox"/> Wildcat  | <input type="checkbox"/> Cable                 |
| <input type="checkbox"/> Other               | <input type="checkbox"/> Other    |  |

If OWWO: old well information as follows:  
 Operator: \_\_\_\_\_  
 Well Name: \_\_\_\_\_  
 Original Completion Date: \_\_\_\_\_ Original Total Depth: \_\_\_\_\_

Directional, Deviated or Horizontal wellbore?  Yes  No  
 If Yes, true vertical depth: \_\_\_\_\_  
 Bottom Hole Location: \_\_\_\_\_  
 KCC DKT #: \_\_\_\_\_

Spot  East  
 C - E/2 SE - SE Sec. 28 Twp. 28 S. R. 13  West  
660 feet from  N /  S Line of Section  
330 feet from  E /  W Line of Section  
 Is SECTION  Regular  Irregular?

(Note: Locate well on the Section Plat on reverse side)  
 County: Elk  
 Lease Name: O. Smith Well #: A-2  
 Field Name: Cherokee Basin Coal Gas Area

Is this a Prorated / Spaced Field?  Yes  No  
 Target Formation(s): Mississippian  
 Nearest Lease or unit boundary: 330'

Ground Surface Elevation: Unknown feet MSL  
 Water well within one-quarter mile:  Yes  No  
 Public water supply well within one mile:  Yes  No

Depth to bottom of fresh water: 100+  
 Depth to bottom of usable water: 200+ 225'  
 Surface Pipe by Alternate:  1  2

Length of Surface Pipe Planned to be set: 40' Minimum   
 Length of Conductor Pipe required: None  
 Projected Total Depth: 1350'  
 Formation at Total Depth: Mississippian

Water Source for Drilling Operations:  
 Well  Farm Pond  Other \_\_\_\_\_  
 DWR Permit #: \_\_\_\_\_

(Note: Apply for Permit with DWR )  
 Will Cores be taken?  Yes  No  
 If Yes, proposed zone: \_\_\_\_\_

**RECEIVED**  
 KANSAS CORPORATION COMMISSION

**AFFIDAVIT**

The undersigned hereby affirms that the drilling, completion and eventual plugging of this well will comply with K.S.A. 55 et. seq. **JUL 18 2007**

It is agreed that the following minimum requirements will be met:

1. Notify the appropriate district office **prior** to spudding of well;
2. A copy of the approved notice of intent to drill **shall be** posted on each drilling rig;
3. The minimum amount of surface pipe as specified below **shall be set** by circulating cement to the top; in all cases surface pipe **shall be set** through all unconsolidated materials plus a minimum of 20 feet into the underlying formation.
4. If the well is dry hole, an agreement between the operator and the district office on plug length and placement is necessary **prior to plugging**;
5. The appropriate district office will be notified before well is either plugged or production casing is cemented in;
6. If an ALTERNATE II COMPLETION, production pipe shall be cemented from below any usable water to surface within **120 days** of spud date.  
 Or pursuant to Appendix "B" - Eastern Kansas surface casing order #133,891-C, which applies to the KCC District 3 area, alternate II cementing must be completed within 30 days of the spud date or the well shall be plugged. **In all cases, NOTIFY district office** prior to any cementing.

I hereby certify that the statements made herein are true and to the best of my knowledge and belief.  
 Date: 7/17/07 Signature of Operator or Agent: Nancy Miller Title: Administrative Assistant

**For KCC Use ONLY**  
 API # 15 - 049-22464-0000  
 Conductor pipe required None feet  
 Minimum surface pipe required 40 feet per Alt. XO 2  
 Approved by: KCC 7-18-07  
 This authorization expires: 1-18-08  
 (This authorization void if drilling not started within 6 months of approval date.)  
 Spud date: \_\_\_\_\_ Agent: \_\_\_\_\_

**Remember to:**  
 - File Drill Pit Application (form CDP-1) with Intent to Drill;  
 - File Completion Form ACO-1 within 120 days of spud date;  
 - File acreage attribution plat according to field proration orders;  
 - Notify appropriate district office 48 hours prior to workover or re-entry;  
 - Submit plugging report (CP-4) after plugging is completed;  
 - Obtain written approval before disposing or injecting salt water.  
 - If this permit has expired (See: authorized expiration date) please check the box below and return to the address below.  
 **Well Not Drilled - Permit Expired**  
 Signature of Operator or Agent: \_\_\_\_\_  
 Date: \_\_\_\_\_

28  
28  
13E

**IN ALL CASES PLOT THE INTENDED WELL ON THE PLAT BELOW**

*Plat of acreage attributable to a well in a prorated or spaced field*

**If the intended well is in a prorated or spaced field, please fully complete this side of the form.** If the intended well is in a prorated or spaced field complete the plat below showing that the well will be properly located in relationship to other wells producing from the common source of supply. Please show all the wells and within 1 mile of the boundaries of the proposed acreage attribution unit for gas wells and within 1/2 mile of the boundaries of the proposed acreage attribution unit for oil wells.

API No. 15 - 049-22464-0000

Operator: Cherokee Wells, LLC

Lease: O. Smith

Well Number: A-2

Field: Cherokee Basin Coal Gas Area

Number of Acres attributable to well: \_\_\_\_\_

QTR / QTR / QTR of acreage: C - E/2 - SE - SE

Location of Well: County: Elk

660 feet from  N /  S Line of Section

330 feet from  E /  W Line of Section

Sec. 28 Twp. 28 S. R. 13  East  West

Is Section:  Regular or  Irregular

**If Section is Irregular, locate well from nearest corner boundary.**

Section corner used:  NE  NW  SE  SW

**PLAT**

*(Show location of the well and shade attributable acreage for prorated or spaced wells.)*

*(Show footage to the nearest lease or unit boundary line.)*

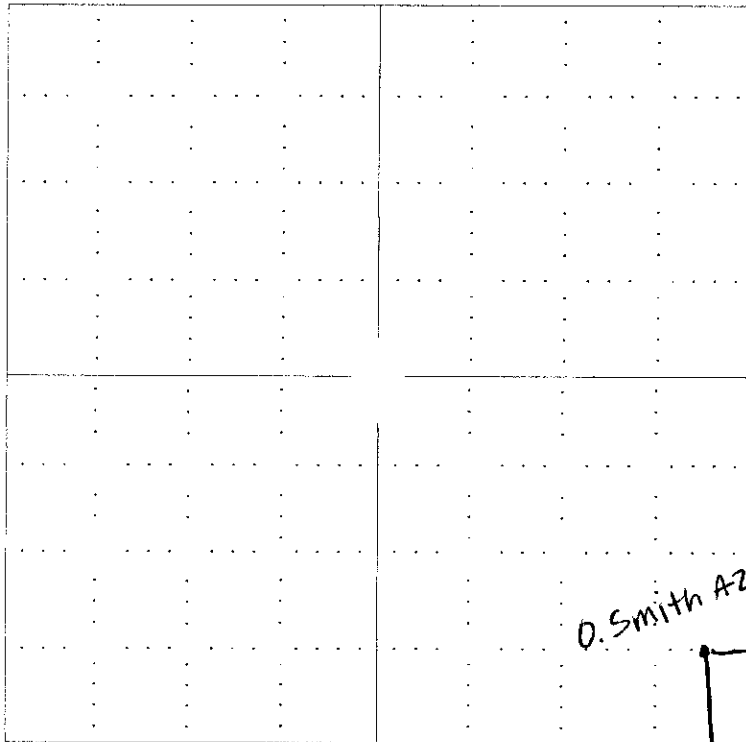

*O. Smith A2*  
*330' FEL*

*N*  
*↑*

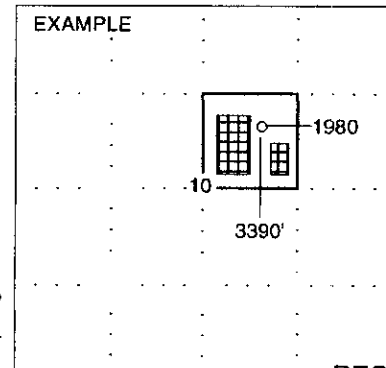

SEWARD CO.

RECEIVED  
KANSAS CORPORATION COMMISSION

**NOTE: In all cases locate the spot of the proposed drilling location. 000' FSL**

**JUL 18 2007**

**In plotting the proposed location of the well, you must show:**

1. The manner in which you are using the depicted plat by identifying section lines, i.e. 1 section, 1 section with 8 surrounding sections, 4 sections, etc.
2. The distance of the proposed drilling location from the section's south / north and east / west.
3. The distance to the nearest lease or unit boundary line.
4. If proposed location is located within a prorated or spaced field a certificate of acreage attribution plat must be attached: (CO-7 for oil wells; CG-8 for gas wells).

CONSERVATION DIVISION  
WICHITA, KS

**KANSAS CORPORATION COMMISSION  
OIL & GAS CONSERVATION DIVISION  
APPLICATION FOR SURFACE PIT**

Form CDP-1  
April 2004  
Form must be Typed

*Submit in Duplicate*

|  |  |  |
|--|--|--|
| Operator Name: <b>Cherokee Wells, LLC</b>  |  | License Number: <b>33539</b>   |
| Operator Address: <b>4916 Camp Bowie Blvd., Suite 204 Fort Worth, TX 76107</b>   |  |  |
| Contact Person: <b>Tracy Miller</b>  |  | Phone Number: ( <b>620</b> ) <b>378 - 3650</b>   |
| Lease Name & Well No.: <b>O. Smith A-2</b>   |  | Pit Location (QQQQ):<br><b>C . E/2 . SE . SE</b>   |
| Type of Pit:<br><input type="checkbox"/> Emergency Pit <input type="checkbox"/> Burn Pit<br><input type="checkbox"/> Settling Pit <input checked="" type="checkbox"/> Drilling Pit<br><input type="checkbox"/> Workover Pit <input type="checkbox"/> Haul-Off Pit<br><small>(If WP Supply API No. or Year Drilled)</small>     | Pit is:<br><input checked="" type="checkbox"/> Proposed <input type="checkbox"/> Existing<br>If Existing, date constructed:<br>_____<br>Pit capacity:<br><b>800</b> (bbls) | Sec. <b>28</b> Twp. <b>28</b> R. <b>13</b> <input checked="" type="checkbox"/> East <input type="checkbox"/> West<br><b>660</b> Feet from <input type="checkbox"/> North / <input checked="" type="checkbox"/> South Line of Section<br><b>330</b> Feet from <input checked="" type="checkbox"/> East / <input type="checkbox"/> West Line of Section<br><b>EIK</b> _____ County |
| Is the pit located in a Sensitive Ground Water Area? <input type="checkbox"/> Yes <input checked="" type="checkbox"/> No   |  | Chloride concentration: _____ mg/l<br><small>(For Emergency Pits and Settling Pits only)</small>   |
| Is the bottom below ground level?<br><input checked="" type="checkbox"/> Yes <input type="checkbox"/> No   | Artificial Liner?<br><input type="checkbox"/> Yes <input checked="" type="checkbox"/> No   | How is the pit lined if a plastic liner is not used?<br><b>Natural Clay &amp; Earth</b>  |
| Pit dimensions (all but working pits): <b>30</b> Length (feet) <b>40</b> Width (feet)    _____ N/A: <b>Steel Pits</b><br>Depth from ground level to deepest point: <b>6</b> (feet)   |  |  |
| If the pit is lined give a brief description of the liner material, thickness and installation procedure.  |  | Describe procedures for periodic maintenance and determining liner integrity, including any special monitoring.  |
| Distance to nearest water well within one-mile of pit:<br><b>N/A</b> feet    Depth of water well _____ feet  |  | Depth to shallowest fresh water <b>est. 100+</b> feet.<br>Source of information:<br>_____ measured    _____ well owner <input checked="" type="checkbox"/> electric log    _____ KDWR  |
| <b>Emergency, Settling and Burn Pits ONLY:</b><br>Producing Formation: _____<br>Number of producing wells on lease: _____<br>Barrels of fluid produced daily: _____<br>Does the slope from the tank battery allow all spilled fluids to flow into the pit? <input checked="" type="checkbox"/> Yes <input type="checkbox"/> No |  | <b>Drilling, Workover and Haul-Off Pits ONLY:</b><br>Type of material utilized in drilling/workover: <b>Fresh Water</b><br>Number of working pits to be utilized: <b>One</b><br>Abandonment procedure: <b>Remove Fluids, Allow to Dry and Level Surface</b><br>_____<br>Drill pits must be closed within 365 days of spud date.  |
| I hereby certify that the above statements are true and correct to the best of my knowledge and belief.  |  |  |
| <b>7/17/07</b><br>Date   | <i>Tracy Miller</i><br>Signature of Applicant or Agent   | RECEIVED<br>KANSAS CORPORATION COMMISSION<br><b>JUL 18 2007</b><br>CONSERVATION DIVISION<br>WICHITA, KS  |
| <b>KCC OFFICE USE ONLY</b>   |  |  |
| Date Received: <b>7/18/07</b>  | Permit Number: _____   | Permit Date: <b>7/18/07</b> Lease Inspection: <input type="checkbox"/> Yes <input checked="" type="checkbox"/> No  |

15-049-22144-0000  
0000-hair ee -bho-s1