

For KCC Use:
 Effective Date: 7-24-07
 District # 3
 SGA? Yes No

KANSAS CORPORATION COMMISSION
 OIL & GAS CONSERVATION DIVISION
NOTICE OF INTENT TO DRILL

Form C-1
 December 2002
Form must be Typed
Form must be Signed
All blanks must be Filled

Must be approved by KCC five (5) days prior to commencing well

Expected Spud Date July 23 2007
month day year

OPERATOR: License# 3473
 Name: William T. Wax
 Address: P. O. Box 276
McCune, KS 66753
 Contact Person: Bill Wax
 Phone: 620-724-3400

CONTRACTOR: License# 3473
 Name: Co. Tools

| | | |
|---|--|---|
| Well Drilled For: | Well Class: | Type Equipment: |
| <input checked="" type="checkbox"/> Oil <input checked="" type="checkbox"/> Gas <input type="checkbox"/> QWWD <input type="checkbox"/> Seismic; # of Holes <input type="checkbox"/> Other | <input type="checkbox"/> Enh Rec <input type="checkbox"/> Storage <input type="checkbox"/> Disposal <input type="checkbox"/> Other | <input type="checkbox"/> Mud Rotary <input checked="" type="checkbox"/> Air Rotary <input type="checkbox"/> Cable |
| <input type="checkbox"/> Infield <input type="checkbox"/> Pool Ext. <input type="checkbox"/> Wildcat | | |

If OWWO: old well information as follows:
 Operator: N/A
 Well Name: _____
 Original Completion Date: _____ Original Total Depth: _____
 Directional, Deviated or Horizontal wellbore? Yes No
 If Yes, true vertical depth: _____
 Bottom Hole Location: _____
 KCC DKT #: _____

Spot W2 - E2NE - SE Sec. 1 Twp. 31 S. R. 21
1980 feet from N / S Line of Section
577.5 feet from E / W Line of Section
 Is SECTION Regular Irregular?

(Note: Locate well on the Section Plat on reverse side)
 County: Crawford
 Lease Name: Mullen Well #: F81
 Field Name: McCune
 Is this a Prorated / Spaced Field? Yes No
 Target Formation(s): Cattlemen
 Nearest Lease or unit boundary: 577.5
 Ground Surface Elevation: _____ feet MSL
 Water well within one-quarter mile: Yes No
 Public water supply well within one mile: Yes No
 Depth to bottom of fresh water: 100
 Depth to bottom of usable water: 100
 Surface Pipe by Alternate: 1 2
 Length of Surface Pipe Planned to be set: 20'
 Length of Conductor Pipe required: N/A
 Projected Total Depth: 350
 Formation at Total Depth: Bartlesville
 Water Source for Drilling Operations:
 Well Farm Pond Other AIR
 DWR Permit #: _____
 (Note: Apply for Permit with DWR)
 Will Cores be taken? Yes No
 If Yes, proposed zone: _____

AFFIDAVIT

RECEIVED
 KANSAS CORPORATION COMMISSION

The undersigned hereby affirms that the drilling, completion and eventual plugging of this well will comply with K.S.A. 55 et. seq.
 It is agreed that the following minimum requirements will be met:

1. Notify the appropriate district office **prior** to spudding of well;
2. A copy of the approved notice of intent to drill **shall be** posted on each drilling rig;
3. The minimum amount of surface pipe as specified below **shall be set** by circulating cement to the top; in all cases surface pipe **shall be set** through all unconsolidated materials plus a minimum of 20 feet into the underlying formation.
4. If the well is dry hole, an agreement between the operator and the district office on plug length and placement is necessary **prior to plugging**;
5. The appropriate district office will be notified before well is either plugged or production casing is cemented in;
6. If an ALTERNATE II COMPLETION, production pipe shall be cemented from below any usable water to surface within **120 days** of spud date. Or pursuant to Appendix "B" - Eastern Kansas surface casing order #133,891-C, which applies to the KCC District 3 area, alternate II cementing must be completed within 30 days of the spud date or the well shall be plugged. **In all cases, NOTIFY district office** prior to any cementing.

JUL 18 2007

CONSERVATION DIVISION
 WICHITA, KS

I hereby certify that the statements made herein are true and to the best of my knowledge and belief.
 Date: 07/16/07 Signature of Operator or Agent: _____ Title: _____

For KCC Use ONLY
 API # 15 - 037-21926-0000
 Conductor pipe required None feet
 Minimum surface pipe required 20 feet per Alt. 2
 Approved by: RWH 7-19-07
 This authorization expires: 1-19-08
 (This authorization void if drilling not started within 6 months of approval date.)
 Spud date: _____ Agent: _____

Remember to:

- File Drill Pit Application (form CDP-1) with Intent to Drill;
- File Completion Form ACO-1 within 120 days of spud date;
- File acreage attribution plat according to field proration orders;
- Notify appropriate district office 48 hours prior to workover or re-entry;
- Submit plugging report (CP-4) after plugging is completed;
- Obtain written approval before disposing or injecting salt water.

If this permit has expired (See: authorized expiration date) please check the box below and return to the address below.
 Well Not Drilled - Permit Expired
 Signature of Operator or Agent: _____
 Date: _____

1
 31
 2/E

IN ALL CASES PLOT THE INTENDED WELL ON THE PLAT BELOW

Plat of acreage attributable to a well in a prorated or spaced field

If the intended well is in a prorated or spaced field, please fully complete this side of the form. If the intended well is in a prorated or spaced field complete the plat below showing that the well will be properly located in relationship to other wells producing from the common source of supply. Please show all the wells and within 1 mile of the boundaries of the proposed acreage attribution unit for gas wells and within 1/2 mile of the boundaries of the proposed acreage attribution unit for oil wells.

API No. 15 - 037-21926-0000
 Operator: William T. Wax
 Lease: Mullen
 Well Number: F81
 Field: McCune
 Number of Acres attributable to well: _____
 QTR / QTR / QTR of acreage: W2W2 - E2NE - SE

Location of Well: County: Crawford
 1980 _____ feet from N / S Line of Section
 577.5 _____ feet from E / W Line of Section
 Sec. 1 Twp. 31 S. R. 21 East West

Is Section: Regular or Irregular

If Section is Irregular, locate well from nearest corner boundary.

Section corner used: NE NW SE SW

PLAT

(Show location of the well and shade attributable acreage for prorated or spaced wells.)

(Show footage to the nearest lease or unit boundary line.)

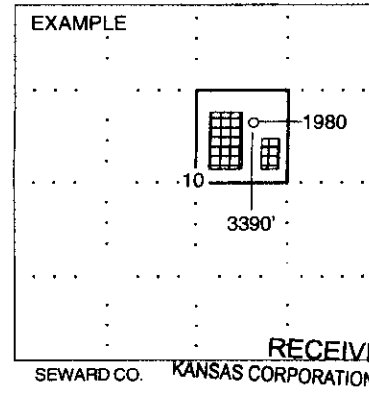
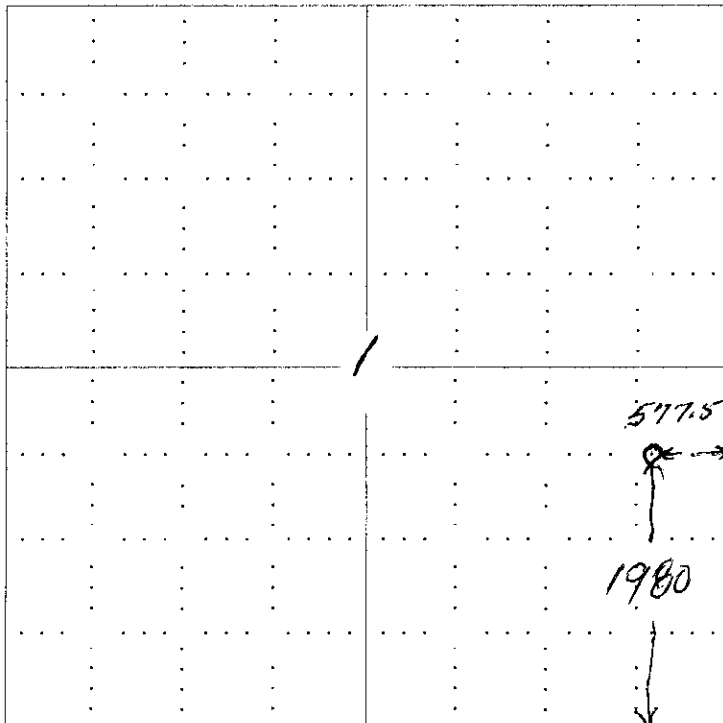

NOTE: In all cases locate the spot of the proposed drilling location.

JUL 18 2007

In plotting the proposed location of the well, you must show:

1. The manner in which you are using the depicted plat by identifying section lines, i.e. 1 section, 1 section with 8 surrounding sections, 4 sections, etc.
2. The distance of the proposed drilling location from the section's south / north and east / west.
3. The distance to the nearest lease or unit boundary line.
4. If proposed location is located within a prorated or spaced field a certificate of acreage attribution plat must be attached: (CO-7 for oil wells; CG-8 for gas wells).

CONSERVATION DIVISION
 WICHITA, KS

**KANSAS CORPORATION COMMISSION
OIL & GAS CONSERVATION DIVISION
APPLICATION FOR SURFACE PIT**

Form CDP-1
April 2004
Form must be Typed

Submit in Duplicate

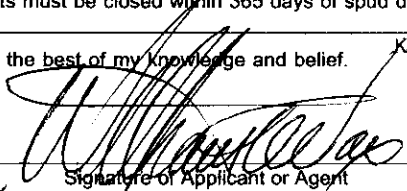
| | | |
|--|---|---|
| Operator Name: William T. Wax | | License Number: 3473 |
| Operator Address: P. O. Box 276, McCune, KS 66753 | | |
| Contact Person: Bill Wax | | Phone Number: (620) 724 - 3400 |
| Lease Name & Well No.: Mullen F81 | | Pit Location (QQQQ): W2W2 E2 NE SE |
| Type of Pit: <input type="checkbox"/> Emergency Pit <input type="checkbox"/> Burn Pit <input type="checkbox"/> Settling Pit <input checked="" type="checkbox"/> Drilling Pit <input type="checkbox"/> Workover Pit <input type="checkbox"/> Haul-Off Pit <small>(If WP Supply API No. or Year Drilled)</small> | Pit is: <input checked="" type="checkbox"/> Proposed <input type="checkbox"/> Existing If Existing, date constructed: _____ Pit capacity: 80 (bbls) | Sec. 1 Twp. 31 R. 21 <input checked="" type="checkbox"/> East <input type="checkbox"/> West 1980 Feet from <input type="checkbox"/> North / <input checked="" type="checkbox"/> South Line of Section 577.5 Feet from <input checked="" type="checkbox"/> East / <input type="checkbox"/> West Line of Section Crawford County |
| Is the pit located in a Sensitive Ground Water Area? <input checked="" type="checkbox"/> Yes <input checked="" type="checkbox"/> No | | Chloride concentration: _____ mg/l <small>(For Emergency Pits and Settling Pits only)</small> |
| Is the bottom below ground level? <input checked="" type="checkbox"/> Yes <input type="checkbox"/> No | Artificial Liner? <input type="checkbox"/> Yes <input checked="" type="checkbox"/> No | How is the pit lined if a plastic liner is not used? Native Clay |
| Pit dimensions (all but working pits): 25 Length (feet) 3 Width (feet) N/A: Steel Pits Depth from ground level to deepest point: 6 (feet) | | |
| If the pit is lined give a brief description of the liner material, thickness and installation procedure. N/A | | Describe procedures for periodic maintenance and determining liner integrity, including any special monitoring. N/A |
| Distance to nearest water well within one-mile of pit <input checked="" type="checkbox"/> N/A feet Depth of water well _____ feet | | Depth to shallowest fresh water unknown feet. Source of information: _____ measured _____ well owner _____ electric log _____ KDWR |
| Emergency, Settling and Burn Pits ONLY: Producing Formation: _____ Number of producing wells on lease: _____ Barrels of fluid produced daily: _____ Does the slope from the tank battery allow all spilled fluids to flow into the pit? <input type="checkbox"/> Yes <input type="checkbox"/> No | | Drilling, Workover and Haul-Off Pits ONLY: Type of material utilized in drilling/workover: AIR Number of working pits to be utilized: 1 Abandonment procedure: Backfill when dry Drill pits must be closed within 365 days of spud date. |
| I hereby certify that the above statements are true and correct to the best of my knowledge and belief. | | RECEIVED KANSAS CORPORATION COMMISSION JUL 18 2007 CONSERVATION DIVISION WICHITA, KS |
| Date: 07/16/07 | | Signature of Applicant or Agent:  |
| KCC OFFICE USE ONLY | | |
| Date Received: 7/18/07 | Permit Number: _____ | Permit Date: 7/18/07 Lease Inspection: <input type="checkbox"/> Yes <input checked="" type="checkbox"/> No |

15-037-21926-0000