

For KCC Use: 7-25-07  
 Effective Date: \_\_\_\_\_  
 District #: 1  
 SGA?  Yes  No

**KANSAS CORPORATION COMMISSION  
 OIL & GAS CONSERVATION DIVISION**

Form C-1  
 December 2002  
**Form must be Typed**  
**Form must be Signed**  
**All blanks must be Filled**

**NOTICE OF INTENT TO DRILL**

*Must be approved by KCC five (5) days prior to commencing well*

Expected Spud Date July 27, 2007  
 month day year

OPERATOR: License# 5123  
 Name: Pickrell Drilling Company, Inc.  
 Address: 100 S. Main, Suite 505  
 City/State/Zip: Wichita, Kansas 67202  
 Contact Person: Larry J. Richardson  
 Phone: 316-262-8427

CONTRACTOR: License# 5123  
 Name: Company Tools

<b>Well Drilled For:</b>	<b>Well Class:</b>	<b>Type Equipment:</b>
<input checked="" type="checkbox"/> Oil	<input checked="" type="checkbox"/> Infield	<input checked="" type="checkbox"/> Mud Rotary
<input type="checkbox"/> Gas	<input type="checkbox"/> Pool Ext.	<input type="checkbox"/> Air Rotary
<input type="checkbox"/> CWO	<input type="checkbox"/> Wildcat	<input type="checkbox"/> Cable
<input type="checkbox"/> Seismic; # of Holes	<input type="checkbox"/> Other	
<input type="checkbox"/> Other		

If OWWO: old well information as follows:  
 Operator: \_\_\_\_\_  
 Well Name: \_\_\_\_\_  
 Original Completion Date: \_\_\_\_\_ Original Total Depth: \_\_\_\_\_  
 Directional, Deviated or Horizontal wellbore?  Yes  No  
 If Yes, true vertical depth: \_\_\_\_\_  
 Bottom Hole Location: \_\_\_\_\_  
 KCC DKT #: \_\_\_\_\_

Spot 110' W N/2 N/2 SE Sec. 24 Twp. 17 S. R. 26  East  West  
2310' feet from  N /  S Line of Section  
1430' feet from  E /  W Line of Section  
 Is SECTION  Regular  Irregular?

(Note: Locate well on the Section Plat on reverse side)  
 County: Ness  
 Lease Name: Popp "A" Well #: 4  
 Field Name: Lazy 17  
 Is this a Prorated / Spaced Field?  Yes  No  
 Target Formation(s): Mississippian  
 Nearest Lease or unit boundary: 330'  
 Ground Surface Elevation: 2420' est. feet MSL  
 Water well within one-quarter mile:  Yes  No  
 Public water supply well within one mile:  Yes  No  
 Depth to bottom of fresh water: 180'  
 Depth to bottom of usable water: 1000'  
 Surface Pipe by Alternate:  1  2  
 Length of Surface Pipe Planned to be set: 200' +  
 Length of Conductor Pipe required: \_\_\_\_\_  
 Projected Total Depth: 4400'  
 Formation at Total Depth: Mississippian  
 Water Source for Drilling Operations:  
 Well  Farm Pond  Other X  
 DWR Permit #: \_\_\_\_\_  
 (Note: Apply for Permit with DWR )  
 Will Cores be taken?  Yes  No  
 If Yes, proposed zone: \_\_\_\_\_

**AFFIDAVIT**

RECEIVED  
 KANSAS CORPORATION COMMISSION

JUL 03 2007

CONSERVATION DIVISION  
 WICHITA, KS

The undersigned hereby affirms that the drilling, completion and eventual plugging of this well will comply with K.S.A. 55 et. seq.  
 It is agreed that the following minimum requirements will be met:

1. Notify the appropriate district office **prior** to spudding of well;
2. A copy of the approved notice of intent to drill **shall be** posted on each drilling rig;
3. The minimum amount of surface pipe as specified below **shall be set** by circulating cement to the top; in all cases surface pipe through all unconsolidated materials plus a minimum of 20 feet into the underlying formation.
4. If the well is dry hole, an agreement between the operator and the district office on plug length and placement is necessary **prior to plugging**;
5. The appropriate district office will be notified before well is either plugged or production casing is cemented in;
6. If an ALTERNATE II COMPLETION, production pipe shall be cemented from below any usable water to surface within **120 days** of spud date. Or pursuant to Appendix "B" - Eastern Kansas surface casing order #133,891-C, which applies to the KCC District 3 area, alternate II cementing must be completed within 30 days of the spud date or the well shall be plugged. **In all cases, NOTIFY district office** prior to any cementing.

I hereby certify that the statements made herein are true and to the best of my knowledge and belief.  
 Date: July 3, 2007 Signature of Operator or Agent: [Signature] Title: Geologist

**For KCC Use ONLY**  
 API # 15 - 135-24679-0000  
 Conductor pipe required None feet  
 Minimum surface pipe required 200 feet per Alt. X 2  
 Approved by: [Signature] 7-20-07  
 This authorization expires: 1-30-08  
 (This authorization void if drilling not started within 6 months of approval date.)  
 Spud date: \_\_\_\_\_ Agent: \_\_\_\_\_

**Remember to:**

- File Drill Pit Application (form CDP-1) with Intent to Drill;
- File Completion Form ACO-1 within 120 days of spud date;
- File acreage attribution plat according to field proration orders;
- Notify appropriate district office 48 hours prior to workover or re-entry;
- Submit plugging report (CP-4) after plugging is completed;
- Obtain written approval before disposing or injecting salt water.

- If this permit has expired (See: authorized expiration date) please check the box below and return to the address below.  
 Well Not Drilled - Permit Expired  
 Signature of Operator or Agent: \_\_\_\_\_  
 Date: \_\_\_\_\_

Mail to: KCC - Conservation Division, 130 S. Market - Room 2078, Wichita, Kansas 67202

24 17 26W

**IN ALL CASES PLOT THE INTENDED WELL ON THE PLAT BELOW**

*Plat of acreage attributable to a well in a prorated or spaced field*

**If the intended well is in a prorated or spaced field, please fully complete this side of the form.** If the intended well is in a prorated or spaced field complete the plat below showing that the well will be properly located in relationship to other wells producing from the common source of supply. Please show all the wells and within 1 mile of the boundaries of the proposed acreage attribution unit for gas wells and within 1/2 mile of the boundaries of the proposed acreage attribution unit for oil wells.

API No. 15 - 135-24679-0000  
 Operator: Pickrell Drilling Company, Inc.  
 Lease: Popp "A"  
 Well Number: 4  
 Field: Lazy 17  
 Number of Acres attributable to well: \_\_\_\_\_  
 QTR / QTR / QTR of acreage: 110' W - N/2 N/2 - SE

Location of Well: County: Ness  
2310' feet from  N /  S Line of Section  
1430' feet from  E /  W Line of Section  
 Sec. 24 Twp. 17 S. R. 26  East  West

Is Section:  Regular or  Irregular

**If Section is Irregular, locate well from nearest corner boundary.**

Section corner used:  NE  NW  SE  SW

**PLAT**

*(Show location of the well and shade attributable acreage for prorated or spaced wells.)  
 (Show footage to the nearest lease or unit boundary line.)*

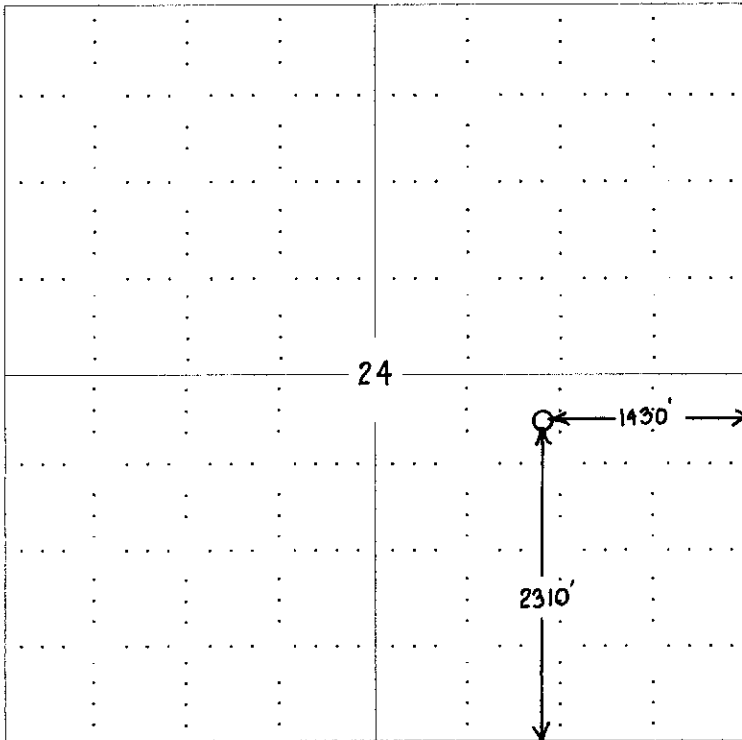

**NOTE: In all cases locate the spot of the proposed drilling location.**

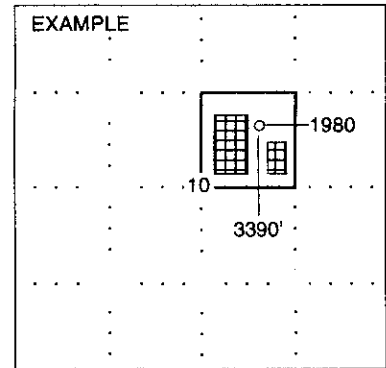

RECEIVED  
 KANSAS CORPORATION COMMISSION

**JUL 03 2007**

**In plotting the proposed location of the well, you must show:**

1. The manner in which you are using the depicted plat by identifying section lines, i.e. 1 section, 1 section with 8 surrounding sections, 4 sections, etc.
2. The distance of the proposed drilling location from the section's south / north and east / west.
3. The distance to the nearest lease or unit boundary line.
4. If proposed location is located within a prorated or spaced field a certificate of acreage attribution plat must be attached: (C0-7 for oil wells; CG-8 for gas wells).

CONSERVATION DIVISION  
 WICHITA, KS

**KANSAS CORPORATION COMMISSION  
OIL & GAS CONSERVATION DIVISION  
APPLICATION FOR SURFACE PIT**

Form GDP-1  
April 2004  
Form must be Typed

*Submit in Duplicate*

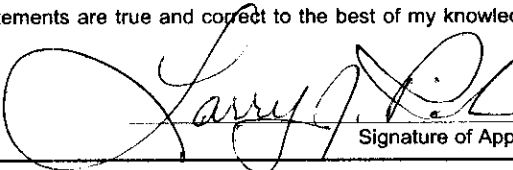
Operator Name: <b>Pickrell Drilling Company, Inc.</b>		License Number: <b>5123</b>
Operator Address: <b>100 S. Main, Suite 505 - Wichita, Kansas 67202</b>		
Contact Person: <b>Mike Kern</b>		Phone Number: ( <b>620</b> ) <b>793 - 5742</b>
Lease Name & Well No.: <b>#4 Popp "A"</b>		Pit Location (QQQQ): <b>110°W N/2 N/2 SE</b>
Type of Pit: <input type="checkbox"/> Emergency Pit <input type="checkbox"/> Burn Pit <input type="checkbox"/> Settling Pit <input checked="" type="checkbox"/> Drilling Pit <input type="checkbox"/> Workover Pit <input type="checkbox"/> Haul-Off Pit <small>(If WP Supply API No. or Year Drilled)</small>	Pit is: <input checked="" type="checkbox"/> Proposed <input type="checkbox"/> Existing If Existing, date constructed: _____ Pit capacity: <b>1780</b> (bbls)	Sec. <b>24</b> Twp. <b>17S</b> R. <b>26</b> <input type="checkbox"/> East <input checked="" type="checkbox"/> West <b>2310'</b> Feet from <input type="checkbox"/> North / <input checked="" type="checkbox"/> South Line of Section <b>1430'</b> Feet from <input checked="" type="checkbox"/> East / <input type="checkbox"/> West Line of Section <b>Ness</b> _____ County
Is the pit located in a Sensitive Ground Water Area? <input checked="" type="checkbox"/> Yes <input checked="" type="checkbox"/> No		Chloride concentration: _____ mg/l <small>(For Emergency Pits and Settling Pits only)</small>
Is the bottom below ground level? <input checked="" type="checkbox"/> Yes <input type="checkbox"/> No	Artificial Liner? <input type="checkbox"/> Yes <input checked="" type="checkbox"/> No	How is the pit lined if a plastic liner is not used? <b>Bentonite Sealer</b>
Pit dimensions (all but working pits): <b>50'</b> Length (feet) <b>50'</b> Width (feet) <b>N/A: Steel Pits</b> Depth from ground level to deepest point: <b>4' aver.</b> (feet)		
If the pit is lined give a brief description of the liner material, thickness and installation procedure.		Describe procedures for periodic maintenance and determining liner integrity, including any special monitoring.
Distance to nearest water well within one-mile of pit <b>2860</b> feet    Depth of water well <b>40</b> feet		Depth to shallowest fresh water <b>18</b> feet. Source of information: _____ measured    _____ well owner    _____ electric log <b>(1) KDWR</b>
<b>Emergency, Settling and Burn Pits ONLY:</b> Producing Formation: _____ Number of producing wells on lease: _____ Barrels of fluid produced daily: _____ Does the slope from the tank battery allow all spilled fluids to flow into the pit? <input type="checkbox"/> Yes <input type="checkbox"/> No		<b>Drilling, Workover and Haul-Off Pits ONLY:</b> Type of material utilized in drilling/workover: <b>Fresh</b> Number of working pits to be utilized: <b>2</b> Abandonment procedure: <b>Allow to evaporate and backfill when sufficiently dry.</b> Drill pits must be closed within 365 days of spud date.
I hereby certify that the above statements are true and correct to the best of my knowledge and belief.		
July 3, 2007 Date	 Signature of Applicant or Agent	RECEIVED KANSAS CORPORATION COMMISSION <b>JUL 03 2007</b>
<b>KCC OFFICE USE ONLY</b>		
Date Received: <b>7/3/07</b>	Permit Number: _____	Permit Date: <b>7/20/07</b> Lease Inspection: <input checked="" type="checkbox"/> Yes <input type="checkbox"/> No

15-135-24679-0000

Mail to: KCC - Conservation Division, 130 S. Market - Room 2078, Wichita, Kansas 67202

July 20, 2007

Larry J Richardson  
Pickrell Drilling Company, Inc.  
100 S Main, Ste 505  
Wichita KS 67202

Re: Drilling Pit Application  
Popp A Lease Well No. 4  
SE/4 24-17S-26W  
Ness County, Kansas

Dear Mr. Richardson:

District staff has inspected the above referenced location and has determined that the reserve pit shall be constructed **without slots**, the bottom shall be flat and reasonably level, and the free fluids must be removed. The fluids are to be removed from the reserve pit as soon as practical after drilling operations have ceased.

**If production casing is set all completion fluids shall be removed from the working pits daily. NO completion fluids or non-exempt wastes shall be placed in the reserve pit.**

The fluids should be taken to an authorized disposal well. Please call the District Office at (620) 225-8888 when the fluids have been removed. Please file form CDP-5 (August 2004), Exploration and Production Waste Transfer, within 30 days of fluid removal. Conservation division forms are available through our office and on the KCC web site: <http://kcc.ks.gov/conservation/forms/>

**A copy of this letter should be posted in the doghouse along with the approved Intent to Drill.** If you have any questions or concerns please feel free to contact the undersigned at the above address.

Sincerely,



Jonelle Rains, Supervisor  
Department of Environmental Protection and Remediation

cc: Steve Durrant  
File