

IN ALL CASES PLOT THE INTENDED WELL ON THE PLAT BELOW

Show the relationship to other wells or facilities proposed to be serviced by the intended cathodic borehole. Please show all the wells, existing cathodic boreholes, pipelines or facilities within 1/2 mile of the proposed borehole.

API NO. 15- 113-21326-0000

OPERATOR MID-CONTINENT FRACTIONATION & STORAGE, LLC LOCATION OF WELL: COUNTY MCPHERSON
 LEASE CONWAY 203 feet from south/north line of section
 WELL NUMBER 17A 1122 feet from east/west line of section
 FACILITY NAME CONWAY SECTION 23 TWP 19-S RG 5 WEST

SPOT: QTR/QTR/QTR/QTR OF ACREAGE
NW - NE - NE -

IS SECTION X REGULAR or IRREGULAR
IF SECTION IS IRREGULAR, LOCATE WELL FROM NEAREST
CORNER BOUNDARY.
 Section corner used: X NE NW SE SW

PLAT

(Show location of intended cathodic borehole.)

(Show footage from nearest lease, unit or outside section boundary line.)

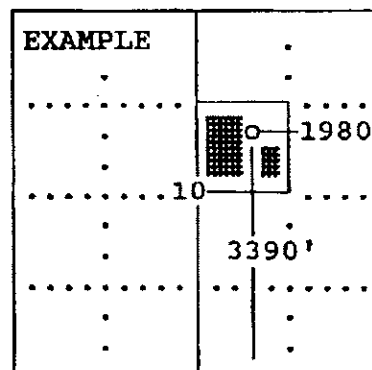
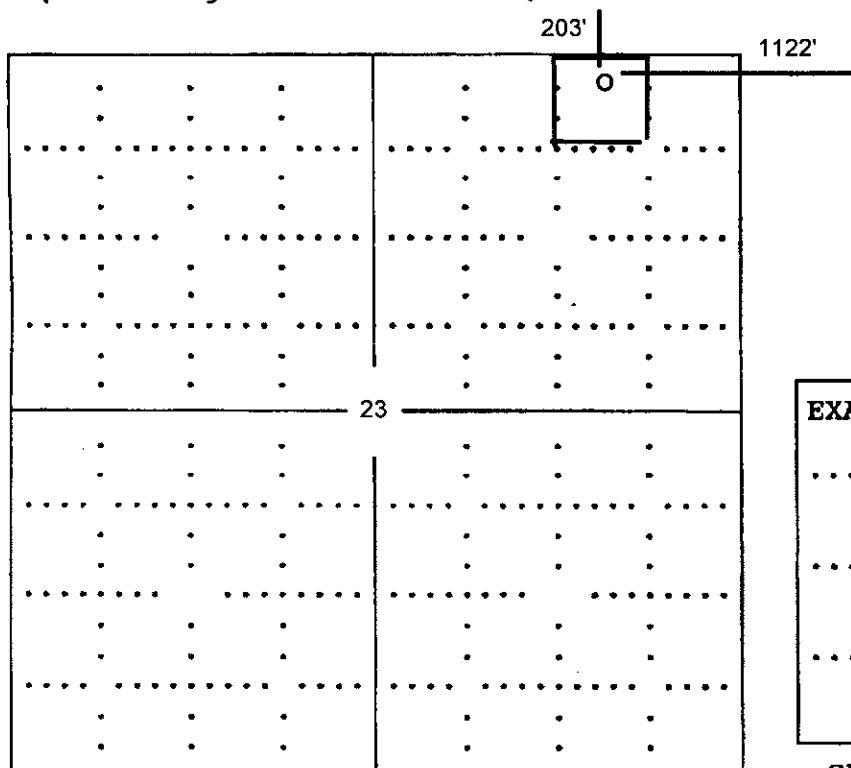

SEWARD CO.

In plotting the proposed location of the well, you must show:

- 1) The manner in which you are using the depicted plat by identifying section lines, i.e. 1 section, 1 section with 8 surrounding sections, 4 sections, etc.;
- 2) the distance of the proposed drilling location from the section's south/north and east/west; and
- 3) the distance to the nearest lease, unit or outside section boundary line.

RECEIVED
 KANSAS CORPORATION COMMISSION

AUG 03 2007

CONSERVATION DIVISION
 WICHITA, KS

**KANSAS CORPORATION COMMISSION
OIL & GAS CONSERVATION DIVISION
APPLICATION FOR SURFACE POND**

Form CDP-1
January 2001
Form must be Typed

Submit in Duplicate

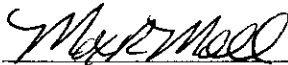
Operator Name: Mid-Continent Fractionation & Storage, LLC		License Number: 33471
Operator Address: PO BOX 21628 MD 27 TULSA, OK 74172		
Contact Person: PAT RICE		Phone Number: (918) 573-0419
Lease Name: CONWAY 17A		Pit Location:
Type of Pond: _____ Emergency Pit _____ Treatment Pit _____ Workover Pit <input checked="" type="checkbox"/> Drilling Pit _____ Burn Pit <small>(If WP Supply API No. or Year Drilled)</small>	Pit is: <input checked="" type="checkbox"/> Proposed _____ Existing If Existing, date constructed: _____ Pit capacity: _____ (bbls)	NE Qtr. Sec. 23 Twp. 19S R. 5W <input type="checkbox"/> E <input checked="" type="checkbox"/> W 203' Feet from (N) S (circle one) Line of Section 1122' Feet from (E) W (circle one) Line of Section MCPHERSON County
Is the pit located in a Sensitive Ground Water Area? <input type="checkbox"/> Yes <input checked="" type="checkbox"/> No		Chloride concentration: _____ mg/l <small>(For Emergency Pits and Treatment Pits only)</small>
Is the bottom below ground level? <input checked="" type="checkbox"/> Yes <input type="checkbox"/> No	Artificial Liner? <input checked="" type="checkbox"/> Yes <input type="checkbox"/> No	How is the pit lined if a plastic liner is not used?
Pit dimensions (all but working pits): <u>15</u> Length (feet) <u>6</u> Width (feet) Depth from ground level to deepest point: <u>6</u> (feet)		
If the pit is lined give a brief description of the liner material, thickness and installation procedure. <u>6M clear plastic liner, layed in pit and edges secured to pit</u>		Describe procedures for periodic maintenance and determining liner integrity, including any special monitoring. <u>Pit will only be used for 3-4 days</u>
Distance to nearest water well within one-mile of pit <u>798</u> feet Depth of water well <u>123</u> feet		Depth to shallowest fresh water <u>109</u> feet. Source of information: _____ measured _____ well owner _____ electric log <input checked="" type="checkbox"/> KOWR
Emergency, Treatment and Burn Pits ONLY: Producing Formation: _____ Number of producing wells on lease: _____ Barrels of fluid produced daily: _____ Does the slope from the tank battery allow all spilled fluids to flow into the pond? <input type="checkbox"/> Yes <input type="checkbox"/> No		Drilling and Workover Pits ONLY: Type of material utilized in drilling/workover: _____ Number of working pits to be utilized: <u>1</u> Abandonment procedure: <u>Fluids will be pumped out and liner folded and backfilled.</u> Drill pits must be closed within 365 days of spud date.
I hereby certify that the above statements are true and correct to the best of my knowledge and belief. <u>08/02/2007</u> Date		<div style="text-align: right;">  Signature of Applicant or Agent </div> <div style="text-align: right;"> AUG 03 2007 CONSERVATION DIVISION WICHITA, KS </div>

KCC OFFICE USE ONLY

Date Received: 8/3/07 Permit Number: _____ Permit Date: 8/3/07 Lease Inspection: ☐ Yes ☒ No

Mail to: KCC - Conservation Division, 130 S. Market - Room 2078, Wichita, Kansas 67202

Thu, 8/2/2007 12:13 PM