

For KCC Use:  
 Effective Date: 8-11-07  
 District # 4  
 SGA?  Yes  No

KANSAS CORPORATION COMMISSION  
 OIL & GAS CONSERVATION DIVISION

Form C-1

December 2002

Form must be Typed  
 Form must be Signed  
 All blanks must be Filled

**NOTICE OF INTENT TO DRILL**

Must be approved by KCC five (5) days prior to commencing well

Expected Spud Date August 8, 2007  
 month day year

OPERATOR: License# 5056 ✓  
 Name: F.G. Holl Company, L.L.C.  
 Address: 9431 E. Central, Suite 100  
Wichita, Kansas, 67206  
 City/State/Zip:  
 Contact Person: Franklin R. Greenbaum  
 Phone: (316) 684-8481

CONTRACTOR: License# 33323 ✓  
 Name: Petromark, Rig 2

|   |   |  |
|---|---|--|
| <b>Well Drilled For:</b>  | <b>Well Class:</b>                          | <b>Type Equipment:</b>                         |
| <input checked="" type="checkbox"/> Oil <input checked="" type="checkbox"/> Enh Rec | <input checked="" type="checkbox"/> Infield | <input checked="" type="checkbox"/> Mud Rotary |
| <input checked="" type="checkbox"/> Gas <input type="checkbox"/> Storage            | <input type="checkbox"/> Pool Ext.          | <input type="checkbox"/> Air Rotary            |
| <input type="checkbox"/> OWO <input type="checkbox"/> Disposal                      | <input type="checkbox"/> Wildcat            | <input type="checkbox"/> Cable                 |
| <input type="checkbox"/> Seismic; # of Holes  | <input type="checkbox"/> Other              |  |
| <input type="checkbox"/> Other  |   |  |

If OWWO: old well information as follows:  
 Operator: \_\_\_\_\_  
 Well Name: \_\_\_\_\_  
 Original Completion Date: \_\_\_\_\_ Original Total Depth: \_\_\_\_\_  
 Directional, Deviated or Horizontal wellbore?  Yes  No  
 If Yes, true vertical depth: \_\_\_\_\_  
 Bottom Hole Location: \_\_\_\_\_  
 KCC DKT #: \_\_\_\_\_

Spot ISO E. of  
 C W/2 NW - NW Sec. 17 Twp. 20S S. R. 13W  East  West  
660 feet from  N /  S Line of Section  
480 feet from  E /  W Line of Section  
 Is SECTION  Regular  Irregular?

(Note: Locate well on the Section Plat on reverse side)  
 County: Barton  
 Lease Name: D. ROACH Well #: 1-17  
 Field Name: Harrison  
 Is this a Prorated / Spaced Field?  Yes  No  
 Target Formation(s): Lansing Kansas City & Arbuckle  
 Nearest Lease or unit boundary: 480'  
 Ground Surface Elevation: 1886' Estimated feet MSL  
 Water well within one-quarter mile:  Yes  No  
 Public water supply well within one mile:  Yes  No  
 Depth to bottom of fresh water: 200'  
 Depth to bottom of usable water: 240'  
 Surface Pipe by Alternate:  1  2  
 Length of Surface Pipe Planned to be set: 780'  
 Length of Conductor Pipe required: None  
 Projected Total Depth: 3650'  
 Formation at Total Depth: Arbuckle  
 Water Source for Drilling Operations:  
 Well  Farm Pond  Other  
 DWR Permit #: \_\_\_\_\_ (Contractor will apply)  
 (Note: Apply for Permit with DWR )  
 Will Cores be taken?  Yes  No  
 If Yes, proposed zone: \_\_\_\_\_

**AFFIDAVIT**

RECEIVED

The undersigned hereby affirms that the drilling, completion and eventual plugging of this well will comply with K.S.A. 48-201. It is agreed that the following minimum requirements will be met:

AUG 03 2007

1. Notify the appropriate district office **prior** to spudding of well;
2. A copy of the approved notice of intent to drill **shall be** posted on each drilling rig;
3. The minimum amount of surface pipe as specified below **shall be set** by circulating cement to the top; in all cases surface pipe shall be set through all unconsolidated materials plus a minimum of 20 feet into the underlying formation.
4. If the well is dry hole, an agreement between the operator and the district office on plug length and placement is necessary **prior to plugging**;
5. The appropriate district office will be notified before well is either plugged or production casing is cemented in;
6. If an ALTERNATE II COMPLETION, production pipe shall be cemented from below any usable water to surface within **120 days** of spud date. Or pursuant to Appendix "B" - Eastern Kansas surface casing order #133,891-C, which applies to the KCC District 3 area, alternate II cementing must be completed within 30 days of the spud date or the well shall be plugged. **In all cases, NOTIFY district office** prior to any cementing.

I hereby certify that the statements made herein are true and to the best of my knowledge and belief.  
 Date: 8/3/2007 Signature of Operator or Agent: Franklin R. Greenbaum Title: Exploration Manager

**For KCC Use ONLY**  
 API # 15 - 009-25085-0000  
 Conductor pipe required None feet  
 Minimum surface pipe required 260 feet per Alt. 1  
 Approved by: 8-6-07  
 This authorization expires: 2-6-08  
 (This authorization void if drilling not started within 6 months of approval date.)  
 Spud date: \_\_\_\_\_ Agent: \_\_\_\_\_

**Remember to:**

- File Drill Pit Application (form CDP-1) with Intent to Drill;
- File Completion Form ACO-1 within 120 days of spud date;
- File acreage attribution plat according to field proration orders;
- Notify appropriate district office 48 hours prior to workover or re-entry;
- Submit plugging report (CP-4) after plugging is completed;
- Obtain written approval before disposing or injecting salt water.
- If this permit has expired (See: authorized expiration date) please check the box below and return to the address below.

Well Not Drilled - Permit Expired  
 Signature of Operator or Agent: \_\_\_\_\_  
 Date: \_\_\_\_\_

Mail to: KCC - Conservation Division, 130 S. Market - Room 2078, Wichita, Kansas 67202

17 20 13W

**IN ALL CASES PLOT THE INTENDED WELL ON THE PLAT BELOW**

*Plat of acreage attributable to a well in a prorated or spaced field*

**If the intended well is in a prorated or spaced field, please fully complete this side of the form.** If the intended well is in a prorated or spaced field complete the plat below showing that the well will be properly located in relationship to other wells producing from the common source of supply. Please show all the wells and within 1 mile of the boundaries of the proposed acreage attribution unit for gas wells and within 1/2 mile of the boundaries of the proposed acreage attribution unit for oil wells.

API No. 15 - 009-25085-0000  
 Operator: F.G. Holl Company, L.L.C.  
 Lease: D. ROACH  
 Well Number: 1-17  
 Field: Harrison  
 Number of Acres attributable to well: \_\_\_\_\_  
 QTR / QTR / QTR of acreage:    C W/2    -    NW    -    NW

Location of Well: County: Barton  
 660 \_\_\_\_\_ feet from  N /  S Line of Section  
 480 \_\_\_\_\_ feet from  E /  W Line of Section  
 Sec. 17 Twp. 20S S. R. 13W  East  West

Is Section:  Regular or  Irregular

**If Section is Irregular, locate well from nearest corner boundary.**

Section corner used:  NE  NW  SE  SW

**PLAT**

*(Show location of the well and shade attributable acreage for prorated or spaced wells.)  
 (Show footage to the nearest lease or unit boundary line.)*

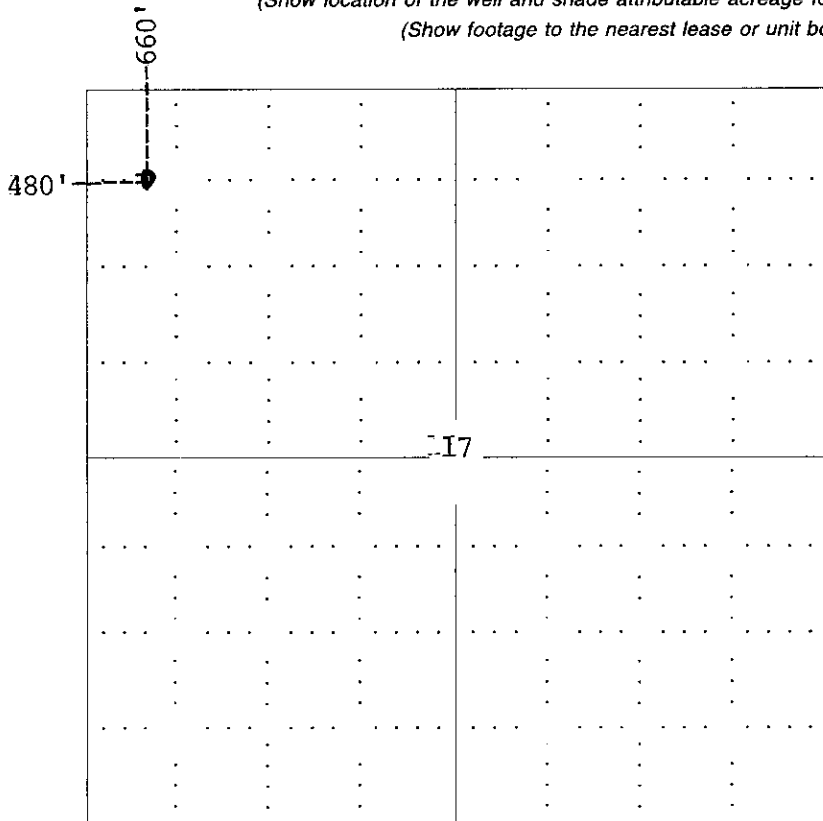

RECEIVED  
 KANSAS CORPORATION COMMISSION

**AUG 03 2007**

CONSERVATION DIVISION  
 WICHITA, KS

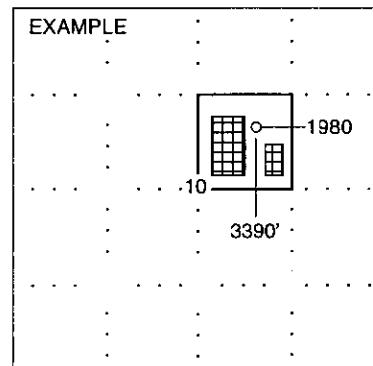

SEWARD CO.

**NOTE: In all cases locate the spot of the proposed drilling locaton.**

**In plotting the proposed location of the well, you must show:**

1. The manner in which you are using the depicted plat by identifying section lines, i.e. 1 section, 1 section with 8 surrounding sections, 4 sections, etc.
2. The distance of the proposed drilling location from the section's south / north and east / west.
3. The distance to the nearest lease or unit boundary line.
4. If proposed location is located within a prorated or spaced field a certificate of acreage attribution plat must be attached: (CO-7 for oil wells; CG-8 for gas wells).

KANSAS CORPORATION COMMISSION  
OIL & GAS CONSERVATION DIVISION

AUG 13 2007

Form CDP-1  
April 2004  
Form must be Typed

APPLICATION FOR SURFACE PIT

Submit in Duplicate

|  |  |   |
|--|--|---|
| Operator Name: <b>F.G. Holl Company, L.L.C.</b>  |  | License Number: <b>5056</b>   |
| Operator Address: <b>9431 E. Central, Suite 100, Wichita, Kansas 67206</b>   |  |   |
| Contact Person: <b>Franklin R. Greenbaum</b>   |  | Phone Number: ( <b>316</b> ) <b>684 - 8481</b>  |
| Lease Name & Well No.: <b>D. ROACH NO. 1-17</b>  |  | Pit Location (QQQQ):<br><b>W/2 - NW - NW</b>  |
| Type of Pit:<br><input type="checkbox"/> Emergency Pit <input type="checkbox"/> Burn Pit<br><input type="checkbox"/> Settling Pit <input checked="" type="checkbox"/> Drilling Pit<br><input type="checkbox"/> Workover Pit <input type="checkbox"/> Haul-Off Pit<br><small>(If WP Supply API No. or Year Drilled)</small> | Pit is:<br><input checked="" type="checkbox"/> Proposed <input type="checkbox"/> Existing<br>If Existing, date constructed:<br>_____<br>Pit capacity:<br><b>500</b> (bbls) | Sec. <b>17</b> Twp. <b>20S</b> R. <b>13W</b> <input type="checkbox"/> East <input checked="" type="checkbox"/> West<br><b>660</b> Feet from <input type="checkbox"/> North / <input type="checkbox"/> South Line of Section<br><b>480</b> Feet from <input type="checkbox"/> East / <input type="checkbox"/> West Line of Section<br><b>Barton</b> County |
| Is the pit located in a Sensitive Ground Water Area? <input checked="" type="checkbox"/> Yes <input type="checkbox"/> No   |  | Chloride concentration: _____ mg/l<br><small>(For Emergency Pits and Settling Pits only)</small>  |
| Is the bottom below ground level?<br><input checked="" type="checkbox"/> Yes <input type="checkbox"/> No   | Artificial Liner?<br><input type="checkbox"/> Yes <input checked="" type="checkbox"/> No   | How is the pit lined if a plastic liner is not used?<br><b>Mud &amp; natural clays</b>  |
| Pit dimensions (all but working pits): <b>150</b> Length (feet) <b>150</b> Width (feet) <b>N/A: Steel Pits</b><br>Depth from ground level to deepest point: <b>4</b> (feet)  |  |   |
| If the pit is lined give a brief description of the liner material, thickness and installation procedure.  |  | Describe procedures for periodic maintenance and determining liner integrity, including any special monitoring.   |
| Distance to nearest water well within one-mile of pit<br><b>311</b> feet    Depth of water well <b>50</b> feet   |  | Depth to shallowest fresh water <b>19</b> feet.    /<br>Source of information: <b>JR KGS</b><br>_____ measured _____ well owner _____ electric log _____ KDWR   |
| <b>Emergency, Settling and Burn Pits ONLY:</b><br>Producing Formation: _____<br>Number of producing wells on lease: _____<br>Barrels of fluid produced daily: _____<br>Does the slope from the tank battery allow all spilled fluids to flow into the pit? <input type="checkbox"/> Yes <input type="checkbox"/> No        |  | <b>Drilling, Workover and Haul-Off Pits ONLY:</b><br>Type of material utilized in drilling/workover: <b>Fresh Mud</b><br>Number of working pits to be utilized: <b>3</b><br>Abandonment procedure: <b>Backfill rotary pits, rip and smooth location</b><br>_____<br>Drill pits must be closed within 365 days of spud date.                               |
| I hereby certify that the above statements are true and correct to the best of my knowledge and belief.<br><br>Date: <b>8/3/2007</b> Signature: <b>Franklin R. Greenbaum</b><br>_____<br>Date    Signature of Applicant or Agent   |  |   |

15-008-25085-0000

|                              |                      |  |
|------------------------------|----------------------|--|
| <b>KCC OFFICE USE ONLY</b>   |                      | <i>Call center send REASVC</i>   |
| Date Received: <b>8/3/07</b> | Permit Number: _____ | Permit Date: <b>8/6/07</b> Lease Inspection: <input checked="" type="checkbox"/> Yes <input type="checkbox"/> No |



*Kathleen Sebelius, Governor  
Thomas E. Wright, Chairman  
Robert E. Krehbiel, Commissioner  
Michael C. Moffet, Commissioner*

August 6, 2007

Mr. Franklin R. Greenbaum  
F.G. Holl Company, LLC  
9431 E. Central Ste 100  
Wichita, KS 67206

RE: Drilling Pit Application  
D. Roach Lease Well No. 1-17  
NW/4 Sec. 17-20S-13W  
Barton County, Kansas

Dear Mr. Greenbaum:

District staff has inspected the above referenced location and has determined that the reserve pit shall be constructed **without slots**, the bottom shall be flat and reasonably level, and **if sand is encountered during the construction of the reserve pit or working pits, please call the District Office at (785) 625-0550**. The fluids must be removed. The fluids are to be removed from the reserve pit as soon as the Hutchinson Salt section has been drilled through and displacement of the fluids into the reserve pit has occurred. The fluids should be removed again as soon as practical after drilling operations have ceased. **Please keep all pits away from any draws.**

**If production casing is set all completion fluids shall be removed from the working pits daily. NO completion fluids or non-exempt wastes shall be placed in the reserve pit.**

The fluids should be taken to an authorized disposal well. Please call the District Office at (785) 625-0550 when the fluids have been removed. Please file form CDP-5, Exploration and Production Waste Transfer, within 30 days of fluid removal. Conservation division forms are available through our office and on the KCC web site: [www.kcc.state.ks.us/conservation/forms](http://www.kcc.state.ks.us/conservation/forms).

**A copy of this letter should be posted in the doghouse along with the approved Intent to Drill.**

If you have any questions or concerns please feel free to contact the undersigned at the above address.

Sincerely,

A handwritten signature in black ink that reads "Kathy Haynes".

Kathy Haynes  
Environmental Protection and Remediation Department

cc: File