



For KCC Use: 8-12-07  
 Effective Date: \_\_\_\_\_  
 District # 1  
 SGA?  Yes  No

KANSAS CORPORATION COMMISSION 1011160  
 OIL & GAS CONSERVATION DIVISION

Form C-1  
 November 2005  
 Form must be Typed  
 Form must be Signed  
 All blanks must be Filled

**NOTICE OF INTENT TO DRILL**

Must be approved by KCC five (5) days prior to commencing well

Expected Spud Date: 08/24/2007  
 month day year

Spot Description: \_\_\_\_\_  
 \_\_\_\_\_ NW \_\_\_\_\_ NW Sec. 13 Twp. 35 S. R. 16  E  W  
 (a/a/a/a) 660 feet from  N /  S Line of Section  
660 feet from  E /  W Line of Section

OPERATOR: License# 8061  
 Name: Oil Producers Inc. of Kansas  
 Address 1: 1710 WATERFRONT PARKWAY  
 Address 2: \_\_\_\_\_  
 City: WICHITA State: KS Zip: 67206 + \_\_\_\_\_  
 Contact Person: Lori A. Zehr  
 Phone: 316-682-3022

Is SECTION:  Regular  Irregular?  
 (Note: Locate well on the Section Plat on reverse side)

CONTRACTOR: License# 5929  
 Name: Duke Drilling Co., Inc.

County: Comanche  
 Lease Name: Leon May Well #: 3-13  
 Field Name: YELLOWSTONE EAST  
 Is this a Prorated / Spaced Field?  Yes  No

Well Drilled For:	Well Class:	Type Equipment:
<input checked="" type="checkbox"/> Oil	<input type="checkbox"/> Enh Rec	<input checked="" type="checkbox"/> Mud Rotary
<input checked="" type="checkbox"/> Gas	<input type="checkbox"/> Storage	<input type="checkbox"/> Air Rotary
<input type="checkbox"/> Seismic ; _____ # of Holes	<input type="checkbox"/> Disposal	<input type="checkbox"/> Cable
<input type="checkbox"/> Other: _____	<input type="checkbox"/> Pool Ext.	
	<input type="checkbox"/> Wildcat	
	<input type="checkbox"/> Other	

Target Formation(s): Mississippi Warsaw  
 Nearest Lease or unit boundary line (in footage): 660  
 Ground Surface Elevation: 1842 feet MSL  
 Water well within one-quarter mile:  Yes  No  
 Public water supply well within one mile:  Yes  No  
 Depth to bottom of fresh water: 180  
 Depth to bottom of usable water: 180  
 Surface Pipe by Alternate:  I  II  
 Length of Surface Pipe Planned to be set: 670  
 Length of Conductor Pipe (if any): \_\_\_\_\_  
 Projected Total Depth: 5500  
 Formation at Total Depth: Mississippi Warsaw

If OWWO: old well information as follows:  
 Operator: \_\_\_\_\_  
 Well Name: \_\_\_\_\_  
 Original Completion Date: \_\_\_\_\_ Original Total Depth: \_\_\_\_\_

Water Source for Drilling Operations:  
 Well  Farm Pond  Other: Hauled  
 DWR Permit #: \_\_\_\_\_  
 (Note: Apply for Permit with DWR )  
 Will Cores be taken?  Yes  No  
 If Yes, proposed zone: \_\_\_\_\_

Directional, Deviated or Horizontal wellbore?  Yes  No  
 If Yes, true vertical depth: \_\_\_\_\_  
 Bottom Hole Location: \_\_\_\_\_  
 KCC DKT #: \_\_\_\_\_

**AFFIDAVIT**

RECEIVED  
 KANSAS CORPORATION COMMISSION

The undersigned hereby affirms that the drilling, completion and eventual plugging of this well will comply with K.S.A. 55 et. seq.  
 It is agreed that the following minimum requirements will be met:

AUG 07 2007

1. Notify the appropriate district office **prior** to spudding of well;
2. A copy of the approved notice of intent to drill **shall be** posted on each drilling rig;
3. The minimum amount of surface pipe as specified below **shall be set** by circulating cement to the top; in all cases surface pipe **shall be set** through all unconsolidated materials plus a minimum of 20 feet into the underlying formation.
4. If the well is dry hole, an agreement between the operator and the district office on plug length and placement is necessary **prior to plugging**;
5. The appropriate district office will be notified before well is either plugged or production casing is cemented in;
6. If an ALTERNATE II COMPLETION, production pipe shall be cemented from below any usable water to surface within **120 DAYS** of spud date. Or pursuant to Appendix "B" - Eastern Kansas surface casing order #133,891-C, which applies to the KCC District 3 area, alternate II cementing must be completed within 30 days of the spud date or the well shall be plugged. **In all cases, NOTIFY district office** prior to any cementing.

CONSERVATION DIVISION  
 WICHITA, KS

I hereby certify that the statements made herein are true and to the best of my knowledge and belief.

Date: 8.6.07 Signature of Operator or Agent: TJ. [Signature] Title: VICE PRESIDENT

**For KCC Use ONLY**  
 API # 15 - 033-21502-0000  
 Conductor pipe required 0 feet  
 Minimum surface pipe required 200 feet per ALT  I  II  
 Approved by: [Signature]  
 This authorization expires: 8-7-08  
 (This authorization void if drilling not started within 6 months of approval date.)  
 Spud date: \_\_\_\_\_ Agent: \_\_\_\_\_

- Remember to:**
- File Drill Pit Application (form CDP-1) with Intent to Drill;
  - File Completion Form ACO-1 within 120 days of spud date;
  - File acreage attribution plat according to field proration orders;
  - Notify appropriate district office 48 hours prior to workover or re-entry;
  - Submit plugging report (CP-4) after plugging is completed (within 60 days);
  - Obtain written approval before disposing or injecting salt water.
- If this permit has expired (See: authorized expiration date) please check the box below and return to the address below.  
 Well Not Drilled - Permit Expired Date: \_\_\_\_\_  
 Signature of Operator or Agent: \_\_\_\_\_

13  
 35  
 16  
 E  
 W



1011160

**IN ALL CASES PLOT THE INTENDED WELL ON THE PLAT BELOW**

*Plat of acreage attributable to a well in a prorated or spaced field*

**If the intended well is in a prorated or spaced field, please fully complete this side of the form.** If the intended well is in a prorated or spaced field complete the plat below showing that the well will be properly located in relationship to other wells producing from the common source of supply. Please show all the wells and within 1 mile of the boundaries of the proposed acreage attribution unit for gas wells and within 1/2 mile of the boundaries of the proposed acreage attribution unit for oil wells.

API No. 15 - 033-21502-0000  
Operator: Oil Producers Inc. of Kansas  
Lease: Leon May  
Well Number: 3-13  
Field: YELLOWSTONE EAST

Location of Well: County: Comanche  
660 feet from  N /  S Line of Section  
660 feet from  E /  W Line of Section  
Sec. 13 Twp. 35 S. R. 16  E  W

Number of Acres attributable to well: \_\_\_\_\_  
QTR/QTR/QTR/QTR of acreage: \_\_\_\_\_ - \_\_\_\_\_ - NW - NW

Is Section:  Regular or  Irregular

**If Section is Irregular, locate well from nearest corner boundary.**  
Section corner used:  NE  NW  SE  SW

**PLAT**

*(Show location of the well and shade attributable acreage for prorated or spaced wells.)  
(Show footage to the nearest lease or unit boundary line.)*

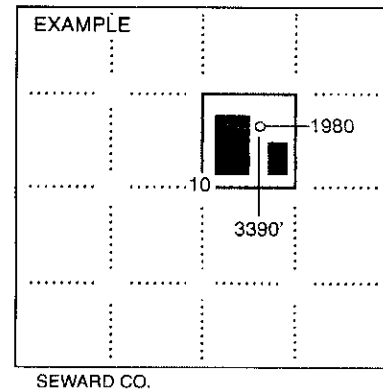
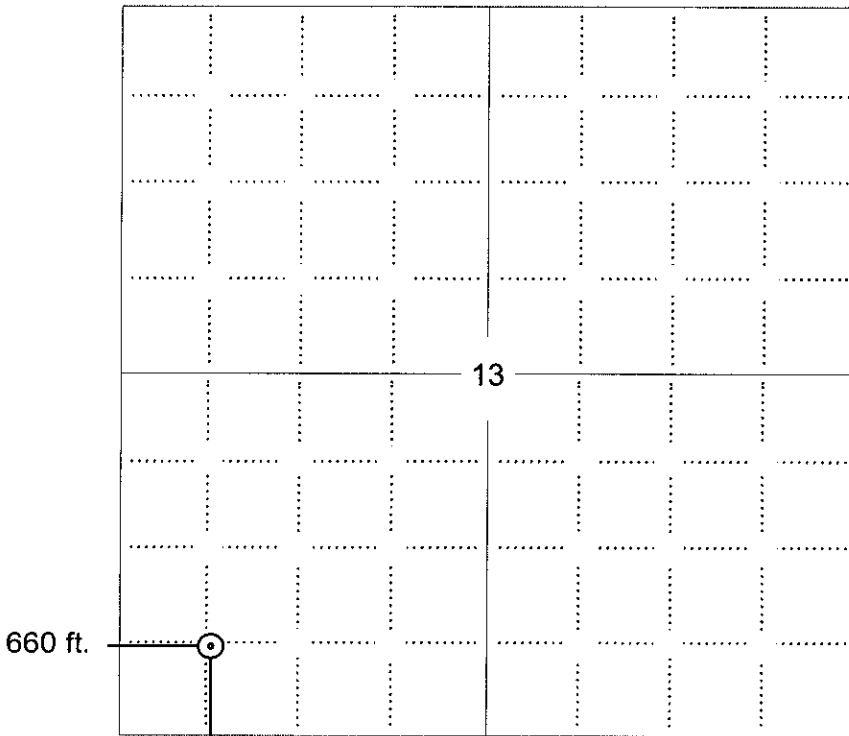

**NOTE: In all cases locate the spot of the proposed drilling location.**

660 ft.

**In plotting the proposed location of the well, you must show:**

1. The manner in which you are using the depicted plat by identifying section lines, i.e. 1 section, 1 section with 8 surrounding sections, 4 sections, etc.
2. The distance of the proposed drilling location from the south / north and east / west outside section lines.
3. The distance to the nearest lease or unit boundary line (in footage).
4. If proposed location is located within a prorated or spaced field a certificate of acreage attribution plat must be attached: (CO-7 for oil wells; CG-8 for gas wells).

RECEIVED  
KANSAS CORPORATION COMMISSION

**AUG 07 2007**

CONSERVATION DIVISION  
WICHITA, KS



KANSAS CORPORATION COMMISSION 1011160  
OIL & GAS CONSERVATION DIVISION

Form CDP-1  
April 2004  
Form must be Typed

**APPLICATION FOR SURFACE PIT**

Submit in Duplicate

Operator Name: Oil Producers Inc. of Kansas		License Number: 8061	
Operator Address: 1710 WATERFRONT PARKWAY		WICHITA KS 67206	
Contact Person: Lori A. Zehr		Phone Number: 316-682-3022	
Lease Name & Well No.: Leon May 3-13		Pit Location (QQQQ): _____ NW _____ NW	
Type of Pit: <input type="checkbox"/> Emergency Pit <input type="checkbox"/> Burn Pit <input type="checkbox"/> Settling Pit <input checked="" type="checkbox"/> Drilling Pit <input type="checkbox"/> Workover Pit <input type="checkbox"/> Haul-Off Pit <small>(If WP Supply API No. or Year Drilled)</small>		Pit is: <input checked="" type="checkbox"/> Proposed <input type="checkbox"/> Existing If Existing, date constructed: _____ Pit capacity: 512 _____ (bbls)	
Is the pit located in a Sensitive Ground Water Area? <input type="checkbox"/> Yes <input checked="" type="checkbox"/> No		Chloride concentration: _____ mg/l <small>(For Emergency Pits and Settling Pits only)</small>	
Is the bottom below ground level? <input checked="" type="checkbox"/> Yes <input type="checkbox"/> No		Artificial Liner? <input type="checkbox"/> Yes <input checked="" type="checkbox"/> No	
How is the pit lined if a plastic liner is not used? Mud & Shale well bore.		Pit dimensions (all but working pits): _____ 80 _____ Length (feet) _____ 8 _____ Width (feet) _____ N/A: Steel Pits Depth from ground level to deepest point: _____ 6 _____ (feet) _____ No Pit	
If the pit is lined give a brief description of the liner material, thickness and installation procedure.  Dig pit to above specifications and lay liner. Liner will be plastic & 6 mil in thickness.		Describe procedures for periodic maintenance and determining liner integrity, including any special monitoring.  Feild Supervisor will inspect on a daily basis.	
Distance to nearest water well within one-mile of pit _____ NA _____ feet    Depth of water well _____ feet		Depth to shallowest fresh water _____ 50 _____ feet. Source of information: <input type="checkbox"/> measured <input type="checkbox"/> well owner <input type="checkbox"/> electric log <input checked="" type="checkbox"/> KDWR	
<b>Emergency, Settling and Burn Pits ONLY:</b> Producing Formation: _____ Number of producing wells on lease: _____ Barrels of fluid produced daily: _____ Does the slope from the tank battery allow all spilled fluids to flow into the pit? <input type="checkbox"/> Yes <input type="checkbox"/> No		<b>Drilling, Workover and Haul-Off Pits ONLY:</b> Type of material utilized in drilling/workover: Chemical Number of working pits to be utilized: _____ 2 _____ Abandonment procedure: Evaporate & Restore Drill pits must be closed within 365 days of spud date.	
I hereby certify that the above statements are true and correct to the best of my knowledge and belief.		RECEIVED KANSAS CORPORATION COMMISSION	
Date: 8.6.07		Signature of Applicant or Agent: <u>TB</u> WICHITA, KS	
<b>KCC OFFICE USE ONLY</b>			
Date Received: 8/7/07		Permit Date: 8/7/07	
Permit Number: _____		Lease Inspection: <input checked="" type="checkbox"/> Yes <input type="checkbox"/> No	

15-033-21502-0000



*Kathleen Sebelius, Governor  
Thomas E. Wright, Chairman  
Robert E. Krehbiel, Commissioner  
Michael C. Moffet, Commissioner*

August 03, 2007

Lori A. Zehr  
Oil Producers Inc. of Kansas  
1710 WATERFRONT PARKWAY  
WICHITA, KS67206

Re: Drilling Pit Application  
Leon May Lease Well No. 3-13  
NW/4 Sec.13-35S-16W  
Comanche County, Kansas

Dear Lori A. Zehr:

District staff has inspected the above referenced location and has determined that the reserve pit shall be constructed **without slots**, the bottom shall be flat and reasonably level and the free fluids must be removed. The fluids are to be removed from the reserve pit as soon as the Hutchinson Salt section has been drilled through and displacement of the fluids into the reserve pit has occurred. The fluids should be removed again as soon as practical after drilling operations have ceased.

**If production casing is set all completion fluids shall be removed from the working pits daily. NO completion fluids or non-exempt wastes shall be placed in the reserve pit.**

The fluids should be taken to an authorized disposal well. Please call the District Office at (620) 225-8888 when the fluids have been removed. Please file form CDP-5 (August 2004), Exploration and Production Waste Transfer, within 30 days of fluid removal. Conservation division forms are available through our office and on the KCC web site:  
[www.kcc.state.ks.us/conservation/forms/](http://www.kcc.state.ks.us/conservation/forms/)

**A copy of this letter should be posted in the doghouse along with the approved Intent to Drill.** If you have any questions or concerns please feel free to contact the District Office at (620) 225-8888.

CONSERVATION DIVISION  
Finney State Office Building, 130 S. Market, Room 2078, Wichita, KS 67202-3802  
(316) 337-6200 • Fax: (316) 337-6211 • <http://kcc.ks.gov/>

RECEIVED  
KANSAS CORPORATION COMMISSION

AUG 07 2007

CONSERVATION DIVISION  
WICHITA, KS