

For KCC Use: 8-12-07  
Effective Date: 3  
District #: 3  
SGA? ☐ Yes ☒ No

KANSAS CORPORATION COMMISSION  
OIL & GAS CONSERVATION DIVISION

AUG 06 2007

Form C-1  
December 2002

NOTICE OF INTENT TO DRILL

Must be approved by KCC five (5) days prior to commencing well

CONSERVATION DIVISION  
WICHITA, KS

Form must be Typed  
Form must be Signed  
All blanks must be Filled

Expected Spud Date August 10, 2007  
month day year

OPERATOR: License# 8210  
Name: Edward E. Birk  
Address: 302 South 16th  
City/State/Zip: Burlington, Ks 66839  
Contact Person: Edward E. Birk  
Phone: 620-364-2745

CONTRACTOR: License# 8210  
Name: Edward E. Birk

Well Drilled For:	Well Class:	Type Equipment:
<input checked="" type="checkbox"/> Oil <input checked="" type="checkbox"/> Enh Rec	<input checked="" type="checkbox"/> Infield <input checked="" type="checkbox"/> Pool Ext.	<input checked="" type="checkbox"/> Mud Rotary <input checked="" type="checkbox"/> Air Rotary
<input type="checkbox"/> Gas <input type="checkbox"/> Storage	<input type="checkbox"/> Wildcat <input type="checkbox"/> Cable	
<input type="checkbox"/> OWWO <input type="checkbox"/> Disposal		
<input type="checkbox"/> Seismic; # of Holes	<input type="checkbox"/> Other	
<input type="checkbox"/> Other		

If OWWO: old well information as follows:  
Operator: \_\_\_\_\_  
Well Name: \_\_\_\_\_  
Original Completion Date: \_\_\_\_\_ Original Total Depth: \_\_\_\_\_

Directional, Deviated or Horizontal wellbore? ☐ Yes ☒ No

If Yes, true vertical depth: \_\_\_\_\_

Bottom Hole Location: \_\_\_\_\_

KCC DKT #: \_\_\_\_\_

Spot ☒ East  
SW SW NE Sec. 28 Twp. 23 S. R. 16 ☐ West  
2440 feet from ☒ N / ☐ S Line of Section  
2145 feet from ☒ E / ☐ W Line of Section  
Is SECTION ☒ Regular ☐ Irregular?

(Note: Locate well on the Section Plat on reverse side)

County: Woodson  
Lease Name: McNatt Well #: 8  
Field Name: Vernon

Is this a Prorated / Spaced Field? ☐ Yes ☒ No

Target Formation(s): Squirrel

Nearest Lease or unit boundary: 200

Ground Surface Elevation: N/A feet MSL

Water well within one-quarter mile: ☐ Yes ☒ No

Public water supply well within one mile: ☐ Yes ☒ No

Depth to bottom of fresh water: 150'

Depth to bottom of usable water: 150'

Surface Pipe by Alternate: ☐ 1 ☒ 2

Length of Surface Pipe Planned to be set: 40'

Length of Conductor Pipe required: N/A

Projected Total Depth: 1100'

Formation at Total Depth: Squirrel

Water Source for Drilling Operations:

☐ Well ☒ Farm Pond ☐ Other

DWR Permit #: \_\_\_\_\_

(Note: Apply for Permit with DWR ☐)

Will Cores be taken? ☐ Yes ☒ No

If Yes, proposed zone: \_\_\_\_\_

AFFIDAVIT

The undersigned hereby affirms that the drilling, completion and eventual plugging of this well will comply with K.S.A. 55 et. seq.

It is agreed that the following minimum requirements will be met:

1. Notify the appropriate district office **prior** to spudding of well;
2. A copy of the approved notice of intent to drill **shall be** posted on each drilling rig;
3. The minimum amount of surface pipe as specified below **shall be set** by circulating cement to the top; in all cases surface pipe **shall be set** through all unconsolidated materials plus a minimum of 20 feet into the underlying formation.
4. If the well is dry hole, an agreement between the operator and the district office on plug length and placement is necessary **prior to plugging**;
5. The appropriate district office will be notified before well is either plugged or production casing is cemented in;
6. If an ALTERNATE II COMPLETION, production pipe shall be cemented from below any usable water to surface within **120 days** of spud date.  
Or pursuant to Appendix "B" - Eastern Kansas surface casing order #133,891-C, which applies to the KCC District 3 area, alternate II cementing must be completed within 30 days of the spud date or the well shall be plugged. **In all cases, NOTIFY district office** prior to any cementing.

I hereby certify that the statements made herein are true and to the best of my knowledge and belief.

Date: 8/3/07 Signature of Operator or Agent: Edward E. Birk Title: Agent

For KCC Use ONLY

API # 15 - 207-27228-0000  
Conductor pipe required None feet  
Minimum surface pipe required 40 feet per Alt. X(2)  
Approved by 8-7-07  
This authorization expires: 2-7-08  
(This authorization void if drilling not started within 6 months of approval date.)  
Spud date: \_\_\_\_\_ Agent: \_\_\_\_\_

Remember to:

- File Drill Pit Application (form CDP-1) with Intent to Drill;
- File Completion Form ACO-1 within 120 days of spud date;
- File acreage attribution plat according to field proration orders;
- Notify appropriate district office 48 hours prior to workover or re-entry;
- Submit plugging report (CP-4) after plugging is completed;
- Obtain written approval before disposing or injecting salt water.
- If this permit has expired (See: authorized expiration date) please check the box below and return to the address below.

☐ Well Not Drilled - Permit Expired

Signature of Operator or Agent: \_\_\_\_\_

Date: \_\_\_\_\_

Mail to: KCC - Conservation Division, 130 S. Market - Room 2078, Wichita, Kansas 67202

28 23 16E

AUG 06 2007

## IN ALL CASES PLOT THE INTENDED WELL ON THE PLAT BELOW

Plat of acreage attributable to a well in a prorated or spaced field

CONSERVATION DIVISION  
NICHOLS

If the intended well is in a prorated or spaced field, please fully complete this side of the form. If the intended well is in a prorated or spaced field complete the plat below showing that the well will be properly located in relationship to other wells producing from the common source of supply. Please show all the wells and within 1 mile of the boundaries of the proposed acreage attribution unit for gas wells and within 1/2 mile of the boundaries of the proposed acreage attribution unit for oil wells.

API No. 15 - 207-27228-0000  
 Operator: Edward E. Birk  
 Lease: McNett  
 Well Number: 8  
 Field: Vernon

Number of Acres attributable to well: \_\_\_\_\_  
 QTR / QTR / QTR of acreage: SW - SW - NE

Location of Well: County: Woodson  
2440 feet from ☒ N / ☐ S Line of Section  
2145 feet from ☒ E / ☐ W Line of Section  
 Sec. 28 Twp. 23 S. R. 16 ☒ East ☐ West

Is Section: ☒ Regular or ☐ Irregular

If Section is Irregular, locate well from nearest corner boundary.

Section corner used: ☐ NE ☐ NW ☐ SE ☐ SW

## PLAT

(Show location of the well and shade attributable acreage for prorated or spaced wells.)

(Show footage to the nearest lease or unit boundary line.)

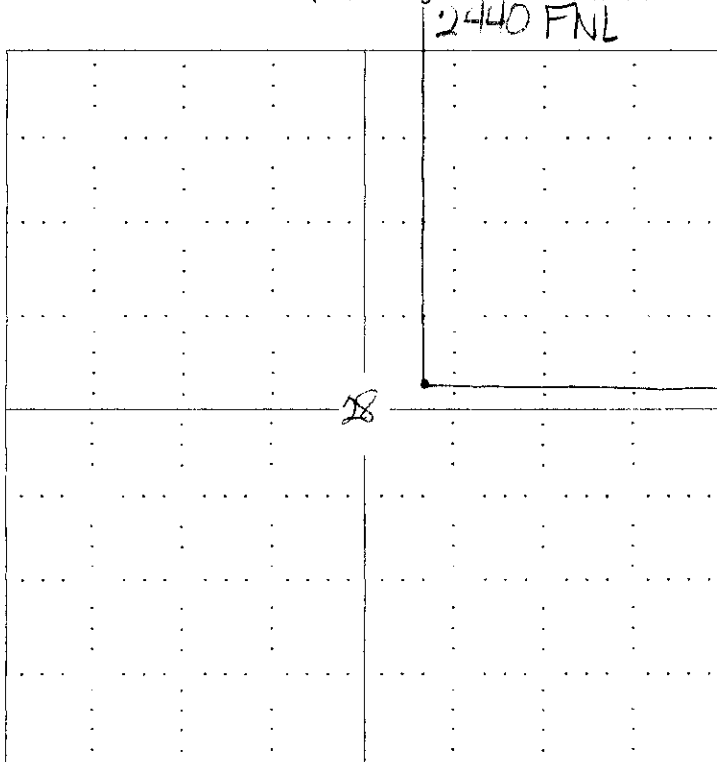

2145 FEL

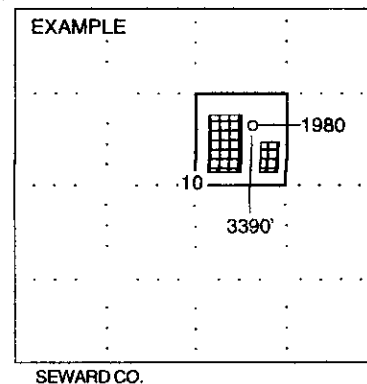

NOTE: In all cases locate the spot of the proposed drilling location.

## In plotting the proposed location of the well, you must show:

1. The manner in which you are using the depicted plat by identifying section lines, i.e. 1 section, 1 section with 8 surrounding sections, 4 sections, etc.
2. The distance of the proposed drilling location from the section's south / north and east / west.
3. The distance to the nearest lease or unit boundary line.
4. If proposed location is located within a prorated or spaced field a certificate of acreage attribution plat must be attached: (CO-7 for oil wells; CG-8 for gas wells).

KANSAS CORPORATION COMMISSION  
OIL & GAS CONSERVATION DIVISION  
**APPLICATION FOR SURFACE PIT**

RECEIVED  
KANSAS CORPORATION COMMISSION

AUG 06 2007

Form CDP-1  
April 2004  
Form must be Typed

CONSERVATION DIVISION  
WICHITA, KS

*Submit in Duplicate*

Operator Name: <b>Edward E. Birk</b>		License Number: <b>8210</b>
Operator Address: <b>302 South 16th Street, Burlington, Ks 66839</b>		
Contact Person: <b>Edward E. Birk</b>		Phone Number: ( <b>620</b> ) <b>364 - 2745</b>
Lease Name & Well No.: <b>McNett #8</b>		Pit Location (QQQQ): _____ <b>SW</b> _____ <b>SW</b> _____ <b>NE</b> Sec. <b>28</b> Twp. <b>23</b> R. <b>16</b> <input checked="" type="checkbox"/> East <input type="checkbox"/> West <b>2440</b> Feet from <input checked="" type="checkbox"/> North / <input type="checkbox"/> South Line of Section <b>2145</b> Feet from <input checked="" type="checkbox"/> East / <input type="checkbox"/> West Line of Section <b>Woodson</b> County
Type of Pit: <input type="checkbox"/> Emergency Pit <input type="checkbox"/> Burn Pit <input type="checkbox"/> Settling Pit <input checked="" type="checkbox"/> Drilling Pit <input type="checkbox"/> Workover Pit <input type="checkbox"/> Haul-Off Pit <small>(If WP Supply API No. or Year Drilled)</small>	Pit is: <input checked="" type="checkbox"/> Proposed <input type="checkbox"/> Existing If Existing, date constructed: _____ Pit capacity: _____ (bbbls)	
Is the pit located in a Sensitive Ground Water Area? <input type="checkbox"/> Yes <input checked="" type="checkbox"/> No		Chloride concentration: _____ mg/l <small>(For Emergency Pits and Settling Pits only)</small>
Is the bottom below ground level? <input checked="" type="checkbox"/> Yes <input type="checkbox"/> No	Artificial Liner? <input type="checkbox"/> Yes <input checked="" type="checkbox"/> No	How is the pit lined if a plastic liner is not used? <b>Native mud/clay</b>
Pit dimensions (all but working pits): <u>30</u> Length (feet) <u>8</u> Width (feet) <u>N/A: Steel Pits</u> Depth from ground level to deepest point: <u>4</u> (feet)		
If the pit is lined give a brief description of the liner material, thickness and installation procedure.		Describe procedures for periodic maintenance and determining liner integrity, including any special monitoring.
Distance to nearest water well within one-mile of pit _____ feet    Depth of water well _____ feet		Depth to shallowest fresh water _____ feet. Source of information: _____ measured _____ well owner _____ electric log _____ KDWR
<b>Emergency, Settling and Burn Pits ONLY:</b> Producing Formation: _____ Number of producing wells on lease: _____ Barrels of fluid produced daily: _____ Does the slope from the tank battery allow all spilled fluids to flow into the pit? <input type="checkbox"/> Yes <input type="checkbox"/> No		<b>Drilling, Workover and Haul-Off Pits ONLY:</b> Type of material utilized in drilling/workover: <u>Drilling mud</u> Number of working pits to be utilized: <u>2</u> Abandonment procedure: <u>evaporate and backfill</u> Drill pits must be closed within 365 days of spud date.
I hereby certify that the above statements are true and correct to the best of my knowledge and belief.  <div style="display: flex; justify-content: space-between;"><div style="text-align: center;"><u>8/3/07</u> Date</div><div style="text-align: center;"> Signature of Applicant or Agent</div></div>		

15-207-27228-P-002

<b>KCC OFFICE USE ONLY</b>			
Date Received: <u>8/6/07</u>	Permit Number: _____	Permit Date: <u>8/6/07</u>	Lease Inspection: <input type="checkbox"/> Yes <input checked="" type="checkbox"/> No

Mail to: KCC - Conservation Division, 130 S. Market - Room 2078, Wichita, Kansas 67202