

FOR KCC USE:

FORM CB-1 12/93  
FORM MUST BE TYPED

EFFECTIVE DATE: 8-19-07  
DISTRICT # 1  
SGA? ... Yes  No

State of Kansas  
CATHODIC PROTECTION BOREHOLE INTENT

FORM MUST BE SIGNED  
ALL BLANKS MUST BE FILLED IN

Must be approved by the K.C.C. sixty (60) days prior to commencing well.

Expected Spud (Starting) Date Sept. 5, 2007  
month day year  
OPERATOR: License # 32119

Spot (Location) Q/Q/Q SE/SE/NE East  
Sec 32 Twp 31. S Rg 32. X West  
2720 feet from South North line of Section  
75 feet from East West line of Section  
(Circle directions from nearest outside corner boundaries)

Name: Northern Natural Gas  
Address: RR 1  
City/State/Zip: Kismet, KS 67859  
Contact Person: Galen Jay Salmans  
Phone: 402-530-6221

IS SECTION  REGULAR  IRREGULAR?  
(Spot well on the Section Plat on Reverse Side)  
County: Seward

CONTRACTOR: License #: 473  
Name: Tyler Water Well, Inc.  
Type Drilling Equipment:  Mud Rotary  Cable  
 Air Rotary  Other

Lease Name: Printz Well #: 2  
Facility Name: Hugoton  
Ground Surface Elevation: 2850 MSL.  
Cathodic Borehole Total Depth: 170 ft.  
Depth to Bedrock: 475 ft.

CONSTRUCTION FEATURES  
Length of Cathodic Surface (Non-Metallic) Casing  
Planned to be set: 20 ft.  
Length of Conductor pipe (if any?): NA ft.  
Surface casing borehole must be 16 or more.  
Size of the borehole (I.D.): 9.75 inches  
Cathodic surface casing size: 10.0 inches  
Cathodic surface casing centralizers set at depths of: 20;

WATER INFORMATION:  
Aquifer Penetration:  None  Single  Multiple  
Depth to bottom of fresh water: 475 ft.  
Depth to bottom of usable water: 500 ft.  
Water well within one-quarter mile:  yes  no  
Public water supply well within one mile:  yes  no  
Water Source for Drilling Operations:  
 well  farm pond  stream  other  
Water Well Location: Kismet

Cathodic surface casing will terminate at:  
 Above surface  Surface Vault  Below Surface Vault  
Pitless casing adaptor will be used:  Yes  No at Depth ft.  
Anode installation depths are: 80 ; 90 ; 100 ; 110 ;  
120 ; 130 ; 140 ; 150 ; 160 ; 170 ;

DWR Permit #: N/A  
Standard Dimension Ratio (SDR) is = 21  
(cathodic surface OD csg. in inches / MWT in inches = SDR)  
Annular space between borehole and casing will be grouted  
with:  Concrete  Bentonite Cement   
 Neat cement  Bentonite clay  
Anode vent pipe will be set at: 3 ft. above surface  
Anode conductor (backfill) material TYPE: Loresco SC-2  
Depth to BASE of Backfill installation material: 170  
Depth to TOP of Backfill installation material: 60

MAX TO=170'

AFFIDAVIT

The undersigned hereby affirms that the drilling, completion and eventual plugging of this well will comply with K.S.A. 55-101, et. seq. It is agreed that the following minimum requirements will be met:

1. Notify the appropriate district office prior to spudding of and again before plugging well;
2. A copy of the approved notice of intent to drill shall be posted on each drilling rig;
3. The minimum amount of cathodic surface casing as specified below shall be set by grouting to the top.
4. An agreement between the operator and the district office on plugs and placement is necessary prior to plugging;
5. The appropriate district office will be notified before well is either plugged or casing is grouted in;
6. IN ALL CASES, NOTIFY DISTRICT OFFICE PRIOR TO ANY CEMENTING.

I hereby certify that the statements made herein are true and to the best of my knowledge and belief.  
Date: 8-13-07 Signature of Operator or Agent: James Heubach Title: V.P. Operations

Energy Economics Agent,  
as consultant for Northern  
Natural Gas.

FOR KCC USE:  
API # 15- 175-22100-000  
Conductor pipe required None feet  
Minimum cathodic surface casing required 20 feet AH-3  
Approved by: KMS-1407  
This authorization expires: 2-14-08  
(This authorization void if drilling not started within  
6 months of effective date.)  
Spud date: \_\_\_\_\_ Agent: \_\_\_\_\_

RECEIVED  
KANSAS CORPORATION COMMISSION

AUG 14 2007

CONSERVATION DIVISION  
WICHITA, KS

- REMEMBER TO:
- File Drill Pit Application (form CDP-1) with Intent to Install;
  - File Completion Form CB-2 within 30 days of spud date;
  - Notify appropriate district office 48 hours prior to workover or re-entry;
  - Submit plugging report (CB-4) within 30 days after plugging is completed.

Mail to: KCC - Conservation Division, 130 S. Market - Room 207B, Wichita, Kansas 67202-1285.

32-31-32 W

**IN ALL CASES PLOT THE INTENDED WELL ON THE PLAT BELOW**

Show the relationship to other wells or facilities proposed to be serviced by the intended cathodic borehole. Please show all the wells, existing cathodic boreholes, pipelines or facilities within 1/2 mile of the proposed borehole.

API NO. 15- 175-22100-000  
 OPERATOR Northern Natural Gas LOCATION OF WELL: COUNTY Seward  
 LEASE Printz 2720 feet from South north line of section  
 WELL NUMBER 2 75 feet from East west line of section  
 FACILITY NAME Hugoton SECTION 32 TWP 31S RG 32W

SPOT: QTR/QTR/QTR/QTR OF ACREAGE  
SW - SE - SE - SE

IS SECTION X REGULAR or IRREGULAR  
IF SECTION IS IRREGULAR, LOCATE WELL FROM NEAREST  
CORNER BOUNDARY.

Section corner used: NE NW X SE SW

PLAT

(Show location of intended cathodic borehole.)

(Show footage from nearest lease, unit or outside section boundary line.)

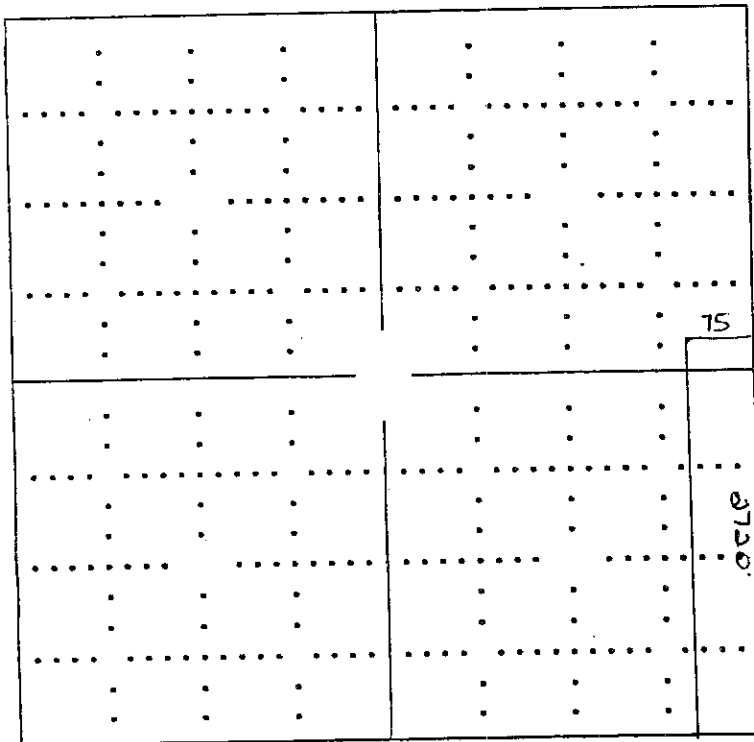

RECEIVED  
 KANSAS CORPORATION COMMISSION

AUG 14 2007

CONSERVATION DIVISION  
 WICHITA KS

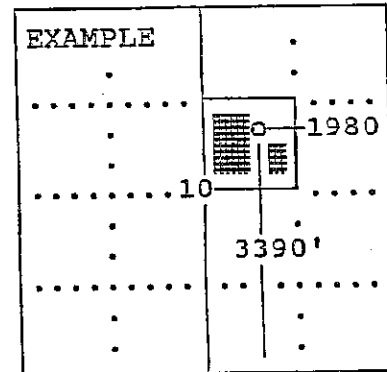

SEWARD CO.

In plotting the proposed location of the well, you must show:

- 1) The manner in which you are using the depicted plat by identifying section lines, i.e. 1 section, 1 section with 8 surrounding sections, 4 sections, etc.;
- 2) the distance of the proposed drilling location from the section's south/north and east/west; and
- 3) the distance to the nearest lease, unit or outside section boundary line.

KANSAS CORPORATION COMMISSION  
OIL & GAS CONSERVATION DIVISION  
**APPLICATION FOR SURFACE PIT**

**AUG 14 2007**

CONSERVATION DIVISION  
WICHITA, KS

Submit in Duplicate

Operator Name: <b>Northern Natural Gas</b>		License Number: <b>32119</b>
Operator Address: <b>RR 1, Kismet, KS 67859</b>		
Contact Person: <b>Galen Jay Salmans</b>		Phone Number: ( <b>402</b> ) <b>530-6221</b>
Lease Name & Well No.: <b>Printz #2</b>		Pit Location (QQQQ): <b>SE SW - SE SE - NE SE</b>
Type of Pit: <input type="checkbox"/> Emergency Pit <input type="checkbox"/> Burn Pit <input type="checkbox"/> Settling Pit <input checked="" type="checkbox"/> Drilling Pit <input type="checkbox"/> Workover Pit <input type="checkbox"/> Haul-Off Pit <small>(If WP Supply API No. or Year Drilled)</small>	Pit is: <input checked="" type="checkbox"/> Proposed <input type="checkbox"/> Existing If Existing, date constructed: _____ Pit capacity: _____ (bbls)	Sec. <b>32</b> Twp. <b>31</b> R. <b>32</b> <input type="checkbox"/> East <input checked="" type="checkbox"/> West <b>2720</b> Feet from <input type="checkbox"/> North / <input checked="" type="checkbox"/> South Line of Section <b>75</b> Feet from <input checked="" type="checkbox"/> East / <input type="checkbox"/> West Line of Section <b>Seward</b> County
Is the pit located in a Sensitive Ground Water Area? <input checked="" type="checkbox"/> Yes <input type="checkbox"/> No		Chloride concentration: <b>None</b> mg/l <small>(For Emergency Pits and Settling Pits only)</small>
Is the bottom below ground level? <input checked="" type="checkbox"/> Yes <input type="checkbox"/> No	Artificial Liner? <input type="checkbox"/> Yes <input checked="" type="checkbox"/> No	How is the pit lined if a plastic liner is not used? <b>Natural Soils</b>
Pit dimensions (all but working pits): <b>30</b> Length (feet) <b>4</b> Width (feet)    N/A: Steel Pits Depth from ground level to deepest point: <b>8</b> (feet)		
If the pit is lined give a brief description of the liner material, thickness and installation procedure. <b>N/A</b>		Describe procedures for periodic maintenance and determining liner integrity, including any special monitoring.
Distance to nearest water well within one-mile of pit <b>2000</b> feet    Depth of water well <b>300</b> feet		Depth to shallowest fresh water <b>248</b> feet. Source of information: _____ measured    _____ well owner    _____ electric log <input checked="" type="checkbox"/> KDWR
<b>Emergency, Settling and Burn Pits ONLY:</b> Producing Formation: <b>Does not apply.</b> Number of producing wells on lease: _____ Barrels of fluid produced daily: _____ Does the slope from the tank battery allow all spilled fluids to flow into the pit? <input type="checkbox"/> Yes <input type="checkbox"/> No		<b>Drilling, Workover and Haul-Off Pits ONLY:</b> Type of material utilized in drilling/workover: <b>Bentonite only</b> Number of working pits to be utilized: <b>1</b> Abandonment procedure: <b>Backfill</b> Drill pits must be closed within 365 days of spud date.
I hereby certify that the above statements are true and correct to the best of my knowledge and belief. <b>Energy Economics Agent, as consultant for Northern Natural Gas.</b> <b>8-13-07</b> Date <i>James Hulshus</i> Signature of Applicant or Agent		

15-175-22100-0002

KCC OFFICE USE ONLY			
Date Received: <b>8/14/07</b>	Permit Number: _____	Permit Date: <b>8/14/07</b>	Lease Inspection: <input type="checkbox"/> Yes <input checked="" type="checkbox"/> No