

For KCC Use: 8-25-07  
 Effective Date: \_\_\_\_\_  
 District # 3  
 SGA?  Yes  No

KANSAS CORPORATION COMMISSION 1011400  
 OIL & GAS CONSERVATION DIVISION

Form C-1  
 November 2005  
 Form must be Typed  
 Form must be Signed  
 All blanks must be Filled

**NOTICE OF INTENT TO DRILL**  
 Must be approved by KCC five (5) days prior to commencing well

Expected Spud Date: 08/22/2007  
 month day year

OPERATOR: License# 5150  
 Name: Colt Energy Inc  
 Address 1: PO BOX 388  
 Address 2: \_\_\_\_\_  
 City: IOLA State: KS Zip: 66749 + 0388  
 Contact Person: DENNIS KERSHNER  
 Phone: 620-365-3111  
 CONTRACTOR: License# 5989  
 Name: Finney, Kurt

Well Drilled For:  Oil  Gas  Enh Rec  Storage  Disposal  Seismic; # of Holes \_\_\_\_\_  Other: \_\_\_\_\_  
 Well Class:  Infield  Pool Ext.  Wildcat  Other \_\_\_\_\_  
 Type Equipment:  Mud Rotary  Air Rotary  Cable

If OWWO: old well information as follows:  
 Operator: \_\_\_\_\_  
 Well Name: \_\_\_\_\_  
 Original Completion Date: \_\_\_\_\_ Original Total Depth: \_\_\_\_\_  
 Directional, Deviated or Horizontal wellbore?  Yes  No  
 If Yes, true vertical depth: \_\_\_\_\_  
 Bottom Hole Location: \_\_\_\_\_  
 KCC DKT #: \_\_\_\_\_

Spot Description: \_\_\_\_\_  
 SE - NE - SE - NW Sec. 33 Twp. 22 S. R. 16  E  W  
 (a/a/a/a) 1,950 feet from  N /  S Line of Section  
2,860 feet from  E /  W Line of Section

Is SECTION:  Regular  Irregular?  
 (Note: Locate well on the Section Plat on reverse side)  
 County: Coffey

Lease Name: BEARD Well #: 33-21  
 Field Name: NEOSHO FALLS-LEROY

Is this a Prorated / Spaced Field?  Yes  No  
 Target Formation(s): LOWER SQUIRREL

Nearest Lease or unit boundary line (in footage): 220  
 Ground Surface Elevation: 1002 feet MSL

Water well within one-quarter mile:  Yes  No  
 Public water supply well within one mile:  Yes  No

Depth to bottom of fresh water: 35  
 Depth to bottom of usable water: 200

Surface Pipe by Alternate:  I  II  
 Length of Surface Pipe Planned to be set: 40

Length of Conductor Pipe (if any): \_\_\_\_\_  
 Projected Total Depth: 1100

Formation at Total Depth: UPPER CHEROKEE  
 Water Source for Drilling Operations:  
 Well  Farm Pond  Other: \_\_\_\_\_

DWR Permit #: \_\_\_\_\_  
 (Note: Apply for Permit with DWR )

Will Cores be taken?  Yes  No  
 If Yes, proposed zone: LOWER SQUIRREL

**AFFIDAVIT**

RECEIVED

The undersigned hereby affirms that the drilling, completion and eventual plugging of this well will comply with K.S.A. 55 et. seq. KANSAS CORPORATION COMMISSION  
 It is agreed that the following minimum requirements will be met:

AUG 20 2007

1. Notify the appropriate district office **prior** to spudding of well;
2. A copy of the approved notice of intent to drill **shall be** posted on each drilling rig;
3. The minimum amount of surface pipe as specified below **shall be set** by circulating cement to the top; in all cases surface pipe **shall be set** through all unconsolidated materials plus a minimum of 20 feet into the underlying formation.
4. If the well is dry hole, an agreement between the operator and the district office on plug length and placement is necessary **prior to plugging**;
5. The appropriate district office will be notified before well is either plugged or production casing is cemented in;
6. If an ALTERNATE II COMPLETION, production pipe shall be cemented from below any usable water to surface within **120 DAYS** of spud date. Or pursuant to Appendix "B" - Eastern Kansas surface casing order #133,891-C, which applies to the KCC District 3 area, alternate II cementing must be completed within 30 days of the spud date or the well shall be plugged. **In all cases, NOTIFY district office** prior to any cementing.

I hereby certify that the statements made herein are true and to the best of my knowledge and belief.

Date: 8-15-07 Signature of Operator or Agent: Shirley Stotler Title: Production Clerk

**For KCC Use ONLY**  
 API # 15 - 031-22322-0000  
 Conductor pipe required 0 feet  
 Minimum surface pipe required 40 feet per ALT.  I  II  
 Approved by: [Signature] 8-2007  
 This authorization expires: 2-2008  
 (This authorization void if drilling not started within 6 months of approval date.)  
 Spud date: \_\_\_\_\_ Agent: \_\_\_\_\_

- Remember to:**
- File Drill Pit Application (form CDP-1) with Intent to Drill;
  - File Completion Form ACO-1 within 120 days of spud date;
  - File acreage attribution plat according to field proration orders;
  - Notify appropriate district office 48 hours prior to workover or re-entry;
  - Submit plugging report (CP-4) after plugging is completed (within 60 days);
  - Obtain written approval before disposing or injecting salt water.
  - If this permit has expired (See: authorized expiration date) please check the box below and return to the address below.
- Well Not Drilled - Permit Expired Date: \_\_\_\_\_  
 Signature of Operator or Agent: \_\_\_\_\_



1011400

**IN ALL CASES PLOT THE INTENDED WELL ON THE PLAT BELOW**

*Plat of acreage attributable to a well in a prorated or spaced field*

**If the intended well is in a prorated or spaced field, please fully complete this side of the form.** If the intended well is in a prorated or spaced field complete the plat below showing that the well will be properly located in relationship to other wells producing from the common source of supply. Please show all the wells and within 1 mile of the boundaries of the proposed acreage attribution unit for gas wells and within 1/2 mile of the boundaries of the proposed acreage attribution unit for oil wells.

API No. 15 - 031-22322-0000  
Operator: Colt Energy Inc  
Lease: BEARD  
Well Number: 33-21  
Field: NEOSHO FALLS-LEROY

Location of Well: County: Coffey  
1,950 feet from  N /  S Line of Section  
2,860 feet from  E /  W Line of Section  
Sec. 33 Twp. 22 S. R. 16  E  W

Number of Acres attributable to well: \_\_\_\_\_  
QTR/QTR/QTR/QTR of acreage: SE - NE - SE - NW

Is Section:  Regular or  Irregular

**If Section is Irregular, locate well from nearest corner boundary.**

Section corner used:  NE  NW  SE  SW

**PLAT**

*(Show location of the well and shade attributable acreage for prorated or spaced wells.)  
(Show footage to the nearest lease or unit boundary line.)*

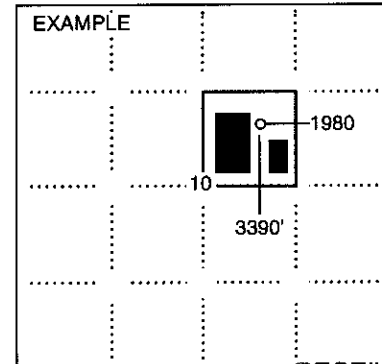
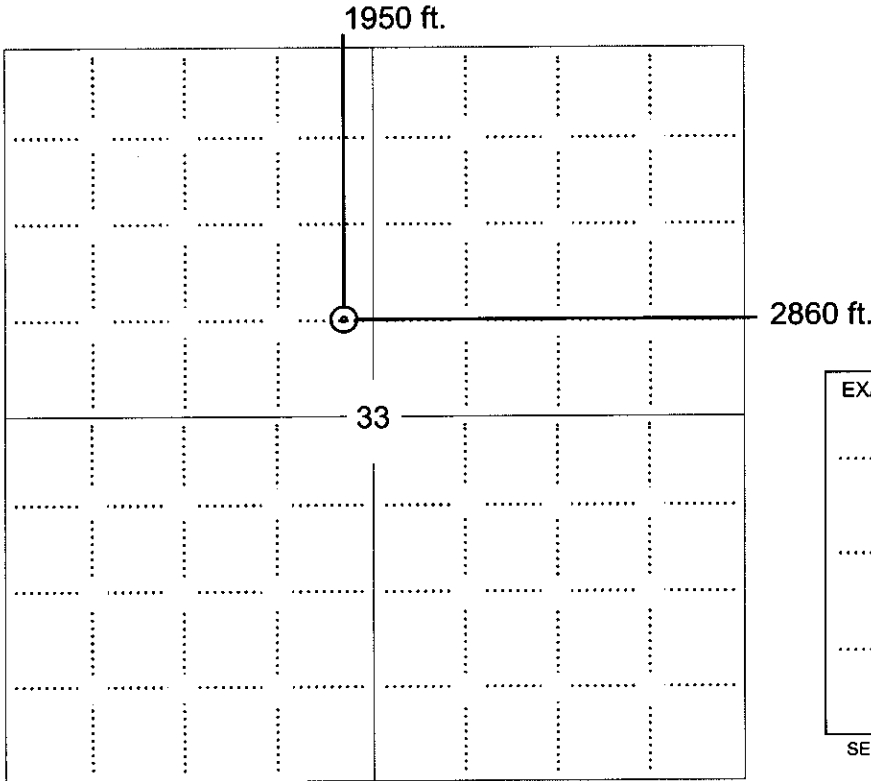

SEWARD CO. RECEIVED KANSAS CORPORATION COMMISSION

**NOTE: In all cases locate the spot of the proposed drilling locaton.**

**AUG 20 2007**

CONSERVATION DIVISION WICHITA, KS

**In plotting the proposed location of the well, you must show:**

1. The manner in which you are using the depicted plat by identifying section lines, i.e. 1 section, 1 section with 8 surrounding sections, 4 sections, etc.
2. The distance of the proposed drilling location from the south / north and east / west outside section lines.
3. The distance to the nearest lease or unit boundary line (in footage).
4. If proposed location is located within a prorated or spaced field a certificate of acreage attribution plat must be attached: (CO-7 for oil wells; CG-8 for gas wells).



KANSAS CORPORATION COMMISSION 1011400  
OIL & GAS CONSERVATION DIVISION

Form GDP-1  
April 2004  
Form must be Typed

APPLICATION FOR SURFACE PIT

Submit in Duplicate

|   |  |   |  |
|---|--|---|--|
| Operator Name: <b>Colt Energy Inc</b>   |  | License Number: <b>5150</b>   |  |
| Operator Address: <b>PO BOX 388</b>   |  | <b>IOLA KS 66749</b>  |  |
| Contact Person: <b>DENNIS KERSHNER</b>  |  | Phone Number: <b>620-365-3111</b>   |  |
| Lease Name & Well No.: <b>BEARD 33-21</b>   |  | Pit Location (QQQQ):<br><b>SE NE SE NW</b><br>Sec. <b>33</b> Twp. <b>22</b> R. <b>16</b> <input checked="" type="checkbox"/> East <input type="checkbox"/> West<br><b>1,950</b> Feet from <input checked="" type="checkbox"/> North / <input type="checkbox"/> South Line of Section<br><b>2,860</b> Feet from <input checked="" type="checkbox"/> East / <input type="checkbox"/> West Line of Section<br><b>Coffey</b> County |  |
| Type of Pit:<br><input type="checkbox"/> Emergency Pit <input type="checkbox"/> Burn Pit<br><input type="checkbox"/> Settling Pit <input checked="" type="checkbox"/> Drilling Pit<br><input type="checkbox"/> Workover Pit <input type="checkbox"/> Haul-Off Pit<br><i>(If WP Supply API No. or Year Drilled)</i>  |  | Pit is:<br><input checked="" type="checkbox"/> Proposed <input type="checkbox"/> Existing<br>If Existing, date constructed: _____<br>Pit capacity:<br><b>80</b> (bbls)  |  |
| Is the pit located in a Sensitive Ground Water Area? <input checked="" type="checkbox"/> Yes <input type="checkbox"/> No  |  | Chloride concentration: _____ mg/l<br><i>(For Emergency Pits and Settling Pits only)</i>  |  |
| Is the bottom below ground level?<br><input checked="" type="checkbox"/> Yes <input type="checkbox"/> No  |  | Artificial Liner?<br><input type="checkbox"/> Yes <input checked="" type="checkbox"/> No  |  |
| How is the pit lined if a plastic liner is not used?<br><b>NATIVE CLAY SOIL</b>   |  |   |  |
| Pit dimensions (all but working pits): <b>30</b> Length (feet) <b>15</b> Width (feet) <input type="checkbox"/> N/A: Steel Pits  |  | Depth from ground level to deepest point: <b>5</b> (feet) <input type="checkbox"/> No Pit   |  |
| If the pit is lined give a brief description of the liner material, thickness and installation procedure.   |  | Describe procedures for periodic maintenance and determining liner integrity, including any special monitoring.   |  |
| Distance to nearest water well within one-mile of pit<br><b>4174</b> feet    Depth of water well <b>35</b> feet   |  | Depth to shallowest fresh water <b>28</b> feet.<br>Source of information:<br><input type="checkbox"/> measured <input type="checkbox"/> well owner <input type="checkbox"/> electric log <input checked="" type="checkbox"/> KDWR   |  |
| <b>Emergency, Settling and Burn Pits ONLY:</b><br>Producing Formation: _____<br>Number of producing wells on lease: _____<br>Barrels of fluid produced daily: _____<br>Does the slope from the tank battery allow all spilled fluids to flow into the pit? <input type="checkbox"/> Yes <input type="checkbox"/> No |  | <b>Drilling, Workover and Haul-Off Pits ONLY:</b><br>Type of material utilized in drilling/workover: <b>NATIVE SOIL</b><br>Number of working pits to be utilized: <b>1</b><br>Abandonment procedure: <b>PUMP FLUID OUT - PUSH PIT IN</b><br>Drill pits must be closed within 365 days of spud date.   |  |
| I hereby certify that the above statements are true and correct to the best of my knowledge and belief.   |  | RECEIVED<br>KANSAS CORPORATION COMMISSION<br><b>AUG 20 2007</b><br>CONSERVATION DIVISION<br>WICHITA, KS   |  |
| <b>8-15-07</b><br>Date  |  | <i>Shirley Stotler</i><br>Signature of Applicant or Agent   |  |
| <b>KCC OFFICE USE ONLY</b>  |  |   |  |
| Date Received: <b>8/20/07</b> Permit Number: _____  |  | Steel Pit <input type="checkbox"/> RFAC <input checked="" type="checkbox"/> RFAS <input type="checkbox"/>   |  |
| Permit Date: <b>8/20/07</b> Lease Inspection: <input checked="" type="checkbox"/> Yes <input type="checkbox"/> No   |  |   |  |

15-031-20322-0000

Mail to: KCC - Conservation Division, 130 S. Market - Room 2078, Wichita, Kansas 67202