

2nd CORRECTED
8-2007

For KCC Use:
Effective Date: 4-15-07
District #: 2
SGA? Yes No

KANSAS CORPORATION COMMISSION
OIL & GAS CONSERVATION DIVISION

NOTICE OF INTENT TO DRILL

Must be approved by KCC five (5) days prior to commencing well

Form must be Typed
Form must be Signed
All blanks must be Filled

Expected Spud Date August 16 2007
month day year

*Spot 100' east of East
S/2 - NW - NE/4 Sec. 9 Twp. 28 S. R. 3 West

OPERATOR: License# 9913
Name: BULLSEYE PETROLEUM, INC.
Address: 15820 Plymouth
Wichita KS. 67230
City/State/Zip:
Contact Person: William Ash
Phone: 316-733-5280 Cell 210-9257

990 feet from N / S Line of Section
1880 feet from E / W Line of Section

CONTRACTOR: License# 32753
Name: SEED GROUP/AA DRILLING

Is SECTION Regular Irregular?

Well Drilled For: Oil Gas OWWO Seismic; # of Holes Other
Well Class: Infield Pool Ext. Wildcat Other
Type Equipment: Mud Rotary Air Rotary Cable

(Note: Locate well on the Section Plat on reverse side)

If OWWO: old well information as follows:
Operator:
Well Name:
Original Completion Date: Original Total Depth:

County: BUTLER
Lease Name: Hooper Well #: C-1

Directional, Deviated or Horizontal wellbore? Yes No

Field Name: Four Mile Creek Southeast

If Yes, true vertical depth:

Is this a Prorated / Spaced Field? Yes No

Bottom Hole Location:

Target Formation(s): Simpson

KCC DKT #:

Nearest Lease or unit boundary: 1090

Ground Surface Elevation: 1310 feet MSL

Water well within one-quarter mile: Yes No

Public water supply well within one mile: Yes No

Depth to bottom of fresh water: 120

Depth to bottom of usable water: 150

Surface Pipe by Alternate: 1 2

Length of Surface Pipe Planned to be set: 200

Length of Conductor Pipe required:

Projected Total Depth: 3125

Formation at Total Depth: Simpson

Water Source for Drilling Operations:

Well Farm Pond Other

DWR Permit #: pond size under 15 acre feet

(Note: Apply for Permit with DWR)

Will Cores be taken? Yes No

If Yes, proposed zone:

* WAS: S/2-NW-NE, 1980' FEL
IS: 100' East of S/2-NW-NE, 1880' FEL

AFFIDAVIT

The undersigned hereby affirms that the drilling, completion and eventual plugging of this well will comply with K.S.A. 55-21990
It is agreed that the following minimum requirements will be met:

RECEIVED
KANSAS CORPORATION COMMISSION
AUG 17 2007
CONSERVATION DIVISION
WICHITA, KS

- 1. Notify the appropriate district office prior to spudding of well;
- 2. A copy of the approved notice of intent to drill shall be posted on each drilling rig;
- 3. The minimum amount of surface pipe as specified below shall be set by circulating cement to the top; in all cases surface pipe shall be set through all unconsolidated materials plus a minimum of 20 feet into the underlying formation.
- 4. If the well is dry hole, an agreement between the operator and the district office on plug length and placement is necessary prior to plugging;
- 5. The appropriate district office will be notified before well is either plugged or production casing is cemented in;
- 6. If an ALTERNATE II COMPLETION, production pipe shall be cemented from below any usable water to surface within 120 days of spud date. Or pursuant to Appendix "B" - Eastern Kansas surface casing order #133,891-C, which applies to the KCC District 3 area, alternate II cementing must be completed within 30 days of the spud date or the well shall be plugged. In all cases, NOTIFY district office prior to any cementing.

I hereby certify that the statements made herein are true and to the best of my knowledge and belief.

Date: 8/16/2007 Signature of Operator or Agent: [Signature] Title: V.P./Operations Director

For KCC Use ONLY
API # 15 - 015-23731-0000
Conductor pipe required None feet
Minimum surface pipe required 200 feet per Alt 1
Approved by: WAM 4-10-07 / RWH 8-14-07 / RWH 8-20-07
This authorization expires:
(This authorization void if drilling not started within 6 months of approval date.)
Spud date: Agent:

Remember to:
- File Drill Pit Application (form CDP-1) with Intent to Drill;
- File Completion Form ACO-1 within 120 days of spud date;
- File acreage attribution plat according to field proration orders;
- Notify appropriate district office 48 hours prior to workover or re-entry;
- Submit plugging report (CP-4) after plugging is completed;
- Obtain written approval before disposing or injecting salt water.
- If this permit has expired (See: authorized expiration date) please check the box below and return to the address below.
 Well Not Drilled - Permit Expired
Signature of Operator or Agent:
Date:

9
28
3E

CORRECTED

IN ALL CASES PLOT THE INTENDED WELL ON THE PLAT BELOW

Plat of acreage attributable to a well in a prorated or spaced field

If the intended well is in a prorated or spaced field, please fully complete this side of the form. If the intended well is in a prorated or spaced field complete the plat below showing that the well will be properly located in relationship to other wells producing from the common source of supply. Please show all the wells and within 1 mile of the boundaries of the proposed acreage attribution unit for gas wells and within 1/2 mile of the boundaries of the proposed acreage attribution unit for oil wells.

API No. 15 - 015-23731-0000

Operator: BULLSEYE PETROLEUM, INC.

Lease: Hooper

Well Number: C-1

Field: Four Mile Creek Southeast

Number of Acres attributable to well: (10 A)

QTR / QTR / QTR of acreage: 100 E S/2 - NW - NE/4

Location of Well: County: BUTLER

990 feet from N / S Line of Section

1880 feet from E / W Line of Section

Sec. 9 Twp. 28 S. R. 3 East West

Is Section: Regular or Irregular

If Section is Irregular, locate well from nearest corner boundary.

Section corner used: NE NW SE SW

PLAT

(Show location of the well and shade attributable acreage for prorated or spaced wells.)

(Show footage to the nearest lease or unit boundary line.)

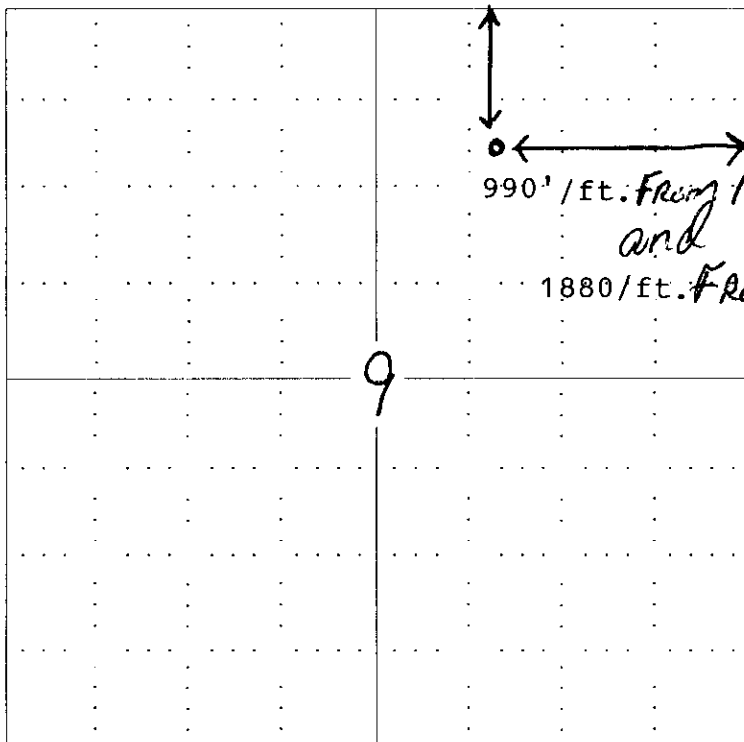

RECEIVED
KANSAS CORPORATION COMMISSION

AUG 17 2007

CONSERVATION DIVISION
WICHITA, KS

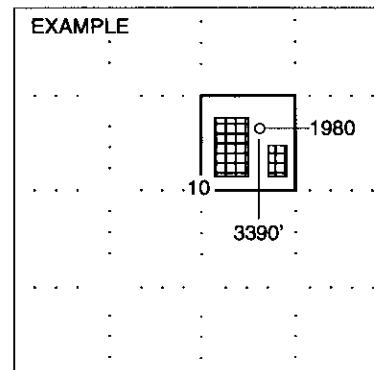

NOTE: In all cases locate the spot of the proposed drilling locaton.

In plotting the proposed location of the well, you must show:

1. The manner in which you are using the depicted plat by identifying section lines, i.e. 1 section, 1 section with 8 surrounding sections, 4 sections, etc.
2. The distance of the proposed drilling location from the section's south / north and east / west.
3. The distance to the nearest lease or unit boundary line.
4. If proposed location is located within a prorated or spaced field a certificate of acreage attribution plat must be attached: (CO-7 for oil wells; CG-8 for gas wells).

KANSAS CORPORATION COMMISSION
OIL & GAS CONSERVATION DIVISION
APPLICATION FOR SURFACE PIT

AUG 17 2007

Submit In Duplicate

CORRECTED

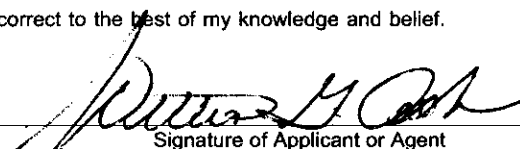
Operator Name: Bullseye Petroleum, Inc.		License Number: 9913
Operator Address: 15820 Plymouth, Wichita, KS. 67230		
Contact Person: William Ash		Phone Number: (316) 733 - 5280
Lease Name & Well No.: Hooper C#1		Pit Location (QQQQ): 100' E. S/2 NW NE/4
Type of Pit: <input type="checkbox"/> Emergency Pit <input type="checkbox"/> Burn Pit <input type="checkbox"/> Settling Pit <input checked="" type="checkbox"/> Drilling Pit <input type="checkbox"/> Workover Pit <input type="checkbox"/> Haul-Off Pit <small>(If WP Supply API No. or Year Drilled)</small>	Pit is: <input checked="" type="checkbox"/> Proposed <input type="checkbox"/> Existing If Existing, date constructed: _____ Pit capacity: 1500+ (bbls)	Sec. 9 Twp. 28S R. 3 <input checked="" type="checkbox"/> East <input type="checkbox"/> West 990 Feet from <input type="checkbox"/> North / <input type="checkbox"/> South Line of Section X 1880 Feet from <input checked="" type="checkbox"/> East / <input type="checkbox"/> West Line of Section Butler County
Is the pit located in a Sensitive Ground Water Area? <input type="checkbox"/> Yes <input checked="" type="checkbox"/> No		Chloride concentration: _____ mg/l <small>(For Emergency Pits and Settling Pits only)</small>
Is the bottom below ground level? <input checked="" type="checkbox"/> Yes <input type="checkbox"/> No	Artificial Liner? <input type="checkbox"/> Yes <input checked="" type="checkbox"/> No	How is the pit lined if a plastic liner is not used?
Pit dimensions (all but working pits): 60 Length (feet) 60 Width (feet) N/A: Steel Pits Depth from ground level to deepest point: 6 (feet)		
If the pit is lined give a brief description of the liner material, thickness and installation procedure.		Describe procedures for periodic maintenance and determining liner integrity, including any special monitoring.
Distance to nearest water well within one-mile of pit 1320 feet Depth of water well 120 feet		Depth to shallowest fresh water 40+ aver. feet. Source of information: _____ measured <input checked="" type="checkbox"/> well owner _____ electric log _____ KDWR
Emergency, Settling and Burn Pits ONLY: Producing Formation: _____ Number of producing wells on lease: _____ Barrels of fluid produced daily: _____ Does the slope from the tank battery allow all spilled fluids to flow into the pit? <input type="checkbox"/> Yes <input type="checkbox"/> No		Drilling, Workover and Haul-Off Pits ONLY: Type of material utilized in drilling/workover: Fresh Mud & Water Number of working pits to be utilized: 3 Abandonment procedure: Natural Evaporation, Dry Backfill with natural soil from location Drill pits must be closed within 365 days of spud date.
I hereby certify that the above statements are true and correct to the best of my knowledge and belief.		
8/16/07 Date		 Signature of Applicant or Agent

15-015-23731-0000

KCC OFFICE USE ONLY		
Date Received: _____	Permit Number: _____	Correction Permit Date: 8/17/07 Lease Inspection: <input type="checkbox"/> Yes <input type="checkbox"/> No