

For KCC Use: 8-26-07
 Effective Date: 8-26-07
 District #: 3
 SGA? Yes No

KANSAS CORPORATION COMMISSION
 OIL & GAS CONSERVATION DIVISION
NOTICE OF INTENT TO DRILL

Form C-1
 December 2002
 Form must be Typed
 Form must be Signed
 All blanks must be Filled

Must be approved by KCC five (5) days prior to commencing well

Expected Spud Date 08 31 2007
 month day year

OPERATOR: License# 9722
 Name: G & J OIL COMPANY, INC.
 Address: RT 1 BOX 212
 City/State/Zip: CANEY, KS 67333
 Contact Person: Gene Nunneley
 Phone: 620-879-2543

CONTRACTOR: License# 33689
 Name: Cannon Drilling Company

Well Drilled For:	Well Class:	Type Equipment:
<input checked="" type="checkbox"/> Oil	<input type="checkbox"/> Enh Rec	<input checked="" type="checkbox"/> Infield
<input type="checkbox"/> Gas	<input type="checkbox"/> Storage	<input type="checkbox"/> Pool Ext.
<input type="checkbox"/> OWWO	<input type="checkbox"/> Disposal	<input type="checkbox"/> Wildcat
<input type="checkbox"/> Seismic; # of Holes	<input type="checkbox"/> Other	<input checked="" type="checkbox"/> Mud Rotary
<input type="checkbox"/> Other		<input type="checkbox"/> Air Rotary
		<input type="checkbox"/> Cable

If OWWO: old well information as follows:
 Operator: n/a
 Well Name: n/a
 Original Completion Date: n/a Original Total Depth: n/a
 Directional, Deviated or Horizontal wellbore? Yes No
 If Yes, true vertical depth: n/a
 Bottom Hole Location: n/a
 KCC DKT #: n/a

Spot sw sw ne/4 Sec. 1 Twp. 34 S. R. 14 East West
2475 feet from N / S Line of Section
3145 feet from E / W Line of Section
 Is SECTION Regular Irregular?

(Note: Locate well on the Section Plat on reverse side)

County: Montgomery
 Lease Name: Meadows Well #: 07-3
 Field Name: Wayside-Havana
 Is this a Prorated / Spaced Field? Yes No
 Target Formation(s): Wayside
 Nearest Lease or unit boundary: 495
 Ground Surface Elevation: n/a feet MSL
 Water well within one-quarter mile: Yes No
 Public water supply well within one mile: Yes No
 Depth to bottom of fresh water: 100+
 Depth to bottom of usable water: 228 / 175
 Surface Pipe by Alternate: 1 2
 Length of Surface Pipe Planned to be set: 20'
 Length of Conductor Pipe required: none
 Projected Total Depth: 720'
 Formation at Total Depth: Wayside
 Water Source for Drilling Operations:
 Well Farm Pond Other Haul In
 DWR Permit #: _____
 (Note: Apply for Permit with DWR)
 Will Cores be taken? Yes No
 If Yes, proposed zone: Wayside

AFFIDAVIT

The undersigned hereby affirms that the drilling, completion and eventual plugging of this well will comply with K.S.A. 55' et. seq.
 It is agreed that the following minimum requirements will be met:

1. Notify the appropriate district office **prior** to spudding of well;
2. A copy of the approved notice of intent to drill **shall be** posted on each drilling rig;
3. The minimum amount of surface pipe as specified below **shall be set** by circulating cement to the top; in all cases surface pipe shall be cemented through all unconsolidated materials plus a minimum of 20 feet into the underlying formation.
4. If the well is dry hole, an agreement between the operator and the district office on plug length and placement is necessary **prior to plugging**;
5. The appropriate district office will be notified before well is either plugged or production casing is cemented in;
6. If an ALTERNATE II COMPLETION, production pipe shall be cemented from below any usable water to surface within **120 days** of spud date. Or pursuant to Appendix "B" - Eastern Kansas surface casing order #133,891-C, which applies to the KCC District 3 area, alternate II cementing must be completed within 30 days of the spud date or the well shall be plugged. **In all cases, NOTIFY district office** prior to any cementing.

I hereby certify that the statements made herein are true and to the best of my knowledge and belief.

Date: 8-17-07 Signature of Operator or Agent: Gene Nunneley Title: President

RECEIVED
 KANSAS CORPORATION COMMISSION
 AUG 20 2007

CONSERVATION DIVISION
 WICHITA, KS

For KCC Use ONLY
 API # 15 - 125-31425-0000
 Conductor pipe required None feet
 Minimum surface pipe required 20 feet per Alt. **X(2)**
 Approved by: Gene Nunneley
 This authorization expires: 2-21-08
 (This authorization void if drilling not started within 6 months of approval date.)
 Spud date: _____ Agent: _____

Remember to:

- File Drill Pit Application (form CDP-1) with Intent to Drill;
- File Completion Form ACO-1 within 120 days of spud date;
- File acreage attribution plat according to field proration orders;
- Notify appropriate district office 48 hours prior to workover or re-entry;
- Submit plugging report (CP-4) after plugging is completed;
- Obtain written approval before disposing or injecting salt water.
- If this permit has expired (See: authorized expiration date) please check the box below and return to the address below.

Well Not Drilled - Permit Expired
 Signature of Operator or Agent: _____
 Date: _____

1
 34
 14E

IN ALL CASES PLOT THE INTENDED WELL ON THE PLAT BELOW

Plat of acreage attributable to a well in a prorated or spaced field

If the intended well is in a prorated or spaced field, please fully complete this side of the form. If the intended well is in a prorated or spaced field complete the plat below showing that the well will be properly located in relationship to other wells producing from the common source of supply. Please show all the wells and within 1 mile of the boundaries of the proposed acreage attribution unit for gas wells and within 1/2 mile of the boundaries of the proposed acreage attribution unit for oil wells.

API No. 15 - 125-31425-0000
 Operator: G & J OIL COMPANY, INC.
 Lease: Meadows
 Well Number: 07-3
 Field: Wayside-Havana
 Number of Acres attributable to well: 10
 QTR / QTR / QTR of acreage: sw - sw - ne/4

Location of Well: County: Montgomery
2475 feet from N / S Line of Section
3145 feet from E / W Line of Section
 Sec. 1 Twp. 34 S. R. 14 East West

Is Section: Regular or Irregular

If Section is Irregular, locate well from nearest corner boundary.

Section corner used: NE NW SE SW

PLAT

(Show location of the well and shade attributable acreage for prorated or spaced wells.)

(Show footage to the nearest lease or unit boundary line.)

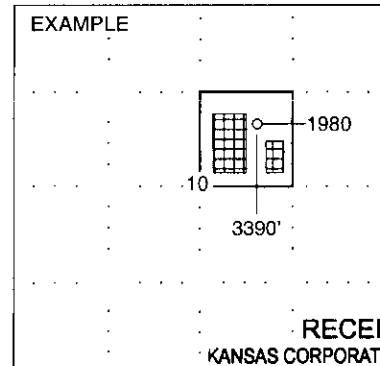
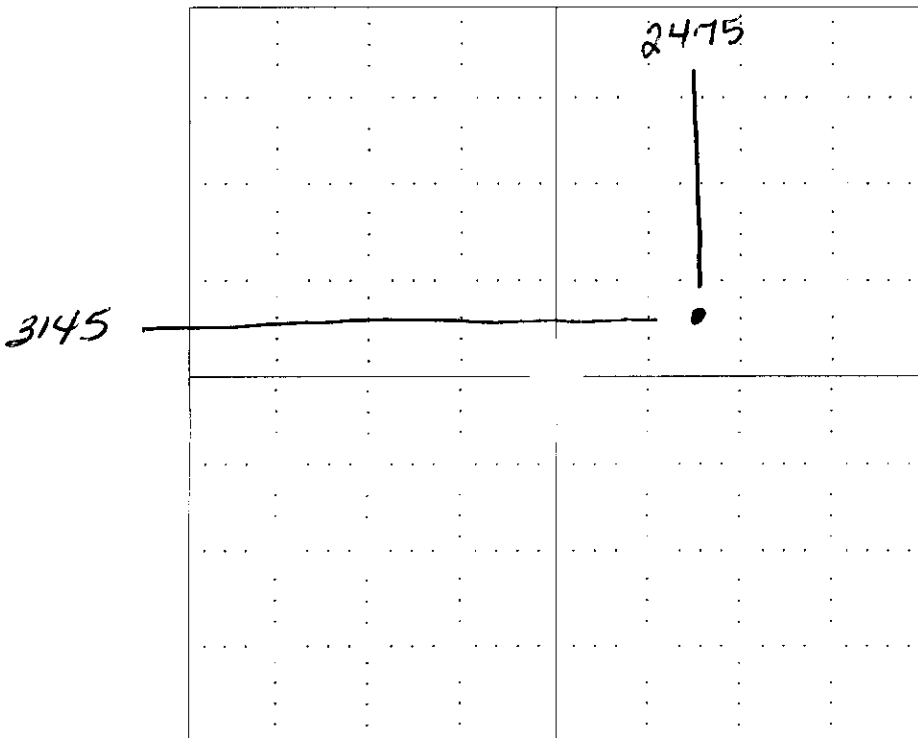

RECEIVED
 KANSAS CORPORATION COMMISSION

SEWARD CO.

AUG 20 2007

CONSERVATION DIVISION
 WICHITA, KS

NOTE: In all cases locate the spot of the proposed drilling location.

In plotting the proposed location of the well, you must show:

1. The manner in which you are using the depicted plat by identifying section lines, i.e. 1 section, 1 section with 8 surrounding sections, 4 sections, etc.
2. The distance of the proposed drilling location from the section's south / north and east / west.
3. The distance to the nearest lease or unit boundary line.
4. If proposed location is located within a prorated or spaced field a certificate of acreage attribution plat must be attached: (CO-7 for oil wells; CG-8 for gas wells).

**KANSAS CORPORATION COMMISSION
OIL & GAS CONSERVATION DIVISION
APPLICATION FOR SURFACE PIT**

Form CDP-1
April 2004
Form must be Typed

Submit in Duplicate

Operator Name: G & J Oil Company, Inc.		License Number: 9722
Operator Address: Route 1 Box 212, Caney, KS 67333		
Contact Person: Gene Nunneley		Phone Number: (620) 252 - 9700
Lease Name & Well No.: Meadows #07-3		Pit Location (QQQQ): sw sw ne/4
Type of Pit: <input type="checkbox"/> Emergency Pit <input type="checkbox"/> Burn Pit <input type="checkbox"/> Settling Pit <input checked="" type="checkbox"/> Drilling Pit <input type="checkbox"/> Workover Pit <input type="checkbox"/> Haul-Off Pit <small>(If WP Supply API No. or Year Drilled)</small>	Pit is: <input checked="" type="checkbox"/> Proposed <input type="checkbox"/> Existing If Existing, date constructed: _____ Pit capacity: 100 (bbls)	Sec. 1 Twp. 34 R. 14 <input checked="" type="checkbox"/> East <input type="checkbox"/> West 2475 Feet from <input checked="" type="checkbox"/> North / <input type="checkbox"/> South Line of Section 3145 Feet from <input type="checkbox"/> East / <input checked="" type="checkbox"/> West Line of Section Montgomery County
Is the pit located in a Sensitive Ground Water Area? <input type="checkbox"/> Yes <input checked="" type="checkbox"/> No		Chloride concentration: <u>n/a</u> mg/l <small>(For Emergency Pits and Settling Pits only)</small>
Is the bottom below ground level? <input checked="" type="checkbox"/> Yes <input type="checkbox"/> No	Artificial Liner? <input type="checkbox"/> Yes <input checked="" type="checkbox"/> No	How is the pit lined if a plastic liner is not used? shale
Pit dimensions (all but working pits): 40 Length (feet) 8 Width (feet) N/A: Steel Pits Depth from ground level to deepest point: 4 (feet)		
If the pit is lined give a brief description of the liner material, thickness and installation procedure.		Describe procedures for periodic maintenance and determining liner integrity, including any special monitoring.
Distance to nearest water well within one-mile of pit 3218 feet Depth of water well 120 feet		Depth to shallowest fresh water 100 feet. Source of information: _____ measured <input checked="" type="checkbox"/> well owner _____ electric log (1) KDWR
Emergency, Settling and Burn Pits ONLY: Producing Formation: _____ Number of producing wells on lease: _____ Barrels of fluid produced daily: _____ Does the slope from the tank battery allow all spilled fluids to flow into the pit? <input type="checkbox"/> Yes <input type="checkbox"/> No		Drilling, Workover and Haul-Off Pits ONLY: Type of material utilized in drilling/workover: fresh water Number of working pits to be utilized: 1 Abandonment procedure: Pit dried, backfill with overburden then topsoil restored at surface. Drill pits must be closed within 365 days of spud date.
I hereby certify that the above statements are true and correct to the best of my knowledge and belief.		RECEIVED KANSAS CORPORATION COMMISSION AUG 20 2007 CONSERVATION DIVISION WICHITA, KS
8-17-07 Date	<i>Gene Nunneley</i> Signature of Applicant or Agent	
KCC OFFICE USE ONLY		
Date Received: 8/20/07	Permit Number: _____	Permit Date: 8/20/07 Lease Inspection: <input type="checkbox"/> Yes <input checked="" type="checkbox"/> No

15-105-31425-0000