

STATE CORPORATION COMMISSION OF KANSAS  
OIL & GAS CONSERVATION DIVISION  
WELL COMPLETION FORM  
ACO-1 WELL HISTORY  
DESCRIPTION OF WELL AND LEASE

RECEIVED  
SEP 04 2003  
KCC WICHITA

Operator: License # 6101  
Name: TEICHGRAEBER OIL, INC  
Address: 700 N MAIN  
EUREKA, KS 67045  
City/State/Zip EUREKA, KS 67045

Purchaser: SEMINOLE TRANSPORTATION & GATHERING

Operator Contact Person: R K TEICHGRAEBER  
Phone (620) 583-7500

Contractor: Name: BERENTZ DRILLING COM, INC  
License: 5892

Wellsite Geologist: IVAN STUBER

Designate Type of Completion  
 New Well  Re-Entry  Workover  
 Oil  SWD  SIOW  Temp. Abd.  
 Gas  ENHR  SIGW  
 Dry  Other (Core, WSW, Expl., Cathodic, etc)

If Workover/Re-Entry: old well info as follows:  
Operator: DOCKING DEVELOPMENT CO  
Well Name: COULTER B #1  
Comp. Date 4-21-96 Old Total Depth 2450  
 Deepening  Re-perf.  Conv. to Inj/SWD  
 Plug Back  PBD  
 Commingled  Docket No. \_\_\_\_\_  
 Dual Completion  Docket No. \_\_\_\_\_  
 Other (SWD or Inj?)  Docket No. \_\_\_\_\_

06-27-03 06-29-03 7-22-03  
Spud Date Date Reached TD Completion Date

API NO. 15- 035-24082-00-01  
County Cowley  
NW - SE - NE - Sec. 4 Twp. 34S Rge. 8 XX E  
W

3630 Feet from (S) (circle one) Line of Section  
993 Feet from (E) (circle one) Line of Section

Footages Calculated from Nearest Outside Section Corner:  
NE, SE, NW or SW (circle one)

Lease Name FULSOM Well # 2

Field Name FULSOM

Producing Formation MISSISSIPPI

Elevation: Ground 1001' KB 1006'

Total Depth 2478.9' PBDT \_\_\_\_\_

Amount of Surface Pipe Set and Cemented at \_\_\_\_\_ Feet

Multiple Stage Cementing Collar Used?  Yes  No

If yes, show depth set \_\_\_\_\_ Feet

If Alternate II completion, cement circulated from \_\_\_\_\_  
feet depth to \_\_\_\_\_ w/ \_\_\_\_\_ sx cmt.

Drilling Fluid Management Plan ALT I WHM  
(Data must be collected from the Reserve Pit) 4-25-07

Chloride content \_\_\_\_\_ ppm Fluid volume \_\_\_\_\_ bbls

Dewatering method used \_\_\_\_\_

Location of fluid disposal if hauled offsite: \_\_\_\_\_

Operator Name \_\_\_\_\_

Lease Name \_\_\_\_\_ License No. \_\_\_\_\_

Quarter Sec. Twp. S Rng. E/W

County \_\_\_\_\_ Docket No. \_\_\_\_\_

INSTRUCTIONS: An original and two copies of this form shall be filed with the Kansas Corporation Commission, 200 Colorado Derby Building, Wichita, Kansas 67202, within 120 days of the spud date, recompletion, workover or conversion of a well. Rule 82-3-130, 82-3-106 and 82-3-107 apply. Information on side two of this form will be held confidential for a period of 12 months if requested in writing and submitted with the form (see rule 82-3-107 for confidentiality in excess of 12 months). One copy of all wireline logs and geologist well report shall be attached with this form. ALL CEMENTING TICKETS MUST BE ATTACHED. Submit CP-4 form with all plugged wells. Submit CP-111 form with all temporarily abandoned wells.

All requirements of the statutes, rules and regulations promulgated to regulate the oil and gas industry have been fully complied with and the statements herein are complete and correct to the best of my knowledge.

Signature [Signature]  
Title owner/operator Date 8-30-03

Subscribed and sworn to before me this 30 day of August, 2003

Notary Public [Signature]

Date Commission Expires 05-19-2004

JANET L. TURNER  
Notary Public - State of Kansas  
My Appt. Expires 05-19-04

K.C.C. OFFICE USE ONLY  
F  Letter of Confidentiality Attached  
C  Wireline Log Received  
C  Geologist Report Received  
Distribution  
 KCC  SWD/Rep  NGPA  
 KGS  Plug  Other (Specify)

SIDE TWO

Operator Name TEICHGRAEBER OIL, INC Lease Name FULSOM Well # 2  
 East County COWLEY  
 Sec. 4 Twp. 34S Rge. 8  West

INSTRUCTIONS: Show important tops and base of formations penetrated. Detail all cores. Report all drill stem tests giving interval tested, time tool open and closed, flowing and shut-in pressures, whether shut-in pressure reached static level, hydrostatic pressures, bottom hole temperature, fluid recovery, and flow rates if gas to surface during test. Attach extra sheet if more space is needed. Attach copy of log.

Drill Stem Tests Taken  Yes  No  
 (Attach Additional Sheets.)  
 Samples Sent to Geological Survey  Yes  No  
 Cores Taken  Yes  No  
 Electric Log Run  Yes  No  
 (Submit Copy.)  
 List All E.Logs Run:

Name	Formation (Top), Depth and Datum		Datum
	Top	Depth	
KANSAS CITY	1806	-795	
B.L.C.	1887	-876	
ALTAMONT	1985	-974	
pawnee	2088	-1077	
FORT SCOTT	2134	-1123	
CHEROKEE SH.	2173	-1162	
CATTLEMAN ZONE	2250	-1239	
MISSISSIPPI	2438	-1427	

CASING RECORD <input type="checkbox"/> New <input type="checkbox"/> Used							
Report all strings set-conductor, surface, intermediate, production, etc.							
Purpose of String	Size Hole Drilled	Size Casing Set (In O.D.)	Weight Lbs./Ft.	Setting Depth	Type of Cement	# Sacks Used	Type and Percent Additives
SURFACE	10"	8 7/8	----	132 FT	REGULAR	100	
PRODUCTION	7 7/8	5 1/2	----	2490	Regular	150	

ADDITIONAL CEMENTING/SQUEEZE RECORD				
Purpose:	Depth Top Bottom	Type of Cement	#Sacks Used	Type and Percent Additives
<input type="checkbox"/> Perforate				
<input type="checkbox"/> Protect Casing				
<input type="checkbox"/> Plug Back TD				
<input type="checkbox"/> Plug Off Zone				

Shots Per Foot	PERFORATION RECORD - Bridge Plugs Set/Type	Acid, Fracture, Shot, Cement Squeeze Record
	Specify Footage of Each Interval Perforated	(Amount and Kind of Material Used) Depth

TUBING RECORD		Size	Set At	Packer At	Liner Run	<input type="checkbox"/> Yes <input type="checkbox"/> No
Date of First, Resumed Production, SWD or Inj.		Producing Method <input type="checkbox"/> Flowing <input type="checkbox"/> Pumping <input type="checkbox"/> Gas Lift <input type="checkbox"/> Other (Explain)				
Estimated Production Per 24 Hours	Oil Bbls.	Gas Mcf	Water Bbls.	Gas-Oil Ratio	Gravity	

Disposition of Gas:  Vented  Sold  Used on Lease (If vented, submit ACO-18.)

METHOD OF COMPLETION  Open Hole  Perf.  Dually Comp.  Commingled  Other (Specify) \_\_\_\_\_

Production Interval \_\_\_\_\_

ORIGINAL  
RECEIVED

SEP 04 2003

KCC WICHITA

Re: Evaluating Cowley Co. Prospect

Fulson #2:

Presently making 6-8 barrels oil with a nominal amount of water (35 bbls.) will acidize well with 1,000 gallons acid, well expected to make 15-20 bbls oil plus water. Well producing from 4' of dolomite 40' in the Mississippian.

Altamont:

From DST on this well it is expected that the zone could be completed for 15-20 bbls oil plus a nominal amount of water.

Pawnee:

The offset well to the north was perforated and acidized and was making 1-2 bbls oil plus nominal amount of water. The Pawnee zone on this well showed slight improvement in the electric log, and need not be completed.

Mississippi Chert:

This is the main objective on these leases. The DST on this zone showed a probable well. The well to the north (Fulson #1), was completed in this zone, and while it showed promise at the start, it was making too much water to produce (300-350 bbls). The water was obviously coming from 4' of very porous chert at the bottom of a 13' zone. This well (Fulson #2) was structurally 6' high to this well, and the electric log of this 10' of chert with a very good show of oil showed no high porosity at the bottom. It is expected that this zone would make 20-50 bbls oil plus less water than the Fulson #1. Should be completed at a later date.

Future drilling on this prospect:

Wells to the east should be higher structurally, as well as high because of thinning in the Cherokee shale of at least 10'. A possible Arbuckle high well could be found to the east, although no known Arbuckle wells are in the area.

A well drilled at the west offset to the Fulson #2 would produce from some of these zones as well as having a possibility of finding the Cattleman sand. The Mississippi zone may or may not be found to the east, because of the thinness of the zone, and losing the zone entirely on the high.

These leases have the potential of drilling several wells of commercial production.

*John S. ...*

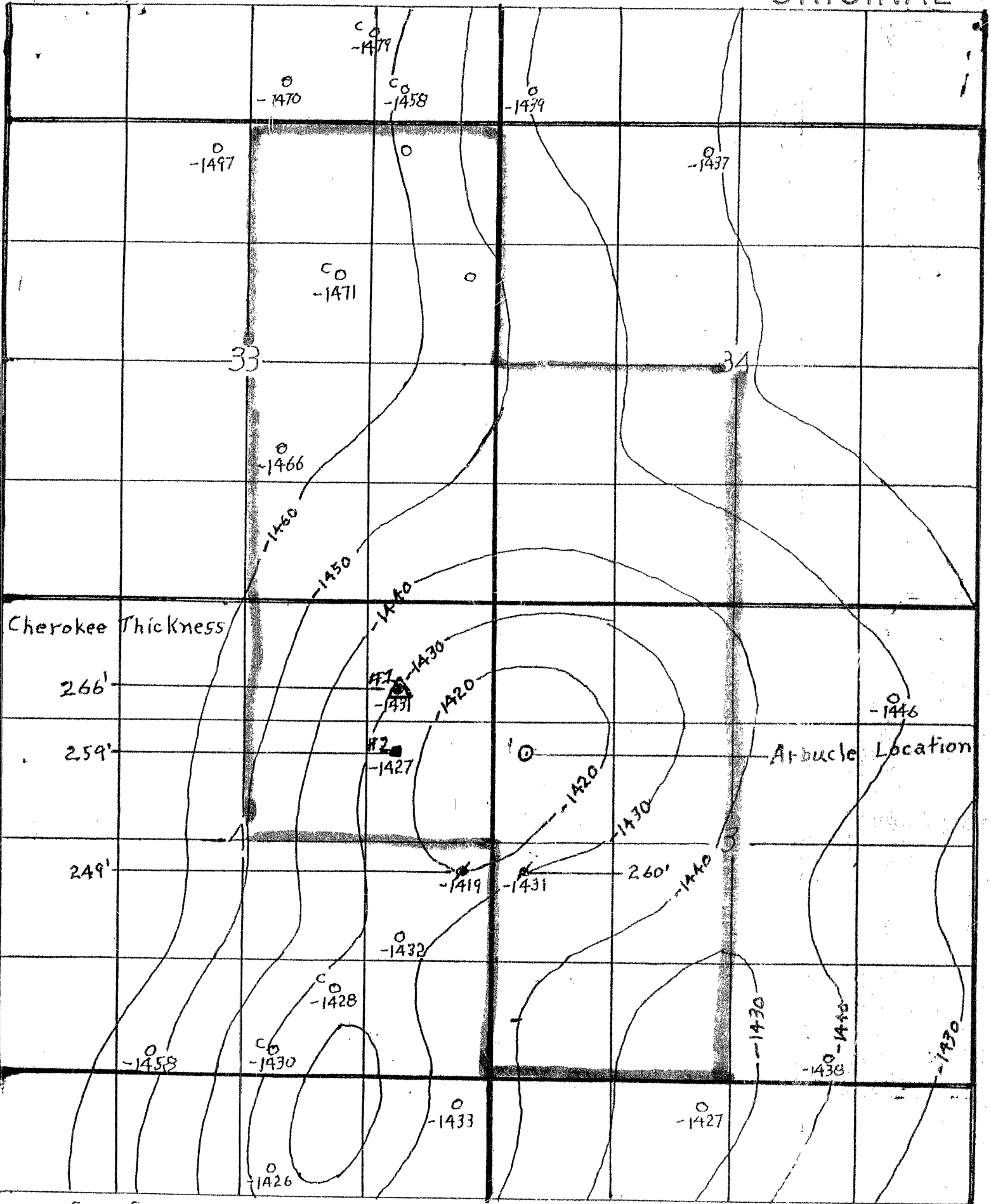

Cherokee Thickness

266'

259'

249'

Arbuckle Location

260'

COWLEY CO.

CHATAUQUA CO.

RECEIVED

SEP 25 2003

BLUE STAR  
ACID SERVICE, INC.

KCC WICHITA

PO Box 103  
Eureka, Kansas 67045

Cementing Ticket  
and Invoice Number

Nº 4686

Date 6-29-03	Customer Order No.	Sect.	Twp.	Range	Truck Called Out AM 1.00	On Location 3.00 AM	Job Began 7.00 AM	Job Completed 8.00 AM
Owner Teichgraber Oil		Contractor Berentz Drilling			Charge To Teichgraber Oil			
Mailing Address 700 N MAIN		City EUREKA			State KANSAS			
Well No. & Form Fulsom # 2		Place Cowley			State KANSAS			
Depth of Well 2490	Depth of Job 2489	Casing (New) Size 5 1/2 (Used) Weight UNK. APPROX	Size of Hole 1 1/8 Amt and Kind of Cement 125 T.S.		Cement Left in casing by	Request Necessity 11 feet		
Kind of Job long string BAFFLE AT 2478					Drillpipe Tubing	(Rotary) (Cable)		Truck No. 12

Price Reference No. # 1
Price of Job 665.00
Second Stage
Mileage 50) 112.50
Other Charges
Total Charges 777.50

Remarks Safety meeting CASING SET AT 2489 w/ Baffle Plate at 2478'. Drop Ball to close AFV INSERT Pump 20 Bbl water for pre flush, mix 12.5 SKS Thickset cement w/ 4 lbs Kol seal at 13.8 # Per Gallon. Shut Down, wash out pump & lines. Release Plug, Displace w/ 59 1/4 Bbl Fresh water. Front Pump PST was 500' Bump Plug to 700' Check Front Front DID NOT HOLD. Bump Plug back to 700' close casing in at 700' PST. Tag Plug at 2581 w/ wire line GOOD circulation during cement procedure. Simple, Trac Down. NOTE'S casing w/ full of slate, and pits sort of BAD'S JOINTS 2m

Cementor Russell McCoy District EUREKA State KANSAS

Helper Troy - Manti - JASON

The above job was done under supervision of the owner, operator, or his agent whose signature appears below.

THANK YOU

called by Dick Teichgraber  
Agent of contractor or operator

Sales Ticket for Materials Only

Quantity Sacks	BRAND AND TYPE	PRICE	TOTAL
12.5	SKS Thickset cement	10.75	1343.75
600	16's Kol-Seal 4 16's Per/SK	.30	180.00
1	5 1/2 Guide Shoe	85.00	85.00
1	5 1/2 A.F.V. INSERT	92.00	92.00
1	5 1/2 TOP Rubber Plug	40.00	40.00
5	hrs 80 Bbl VAC TRUCK	60.00	300.00
1	load City water (used for mixing cement)	20.00	20.00
Plugs			
	12.5 SKS Handling & Dumping	.50	62.50
	6.87 Mileage 50	.80	274.80
	Delivered by # 22		3175.55
	Delivered from Eureka		
	Signature of operator <u>Russell McCoy</u>		

