

STATE CORPORATION COMMISSION OF KANSAS
OIL & GAS CONSERVATION DIVISION
WELL COMPLETION OR RECOMPLETION FORM
ACO-1 WELL HISTORY
DESCRIPTION OF WELL AND LEASE

Operator: License # 5635
Name The Gene Brown Company
Address 407 S. Main
Plainville, Kansas 67663
City/State/Zip
Purchaser Enron
P.O. Box 20108
Shreveport, La. 71120
Operator Contact Person Thomas E. Brown
Phone 913-434-4811
Contractor: License # 9087
Name R & C Drilling Co., Inc.
Wellsite Geologist Gerald Wehrli
Phone 913-434-2288

Designate Type of Completion
 New Well Re-Entry Workover
 Oil SWD Temp Abd
 Gas Inj Delayed Comp
 Dry Other (Core, Water Supply etc.)
If **OWWO**: old well info as follows:
Operator
Well Name
Comp. Date Old Total Depth

WELL HISTORY

Drilling Method:
 Mud Rotary Air Rotary Cable
8/6/88 8/11/88 10-18-88
Spud Date Date Reached TD Completion Date
3508' 3485'
Total Depth PBTD
Amount of Surface Pipe Set and Cemented at 212 feet
Multiple Stage Cementing Collar Used? Yes No
If yes, show depth set feet
If alternate 2 completion, cement circulated
from 1280 feet depth to surface 320 SX cmt
Cement Company Name Halliburton
Invoice # 650695
10-8-88 12-19-88

API No. 15-163-23,011 -00-00
County Rooks
SW SE SE Sec. 24 Twp. 8 Rge. 18 XX West
330 Ft North from Southeast Corner of Section
990 Ft West from Southeast Corner of Section
(Note: Locate well in section plat below)
Lease Name Pearl McMillen Well # 6
Field Name Dopita
Producing Formation Arbuckle - LKC
Elevation: Ground 1996 KB 2004

Section Plat

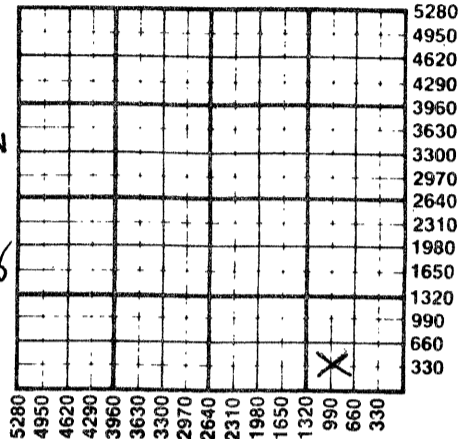

WATER SUPPLY INFORMATION

Disposition of Produced Water: 65,534-C (C-8544)
Docket # Disposal
 Repressuring

Questions on this portion of the ACO-1 call:
Water Resources Board (913) 296-3717

Source of Water:
Division of Water Resources Permit #
Groundwater Ft North from Southeast Corner
(Well) Ft West from Southeast Corner of
Sec Twp Rge East West
 Surface Water 4840 Ft North from Southeast Corner
(Stream, pond etc) 4950 Ft West from Southeast Corner
Sec 31 Twp 8 Rge 17 East West
Other (explain)
(purchased from city, R.W.D. #)

INSTRUCTIONS: This form shall be completed in triplicate and filed with the Kansas Corporation Commission, 200 Colorado Derby Building, Wichita, Kansas 67202, within 120 days of the spud date of any well. Rule 82-3-130, 82-3-107 and 82-3-106 apply.
Information on side two of this form will be held confidential for a period of 12 months if requested in writing and submitted with the form. See rule 82-3-107 for confidentiality in excess of 12 months.
One copy of all wireline logs and drillers time log shall be attached with this form. Submit CP-4 form with all plugged wells. Submit CP-111 form with all temporarily abandoned wells.

All requirements of the statutes, rules and regulations promulgated to regulate the oil and gas industry have been fully complied with and the statements herein are complete and correct to the best of my knowledge.

Signature Thomas M. Brown
Title FOREMAN Date 11-29-88
Subscribed and sworn to before me this 29th day of November 1988
Notary Public Kathy A. Wise
Date Commission Expires 5-27-90

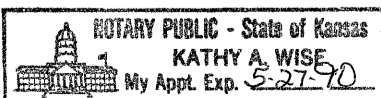

K.C.C. OFFICE USE ONLY
F Letter of Confidentiality Attached
C Wireline Log Received
C Drillers Timelog Received
Distribution
 KCC SWD/Rep NGPA
 KGS Plug Other
(Specify)
12-2-88 14

Sec 24 Twp 8 Rge 18

Operator Name The Gene Brown Company Lease Name..... Pearl McMillen Well #..... 6

Sec..... 24 Twp..... 8 Rge..... 18 East West County..... Rooks

WELL LOG

INSTRUCTIONS: Show important tops and base of formations penetrated. Detail all cores. Report all drill stem tests giving interval tested, time tool open and closed, flowing and shut-in pressures, whether shut-in pressure reached static level, hydrostatic pressures, bottom hole temperature, fluid recovery, and flow rates if gas to surface during test. Attach extra sheet if more space is needed. Attach copy of log.

Drill Stem Tests Taken Yes No
 Samples Sent to Geological Survey Yes No
 Cores Taken Yes No

Formation Description
 Log Sample

Name	Top	Bottom
Anhydrite	1313	
Topeka	2906	
Hebner	3116	
Toronto	3139	
K.C	3158-3383	
Arbuckle	3416	

CASING RECORD <input type="checkbox"/> New <input type="checkbox"/> Used							
Report all strings set-conductor, surface, intermediate, production, etc.							
Purpose of String	Size Hole Drilled	Size Casing Set (in O.D.)	Weight Lbs/Ft.	Setting Depth	Type of Cement	#Sacks Used	Type and Percent Additives
Surface	12 1/4"	8-5/8"	20	212'	Class A Common	140	3%cc
Production	7 7/8	4 1/2"	10 1/2	3508	60/40poz	175	2%gel/10%salt/3#gilsonit
PERFORATION RECORD				Acid, Fracture, Shot, Cement Squeeze Record			
Shots Per Foot	Specify Footage of Each Interval Perforated			Amount and Kind of Material Used		Depth	
3	3420-50			3000 gal. 20% acid		3420-50	
1	3317 & 3333 & 3358			2250 gal. 15% acid			
1	3197 & 3202 & 3216			2250 gal. 15% acid		3141 - 3858	
1	3141 & 3162			1500 gal. 15% acid			
TUBING RECORD				Liner Run <input type="checkbox"/> Yes <input checked="" type="checkbox"/> No			
Size 2 3/8		Set At 3460		Packer at			
Date of First Production		Producing Method					
10-18-88		<input type="checkbox"/> Flowing <input checked="" type="checkbox"/> Pumping <input type="checkbox"/> Gas Lift <input type="checkbox"/> Other (explain).....					
Estimated Production Per 24 Hours		Oil	Gas	Water	Gas-Oil Ratio	Gravity	
14 Bbls			MCF	100 Bbls	CFPB	32	

METHOD OF COMPLETION

Production Interval

Disposition of gas: Vented Open Hole Perforation
 Sold Other (Specify)
 Used on Lease Dually Completed Commingled

Arbuckle 3420
 3450
 LKC 3158
 3360



REMIT TO:
P.O. BOX 651046
DALLAS, TX 75266

HALLIBURTON SERVICES 15-163-23011-00-00

INVOICE

A Halliburton Company

INVOICE NO.	DATE
650695	10/08/1988

WELL LEASE NO./PLANT NAME		WELL/PLANT LOCATION		STATE	WELL/PLANT OWNER
PEARL MC MILLER 6		ROOKS		KS	SAME
SERVICE LOCATION		CONTRACTOR	JOB PURPOSE		TICKET DATE
HAYS		BILLS WELL SERV.	SQUEEZE PERFORATIONS		10/08/1988
ACCT. NO.	CUSTOMER AGENT	VENDOR NO.	CUSTOMER P.O. NUMBER	SHIPPED VIA	FILE NO.
104600	THOMAS M. BROWN			COMPANY TRUCK	65966

DIRECT CORRESPONDENCE TO:

GENE BROWN CO
407 SO MAIN
PLAINVILLE, KS 67663

SUITE 600
COLORADO DERBY BUILDING
WICHITA, KS 67202-0000

PRICE REF. NO.	DESCRIPTION	QUANTITY	U/M	UNIT PRICE	AMOUNT
000-117	MILEAGE	9	MI	2.20	19.80
		1	UNT		
009-114	SQUEEZING CEMENT	1280	FF	787.00	787.00
007-019		1	UNT		
504-118	HALLIBURTON LIGHT CEMENT - PREM	275	SK	4.92	1,353.00
504-308	STANDARD CEMENT	45	SK	5.45	245.25
506-105	POZMIX-A	30	SK	2.88	86.40
509-406	ANHYDROUS CALCIUM CHLORIDE	2	SK	25.75	51.50
507-210	FLOCELE	69	LB	1.21	83.49
510-222	SACKED SAND 20/40 & SMALLER	2	SK	7.95	15.90
500-207	BULK SERVICE CHARGE	354	CFT	.95	336.30
509-306	MILEAGE	145.053	TMI	.70	101.54
INVOICE SUBTOTAL					3,080.18
DISCOUNT - (BID)					462.00
INVOICE BID AMOUNT					2,618.18
*- KANSAS STATE SALES TAX					76.75
*- HAYS CITY SALES TAX					9.59
RECEIVED STATE CORPORATION COMMISSION DEC 15 1988 Dec 15, 1988 CONSERVATION DIVISION Wichita, Kansas					
INVOICE TOTAL PLEASE PAY THIS AMOUNT					\$2,704.52

TERMS INVOICES PAYABLE NET BY THE 20TH OF THE FOLLOWING MONTH AFTER DATE OF INVOICE. UPON CUSTOMER'S DEFAULT IN PAYMENT OF CUSTOMER'S ACCOUNT BY THE LAST DAY OF THE MONTH FOLLOWING THE MONTH IN WHICH THE INVOICE IS DATED, CUSTOMER AGREES TO PAY INTEREST THEREON AFTER DEFAULT AT THE HIGHEST LAWFUL CONTRACT RATE APPLICABLE BUT NEVER TO EXCEED 18% PER ANNUM. IN THE EVENT IT BECOMES NECESSARY TO EMPLOY AN ATTORNEY TO ENFORCE COLLECTION OF SAID ACCOUNT, CUSTOMER AGREES TO PAY ALL COLLECTION COSTS AND ATTORNEY FEES IN THE AMOUNT OF 20% OF THE AMOUNT OF THE UNPAID ACCOUNT.