



For KCC Use: 8-28-07
 Effective Date: 8-28-07
 District # 2
 SGA? Yes No

KANSAS CORPORATION COMMISSION 1011600
 OIL & GAS CONSERVATION DIVISION

Form C-1
 November 2005
 Form must be Typed
 Form must be Signed
 All blanks must be Filled

NOTICE OF INTENT TO DRILL

Must be approved by KCC five (5) days prior to commencing well

Expected Spud Date: 09/10/2007
month day year

Spot Description: 180'E 90'N of C N/2 S/2 SW
N2 S2 SW Sec. 33 Twp. 25 S. R. 5 E W
(O/Q/Q/Q) 750 feet from N / S Line of Section
1,500 feet from E / W Line of Section

OPERATOR: License# 5030
 Name: Vess Oil Corporation
 Address 1: 1700 WATERFRONT PKWY BLDG 500
 Address 2:
 City: WICHITA State: KS Zip: 67206 + 6619
 Contact Person: Casey Coats
 Phone: 316-682-1537

Is SECTION: Regular Irregular?
 (Note: Locate well on the Section Plat on reverse side)
 County: Butler
 Lease Name: Pierpoint A Well #: 124
 Field Name: EL DORADO

CONTRACTOR: License# 32701
 Name: C & G Drilling, Inc.

Is this a Prorated / Spaced Field? Yes No
 Target Formation(s): Viola, Simpson
 Nearest Lease or unit boundary line (in footage): 750

Well Drilled For: Well Class: Type Equipment:
 Oil Enh Rec Infield Mud Rotary
 Gas Storage Pool Ext. Air Rotary
 Disposal Wildcat Cable
 Seismic; # of Holes Other
 Other:
 If OWWO: old well information as follows:

Ground Surface Elevation: 1334 feet MSL
 Water well within one-quarter mile: Yes No
 Public water supply well within one mile: Yes No

Operator: _____
 Well Name: _____
 Original Completion Date: _____ Original Total Depth: _____

Depth to bottom of fresh water: 160
 Depth to bottom of usable water: 180
 Surface Pipe by Alternate: I II
 Length of Surface Pipe Planned to be set: 250
 Length of Conductor Pipe (if any): 0

Directional, Deviated or Horizontal wellbore? Yes No
 If Yes, true vertical depth: _____
 Bottom Hole Location: _____
 KCC DKT #: _____

Projected Total Depth: 2500
 Formation at Total Depth: Simpson
 Water Source for Drilling Operations:
 Well Farm Pond Other: trucked
 DWR Permit #: _____

(Note: Apply for Permit with DWR)
 Will Cores be taken? Yes No
 If Yes, proposed zone: _____

AFFIDAVIT

The undersigned hereby affirms that the drilling, completion and eventual plugging of this well will comply with K.S.A. 55 et. seq.
 It is agreed that the following minimum requirements will be met:

RECEIVED
 KANSAS CORPORATION COMMISSION

1. Notify the appropriate district office **prior** to spudding of well;
2. A copy of the approved notice of intent to drill **shall be** posted on each drilling rig;
3. The minimum amount of surface pipe as specified below **shall be set** by circulating cement to the top; in all cases surface pipe **shall be set** through all unconsolidated materials plus a minimum of 20 feet into the underlying formation.
4. If the well is dry hole, an agreement between the operator and the district office on plug length and placement is necessary **prior to plugging**;
5. The appropriate district office will be notified before well is either plugged or production casing is cemented in;
6. If an ALTERNATE II COMPLETION, production pipe shall be cemented from below any usable water to surface within **120 DAYS** of spud date. Or pursuant to Appendix "B" - Eastern Kansas surface casing order #133,891-C, which applies to the KCC District 3 area, alternate II cementing must be completed within 30 days of the spud date or the well shall be plugged. **In all cases, NOTIFY district office** prior to any cementing.

AUG 23 2007

CONSERVATION DIVISION
 WICHITA, KS

I hereby certify that the statements made herein are true and to the best of my knowledge and belief.

Date: 8/22/07 Signature of Operator or Agent: Casey Coats Title: Operations Engineer

For KCC Use ONLY
 API # 15 - 015-23747-0000
 Conductor pipe required 0 feet
 Minimum surface pipe required 200 feet per ALT. I II
 Approved by: Casey Coats
 This authorization expires: 2-23-08
 (This authorization void if drilling not started within 6 months of approval date.)
 Spud date: _____ Agent: _____

Remember to:

- File Drill Pit Application (form CDP-1) with Intent to Drill;
- File Completion Form ACO-1 within 120 days of spud date;
- File acreage attribution plat according to field proration orders;
- Notify appropriate district office 48 hours prior to workover or re-entry;
- Submit plugging report (CP-4) after plugging is completed (within 60 days);
- Obtain written approval before disposing or injecting salt water.
- If this permit has expired (See: authorized expiration date) please check the box below and return to the address below.

Well Not Drilled - Permit Expired Date: _____
 Signature of Operator or Agent: _____

33
 25
 5
 E W



1011600

IN ALL CASES PLOT THE INTENDED WELL ON THE PLAT BELOW

Plat of acreage attributable to a well in a prorated or spaced field

If the intended well is in a prorated or spaced field, please fully complete this side of the form. If the intended well is in a prorated or spaced field complete the plat below showing that the well will be properly located in relationship to other wells producing from the common source of supply. Please show all the wells and within 1 mile of the boundaries of the proposed acreage attribution unit for gas wells and within 1/2 mile of the boundaries of the proposed acreage attribution unit for oil wells.

API No. 15 - 015-23747-0000
Operator: Vess Oil Corporation
Lease: Pierpoint A
Well Number: 124
Field: EL DORADO

Location of Well: County: Butler
750 feet from N / S Line of Section
1,500 feet from E / W Line of Section
Sec. 33 Twp. 25 S. R. 5 E W

Number of Acres attributable to well: _____
QTR/QTR/QTR/QTR of acreage: _____ - N2 - S2 - SW

Is Section: Regular or Irregular

If Section is Irregular, locate well from nearest corner boundary.

Section corner used: NE NW SE SW

PLAT

(Show location of the well and shade attributable acreage for prorated or spaced wells.)

(Show footage to the nearest lease or unit boundary line.)

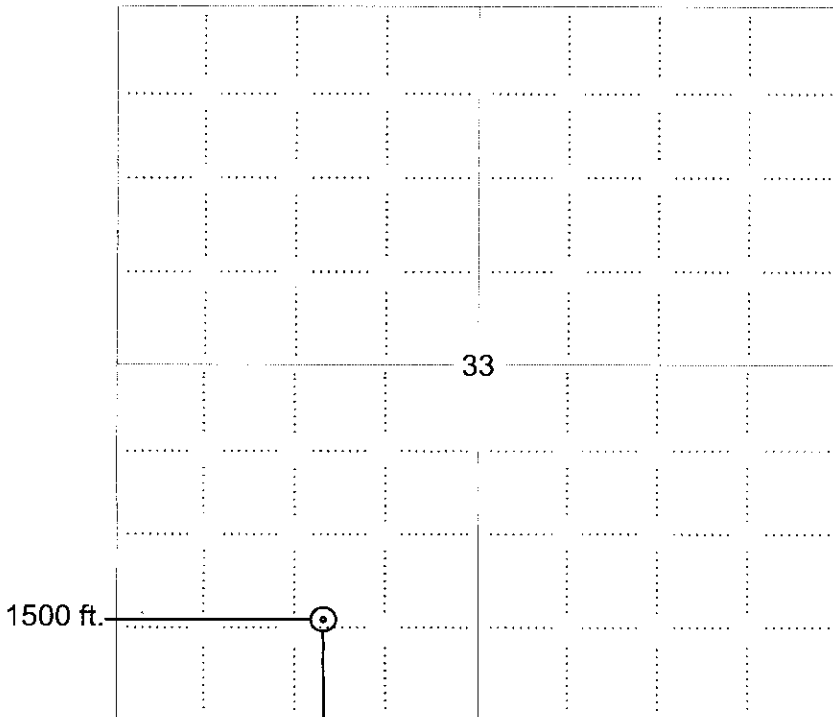

NOTE: In all cases locate the spot of the proposed drilling locaton.

750 ft.

RECEIVED
KANSAS CORPORATION COMMISSION

AUG 23 2007

CONSERVATION DIVISION
WICHITA, KS

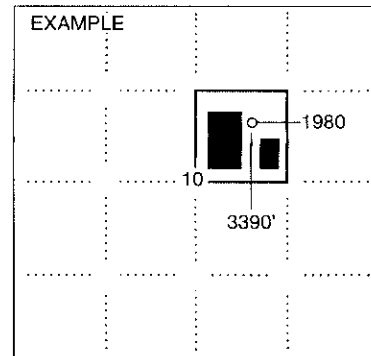

SEWARD CO.

In plotting the proposed location of the well, you must show:

1. The manner in which you are using the depicted plat by identifying section lines, i.e. 1 section, 1 section with 8 surrounding sections, 4 sections, etc.
2. The distance of the proposed drilling location from the south / north and east / west outside section lines.
3. The distance to the nearest lease or unit boundary line (in footage).
4. If proposed location is located within a prorated or spaced field a certificate of acreage attribution plat must be attached: (CO-7 for oil wells; CG-8 for gas wells).



KANSAS CORPORATION COMMISSION 1011600
 OIL & GAS CONSERVATION DIVISION
APPLICATION FOR SURFACE PIT

Form CDP-1
 April 2004
 Form must be Typed

Submit in Duplicate

| | | | |
|--|--|--|--|
| Operator Name: Vess Oil Corporation | | License Number: 5030 | |
| Operator Address: 1700 WATERFRONT PKWY BLDG 500 | | WICHITA KS 67206 | |
| Contact Person: Casey Coats | | Phone Number: 316-682-1537 | |
| Lease Name & Well No.: Pierpoint A 124 | | Pit Location (QQQQ): N2 S2 SW | |
| Type of Pit: <input type="checkbox"/> Emergency Pit <input type="checkbox"/> Burn Pit <input type="checkbox"/> Settling Pit <input checked="" type="checkbox"/> Drilling Pit <input type="checkbox"/> Workover Pit <input type="checkbox"/> Haul-Off Pit <small>(If WP Supply API No. or Year Drilled)</small> | Pit is: <input checked="" type="checkbox"/> Proposed <input type="checkbox"/> Existing If Existing, date constructed: _____ Pit capacity: 3,000 (bbls) | Sec. 33 Twp. 25 R. 5 <input checked="" type="checkbox"/> East <input type="checkbox"/> West 750 Feet from <input type="checkbox"/> North / <input checked="" type="checkbox"/> South Line of Section 1,500 Feet from <input type="checkbox"/> East / <input checked="" type="checkbox"/> West Line of Section Butler County | |
| Is the pit located in a Sensitive Ground Water Area? <input type="checkbox"/> Yes <input checked="" type="checkbox"/> No | | Chloride concentration: _____ mg/l <small>(For Emergency Pits and Settling Pits only)</small> | |
| Is the bottom below ground level? <input checked="" type="checkbox"/> Yes <input type="checkbox"/> No | Artificial Liner? <input type="checkbox"/> Yes <input checked="" type="checkbox"/> No | How is the pit lined if a plastic liner is not used? clay soil and bentonite mud | |
| Pit dimensions (all but working pits): 100 Length (feet) 100 Width (feet) <input type="checkbox"/> N/A: Steel Pits | | Depth from ground level to deepest point: 3 (feet) <input type="checkbox"/> No | |
| If the pit is lined give a brief description of the liner material, thickness and installation procedure. | | Describe procedures for periodic maintenance and determining liner integrity, including any special monitoring. RECEIVED AUG 23 2007 KANSAS CORPORATION COMMISSION CONSERVATION DIVISION WICHITA, KS | |
| Distance to nearest water well within one-mile of pit 3733 feet Depth of water well 12 feet | | Depth to shallowest fresh water 11 feet. Source of information: <input type="checkbox"/> measured <input type="checkbox"/> well owner <input type="checkbox"/> electric log <input checked="" type="checkbox"/> KDWR | |
| Emergency, Settling and Burn Pits ONLY: Producing Formation: _____ Number of producing wells on lease: _____ Barrels of fluid produced daily: _____ Does the slope from the tank battery allow all spilled fluids to flow into the pit? <input type="checkbox"/> Yes <input type="checkbox"/> No | | Drilling, Workover and Haul-Off Pits ONLY: Type of material utilized in drilling/workover: bentonite mud Number of working pits to be utilized: 3 Abandonment procedure: Let dry, push rock and clay in, put top soil on top, compact and we-level. Drill pits must be closed within 365 days of spud date. | |
| I hereby certify that the above statements are true and correct to the best of my knowledge and belief. | | | |
| 8/22/07 Date | | Casey Coats Signature of Applicant or Agent | |

| | | | | |
|-------------------------------|----------------------|------------------------------------|---|-------------------------------|
| KCC OFFICE USE ONLY | | Steel Pit <input type="checkbox"/> | RFAC <input type="checkbox"/> | RFAS <input type="checkbox"/> |
| Date Received: 8/23/07 | Permit Number: _____ | Permit Date: 8/23/07 | Lease Inspection: <input type="checkbox"/> Yes <input checked="" type="checkbox"/> No | |

Mail to: KCC - Conservation Division, 130 S. Market - Room 2078, Wichita, Kansas 67202

15-015-23747-0000