



For KCC Use: **829-07**  
 Effective Date: \_\_\_\_\_  
 District # 1  
 SGA?  Yes  No

KANSAS CORPORATION COMMISSION 1011540  
 OIL & GAS CONSERVATION DIVISION

Form C-1  
 November 2005  
**Form must be Typed**  
**Form must be Signed**  
**All blanks must be Filled**

**NOTICE OF INTENT TO DRILL**

Must be approved by KCC five (5) days prior to commencing well

Expected Spud Date: 09/15/2007  
month day year

OPERATOR: License# 5030  
 Name: Vess Oil Corporation  
 Address 1: 1700 WATERFRONT PKWY BLDG 500  
 Address 2: \_\_\_\_\_  
 City: WICHITA State: KS Zip: 67206 + 6619  
 Contact Person: Casey Coats  
 Phone: 316-682-1537

CONTRACTOR: License# 5822  
 Name: Val Energy, Inc.

<b>Well Drilled For:</b>	<b>Well Class:</b>	<b>Type Equipment:</b>
<input checked="" type="checkbox"/> Oil	<input type="checkbox"/> Enh Rec	<input checked="" type="checkbox"/> Mud Rotary
<input type="checkbox"/> Gas	<input type="checkbox"/> Storage	<input type="checkbox"/> Air Rotary
	<input type="checkbox"/> Disposal	<input type="checkbox"/> Cable
<input type="checkbox"/> Seismic ; _____ # of Holes	<input type="checkbox"/> Pool Ext.	
<input type="checkbox"/> Other: _____	<input type="checkbox"/> Wildcat	
	<input type="checkbox"/> Other	

If OWWO: old well information as follows:

Operator: \_\_\_\_\_  
 Well Name: \_\_\_\_\_  
 Original Completion Date: \_\_\_\_\_ Original Total Depth: \_\_\_\_\_

Directional, Deviated or Horizontal wellbore?  Yes  No  
 If Yes, true vertical depth: \_\_\_\_\_  
 Bottom Hole Location: \_\_\_\_\_  
 KCC DKT #: \_\_\_\_\_

Spot Description: 150'S W/2 W/2 NE  
 - W2 - W2 - NE Sec. 3 Twp. 31 S. R. 24  E  W  
(1/4-0/0)  
1,470 feet from  N /  S Line of Section  
2,310 feet from  E /  W Line of Section  
 Is SECTION:  Regular  Irregular?

(Note: Locate well on the Section Plat on reverse side)  
 County: Clark  
 Lease Name: McFadden Well #: 1-3  
 Field Name: ARDREY  
 Is this a Prorated / Spaced Field?  Yes  No  
 Target Formation(s): Morrow, Mississippi  
 Nearest Lease or unit boundary line (in footage): 330  
 Ground Surface Elevation: 2545 feet MSL  
 Water well within one-quarter mile:  Yes  No  
 Public water supply well within one mile:  Yes  No  
 Depth to bottom of fresh water: 150  
 Depth to bottom of usable water: 300  
 Surface Pipe by Alternate:  I  II  
 Length of Surface Pipe Planned to be set: 700  
 Length of Conductor Pipe (if any): 60  
 Projected Total Depth: 5600  
 Formation at Total Depth: Mississippi  
 Water Source for Drilling Operations:  
 Well  Farm Pond  Other: trucked  
 DWR Permit #: \_\_\_\_\_  
 (Note: Apply for Permit with DWR )  
 Will Cores be taken?  Yes  No  
 If Yes, proposed zone: \_\_\_\_\_

**AFFIDAVIT**

The undersigned hereby affirms that the drilling, completion and eventual plugging of this well will comply with K.S.A. 55 et. seq. RECEIVED  
 It is agreed that the following minimum requirements will be met: KANSAS CORPORATION COMMISSION

1. Notify the appropriate district office **prior** to spudding of well;
2. A copy of the approved notice of intent to drill **shall be** posted on each drilling rig;
3. The minimum amount of surface pipe as specified below **shall be set** by circulating cement to the top; in all cases surface pipe **shall be set** through all unconsolidated materials plus a minimum of 20 feet into the underlying formation.
4. If the well is dry hole, an agreement between the operator and the district office on plug length and placement is necessary **prior to plugging**;
5. The appropriate district office will be notified before well is either plugged or production casing is cemented in;
6. If an ALTERNATE II COMPLETION, production pipe shall be cemented from below any usable water to surface within **120 DAYS** of spud date. Or pursuant to Appendix "B" - Eastern Kansas surface casing order #133,891-C, which applies to the KCC District 3 area, alternate II cementing must be completed within 30 days of the spud date or the well shall be plugged. **In all cases, NOTIFY district office** prior to any cementing.

I hereby certify that the statements made herein are true and to the best of my knowledge and belief.  
 Date: 8-28-2007 Signature of Operator or Agent: Casey Coats Title: Operations Engineer

**For KCC Use ONLY**

API # 15 - 025-21425-0000

Conductor pipe required 0 feet

Minimum surface pipe required 320 feet per ALT.  I  II

Approved by: PH 8-24-07

This authorization expires: 2-24-08  
(This authorization void if drilling not started within 6 months of approval date.)

Spud date: \_\_\_\_\_ Agent: \_\_\_\_\_

- Remember to:**
- File Drill Pit Application (form CDP-1) with Intent to Drill;
  - File Completion Form ACO-1 within 120 days of spud date;
  - File acreage attribution plat according to field proration orders;
  - Notify appropriate district office 48 hours prior to workover or re-entry;
  - Submit plugging report (CP-4) after plugging is completed (within 60 days);
  - Obtain written approval before disposing or injecting salt water.
  - If this permit has expired (See: authorized expiration date) please check the box below and return to the address below.
- Well Not Drilled - Permit Expired Date: \_\_\_\_\_  
 Signature of Operator or Agent: \_\_\_\_\_

Mail to: KCC - Conservation Division, 130 S. Market - Room 2078, Wichita, Kansas 67202

**AUG 24 2007**  
 CONSERVATION DIVISION  
 WICHITA, KS

3  
31  
24  
 E  
 W



1011540

**IN ALL CASES PLOT THE INTENDED WELL ON THE PLAT BELOW**

*Plat of acreage attributable to a well in a prorated or spaced field*

**If the intended well is in a prorated or spaced field, please fully complete this side of the form.** If the intended well is in a prorated or spaced field complete the plat below showing that the well will be properly located in relationship to other wells producing from the common source of supply. Please show all the wells and within 1 mile of the boundaries of the proposed acreage attribution unit for gas wells and within 1/2 mile of the boundaries of the proposed acreage attribution unit for oil wells.

API No. 15 - 025-21425-0000  
Operator: Vess Oil Corporation  
Lease: McFadden  
Well Number: 1-3  
Field: ARDREY

Location of Well: County: Clark  
1,470 feet from  N /  S Line of Section  
2,310 feet from  E /  W Line of Section  
Sec. 3 Twp. 31 S. R. 24  E  W

Number of Acres attributable to well: \_\_\_\_\_  
QTR/QTR/QTR/QTR of acreage: \_\_\_\_\_ - W2 - W2 - NE

Is Section:  Regular or  Irregular

**If Section is Irregular, locate well from nearest corner boundary.**

Section corner used:  NE  NW  SE  SW

**PLAT**

*(Show location of the well and shade attributable acreage for prorated or spaced wells.)  
(Show footage to the nearest lease or unit boundary line.)*

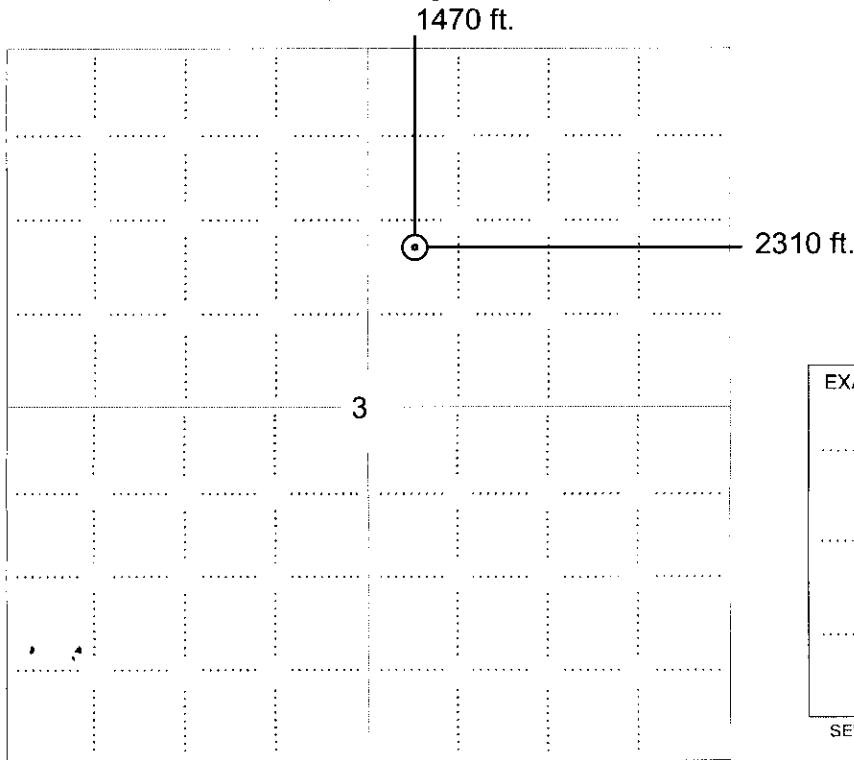

RECEIVED  
KANSAS CORPORATION COMMISSION

AUG 24 2007

CONSERVATION DIVISION  
WICHITA, KS

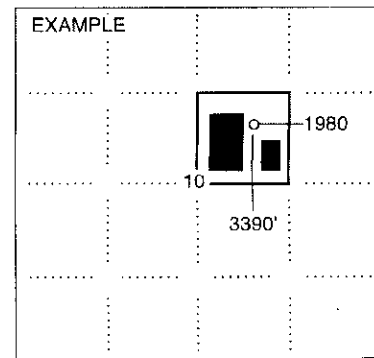

**NOTE: In all cases locate the spot of the proposed drilling location.**

**In plotting the proposed location of the well, you must show:**

1. The manner in which you are using the depicted plat by identifying section lines, i.e. 1 section, 1 section with 8 surrounding sections, 4 sections, etc.
2. The distance of the proposed drilling location from the south / north and east / west outside section lines.
3. The distance to the nearest lease or unit boundary line (in footage).
4. If proposed location is located within a prorated or spaced field a certificate of acreage attribution plat must be attached: (CO-7 for oil wells; CG-8 for gas wells).



KANSAS CORPORATION COMMISSION 1011540  
OIL & GAS CONSERVATION DIVISION

Form CDP-1  
April 2004  
Form must be Typed

APPLICATION FOR SURFACE PIT

Submit in Duplicate

Operator Name: <b>Vess Oil Corporation</b>		License Number: <b>5030</b>	
Operator Address: <b>1700 WATERFRONT PKWY BLDG 500</b>		<b>WICHITA KS 67206</b>	
Contact Person: <b>Casey Coats</b>		Phone Number: <b>316-682-1537</b>	
Lease Name & Well No.: <b>McFadden 1-3</b>		Pit Location (QQQQ): <b>W2 W2 NE</b>	
Type of Pit: <input type="checkbox"/> Emergency Pit <input type="checkbox"/> Burn Pit <input type="checkbox"/> Settling Pit <input checked="" type="checkbox"/> Drilling Pit <input type="checkbox"/> Workover Pit <input type="checkbox"/> Haul-Off Pit <small>(If WP Supply API No. or Year Drilled)</small>		Pit is: <input checked="" type="checkbox"/> Proposed <input type="checkbox"/> Existing if Existing, date constructed: _____ Pit capacity: <b>2,000</b> (bbls)	
Is the pit located in a Sensitive Ground Water Area? <input checked="" type="checkbox"/> Yes <input type="checkbox"/> No		Chloride concentration: _____ mg/l <small>(For Emergency Pits and Settling Pits only)</small>	
Is the bottom below ground level? <input checked="" type="checkbox"/> Yes <input type="checkbox"/> No		Artificial Liner? <input type="checkbox"/> Yes <input checked="" type="checkbox"/> No	
How is the pit lined if a plastic liner is not used? <b>clay, rock, bentonite mud</b>			
Pit dimensions (all but working pits): <b>125</b> Length (feet) <b>125</b> Width (feet) <input type="checkbox"/> N/A: Steel Pits Depth from ground level to deepest point: <b>4</b> (feet) <input type="checkbox"/> No Pit			
If the pit is lined give a brief description of the liner material, thickness and installation procedure.		Describe procedures for periodic maintenance of liner integrity, including any special monitoring.	
		<b>RECEIVED</b> KANSAS CORPORATION COMMISSION <b>AUG 24 2007</b> CONSERVATION DIVISION WICHITA, KS	
Distance to nearest water well within one-mile of pit <b>2163</b> feet    Depth of water well <b>140</b> feet		Depth to shallowest fresh water <b>107</b> feet. Source of information: <input type="checkbox"/> measured <input type="checkbox"/> well owner <input type="checkbox"/> electric log <input checked="" type="checkbox"/> KDWR	
<b>Emergency, Settling and Burn Pits ONLY:</b> Producing Formation: _____ Number of producing wells on lease: _____ Barrels of fluid produced daily: _____ Does the slope from the tank battery allow all spilled fluids to flow into the pit? <input type="checkbox"/> Yes <input type="checkbox"/> No		<b>Drilling, Workover and Haul-Off Pits ONLY:</b> Type of material utilized in drilling/workover: <b>bentonite mud</b> Number of working pits to be utilized: <b>3</b> Abandonment procedure: <b>let dry, remove free water, push back in, add topsoil and compact. Pits will be steel.</b> Drill pits must be closed within 365 days of spud date.	
I hereby certify that the above statements are true and correct to the best of my knowledge and belief.			
<b>8-23-07</b> Date		<b>Casey Coats</b> Signature of Applicant or Agent	
<b>KCC OFFICE USE ONLY</b> Steel Pit <input type="checkbox"/> RFAC <input checked="" type="checkbox"/> RFAS <input checked="" type="checkbox"/>			
Date Received: <b>8/24/07</b> Permit Number: _____    Permit Date: <b>8/24/07</b> Lease Inspection: <input checked="" type="checkbox"/> Yes <input type="checkbox"/> No			

15-025-21425-000



*Kathleen Sebelius, Governor  
Thomas E. Wright, Chairman  
Michael C. Moffet, Commissioner  
Joseph F. Harkins, Commissioner*

August 22, 2007

Casey Coats  
Vess Oil Corporation  
1700 WATERFRONT PKWY BLDG 500  
WICHITA, KS67206-6619

Re: Drilling Pit Application  
McFadden Lease Well No. 1-3  
NE/4 Sec.03-31S-24W  
Clark County, Kansas

Dear Casey Coats:

District staff has inspected the above referenced location and has determined that the reserve pit shall be constructed **without slots**, the bottom shall be flat and reasonably level and the free fluids must be removed. The fluids are to be removed from the reserve pit as soon as the Hutchinson Salt section has been drilled through and displacement of the fluids into the reserve pit has occurred. The fluids should be removed again as soon as practical after drilling operations have ceased.

**If production casing is set all completion fluids shall be removed from the working pits daily. NO completion fluids or non-exempt wastes shall be placed in the reserve pit.**

The fluids should be taken to an authorized disposal well. Please call the District Office at (620) 225-8888 when the fluids have been removed. Please file form CDP-5 (August 2004), Exploration and Production Waste Transfer, within 30 days of fluid removal. Conservation division forms are available through our office and on the KCC web site:  
[kcc.ks.gov/conservation/forms/](http://kcc.ks.gov/conservation/forms/)

**A copy of this letter should be posted in the doghouse along with the approved Intent to Drill.** If you have any questions or concerns please feel free to contact the District Office at (620) 225-8888.