

For KCC Use: 9-3-07
 Effective Date: 9-3-07
 District #: 2
 SGA? Yes No

KANSAS CORPORATION COMMISSION
 OIL & GAS CONSERVATION DIVISION

Form C-1
 December 2002
 Form must be Typed
 Form must be Signed
 All blanks must be Filled

NOTICE OF INTENT TO DRILL

Must be approved by KCC five (5) days prior to commencing well

Expected Spud Date 09 02 07
 month day year

OPERATOR: License# 5210
 Name: Lebsack Oil Production
 Address: P. O. Box 489
 City/State/Zip: Hays, KS 67601-0489
 Contact Person: Rex Curtis
 Phone: (785) 625-5444

CONTRACTOR: License# 5142
 Name: Sterling Drilling Company

Well Drilled For:	Well Class:	Type Equipment:
<input checked="" type="checkbox"/> Oil	<input type="checkbox"/> Enh Rec	<input checked="" type="checkbox"/> Mud Rotary
<input type="checkbox"/> Gas	<input type="checkbox"/> Storage	<input type="checkbox"/> Air Rotary
<input type="checkbox"/> OAWO	<input type="checkbox"/> Disposal	<input type="checkbox"/> Cable
<input type="checkbox"/> Seismic; # of Holes	<input checked="" type="checkbox"/> Wildcat	
<input type="checkbox"/> Other	<input type="checkbox"/> Other	

If OWWO: old well information as follows:
 Operator: _____
 Well Name: _____
 Original Completion Date: _____ Original Total Depth: _____
 Directional, Deviated or Horizontal wellbore? Yes No
 If Yes, true vertical depth: _____
 Bottom Hole Location: _____
 KCC DKT #: _____

Spot 160' E. & 180'S of
 Nw Se Se Sec. 28 Twp. 20 S. R. 10
 East
 West
 810' _____ feet from N / S Line of Section
 830' _____ feet from E / W Line of Section
 Is SECTION Regular Irregular?

(Note: Locate well on the Section Plat on reverse side)

County: Rice
 Lease Name: Caywood Well #: 1
 Field Name: Grove

Is this a Prorated / Spaced Field? Yes No
 Target Information(s): Chase Group, Lansing and Arbuckle
 Nearest Lease or unit boundary: 810'

Ground Surface Elevation: 1722' (Actual Elevation) _____ feet MSL

Water well within one-quarter mile: Yes No

Public water supply well within one mile: Yes No

Depth to bottom of fresh water: 120' Est

Depth to bottom of usable water: 200' Est

Surface Pipe by Alternate: 1 2

Length of Surface Pipe Planned to be set: 250'

Length of Conductor Pipe required: None

Projected Total Depth: 3350'

Formation at Total Depth: Arbuckle

Water Source for Drilling Operations:

Well Farm Pond Other

DWR Permit #: SDC will apply for

(Note: Apply for Permit with DWR)

Will Cores be taken? Yes No

If Yes, proposed zone: _____

AFFIDAVIT

The undersigned hereby affirms that the drilling, completion and eventual plugging of this well will comply with K.S.A. 55 et. seq.

It is agreed that the following minimum requirements will be met:

1. Notify the appropriate district office **prior** to spudding of well;
2. A copy of the approved notice of intent to drill **shall be** posted on each drilling rig;
3. The minimum amount of surface pipe as specified below **shall be set** by circulating cement to the top; in all cases surface pipe shall be set through all unconsolidated materials plus a minimum of 20 feet into the underlying formation.
4. If the well is dry hole, an agreement between the operator and the district office on plug length and placement is necessary **prior to plugging**;
5. The appropriate district office will be notified before well is either plugged or production casing is cemented in;
6. If an ALTERNATE II COMPLETION, production pipe shall be cemented from below any usable water to surface within **120 days** of spud date. Or pursuant to Appendix "B" - Eastern Kansas surface casing order #133,891-C, which applies to the KCC District 3 area, alternate II cementing must be completed within 30 days of the spud date or the well shall be plugged. **In all cases, NOTIFY district office** prior to any cementing.

I hereby certify that the statements made herein are true and to the best of my knowledge and belief.

Date: 08/22/07 Signature of Operator or Agent: _____ Title: Steve McClain, Agent

RECEIVED
 KANSAS CORPORATION COMMISSION

AUG 24 2007

CONSERVATION DIVISION
 WICHITA, KS

Remember to:

- File Drill Pit Application (form CDP-1) with Intent to Drill;
- File Completion Form ACO-1 within 120 days of spud date;
- File acreage attribution plat according to field proration orders;
- Notify appropriate district office 48 hours prior to workover or re-entry;
- Submit plugging report (CP-4) after plugging is completed;
- Obtain written approval before disposing or injecting salt water.
- If this permit has expired (See: authorized expiration date) please check the box below and return to the address below.

Well Not Drilled - Permit Expired

Signature of Operator or Agent: _____

Date: _____

For KCC Use ONLY
 API # 15 - 159-22548-0000
 Conductor pipe required None feet
 Minimum surface pipe required 220 feet per Alt. 1
 Approved by: KM 8-29-07
 This authorization expires: 2-29-08
 (This authorization void if drilling not started within 6 months of effective date.)
 Spud date: _____ Agent: _____

Mail to: KCC - Conservation Division, 130 S. Market - Room 2078, Wichita, Kansas 67202

28
20
10W

IN ALL CASES PLOT THE INTENDED WELL ON THE PLAT BELOW

Plat of acreage attributable to a well in a prorated or spaced field

If the intended well is in a prorated or spaced field, please fully complete this side of the form. If the intended well is in a prorated or spaced field complete the plat below showing that the well will be properly located in relationship to other wells producing from the common source of supply. Please show all the wells and within 1 mile of the boundaries of the proposed acreage attribution unit for gas wells and within 1/2 mile of the boundaries of the proposed acreage attribution unit for oil wells.

API No. 15 - 159-22548-0000
 Operator: Lebsack Oil Production
 Lease: Caywood
 Well Number: 1
 Field: Grove
 Number of Acres attributable to well: 160
 QTR / QTR / QTR of acreage: Nw - Se - Se

Location of Well: County: Rice
810' feet from N / S Line of Section
830' feet from E / W Line of Section
 Sec. 28 Twp. 20 S. R. 10 East West

Is Section: Regular or Irregular

If Section Is Irregular, locate well from nearest corner boundary.
 Section corner used: NE NW SE SW

PLAT

*(Show location of the well and shade acreage attributable for prorated or spaced wells.)
 (Show footage to the nearest lease or unit boundary line.)*

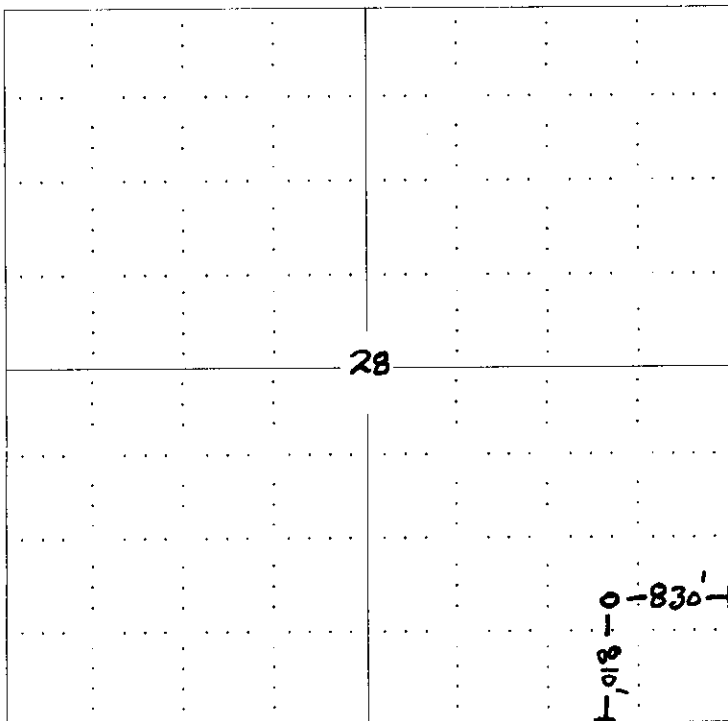

RECEIVED
 KANSAS CORPORATION COMMISSION

AUG 24 2007

CONSERVATION DIVISION
 WICHITA, KS

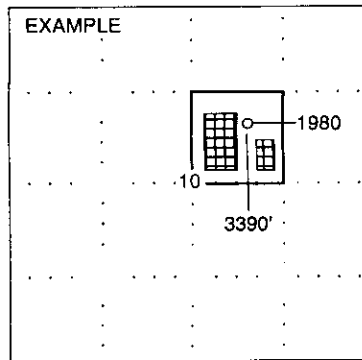

NOTE: In all cases locate the spot of the proposed drilling location.

In plotting the proposed location of the well, you must show:

1. The manner in which you are using the depicted plat by identifying section lines, i.e. 1 section, 1 section with 8 surrounding sections, 4 sections, etc.
2. The distance of the proposed drilling location from the section's south / north and east / west.
3. The distance to the nearest lease or unit boundary line.
4. If proposed location is located within a prorated or spaced field a certificate of acreage attribution plat must be attached: (CO-7 for oil wells; CG-8 for gas wells).

**KANSAS CORPORATION COMMISSION
OIL & GAS CONSERVATION DIVISION
APPLICATION FOR SURFACE POND**

Form CDP-1
January 2001
Form must be Typed

Submit in Duplicate

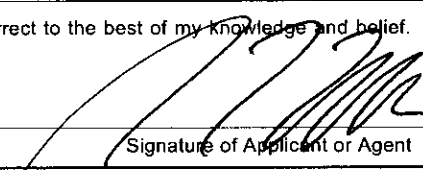
Operator Name: Lebsack Oil Production, Inc.		License Number: 5210
Operator Address: P O Box 489, Hays, Kansas 67601-0489		
Contact Person: Rex Curtis		Phone Number: (785) 625 - 5444
Lease Name: Caywood #1		Pit Location:
Type of Pond: <input type="checkbox"/> Emergency Pit <input type="checkbox"/> Treatment Pit <input type="checkbox"/> Workover Pit <input checked="" type="checkbox"/> Drilling Pit <input type="checkbox"/> Burn Pit <small>(If WP Supply API No. or Year Drilled)</small>	Pit is: <input checked="" type="checkbox"/> Proposed <input type="checkbox"/> Existing If Existing, date constructed: _____ Pit capacity: 3,500 (bbls)	SE Qtr. Sec. 28 Twp. 20 R. 10 <input type="checkbox"/> E <input checked="" type="checkbox"/> W 810' Feet from N S (circle one) Line of Section 830' Feet from E W (circle one) Line of Section Rice _____ County
Is the pit located in a Sensitive Ground Water Area? <input checked="" type="checkbox"/> Yes <input type="checkbox"/> No		Chloride concentration: _____ mg/l <small>(For Emergency Pits and Treatment Pits only)</small>
Is the bottom below ground level? <input checked="" type="checkbox"/> Yes <input type="checkbox"/> No	Artificial Liner? <input type="checkbox"/> Yes <input checked="" type="checkbox"/> No	How is the pit lined if a plastic liner is not used? Bentonite
Pit dimensions (all but working pits): 75 Length (feet) 75 Width (feet) Depth from ground level to deepest point: 4 (feet)		
If the pit is lined give a brief description of the liner material, thickness and installation procedure.		Describe procedures for periodic maintenance and determining liner integrity, including any special monitoring.
_____ _____ _____		_____ _____ _____
Distance to nearest water well within one-mile of pit 990 feet Depth of water well 40 feet	Depth to shallowest fresh water 12' feet. Source of information: _____ measured <input checked="" type="checkbox"/> well owner _____ electric log _____ KDWR	RECEIVED KANSAS CORPORATION COMMISSION AUG 24 2007 CONSERVATION DIVISION WICHITA, KS
Emergency, Treatment and Burn Pits ONLY: Producing Formation: _____ Number of producing wells on lease: _____ Barrels of fluid produced daily: _____ Does the slope from the tank battery allow all spilled fluids to flow into the pond? <input type="checkbox"/> Yes <input type="checkbox"/> No	Drilling and Workover Pits ONLY: Type of material utilized in drilling/workover: Fresh water/Bentonite Number of working pits to be utilized: 3 Abandonment procedure: Haul off free fluids after Hutchinson Salt and at completion of drilling operations. Let dry and backfill. Drill pits must be closed within 365 days of spud date.	
I hereby certify that the above statements are true and correct to the best of my knowledge and belief.		
08/22/07 Date	 Signature of Applicant or Agent	
KCC OFFICE USE ONLY		
Date Received: 8/24/07 Permit Number: _____ Permit Date: 8/29/07 Lease Inspection: <input checked="" type="checkbox"/> Yes <input type="checkbox"/> No	Bent 5472	

15-159-22548-0000

Mail to: KCC - Conservation Division, 130 S. Market - Room 2078, Wichita, Kansas 67202



*Kathleen Sebelius, Governor
Thomas E. Wright, Chairman
Michael C. Moffet, Commissioner
Joseph F. Harkins, Commissioner*

August 29, 2007

Mr. Rex Curtis
Lebsack Oil Production
PO Box 489
Hays, KS 67601-0489

Re: Drilling Pit Application
Caywood Lease Well No. 1
SE/4 Sec. 28-20S-10W
Rice County, Kansas

Dear Mr. Curtis:

District staff has inspected the above referenced location and has determined that the reserve pit shall be constructed **without slots**, the bottom shall be flat and reasonably level, and **all pits must be lined with bentonite**. The free fluids must be removed. The fluids are to be removed from the reserve pit as soon as the Hutchinson Salt section has been drilled through and displacement of the fluids into the reserve pit has occurred. The fluids should be removed again within 72 hours after drilling operations have ceased.

If production casing is set all completion fluids shall be removed from the working pits daily. NO completion fluids or non-exempt wastes shall be placed in the reserve pit.

The fluids should be taken to an authorized disposal well. Please call the District Office at (316) 630-4000 when the fluids have been removed. Please file form CDP-5 (August 2004), Exploration and Production Waste Transfer, within 30 days of fluid removal. Conservation division forms are available through our office and on the KCC web site: www.kcc.state.ks.us/conservation/forms.

A copy of this letter should be posted in the doghouse along with the approved Intent to Drill. If you have any questions or concerns please feel free to contact the undersigned at the above address.

Sincerely,

Kathy Haynes

Environmental Protection and Remediation Department

cc: File