



For KCC Use: 9-3-07
 Effective Date: _____
 District # 1
 SGA? Yes No

KANSAS CORPORATION COMMISSION 1011582
 OIL & GAS CONSERVATION DIVISION

Form C-1
 November 2005
 Form must be Typed
 Form must be Signed
 All blanks must be Filled

NOTICE OF INTENT TO DRILL
 Must be approved by KCC five (5) days prior to commencing well

Expected Spud Date: 09/21/2007
 month day year

OPERATOR: License# 33476
 Name: FIML Natural Resources, LLC
 Address 1: 410 17TH STREET, SUITE 900
 Address 2: _____
 City: DENVER State: CO Zip: 80202 + _____
 Contact Person: Cassandra Parks
 Phone: 303-893-5073
 CONTRACTOR: License# 33532
 Name: Advanced Drilling Technologies LLC

Spot Description: _____
 _____ S2 S2 NE Sec. 6 Twp. 19 S. R. 31 E W
 (a/a/a/a) 2,310 feet from N / S Line of Section
1,320 feet from E / W Line of Section

Is SECTION: Regular Irregular?
 (Note: Locate well on the Section Plat on reverse side)

County: Scott
 Lease Name: Stucky Trust Well #: 7-6-1931
 Field Name: HUGOTON NORTHEAST GAS AREA

Is this a Prorated / Spaced Field? Yes No
 Target Formation(s): Krider

Nearest Lease or unit boundary line (in footage): 1320
 Ground Surface Elevation: 2971 feet MSL

Water well within one-quarter mile: Yes No
 Public water supply well within one mile: Yes No

Depth to bottom of fresh water: _____
 Depth to bottom of usable water: _____

Surface Pipe by Alternate: I II
 Length of Surface Pipe Planned to be set: 350

Length of Conductor Pipe (if any): 0
 Projected Total Depth: 2850

Formation at Total Depth: Krider
 Water Source for Drilling Operations:
 Well Farm Pond Other: Hauled in

DWR Permit #: _____
 (Note: Apply for Permit with DWR)

Will Cores be taken? Yes No
 If Yes, proposed zone: _____

RECEIVED
 KANSAS CORPORATION COMMISSION

Well Drilled For: Well Class: Type Equipment:
 Oil Enh Rec Infield Mud Rotary
 Gas Storage Pool Ext. Air Rotary
 Disposal Wildcat Cable
 Seismic; # of Holes _____
 Other: _____

If OWWO: old well information as follows:

Operator: _____
 Well Name: _____
 Original Completion Date: _____ Original Total Depth: _____

Directional, Deviated or Horizontal wellbore? Yes No

If Yes, true vertical depth: _____

Bottom Hole Location: _____
 KCC DKT #: _____

AFFIDAVIT

The undersigned hereby affirms that the drilling, completion and eventual plugging of this well will comply with K.S.A. 55 et. seq.
 It is agreed that the following minimum requirements will be met:

AUG 28 2007

CONSERVATION DIVISION
 WICHITA, KS

1. Notify the appropriate district office **prior** to spudding of well;
2. A copy of the approved notice of intent to drill **shall be** posted on each drilling rig;
3. The minimum amount of surface pipe as specified below **shall be set** by circulating cement to the top; in all cases surface pipe **shall be set** through all unconsolidated materials plus a minimum of 20 feet into the underlying formation.
4. If the well is dry hole, an agreement between the operator and the district office on plug length and placement is necessary **prior to plugging**;
5. The appropriate district office will be notified before well is either plugged or production casing is cemented in;
6. If an ALTERNATE II COMPLETION, production pipe shall be cemented from below any usable water to surface within **120 DAYS** of spud date.
 Or pursuant to Appendix "B" - Eastern Kansas surface casing order #133,891-C, which applies to the KCC District 3 area, alternate II cementing must be completed within 30 days of the spud date or the well shall be plugged. **In all cases, NOTIFY district office** prior to any cementing.

I hereby certify that the statements made herein are true and to the best of my knowledge and belief.

Date: 8/28/2007 Signature of Operator or Agent: _____ Title: Operations Assistant

For KCC Use ONLY
 API # 15 - 171-20678-0000
 Conductor pipe required 0 feet
 Minimum surface pipe required 200 feet per ALT. I II
 Approved by: 124829-07
 This authorization expires: 2-29-08
 (This authorization void if drilling not started within 6 months of approval date.)
 Spud date: _____ Agent: _____

Remember to:

- File Drill Pit Application (form CDP-1) with Intent to Drill;
- File Completion Form ACO-1 within 120 days of spud date;
- File acreage attribution plat according to field proration orders;
- Notify appropriate district office 48 hours prior to workover or re-entry;
- Submit plugging report (CP-4) after plugging is completed (within 60 days);
- Obtain written approval before disposing or injecting salt water.
- If this permit has expired (See: authorized expiration date) please check the box below and return to the address below.

Well Not Drilled - Permit Expired Date: _____
 Signature of Operator or Agent: _____

6
19
31
 E
 W



1011582

IN ALL CASES PLOT THE INTENDED WELL ON THE PLAT BELOW

Plat of acreage attributable to a well in a prorated or spaced field

If the intended well is in a prorated or spaced field, please fully complete this side of the form. If the intended well is in a prorated or spaced field complete the plat below showing that the well will be properly located in relationship to other wells producing from the common source of supply. Please show all the wells and within 1 mile of the boundaries of the proposed acreage attribution unit for gas wells and within 1/2 mile of the boundaries of the proposed acreage attribution unit for oil wells.

API No. 15 - 171-20678-0000
 Operator: FIML Natural Resources, LLC
 Lease: Stucky Trust
 Well Number: 7-6-1931
 Field: HUGOTON NORTHEAST GAS AREA

Number of Acres attributable to well: 320
 QTR/QTR/QTR/QTR of acreage: - S2 - S2 - NE

Location of Well: County: Scott
2,310 feet from N / S Line of Section
1,320 feet from E / W Line of Section
 Sec. 6 Twp. 19 S. R. 31 E W

Is Section: Regular or Irregular

If Section is Irregular, locate well from nearest corner boundary.

Section corner used: NE NW SE SW

PLAT

*(Show location of the well and shade attributable acreage for prorated or spaced wells.)
(Show footage to the nearest lease or unit boundary line.)*

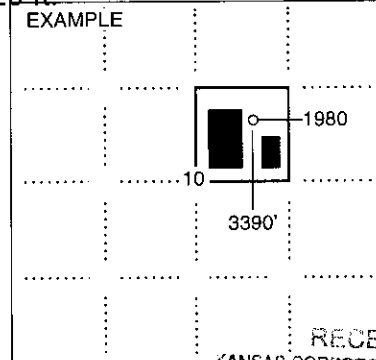
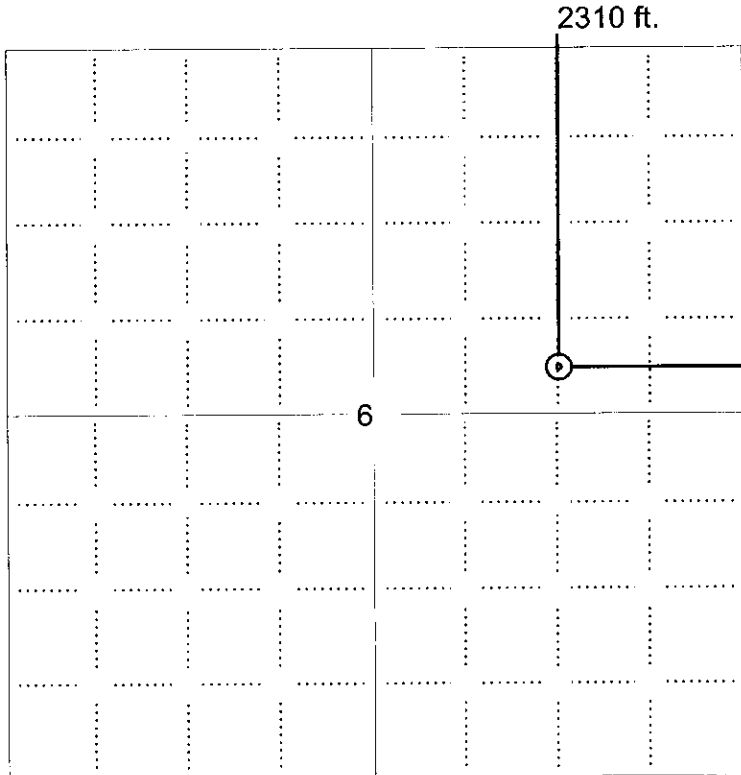

RECEIVED
KANSAS CORPORATION COMMISSION
SEWARD CO.

AUG 28 2007

CONSERVATION DIVISION
WICHITA, KS

In plotting the proposed location of the well, you must show:

1. The manner in which you are using the depicted plat by identifying section lines, i.e. 1 section, 1 section with 8 surrounding sections, 4 sections, etc.
2. The distance of the proposed drilling location from the south / north and east / west outside section lines.
3. The distance to the nearest lease or unit boundary line (in footage).
4. If proposed location is located within a prorated or spaced field a certificate of acreage attribution plat must be attached: (C0-7 for oil wells; CG-8 for gas wells).



KANSAS CORPORATION COMMISSION 1011582
OIL & GAS CONSERVATION DIVISION

Form CDP-1
April 2004
Form must be Typed

APPLICATION FOR SURFACE PIT

Submit in Duplicate

Operator Name: FIML Natural Resources, LLC		License Number: 33476	
Operator Address: 410 17TH STREET, SUITE 900		DENVER CO 80202	
Contact Person: Cassandra Parks		Phone Number: 303-893-5073	
Lease Name & Well No.: Stucky Trust 7-6-1931		Pit Location (QQQQ): S2 S2 NE Sec. 6 Twp. 19 R. 31 <input type="checkbox"/> East <input checked="" type="checkbox"/> West 2,310 Feet from <input checked="" type="checkbox"/> North / <input type="checkbox"/> South Line of Section 1,320 Feet from <input checked="" type="checkbox"/> East / <input type="checkbox"/> West Line of Section Scott County	
Type of Pit: <input type="checkbox"/> Emergency Pit <input type="checkbox"/> Burn Pit <input type="checkbox"/> Settling Pit <input checked="" type="checkbox"/> Drilling Pit <input type="checkbox"/> Workover Pit <input type="checkbox"/> Haul-Off Pit <small>(If WP Supply API No. or Year Drilled)</small>		Pit is: <input checked="" type="checkbox"/> Proposed <input type="checkbox"/> Existing If Existing, date constructed: Pit capacity: 3,000 (bbls)	
Is the pit located in a Sensitive Ground Water Area? <input type="checkbox"/> Yes <input checked="" type="checkbox"/> No		Chloride concentration: _____ mg/l <small>(For Emergency Pits and Settling Pits only)</small>	
Is the bottom below ground level? <input checked="" type="checkbox"/> Yes <input type="checkbox"/> No		Artificial Liner? <input type="checkbox"/> Yes <input checked="" type="checkbox"/> No	
How is the pit lined if a plastic liner is not used? Natural Clay			
Pit dimensions (all but working pits): 80 Length (feet) 80 Width (feet)		<input type="checkbox"/> N/A: Steel Pits	
Depth from ground level to deepest point: 4 (feet)		<input type="checkbox"/> No Pit	
If the pit is lined give a brief description of the liner material, thickness and installation procedure.		Describe procedures for periodic maintenance and determining liner integrity, including any special monitoring.	
Distance to nearest water well within one-mile of pit N/A feet Depth of water well _____ feet		Depth to shallowest fresh water _____ feet. Source of information: <input type="checkbox"/> measured <input type="checkbox"/> well owner <input type="checkbox"/> electric log <input checked="" type="checkbox"/> KDWR	
Emergency, Settling and Burn Pits ONLY: Producing Formation: _____ Number of producing wells on lease: _____ Barrels of fluid produced daily: _____ Does the slope from the tank battery allow all spilled fluids to flow into the pit? <input type="checkbox"/> Yes <input type="checkbox"/> No		Drilling, Workover and Haul-Off Pits ONLY: Type of material utilized in drilling/workover: Bentonite mud Number of working pits to be utilized: 2 Abandonment procedure: Evaporation/backfill Drill pits must be closed within 365 days of spud date.	
I hereby certify that the above statements are true and correct to the best of my knowledge and belief.		RECEIVED KANSAS CORPORATION COMMISSION AUG 28 2007 CONSERVATION DIVISION WICHITA, KS	
Date: 8/29/2007 Signature of Applicant or Agent: <i>Cassandra Parks</i>			
KCC OFFICE USE ONLY			
Date Received: 8/29/07		Permit Number: _____ Permit Date: 8/29/07	
Lease Inspection: <input type="checkbox"/> Yes <input checked="" type="checkbox"/> No			

15-171-20678-0000