



For KCC Use: 9-3-07  
 Effective Date: 9-3-07  
 District # 1  
 SGA?  Yes  No

KANSAS CORPORATION COMMISSION 1011720  
 OIL & GAS CONSERVATION DIVISION

Form C-1  
 November 2005  
 Form must be Typed  
 Form must be Signed  
 All blanks must be Filled

**NOTICE OF INTENT TO DRILL**

Must be approved by KCC five (5) days prior to commencing well

Expected Spud Date: 09/24/2007  
 month day year

OPERATOR: License# 33476  
 Name: FIML Natural Resources, LLC  
 Address 1: 410 17TH STREET, SUITE 900  
 Address 2: \_\_\_\_\_  
 City: DENVER State: CO Zip: 80202 + \_\_\_\_\_  
 Contact Person: Cassie Parks  
 Phone: 303-893-5073

CONTRACTOR: License# 33532  
 Name: Advanced Drilling Technologies LLC

Well Drilled For:	Well Class:	Type Equipment:
<input type="checkbox"/> Oil	<input type="checkbox"/> Enh Rec	<input checked="" type="checkbox"/> Mud Rotary
<input checked="" type="checkbox"/> Gas	<input type="checkbox"/> Storage	<input type="checkbox"/> Air Rotary
	<input type="checkbox"/> Disposal	<input type="checkbox"/> Cable
<input type="checkbox"/> Seismic ; _____ # of Holes	<input checked="" type="checkbox"/> Infield	
<input type="checkbox"/> Other: _____	<input type="checkbox"/> Pool Ext.	
	<input checked="" type="checkbox"/> Wildcat	
	<input type="checkbox"/> Other	

If OWWO: old well information as follows:

Operator: \_\_\_\_\_  
 Well Name: \_\_\_\_\_  
 Original Completion Date: \_\_\_\_\_ Original Total Depth: \_\_\_\_\_

Directional, Deviated or Horizontal wellbore?  Yes  No  
 If Yes, true vertical depth: \_\_\_\_\_  
 Bottom Hole Location: \_\_\_\_\_  
 KCC DKT #: \_\_\_\_\_

Spot Description: \_\_\_\_\_  
S2 NW NW Sec. 30 Twp. 18 S. R. 31  E  W  
 (a/a/a/a) 990 feet from  N /  S Line of Section  
660 feet from  E /  W Line of Section

Is SECTION:  Regular  Irregular?  
 (Note: Locate well on the Section Plat on reverse side)

County: Scott  
 Lease Name: Wiechman Well #: 4-30-1831  
 Field Name: Wildcat

Is this a Prorated / Spaced Field?  Yes  No  
 Target Formation(s): Krider

Nearest Lease or unit boundary line (in footage): 660  
 Ground Surface Elevation: 2968 feet MSL

Water well within one-quarter mile:  Yes  No  
 Public water supply well within one mile:  Yes  No

Depth to bottom of fresh water: 180  
 Depth to bottom of usable water: 1550

Surface Pipe by Alternate:  I  II  
 Length of Surface Pipe Planned to be set: 350

Length of Conductor Pipe (if any): 0  
 Projected Total Depth: 2850

Formation at Total Depth: Krider  
 Water Source for Drilling Operations:  
 Well  Farm Pond  Other: Hauled in

DWR Permit #: \_\_\_\_\_  
 (Note: Apply for Permit with DWR )

Will Cores be taken?  Yes  No  
 If Yes, proposed zone: \_\_\_\_\_

RECEIVED  
 KANSAS CORPORATION COMMISSION

**AFFIDAVIT**

**AUG 28 2007**

The undersigned hereby affirms that the drilling, completion and eventual plugging of this well will comply with K.S.A. 55 et. seq.  
 It is agreed that the following minimum requirements will be met:

CONSERVATION DIVISION  
 WICHITA, KS

1. Notify the appropriate district office **prior** to spudding of well;
2. A copy of the approved notice of intent to drill **shall be** posted on each drilling rig;
3. The minimum amount of surface pipe as specified below **shall be set** by circulating cement to the top; in all cases surface pipe **shall be set** through all unconsolidated materials plus a minimum of 20 feet into the underlying formation.
4. If the well is dry hole, an agreement between the operator and the district office on plug length and placement is necessary **prior to plugging**;
5. The appropriate district office will be notified before well is either plugged or production casing is cemented in;
6. If an ALTERNATE II COMPLETION, production pipe shall be cemented from below any usable water to surface within **120 DAYS** of spud date. Or pursuant to Appendix "B" - Eastern Kansas surface casing order #133,891-C, which applies to the KCC District 3 area, alternate II cementing must be completed within 30 days of the spud date or the well shall be plugged. **In all cases, NOTIFY district office** prior to any cementing.

I hereby certify that the statements made herein are true and to the best of my knowledge and belief.

Date: 8/28/2007 Signature of Operator or Agent: [Signature] Title: Operations Assistant

**For KCC Use ONLY**

API # 15 - 171-20676-0000

Conductor pipe required 0 feet

Minimum surface pipe required 200 feet per ALT.  I  II

Approved by: [Signature]

This authorization expires: 2-29-08  
 (This authorization void if drilling not started within 6 months of approval date.)

Spud date: \_\_\_\_\_ Agent: \_\_\_\_\_

**Remember to:**

- File Drill Pit Application (form CDP-1) with Intent to Drill;
- File Completion Form ACO-1 within 120 days of spud date;
- File acreage attribution plat according to field proration orders;
- Notify appropriate district office 48 hours prior to workover or re-entry;
- Submit plugging report (CP-4) after plugging is completed (within 60 days);
- Obtain written approval before disposing or injecting salt water.
- If this permit has expired (See: *authorized expiration date*) please check the box below and return to the address below.

Well Not Drilled - Permit Expired Date: \_\_\_\_\_  
 Signature of Operator or Agent: \_\_\_\_\_

30  
18  
31  
 E  
 W



1011720

**IN ALL CASES PLOT THE INTENDED WELL ON THE PLAT BELOW**

*Plat of acreage attributable to a well in a prorated or spaced field*

**If the intended well is in a prorated or spaced field, please fully complete this side of the form.** If the intended well is in a prorated or spaced field complete the plat below showing that the well will be properly located in relationship to other wells producing from the common source of supply. Please show all the wells and within 1 mile of the boundaries of the proposed acreage attribution unit for gas wells and within 1/2 mile of the boundaries of the proposed acreage attribution unit for oil wells.

API No. 15 - 171-20676 0000  
Operator: FIML Natural Resources, LLC  
Lease: Wiechman  
Well Number: 4-30-1831  
Field: Wildcat

Location of Well: County: Scott  
990 feet from  N /  S Line of Section  
660 feet from  E /  W Line of Section  
Sec. 30 Twp. 18 S. R. 31  E  W

Number of Acres attributable to well: \_\_\_\_\_  
QTR/QTR/QTR/QTR of acreage: \_\_\_\_\_ - S2 - NW - NW

Is Section:  Regular or  Irregular

**If Section is Irregular, locate well from nearest corner boundary.**

Section corner used:  NE  NW  SE  SW

**PLAT**

*(Show location of the well and shade attributable acreage for prorated or spaced wells.)*

*(Show footage to the nearest lease or unit boundary line.)*

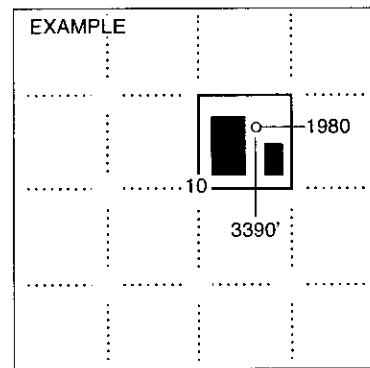
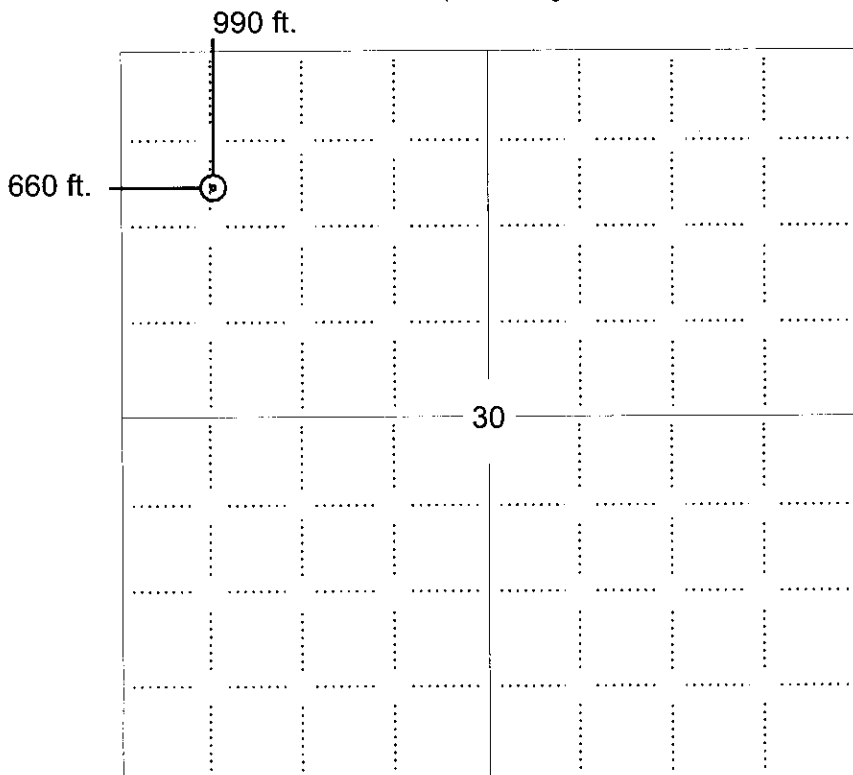

**NOTE: In all cases locate the spot of the proposed drilling location.**

RECEIVED  
KANSAS CORPORATION COMMISSION

**In plotting the proposed location of the well, you must show:**

1. The manner in which you are using the depicted plat by identifying section lines, i.e. 1 section, 1 section with 8 surrounding sections, 4 sections, etc.
2. The distance of the proposed drilling location from the south / north and east / west outside section lines.
3. The distance to the nearest lease or unit boundary line (in footage).
4. If proposed location is located within a prorated or spaced field a certificate of acreage attribution plat must be attached: (CO-7 for oil wells; CG-8 for gas wells).

**AUG 28 2007**

CONSERVATION DIVISION  
WICHITA, KS



KANSAS CORPORATION COMMISSION 1011720  
OIL & GAS CONSERVATION DIVISION

Form CDP-1  
April 2004  
Form must be Typed

APPLICATION FOR SURFACE PIT

Submit in Duplicate

Operator Name: FIML Natural Resources, LLC		License Number: 33476	
Operator Address: 410 17TH STREET, SUITE 900		DENVER CO 80202	
Contact Person: Cassie Parks		Phone Number: 303-893-5073	
Lease Name & Well No.: Wiechman 4-30-1831		Pit Location (QQQQ): S2 NW NW Sec. 30 Twp. 18 R. 31 <input type="checkbox"/> East <input checked="" type="checkbox"/> West 990 Feet from <input checked="" type="checkbox"/> North / <input type="checkbox"/> South Line of Section 660 Feet from <input type="checkbox"/> East / <input checked="" type="checkbox"/> West Line of Section Scott County	
Type of Pit: <input type="checkbox"/> Emergency Pit <input type="checkbox"/> Burn Pit <input type="checkbox"/> Settling Pit <input checked="" type="checkbox"/> Drilling Pit <input type="checkbox"/> Workover Pit <input type="checkbox"/> Haul-Off Pit <small>(If WP Supply API No. or Year Drilled)</small>	Pit is: <input checked="" type="checkbox"/> Proposed <input type="checkbox"/> Existing If Existing, date constructed: _____ Pit capacity: 3,000 (bbls)		
Is the pit located in a Sensitive Ground Water Area? <input type="checkbox"/> Yes <input checked="" type="checkbox"/> No		Chloride concentration: _____ mg/l <small>(For Emergency Pits and Settling Pits only)</small>	
Is the bottom below ground level? <input checked="" type="checkbox"/> Yes <input type="checkbox"/> No		Artificial Liner? <input type="checkbox"/> Yes <input checked="" type="checkbox"/> No	
		How is the pit lined if a plastic liner is not used? Natural Clay	
Pit dimensions (all but working pits): 80 Length (feet) 80 Width (feet) <input type="checkbox"/> N/A: Steel Pits Depth from ground level to deepest point: 4 (feet) <input type="checkbox"/> No Pit			
If the pit is lined give a brief description of the liner material, thickness and installation procedure.		Describe procedures for periodic maintenance and determining liner integrity, including any special monitoring.	
Distance to nearest water well within one-mile of pit 4299 feet Depth of water well 95 feet		Depth to shallowest fresh water 95 feet. Source of information: <input type="checkbox"/> measured <input type="checkbox"/> well owner <input type="checkbox"/> electric log <input checked="" type="checkbox"/> KDWR	
<b>Emergency, Settling and Burn Pits ONLY:</b> Producing Formation: _____ Number of producing wells on lease: _____ Barrels of fluid produced daily: _____ Does the slope from the tank battery allow all spilled fluids to flow into the pit? <input type="checkbox"/> Yes <input type="checkbox"/> No		<b>Drilling, Workover and Haul-Off Pits ONLY:</b> Type of material utilized in drilling/workover: Bentonite mud Number of working pits to be utilized: 2 Abandonment procedure: Evaporation/backfill Drill pits must be closed within 365 days of spud date.	
I hereby certify that the above statements are true and correct to the best of my knowledge and belief.		RECEIVED KANSAS CORPORATION COMMISSION	
8/29/2007 Date		Signature of Applicant or Agent	
		AUG 28 2007 CONSERVATION DIVISION WICHITA, KS	
<b>KCC OFFICE USE ONLY</b>			
Steel Pit <input type="checkbox"/> RFAC <input type="checkbox"/> RFAS <input type="checkbox"/>			
Date Received: 8/29/07 Permit Number: _____ Permit Date: 8/29/07 Lease Inspection: <input type="checkbox"/> Yes <input checked="" type="checkbox"/> No			

15-171-200676-0000