

For KCC Use:  
Effective Date: 8-25-07  
District # 1  
SGA?  Yes  No

KANSAS CORPORATION COMMISSION  
OIL & GAS CONSERVATION DIVISION

**Corrected Intent**

Form C-1

December 2002

Form must be Typed

Form must be Signed

All blanks must be Filled

**NOTICE OF INTENT TO DRILL**

Must be approved by the K.C.C. five (5) days prior to commencing work

**CORRECTED**

Expected Spud Date 9 5 2007  
*month day year*

Spot APP  East  
NE - SE - SW - NE Sec. 19 Twp. 18 S. R. 29  West

OPERATOR: License # 3842  
Name: LARSON ENGINEERING, INC.  
Address: 562 WEST HIGHWAY 4  
City/State/Zip: OLMITZ, KS 67564-8561  
Contact Person: TOM LARSON  
Phone: (620) 653-7368

\* 2140 feet from  N /  S Line of Section  
1500 feet from  E /  W Line of Section  
Is SECTION X Regular  Irregular?

(Note: Locate well on the Section Plat on Reverse Side)

CONTRACTOR: License # 33935  
Name: H. D. DRILLING, LLC

County: LANE  
Lease Name: BOCKELMAN Well #: 1-19  
Field Name: WILDCAT

Is this a Prorated / Spaced Field?  Yes  No

Target Formation(s): L-KC, MARMATON, CHEROKEE

\* Nearest Lease or unit boundary: 180

Ground Surface Elevation: 2835 feet MSL

Water well within one-quarter mile:  Yes  No

Public water supply well within one mile:  Yes  No

Depth to bottom of fresh water: 150

Depth to bottom of usable water: 1375

Surface Pipe by Alternate:   2

Length of Surface Pipe Planned to be set: 250

Length of Conductor pipe required: \_\_\_\_\_

Projected Total Depth: 4650

Formation at Total Depth: MISSISSIPPI

Water Source for Drilling Operations:

Well  Farm Pond Other WATER HAULER

DWR Permit #: \_\_\_\_\_

(Note: Apply for Permit with DWR )

Will Cores Be Taken?  Yes  No

If yes, proposed zone: \_\_\_\_\_

Well Drilled For:  Oil  Gas  OWWO  Seismic; # of Holes  Other  
 Enh Rec  Storage  Disposal  
Well Class:  Infield  Pool Ext.  Wildcat  Other  
Type Equipment:  Mud Rotary  Air Rotary  Cable

If OWWO: old well information as follows:

Operator: \_\_\_\_\_

Well: \_\_\_\_\_

Original Completion Date: \_\_\_\_\_ Original Total Depth: \_\_\_\_\_

Directional, Deviated or Horizontal wellbore?  Yes  No

If yes, true vertical \_\_\_\_\_

Bottom Hole Location: \_\_\_\_\_

KCC DKT#: \_\_\_\_\_

\*copies of leases attached ✓

AFFIDAVIT

WAS: 1620' FEL, NLUB: 500

IS: 1500' FEL, NLUB: 180

RECEIVED

The undersigned hereby affirms that the drilling, completion and eventual plugging of this well will comply with K.S.A. 55-101, et. seq. It is agreed that the following minimum requirements will be met:

1. Notify the appropriate district office **prior** to spudding of well;
2. A copy of the approved Notice of Intent to Drill **shall be** posted on each drilling rig;
3. The minimum amount of surface pipe as specified below **shall be set** by circulating cement to the top; in all cases surface pipe **shall be set** through all unconsolidated materials plus a minimum of 20 feet into the underlying formation;
4. If the well is a dry hole, an agreement between the operator and the district office on plug length and placement is necessary **prior to plugging**;
5. The appropriate district office will be notified before well is either plugged or production casing is cemented in;
6. If an ALTERNATE II COMPLETION, production pipe shall be cemented from below any usable water to surface within **120 days** of spud date. Or pursuant to Appendix "B" - Eastern Kansas surface casing order #133,891-C, which applies to the KCC District 3 area, alternate II cementing must be completed within 30 days of spud date or the well shall be plugged. **In all cases, NOTIFY district office** prior to any cementing.

AUG 29 2007

I hereby certify that the statements made herein are true and to the best of my knowledge and belief.

Date: 08/28/2007 Signature of Operator or Agent: Carol Lam Title: SECRETARY/TREASURER

Remember to:

- File Drill Pit Application (Form CDP-1) with Intent to Drill;
- File Completion Form ACO-1 within 120 days of spud date;
- File acreage attribution plat according to field proration orders;
- Notify appropriate district office 48 hours prior to workover or re-entry;
- Submit plugging report (CP-4) after plugging is completed;
- Obtain written approval before disposing or injecting salt water.

- If this permit has expired (See: authorized expiration date) please check the box below and return to the address below.

Well Not Drilled - Permit Expired

Signature of Operator or Agent: \_\_\_\_\_

Date: \_\_\_\_\_

For KCC use ONLY

API # 15 - 101-22036-0000

Conductor pipe required 0 feet

Minimum surface pipe required 200 feet per Alt. X(2)

Approved by: Auth 8-20-07 / Rev 8-30-07

This authorization expires: 2-20-08

(This authorization void if drilling not started within 6 months of effective date.)

Spud date: \_\_\_\_\_ Agent: \_\_\_\_\_

Mail to: KCC - Conservation Division 130 S. Market - Room 2078, Wichita, Kansas 67202

19  
18  
M62  
29W

**IN ALL CASES PLOT THE INTENDED WELL ON THE PLAT BELOW**

*Plat of acreage attributable to a well in a prorated or spaced field*

**CORRECTED**

If the intended well is in a prorated or spaced field, please fully complete this side of the form. If the intended well is in a prorated or spaced field complete the plat below showing that the well will be properly located in relationship to other wells producing from the common source of supply. Please show all the wells and within 1 mile of the boundaries of the proposed acreage attribution unit for gas wells and within 1/2 mile of the boundaries of the proposed acreage attribution unit for oil wells.

API No. 15 - 101-22036-0000  
 Operator: Larson Engineering, Inc.  
 Lease: Bockelman  
 Well Number: 1-19  
 Field: Wildcat

Location of Well: County: Lane  
2,140 feet from  N /  S Line of Section  
1,500 feet from  E /  W Line of Section  
 Sec. 19 Twp. 18 S. R. 29  E  W

Number of Acres attributable to well: \_\_\_\_\_  
 QTR/QTR/QTR/QTR of acreage: NE - SE - SW - NE

Is Section:  Regular or  Irregular

If Section is Irregular, locate well from nearest corner boundary.  
 Section corner used:  NE  NW  SE  SW

**PLAT**

(Show location of the well and shade attributable acreage for prorated or spaced wells.)  
 (Show footage to the nearest lease or unit boundary line.)

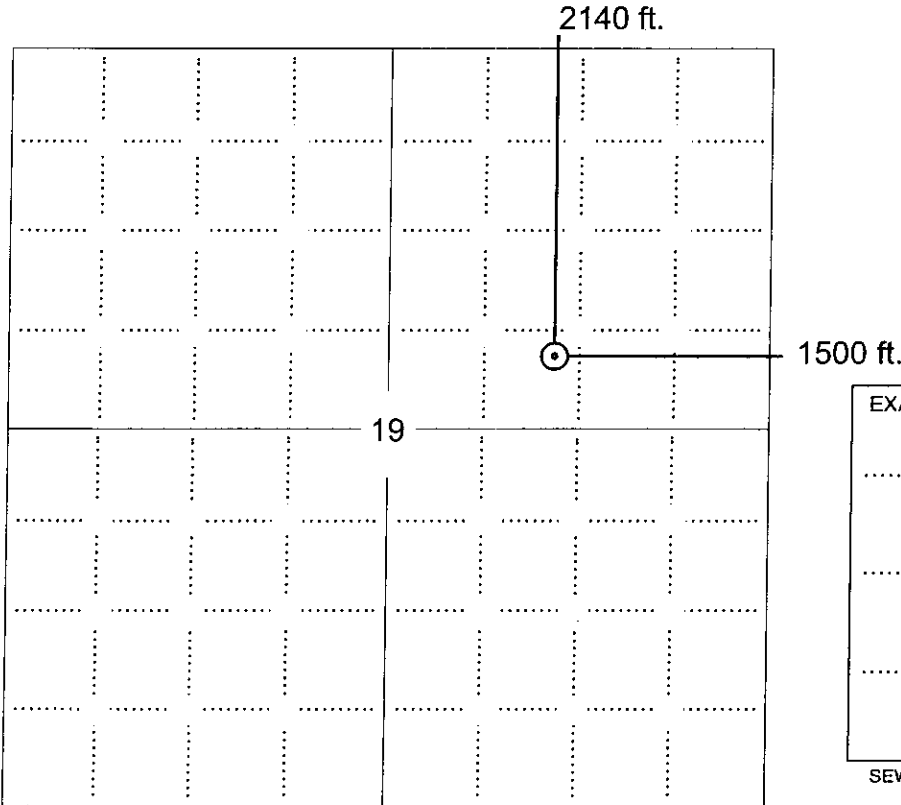

RECEIVED  
 KANSAS CORPORATION COMMISSION

AUG 29 2007

GENERAL INVESTIGATION  
 SECTION

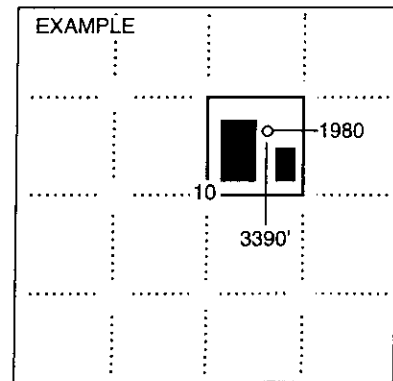

**NOTE: In all cases locate the spot of the proposed drilling locaton.**

**In plotting the proposed location of the well, you must show:**

1. The manner in which you are using the depicted plat by identifying section lines, i.e. 1 section, 1 section with 8 surrounding sections, 4 sections, etc.
2. The distance of the proposed drilling location from the south / north and east / west outside section lines.
3. The distance to the nearest lease or unit boundary line (in footage).
4. If proposed location is located within a prorated or spaced field a certificate of acreage attribution plat must be attached: (CO-7 for oil wells; CG-8 for gas wells).

KANSAS CORPORATION COMMISSION  
OIL & GAS CONSERVATION DIVISION

Form CDP-1  
April 2004  
Form must be Typed

APPLICATION FOR SURFACE PIT **CORRECTED**

Submit in Duplicate

Operator Name: <b>Larson Engineering, Inc.</b>		License Number: <b>3842</b>
Operator Address: <b>562 W STATE RD 4</b>		<b>OLMITZ KS 67564</b>
Contact Person: <b>Thomas Larson</b>		Phone Number: <b>620-653-7368</b>
Lease Name & Well No.: <b>Bockelman 1-19</b>		Pit Location (QQQQ): <b>NE SE SW NE</b>
Type of Pit: <input type="checkbox"/> Emergency Pit <input type="checkbox"/> Burn Pit <input type="checkbox"/> Settling Pit <input checked="" type="checkbox"/> Drilling Pit <input type="checkbox"/> Workover Pit <input type="checkbox"/> Haul-Off Pit <small>(If WP Supply API No. or Year Drilled)</small>	Pit is: <input checked="" type="checkbox"/> Proposed <input type="checkbox"/> Existing If Existing, date constructed: _____ Pit capacity: <b>6,400</b> (bbls)	Sec. <b>19</b> Twp. <b>18</b> R. <b>29</b> <input type="checkbox"/> East <input checked="" type="checkbox"/> West <b>2,140</b> Feet from <input checked="" type="checkbox"/> North / <input type="checkbox"/> South Line of Section <b>1,500</b> Feet from <input checked="" type="checkbox"/> East / <input type="checkbox"/> West Line of Section <b>Lane</b> County
Is the pit located in a Sensitive Ground Water Area? <input type="checkbox"/> Yes <input checked="" type="checkbox"/> No		Chloride concentration: _____ mg/l <small>(For Emergency Pits and Settling Pits only)</small>
Is the bottom below ground level? <input checked="" type="checkbox"/> Yes <input type="checkbox"/> No	Artificial Liner? <input type="checkbox"/> Yes <input checked="" type="checkbox"/> No	How is the pit lined if a plastic liner is not used? <b>Native mud &amp; bentonite clay.</b>
Pit dimensions (all but working pits): <u>80</u> Length (feet) <u>80</u> Width (feet) <input type="checkbox"/> N/A: Steel Pits Depth from ground level to deepest point: <u>3</u> (feet) <input type="checkbox"/> No Pit		
If the pit is lined give a brief description of the liner material, thickness and installation procedure.		Describe procedures for periodic maintenance and determining liner integrity, including any special monitoring. <b>REVIEWED</b> KANSAS CORPORATION COMMISSION <b>AUG 29 2007</b> CONSERVATION DIVISION WICHITA, KS
Distance to nearest water well within one-mile of pit <u>2477</u> feet    Depth of water well <u>100</u> feet		Depth to shallowest fresh water <u>49</u> feet. Source of information: <input type="checkbox"/> measured <input type="checkbox"/> well owner <input type="checkbox"/> electric log <input checked="" type="checkbox"/> KDWR
<b>Emergency, Settling and Burn Pits ONLY:</b> Producing Formation: _____ Number of producing wells on lease: _____ Barrels of fluid produced daily: _____ Does the slope from the tank battery allow all spilled fluids to flow into the pit? <input type="checkbox"/> Yes <input type="checkbox"/> No		<b>Drilling, Workover and Haul-Off Pits ONLY:</b> Type of material utilized in drilling/workover: <u>fresh water mud</u> Number of working pits to be utilized: <u>3</u> Abandonment procedure: <u>Allow to dry then backfill.</u> Drill pits must be closed within 365 days of spud date.
I hereby certify that the above statements are true and correct to the best of my knowledge and belief.		
<u>8/28/07</u> Date		<u>Carol Larson</u> Signature of Applicant or Agent

15-101-22036-0000

<b>KCC OFFICE USE ONLY</b>		Steel Pit <input type="checkbox"/>	RFAC <input type="checkbox"/>	RFAS <input type="checkbox"/>
Date Received: <u>8/29/07</u>	Permit Number: _____	Permit Date: <u>8/29/07</u>	Lease Inspection: <input type="checkbox"/> Yes <input checked="" type="checkbox"/> No	