

For KCC Use: 9-9-07  
 Effective Date: 9-9-07  
 District #: 4  
 SGA?  Yes  No

KANSAS CORPORATION COMMISSION  
 OIL & GAS CONSERVATION DIVISION  
**NOTICE OF INTENT TO DRILL**

Form C-1  
 December 2002

Form must be Typed  
 Form must be Signed  
 All blanks must be Filled

Must be approved by KCC five (5) days prior to commencing well

Expected Spud Date September 5, 2007  
 month day year

Spot  
 NW SE NW Sec. 36 Twp. 4 S. R. 30  East  West  
1690 feet from  N /  S Line of Section  
1410 feet from  E /  W Line of Section  
 Is SECTION  Regular  Irregular?

OPERATOR: License# 33629 ✓  
 Name: Great Plains Energy, Inc.  
 Address: 429 N Linden PO Box 292  
Wahoo, NE 68066  
 City/State/Zip:  
 Contact Person: Dan Blankenau  
 Phone: 402-277-5336

RECEIVED  
 KANSAS CORPORATION COMMISSION  
 AUG 31 2007  
 CONSERVATION DIVISION  
 WICHITA, KS

CONTRACTOR: License# 33575 ✓  
 Name: WW Drilling, LLC

(Note: Locate well on the Section Plat on reverse side)

County: Decatur

Lease Name: Wasson Brothers Farms Well #: 8  
 Field Name: Swede Hollow

Is this a Prorated / Spaced Field?  Yes  No

Target Formation(s): LKC

Nearest Lease or unit boundary: 1410

Ground Surface Elevation: 2832 feet MSL

Water well within one-quarter mile:  Yes  No

Public water supply well within one mile:  Yes  No

Depth to bottom of fresh water: 240 175

Depth to bottom of usable water: 270 175

Surface Pipe by Alternate:  1  2

Length of Surface Pipe Planned to be set: 260'

Length of Conductor Pipe required: None

Projected Total Depth: 4220'

Formation at Total Depth: Marmaton

Water Source for Drilling Operations:

Well  Farm Pond Other \_\_\_\_\_

DWR Permit #: \_\_\_\_\_

(Note: Apply for Permit with DWR )

Will Cores be taken?  Yes  No

If Yes, proposed zone: \_\_\_\_\_

Well Drilled For: Well Class: Type Equipment:

Oil  Enh Rec  Infield  Mud Rotary  
 Gas  Storage  Pool Ext.  Air Rotary  
 OWWO  Disposal  Wildcat  Cable  
 Seismic; # of Holes  Other  
 Other

If OWWO: old well information as follows:

Operator: \_\_\_\_\_

Well Name: \_\_\_\_\_

Original Completion Date: \_\_\_\_\_ Original Total Depth: \_\_\_\_\_

Directional, Deviated or Horizontal wellbore?  Yes  No

If Yes, true vertical depth: \_\_\_\_\_

Bottom Hole Location: \_\_\_\_\_

KCC DKT #: \_\_\_\_\_

**AFFIDAVIT**

The undersigned hereby affirms that the drilling, completion and eventual plugging of this well will comply with K.S.A. 55 et. seq.

It is agreed that the following minimum requirements will be met:

1. Notify the appropriate district office **prior** to spudding of well;
2. A copy of the approved notice of intent to drill **shall be** posted on each drilling rig;
3. The minimum amount of surface pipe as specified below **shall be set** by circulating cement to the top; in all cases surface pipe **shall be set** through all unconsolidated materials plus a minimum of 20 feet into the underlying formation.
4. If the well is dry hole, an agreement between the operator and the district office on plug length and placement is necessary **prior to plugging**;
5. The appropriate district office will be notified before well is either plugged or production casing is cemented in;
6. If an ALTERNATE II COMPLETION, production pipe shall be cemented from below any usable water to surface within **120 days** of spud date. Or pursuant to Appendix "B" - Eastern Kansas surface casing order #133,891-C, which applies to the KCC District 3 area, alternate II cementing must be completed within 30 days of the spud date or the well shall be plugged. **In all cases, NOTIFY district office** prior to any cementing.

I hereby certify that the statements made herein are true and to the best of my knowledge and belief.

Date: August 27, 2007 Signature of Operator or Agent: Carol Medina Title: Secretary

For KCC Use ONLY  
 API # 15 - D39-21020-0000  
 Conductor pipe required None feet  
 Minimum surface pipe required 225 feet per Alt. 1  
 Approved by: Rut 9-4-07  
 This authorization expires: 3-4-08  
 (This authorization void if drilling not started within 6 months of approval date.)  
 Spud date: \_\_\_\_\_ Agent: \_\_\_\_\_

**Remember to:**

- File Drill Pit Application (form CDP-1) with Intent to Drill;
- File Completion Form ACO-1 within 120 days of spud date;
- File acreage attribution plat according to field proration orders;
- Notify appropriate district office 48 hours prior to workover or re-entry;
- Submit plugging report (CP-4) after plugging is completed;
- Obtain written approval before disposing or injecting salt water.
- If this permit has expired (See: authorized expiration date) please check the box below and return to the address below.

Well Not Drilled - Permit Expired

Signature of Operator or Agent: \_\_\_\_\_

Date: \_\_\_\_\_

Mall to: KCC - Conservation Division, 130 S. Market - Room 2078, Wichita, Kansas 67202

36  
4  
SDW

**IN ALL CASES PLOT THE INTENDED WELL ON THE PLAT BELOW**

*Plat of acreage attributable to a well in a prorated or spaced field*

**If the intended well is in a prorated or spaced field, please fully complete this side of the form.** If the intended well is in a prorated or spaced field complete the plat below showing that the well will be properly located in relationship to other wells producing from the common source of supply. Please show all the wells and within 1 mile of the boundaries of the proposed acreage attribution unit for gas wells and within 1/2 mile of the boundaries of the proposed acreage attribution unit for oil wells.

API No. 15 - 039-21020-0000  
Operator: Great Plains Energy, Inc.  
Lease: Wasson Brothers Farms  
Well Number: 8  
Field: Swede Hollow  
Number of Acres attributable to well: \_\_\_\_\_  
QTR / QTR / QTR of acreage: NW - SE - NW

Location of Well: County: Decatur  
1690 feet from  N /  S Line of Section  
1410 feet from  E /  W Line of Section  
Sec. 36 Twp. 4 S. R. 30  East  West

Is Section:  Regular or  Irregular

**If Section is Irregular, locate well from nearest corner boundary.**  
Section corner used:  NE  NW  SE  SW

**PLAT**

*(Show location of the well and shade attributable acreage for prorated or spaced wells.)*  
*(Show footage to the nearest lease or unit boundary line.)*

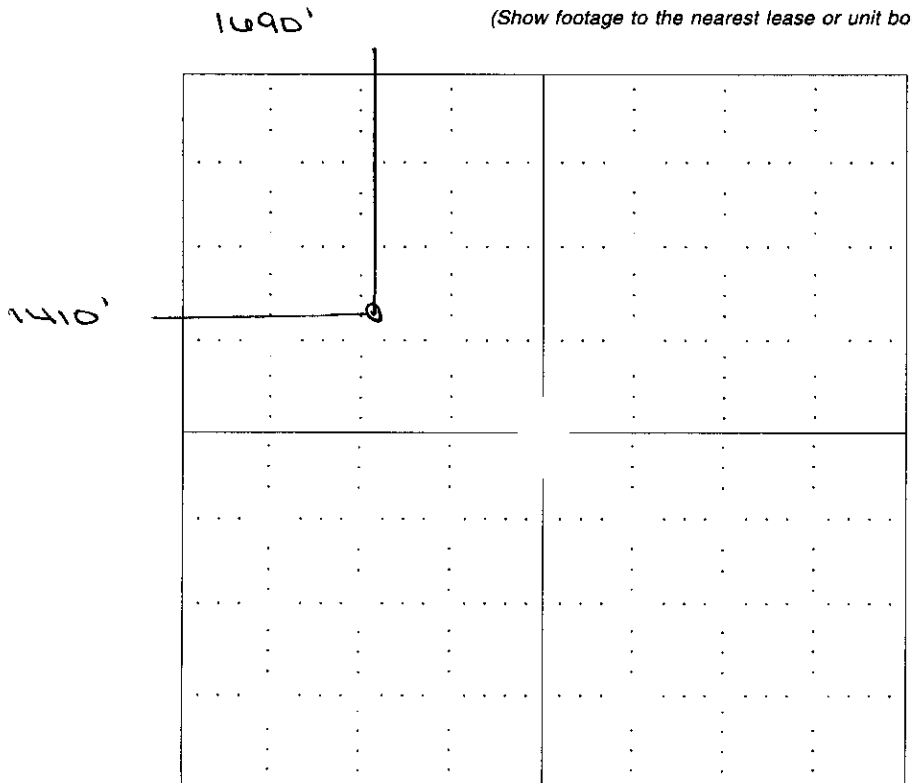

RECEIVED  
KANSAS CORPORATION COMMISSION  
AUG 31 2007  
CONSERVATION DIVISION  
WICHITA, KS

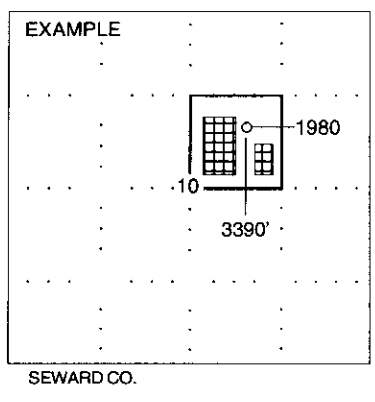

**NOTE: In all cases locate the spot of the proposed drilling locaton.**

**In plotting the proposed location of the well, you must show:**

- 1. The manner in which you are using the depicted plat by identifying section lines, i.e. 1 section, 1 section with 8 surrounding sections, 4 sections, etc.
- 2. The distance of the proposed drilling location from the section's south / north and east / west.
- 3. The distance to the nearest lease or unit boundary line.
- 4. If proposed location is located within a prorated or spaced field a certificate of acreage attribution plat must be attached: (CO-7 for oil wells; CG-8 for gas wells).



# Fall & Associates

State and Elevation Service

719 W. 5<sup>th</sup> Street

P.O. Box 404

Concordia, KS. 66901

1-800-536-2821

15-039-21020-0000

Date 8-14-07

Invoice Number 0813071

GREAT PLAINS ENERGY

Operator

8

Number

Wasson Bros.

Farm Name

Decatur-KS

County-State

36

S

4s

T

30w

R

1690' FNL 1410' FWL

Location

Elevation 2832 Gr.

Ordered By: Barney

Great Plains Energy  
P.O. Box 292  
Wahoo, NE. 68066

Scale 1"=1000'

RECEIVED  
KANSAS CORPORATION COMMISSION

AUG 31 2007

CONSERVATION DIVISION  
WICHITA, KS

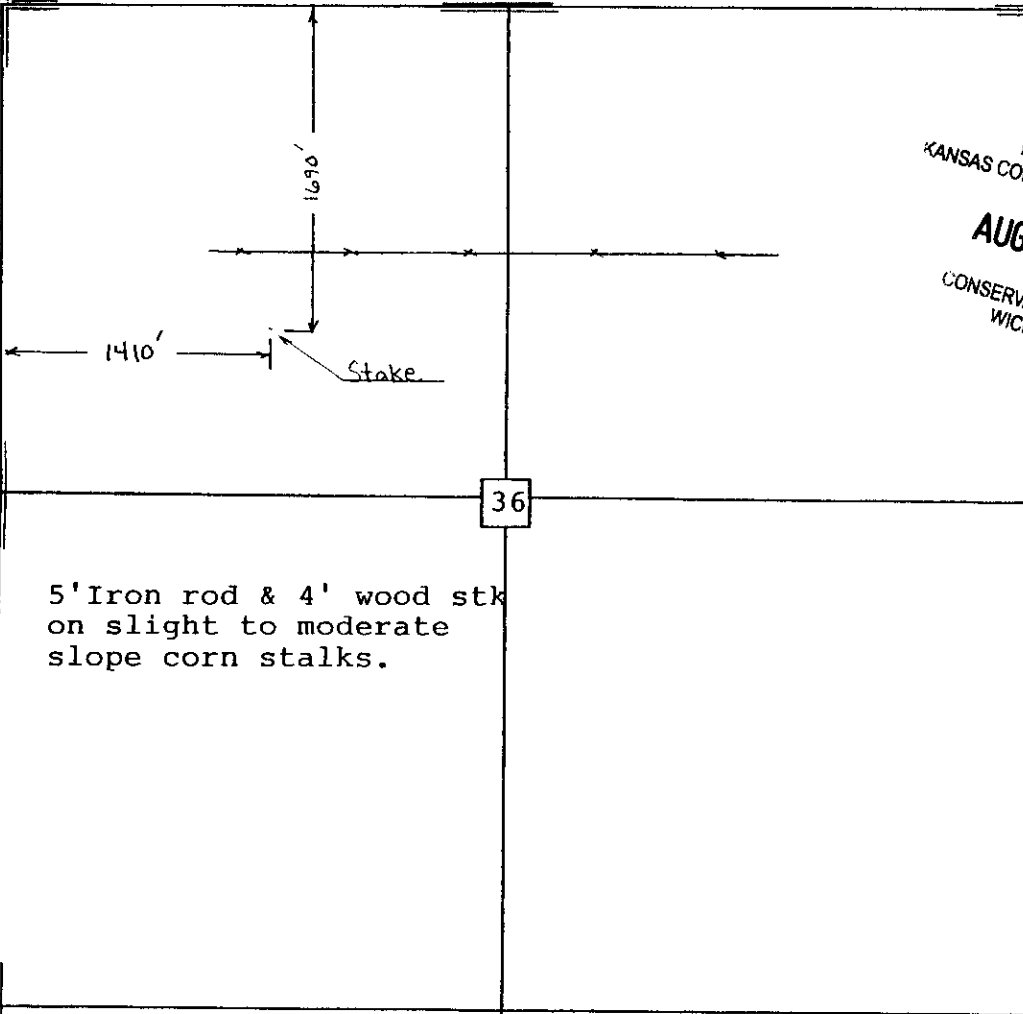

**KANSAS CORPORATION COMMISSION  
OIL & GAS CONSERVATION DIVISION  
APPLICATION FOR SURFACE PIT**

Form GDP-1  
April 2004  
Form must be Typed

*Submit in Duplicate*

Operator Name: <b>Great Plains Energy, Inc.</b>		License Number: <b>33629</b>
Operator Address: <b>429 N Linden, PO Box 292, Wahoo, NE 68066</b>		
Contact Person: <b>Dan Blankenau</b>		Phone Number: ( <b>402</b> ) <b>277 - 5336</b>
Lease Name & Well No.: <b>Wasson #8</b>		Pit Location (QQQQ): <u>  NW  </u> - <u>  NW  </u> - <u>  SE  </u> - <u>  NW  </u> Sec. <u>36</u> Twp. <u>4S</u> R. <u>30</u> <input type="checkbox"/> East <input checked="" type="checkbox"/> West <u>1690</u> Feet from <input checked="" type="checkbox"/> North / <input type="checkbox"/> South Line of Section <u>1410</u> Feet from <input type="checkbox"/> East / <input checked="" type="checkbox"/> West Line of Section <u>Decatur</u> County
Type of Pit: <input type="checkbox"/> Emergency Pit <input type="checkbox"/> Burn Pit <input type="checkbox"/> Settling Pit <input checked="" type="checkbox"/> Drilling Pit <input type="checkbox"/> Workover Pit <input type="checkbox"/> Haul-Off Pit <i>(If WP Supply API No. or Year Drilled)</i>	Pit is: <input checked="" type="checkbox"/> Proposed <input type="checkbox"/> Existing If Existing, date constructed: _____ Pit capacity: _____ (bbls)	
Is the pit located in a Sensitive Ground Water Area? <input type="checkbox"/> Yes <input checked="" type="checkbox"/> No		Chloride concentration: _____ mg/l <i>(For Emergency Pits and Settling Pits only)</i>
Is the bottom below ground level? <input checked="" type="checkbox"/> Yes <input type="checkbox"/> No	Artificial Liner? <input type="checkbox"/> Yes <input checked="" type="checkbox"/> No	How is the pit lined if a plastic liner is not used? <b>Bentonite &amp; Drilling Solids for Self Seal</b>
Pit dimensions (all but working pits): <u>80</u> Length (feet) <u>60</u> Width (feet)    _____ N/A: Steel Pits Depth from ground level to deepest point: <u>4</u> (feet)		
If the pit is lined give a brief description of the liner material, thickness and installation procedure.		Describe procedures for periodic maintenance and liner integrity, including any special monitoring.
Distance to nearest water well within one-mile of pit <u>1289</u> feet    Depth of water well <u>136</u> feet		Depth to shallowest fresh water <u>96</u> feet. Source of information: _____ measured    _____ well owner    _____ electric log <u>(1)</u> KDWR
<b>Emergency, Settling and Burn Pits ONLY:</b> Producing Formation: _____ Number of producing wells on lease: _____ Barrels of fluid produced daily: _____ Does the slope from the tank battery allow all spilled fluids to flow into the pit? <input type="checkbox"/> Yes <input type="checkbox"/> No		<b>Drilling, Workover and Haul-Off Pits ONLY:</b> Type of material utilized in drilling/workover: <u>Bentonite</u> Number of working pits to be utilized: <u>4</u> Abandonment procedure: <u>Allow to evaporate then cover for farming</u> Drill pits must be closed within 365 days of spud date.
I hereby certify that the above statements are true and correct to the best of my knowledge and belief.		
<u>August 27, 2007</u> Date		<u>Carol Medina</u> Signature of Applicant or Agent

**RECEIVED**  
KANSAS CORPORATION COMMISSION  
**AUG 31 2007**  
CONSERVATION DIVISION  
WICHITA, KS

15-039-21020-0000

KCC OFFICE USE ONLY			
Date Received: _____	Permit Number: _____	Permit Date: _____	Lease Inspection: <input type="checkbox"/> Yes <input type="checkbox"/> No

Mail to: KCC - Conservation Division, 130 S. Market - Room 2078, Wichita, Kansas 67202