



For KCC Use:
 Effective Date: 9-11-07
 District # 1
 SGA? ☐ Yes ☒ No

KANSAS CORPORATION COMMISSION 1011902
 OIL & GAS CONSERVATION DIVISION

Form C-1
 November 2005
 Form must be Typed
 Form must be Signed
 All blanks must be Filled

NOTICE OF INTENT TO DRILL

Must be approved by KCC five (5) days prior to commencing well

Expected Spud Date: 09/12/2007
 month day year

OPERATOR: License# 33168
 Name: Woolsey Operating Company, LLC
 Address 1: 125 N. MARKET, SUITE 1000
 Address 2:
 City: WICHITA State: KS Zip: 67202 + 1775
 Contact Person: Dean Pattisson
 Phone: 316-267-4379

CONTRACTOR: License# 33610
 Name: Fossil Drilling, Inc.

Well Drilled For: ☒ Oil ☐ Enh Rec ☒ Infield ☒ Mud Rotary
☒ Gas ☐ Storage ☐ Pool Ext. ☐ Air Rotary
☐ Disposal ☐ Wildcat ☐ Cable
☐ Seismic; # of Holes ☐ Other
☐ Other:
☐ If OWWO: old well information as follows:

Operator:
 Well Name:
 Original Completion Date: Original Total Depth:

Directional, Deviated or Horizontal wellbore? ☐ Yes ☒ No
 If Yes, true vertical depth:
 Bottom Hole Location:
 KCC DKT #:

Spot Description: 190' E of
E2 - SW - SW Sec. 6 Twp. 33 S. R. 10 ☐ E ☒ W
660 feet from ☐ N / ☒ S Line of Section
1,180 feet from ☐ E / ☒ W Line of Section
 Is SECTION: ☐ Regular ☒ Irregular?

(Note: Locate well on the Section Plat on reverse side)

County: Barber
 Lease Name: LIEBL Well #: 1
 Field Name: TRAFFAS
 Is this a Prorated / Spaced Field? ☐ Yes ☒ No
 Target Formation(s): Mississippian
 Nearest Lease or unit boundary line (in footage): 660
 Ground Surface Elevation: 1616 feet MSL
 Water well within one-quarter mile: ☐ Yes ☒ No
 Public water supply well within one mile: ☐ Yes ☒ No
 Depth to bottom of fresh water: 180
 Depth to bottom of usable water: 180
 Surface Pipe by Alternate: ☒ I ☐ II
 Length of Surface Pipe Planned to be set: 200
 Length of Conductor Pipe (if any): 0
 Projected Total Depth: 5120
 Formation at Total Depth: Simpson
 Water Source for Drilling Operations:
☐ Well ☐ Farm Pond ☒ Other: to be hauled
 DWR Permit #: (Note: Apply for Permit with DWR)
 Will Cores be taken? ☐ Yes ☒ No
 If Yes, proposed zone:

AFFIDAVIT

RECEIVED
 KANSAS CORPORATION COMMISSION

SEP 06 2007

The undersigned hereby affirms that the drilling, completion and eventual plugging of this well will comply with K.S.A. 55 et. seq.

It is agreed that the following minimum requirements will be met:

1. Notify the appropriate district office **prior** to spudding of well;
2. A copy of the approved notice of intent to drill **shall be** posted on each drilling rig;
3. The minimum amount of surface pipe as specified below **shall be set** by circulating cement to the top; in all cases surface pipe **shall be set** through all unconsolidated materials plus a minimum of 20 feet into the underlying formation.
4. If the well is dry hole, an agreement between the operator and the district office on plug length and placement is necessary **prior to plugging**;
5. The appropriate district office will be notified before well is either plugged or production casing is cemented in;
6. If an ALTERNATE II COMPLETION, production pipe shall be cemented from below any usable water to surface within **120 DAYS** of spud date. Or pursuant to Appendix "B" - Eastern Kansas surface casing order #133,891-C, which applies to the KCC District 3 area, alternate II cementing must be completed within 30 days of the spud date or the well shall be plugged. **In all cases, NOTIFY district office** prior to any cementing.

I hereby certify that the statements made herein are true and to the best of my knowledge and belief.

Date: 09/06/2007 Signature of Operator or Agent: Dean Pattisson Title: Operations Manager

For KCC Use ONLY
 API # 15 - 007-23193-0000
 Conductor pipe required 0 feet
 Minimum surface pipe required 200 feet per ALT. ☒ I ☐ II
 Approved by: 104 9-6-07
 This authorization expires: 3-6-08
 (This authorization void if drilling not started within 6 months of approval date.)
 Spud date: Agent:

- Remember to:**
- File Drill Pit Application (form CDP-1) with Intent to Drill;
 - File Completion Form ACO-1 within 120 days of spud date;
 - File acreage attribution plat according to field proration orders;
 - Notify appropriate district office 48 hours prior to workover or re-entry;
 - Submit plugging report (CP-4) after plugging is completed (within 60 days);
 - Obtain written approval before disposing or injecting salt water.
 - If this permit has expired (See: authorized expiration date) please check the box below and return to the address below.
- ☐ Well Not Drilled - Permit Expired Date: Signature of Operator or Agent:

Mail to: KCC - Conservation Division, 130 S. Market - Room 2078, Wichita, Kansas 67202

6
33
10
☐ E ☒ W

1011902

IN ALL CASES PLOT THE INTENDED WELL ON THE PLAT BELOW*Plat of acreage attributable to a well in a prorated or spaced field*

If the intended well is in a prorated or spaced field, please fully complete this side of the form. If the intended well is in a prorated or spaced field complete the plat below showing that the well will be properly located in relationship to other wells producing from the common source of supply. Please show all the wells and within 1 mile of the boundaries of the proposed acreage attribution unit for gas wells and within 1/2 mile of the boundaries of the proposed acreage attribution unit for oil wells.

API No. 15 - 007-23193-0000
 Operator: Woolsey Operating Company, LLC
 Lease: LIEBL
 Well Number: 1
 Field: TRAFFAS

Number of Acres attributable to well: _____
 QTR/QTR/QTR/QTR of acreage: _____ E2 _____ SW _____ SW

Location of Well: County: Barber
 660 _____ feet from ☐ N / ☒ S Line of Section
 1,180 _____ feet from ☐ E / ☒ W Line of Section
 Sec. 6 Twp. 33 S. R. 10 ☐ E ☒ W

Is Section: ☐ Regular or ☒ Irregular

If Section is Irregular, locate well from nearest corner boundary.

Section corner used: ☐ NE ☐ NW ☐ SE ☒ SW

PLAT

(Show location of the well and shade attributable acreage for prorated or spaced wells.)

(Show footage to the nearest lease or unit boundary line.)

RECEIVED
 KANSAS CORPORATION COMMISSION

SEP 06 2007

CONSERVATION DIVISION
 WICHITA, KS

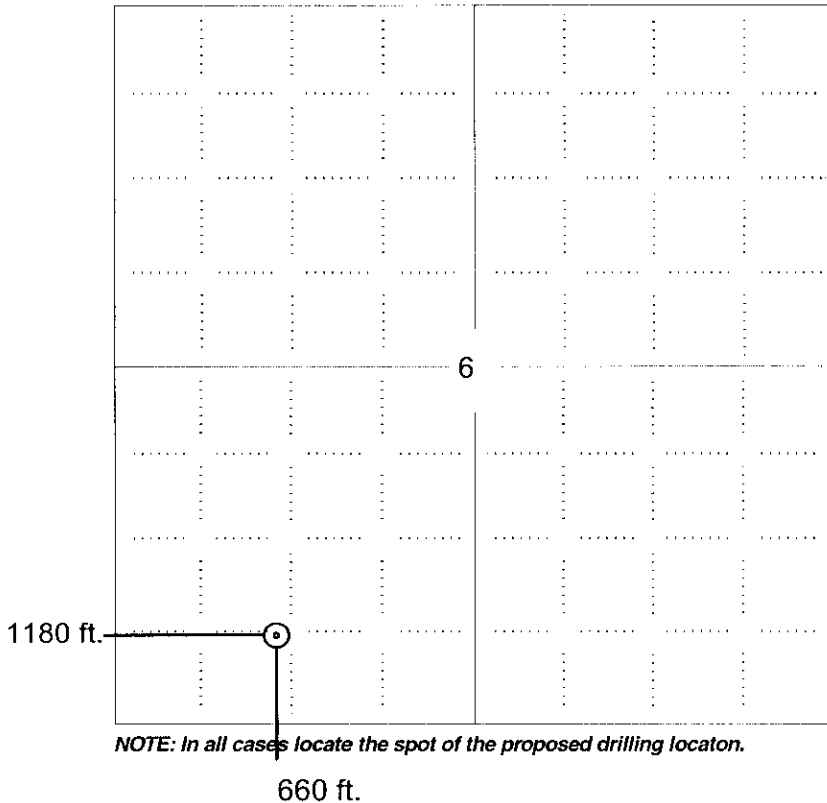

NOTE: In all cases locate the spot of the proposed drilling location.

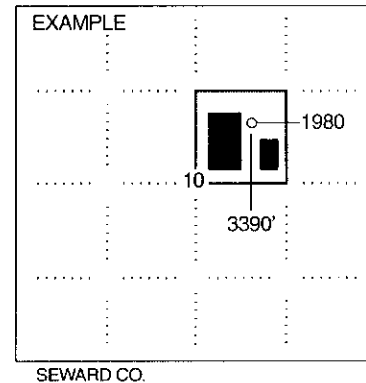

In plotting the proposed location of the well, you must show:

1. The manner in which you are using the depicted plat by identifying section lines, i.e. 1 section, 1 section with 8 surrounding sections, 4 sections, etc.
2. The distance of the proposed drilling location from the south / north and east / west outside section lines.
3. The distance to the nearest lease or unit boundary line (in footage).
4. If proposed location is located within a prorated or spaced field a certificate of acreage attribution plat must be attached: (CO-7 for oil wells; CG-8 for gas wells).

KANSAS CORPORATION COMMISSION
OIL & GAS CONSERVATION DIVISION

1011902

Form CDP-1
April 2004
Form must be Typed

APPLICATION FOR SURFACE PIT

Submit in Duplicate

Operator Name: Woolsey Operating Company, LLC		License Number: 33168	
Operator Address: 125 N. MARKET, SUITE 1000		WICHITA KS 67202	
Contact Person: Dean Pattisson		Phone Number: 316-267-4379	
Lease Name & Well No.: LIEBL 1		Pit Location (QQQQ):	
Type of Pit: <input type="checkbox"/> Emergency Pit <input type="checkbox"/> Burn Pit <input type="checkbox"/> Settling Pit <input checked="" type="checkbox"/> Drilling Pit <input type="checkbox"/> Workover Pit <input type="checkbox"/> Haul-Off Pit <small>(If WP Supply API No. or Year Drilled)</small>		Pit is: <input type="checkbox"/> Proposed <input checked="" type="checkbox"/> Existing If Existing, date constructed: _____ Pit capacity: 4,800 (bbls)	
		Sec. 6 Twp. 33 R. 10 <input type="checkbox"/> East <input checked="" type="checkbox"/> West 660 Feet from <input type="checkbox"/> North / <input checked="" type="checkbox"/> South Line of Section 1,180 Feet from <input type="checkbox"/> East / <input checked="" type="checkbox"/> West Line of Section Barber County	
Is the pit located in a Sensitive Ground Water Area? <input type="checkbox"/> Yes <input checked="" type="checkbox"/> No		Chloride concentration: _____ mg/l <small>(For Emergency Pits and Settling Pits only)</small>	
Is the bottom below ground level? <input checked="" type="checkbox"/> Yes <input type="checkbox"/> No	Artificial Liner? <input type="checkbox"/> Yes <input checked="" type="checkbox"/> No	How is the pit lined if a plastic liner is not used? Clays from mud will provide sealer	
Pit dimensions (all but working pits): 100 Length (feet) 100 Width (feet)		N/A: Steel Pits	
Depth from ground level to deepest point: 4 (feet)		No Pit	
If the pit is lined give a brief description of the liner material, thickness and installation procedure.		Describe procedures for periodic maintenance and determining liner integrity, including any special monitoring. <div style="text-align: right;"> RECEIVED SEP 06 2007 KANSAS CORPORATION COMMISSION CONSERVATION DIVISION WICHITA, KS </div>	
Distance to nearest water well within one-mile of pit 3795 feet Depth of water well 69 feet		Depth to shallowest fresh water 18 feet. Source of information: <input type="checkbox"/> measured <input type="checkbox"/> well owner <input type="checkbox"/> electric log <input checked="" type="checkbox"/> KDWR	
Emergency, Settling and Burn Pits ONLY: Producing Formation: _____ Number of producing wells on lease: _____ Barrels of fluid produced daily: _____ Does the slope from the tank battery allow all spilled fluids to flow into the pit? <input type="checkbox"/> Yes <input type="checkbox"/> No		Drilling, Workover and Haul-Off Pits ONLY: Type of material utilized in drilling/workover: Fresh Number of working pits to be utilized: 3 Abandonment procedure: When dry, backfill and restore location Drill pits must be closed within 365 days of spud date.	
I hereby certify that the above statements are true and correct to the best of my knowledge and belief.			
09/06/2007 Date		 Signature of Applicant or Agent	

KCC OFFICE USE ONLY

Steel Pit ☐ RFAC ☒ RFAS ☒

Date Received: 9/6/07 Permit Number: _____ Permit Date: 9/6/07 Lease Inspection: ☒ Yes ☐ No

Mail to: KCC - Conservation Division, 130 S. Market - Room 2078, Wichita, Kansas 67202

15-007-23193-0000



*Kathleen Sebelius, Governor
Thomas E. Wright, Chairman
Michael C. Moffet, Commissioner
Joseph F. Harkins, Commissioner*

September 06, 2007

Dean Pattisson
Woolsey Operating Company, LLC
125 N. MARKET, SUITE 1000
WICHITA, KS 67202-1775

RECEIVED
KANSAS CORPORATION COMMISSION

SEP 06 2007

CONSERVATION DIVISION
WICHITA, KS

Re: Drilling Pit Application
LIEBL Lease Well No. 1
SW/4 Sec.06-33S-10W
Barber County, Kansas

Dear Dean Pattisson:

District staff has inspected the above referenced location and has determined that an unsealed condition will present a pollution threat to water resources.

District staff has recommended that the reserve pit be lined with bentonite or native clay, constructed **without slots**, the bottom shall be flat and reasonably level and the free fluids must be removed. The fluids are to be removed from the reserve pit as soon as the Hutchinson Salt section has been drilled through and displacement of the fluids into the reserve pit has occurred. The fluids should be removed again within 72 hours after drilling operations have ceased.

If production casing is set all completion fluids shall be removed from the working pits daily. NO completion fluids or non-exempt wastes shall be placed in the reserve pit.

The fluids should be taken to an authorized disposal well. Please call the District Office at (620) 225-8888 when the fluids have been removed. Please file form CDP-5, Exploration and Production Waste Transfer, within 30 days of fluid removal. Conservation division forms are available through our office and on the KCC web site: kcc.ks.gov/conservation/forms/

A copy of this letter should be posted in the doghouse along with the approved Intent to Drill. If you have any questions or concerns please feel free to contact the District Office at (620) 225-8888.