

Correction - Well Number #

KANSAS CORPORATION COMMISSION OIL & GAS CONSERVATION DIVISION NOTICE OF INTENT TO DRILL

Must be approved by KCC five (5) days prior to commencing work

RECEIVED CORPORATION

AUG 28

CORRECTED 8-21-07

December 2002

Form must be Typed Form must be Signed All blanks must be Filled

For KCC Use: 8-14-07 Effective Date: District # 3 SGA? Yes No

Expected Spud Date September 2, 2007 month day year

OPERATOR: License# 33344 Name: Quest Cherokee LLC Address: 9520 North May Avenue Suite 300 City/State/Zip: Oklahoma City Oklahoma 73120 Contact Person: Richard Marlin Phone: 405-463-6880

CONTRACTOR: License# Will be licensed by the KCC Name: Will advise on the ACO-1

Well Drilled For: Oil Gas OAWD Seismic Other Enh Rec Storage Disposal Coalbed Methane Well Class: Infield Pool Ext Wildcat Other Type Equipment: Mud Rotary Air Rotary Cable

If OWWO: old well information as follows: Operator: Well Name: Original Completion Date: Original Total Depth:

Directional, Deviated or Horizontal wellbore? Yes No

If Yes, true vertical depth: Bottom Hole Location:

KCC DKT #: # WAS: 450' FWH, 1830' FWH, Well # 25-2, NLUB: 450' IS: 835' FWH, 1795' FWH Well # 25-2A, NLUB: 835'

Spot NE NW Sec. 25 Twp. 27 S. R. 19 East West 835 feet from N / S Line of Section 1785 feet from E / W Line of Section Is SECTION Regular Irregular?

County: Neosho Lease Name: Reinhardt, Richard Well # 25-2 Field Name: Cherokee Basin CBM

Is this a Prorated / Spaced Field? Yes No

Target Formation(s): Cherokee Coal

Nearest Lease or unit boundary: 835

Ground Surface Elevation: 978 feet MSL

Water well within one-quarter mile: Yes No

Public water supply well within one mile: Yes No

Depth to bottom of fresh water: 100

Depth to bottom of usable water: 150

Surface Pipe by Alternate: 1 2

Length of Surface Pipe Planned to be set: 25

Length of Conductor Pipe required:

Projected Total Depth: 1300

Formation at Total Depth: Cherokee Coals

Water Source for Drilling Operations: Well Farm Pond Other Air

DWR Permit #: (Note: Apply for Permit with DWR)

Will Cores be taken? Yes No

If Yes, proposed zone: 9-7-07 WAS: Well # 25-2A IS: Well # 25-2

AFFIDAVIT

The undersigned hereby affirms that the drilling, completion and eventual plugging of this well will comply with K.S. CORPORATION COMMISSION It is agreed that the following minimum requirements will be met:

- 1. Notify the appropriate district office prior to spudding of well; 2. A copy of the approved notice of intent to drill shall be posted on each drilling rig; 3. The minimum amount of surface pipe as specified below shall be set by circulating cement to the top; in all cases surface pipe shall be set through all unconsolidated materials plus a minimum of 20 feet into the underlying formation. 4. If the well is dry hole, an agreement between the operator and the district office on plug length and placement is necessary prior to plugging; 5. The appropriate district office will be notified before well is either plugged or production casing is cemented in; 6. If an ALTERNATE II COMPLETION, production pipe shall be cemented from below any usable water to surface within 120 days of spud date. Or pursuant to Appendix "B" - Eastern Kansas surface casing order #133,891-C, which applies to the KCC District 3 area, alternate II cementing must be completed within 30 days of the spud date or the well shall be plugged. In all cases, NOTIFY district office prior to any cementing.

I hereby certify that the statements made herein are true and to the best of my knowledge and belief.

Date: August 28, 2007 Signature of Operator or Agent: Richard Marlin Title: Vice President

SEP 06 2007

RECEIVED CONSERVATION DIVISION WICHITA, KS

For KCC Use ONLY API # 15 - 133-27112-0000 Conductor pipe required None feet Minimum surface pipe required 20 feet per Alt. Approved by: P/M 8-9-07 / P/M 8-29-07 / K/M 9-7-07 This authorization expires: 2-9-08 Spud date: Agent:

Remember to: - File Drill Pit Application (form CDP-1) with Intent to Drill; - File Completion Form ACO-1 within 120 days of spud date; - File acreage attribution plat according to field proration orders; - Notify appropriate district office 48 hours prior to workover or re-entry; - Submit plugging report (CP-4) after plugging is completed; - Obtain written approval before disposing or injecting salt water. - If this permit has expired (See: authorized expiration date) please check the box below and return to the address below. Well Not Drilled - Permit Expired Signature of Operator or Agent: Date:

Mail to: KCC - Conservation Division, 130 S. Market - Room 2078, Wichita, Kansas 67202

25 27 196

# CORRECTED IN ALL CASES PLOT THE INTENDED WELL ON THE PLAT BELOW

Plat of acreage attributable to a well in a prorated or spaced field

CORRECTED

If the intended well is in a prorated or spaced field, please fully complete this side of the form. If the intended well is in a prorated or spaced field complete the plat below showing that the well will be properly located in relationship to other wells producing from the common source of supply. Please show all the wells and within 1 mile of the boundaries of the proposed acreage attribution unit for gas wells and within 1/2 mile of the boundaries of the proposed acreage attribution unit for oil wells.

API No. 15 \_\_\_\_\_  
Operator: Quest Cherokee LLC  
Lease: Reinhardt, Richard  
Well Number: ~~25-2A~~ 25-2  
Field: Cherokee Basin CBM

Location of Well: County: Neosho  
835 feet from  N /  S Line of Section  
1795 feet from  E /  W Line of Section  
Sec. 25 Twp. 27 S. R. 19  East  West

Number of Acres attributable to well: \_\_\_\_\_  
QTR / QTR / QTR of acreage: \_\_\_\_\_ - NE - NW

Is Section:  Regular or  Irregular

If Section is Irregular, locate well from nearest corner boundary.

Section corner used:  NE  NW  SE  SW

### PLAT

(Show location of the well and shade attributable acreage for prorated or spaced wells.)  
(Show footage to the nearest lease or unit boundary line.)

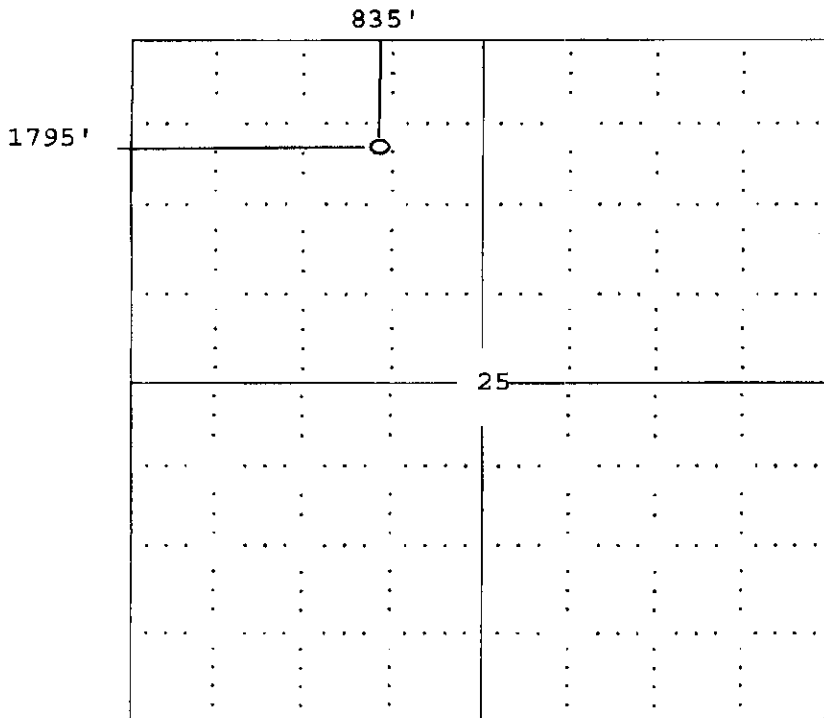

RECEIVED  
KANSAS CORPORATION COMMISSION

SEP 06 2007

CONSERVATION DIVISION  
WICHITA, KS

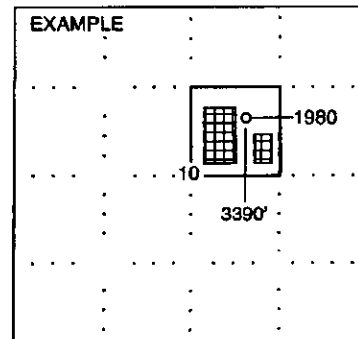

SEWARD CO.

NOTE: In all cases locate the spot of the proposed drilling location.

#### In plotting the proposed location of the well, you must show:

1. The manner in which you are using the depicted plat by identifying section lines, i.e. 1 section, 1 section with 8 surrounding sections, 4 sections, etc.
2. The distance of the proposed drilling location from the section's south / north and east / west.
3. The distance to the nearest lease or unit boundary line.
4. If proposed location is located within a prorated or spaced field a certificate of acreage attribution plat must be attached: (CO-7 for oil wells; CG-8 for gas wells).

**KANSAS CORPORATION COMMISSION  
OIL & GAS CONSERVATION DIVISION  
APPLICATION FOR SURFACE PIT**

Form CDP-1  
April 2004  
Form must be Typed

*Submit in Duplicate*

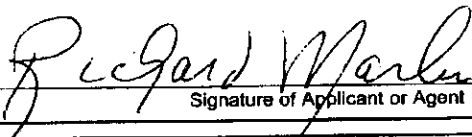
Operator Name: <b>Quest Cherokee LLC</b>		License Number: <b>33344</b>
Operator Address: <b>9520 North May Avenue Suite 300 Oklahoma City Oklahoma 73120</b>		
Contact Person: <b>Richard Marlin</b>		Phone Number: ( <b>405</b> ) <b>463 - 6880</b>
Lease Name & Well No.: <b>Reinhard, Richard R <del>25-2A</del> #25-2</b>		Pit Location (QQQQ): _____ <b>NE</b> _____ <b>NW</b> Sec. <b>25</b> Twp. <b>27</b> R. <b>19</b> <input checked="" type="checkbox"/> East <input type="checkbox"/> West <b>835</b> Feet from <input checked="" type="checkbox"/> North / <input type="checkbox"/> South Line of Section <b>1795</b> Feet from <input type="checkbox"/> East / <input checked="" type="checkbox"/> West Line of Section <b>Neosho</b> County
Type of Pit: <input type="checkbox"/> Emergency Pit <input type="checkbox"/> Burn Pit <input type="checkbox"/> Settling Pit <input checked="" type="checkbox"/> Drilling Pit <input type="checkbox"/> Workover Pit <input type="checkbox"/> Haul-Off Pit <small>(If WP Supply API No. or Year Drilled)</small>	Pit Is: <input checked="" type="checkbox"/> Proposed <input type="checkbox"/> Existing If Existing, date constructed: _____ Pit capacity: <b>300</b> (bbls)	
Is the pit located in a Sensitive Ground Water Area? <input type="checkbox"/> Yes <input checked="" type="checkbox"/> No		Chloride concentration: _____ mg/l <small>(For Emergency Pits and Settling Pits only)</small>
Is the bottom below ground level? <input type="checkbox"/> Yes <input checked="" type="checkbox"/> No	Artificial Liner? <input type="checkbox"/> Yes <input checked="" type="checkbox"/> No	How is the pit lined if a plastic liner is not used?
Pit dimensions (all but working pits): <u>30</u> Length (feet) <u>10</u> Width (feet) _____ N/A: Steel Pits Depth from ground level to deepest point: <u>10</u> (feet)		
If the pit is lined give a brief description of the liner material, thickness and installation procedure.		Describe procedures for periodic maintenance and determining liner integrity, including any special monitoring. <b>Air Drilling Operation Lasting Approx 3 Days</b>
Distance to nearest water well within one-mile of pit <u>5082</u> feet    Depth of water well <u>180</u> feet		Depth to shallowest fresh water <u>45</u> feet. Source of information: _____ measured _____ well owner _____ electric log _____ KDWR
<b>Emergency, Settling and Burn Pits ONLY:</b> Producing Formation: _____ Number of producing wells on lease: _____ Barrels of fluid produced daily: _____ Does the slope from the tank battery allow all spilled fluids to flow into the pit? <input type="checkbox"/> Yes <input type="checkbox"/> No		<b>Drilling, Workover and Haul-Off Pits ONLY:</b> Type of material utilized in drilling/workover: <u>Air-Drilled</u> Number of working pits to be utilized: <u>One</u> Abandonment procedure: <u>Air dry, Back fill and cover</u> Drill pits must be closed within 365 days of spud date.
I hereby certify that the above statements are true and correct to the best of my knowledge and belief.		
<u>August 28, 2007</u> Date	 Signature of Applicant or Agent	<b>RECEIVED</b> <b>AUG 28 2007</b> KANSAS CORPORATION COMMISSION CONSERVATION DIVISION WICHITA, KS
<b>KCC OFFICE USE ONLY</b>		
Date Received: <u>8/29/07</u>	Permit Number: _____	Permit Date: <u>8/29/07</u> Lease Inspection: <input type="checkbox"/> Yes <input checked="" type="checkbox"/> No

Mail to: KCC - Conservation Division, 130 S. Market - Room 2078, Wichita, Kansas **RECEIVED**

**SEP 06 2007**

CONSERVATION DIVISION  
WICHITA, KS