

RECEIVED O W W O
KANSAS CORPORATION COMMISSION

For KCC Use:
Effective Date: 9-18-07
District #: 4
SGA? Yes No

KANSAS CORPORATION COMMISSION
OIL & GAS CONSERVATION DIVISION
NOTICE OF INTENT TO DRILL

Form C-1
December 2002
Form must be Typed
Form must be Signed
All blanks must be Filled
SEP 12 2007
CONSERVATION DIVISION
WICHITA, KS

Must be approved by KCC five (5) days prior to commencing well

Expected Spud Date September 17, 2007
month day year

Spot E12-E12NW Sec. 11 Twp. 7 S. R. 21 East West
1400 feet from N / S Line of Section
2400 feet from E / W Line of Section
Is SECTION Regular Irregular?

OPERATOR: License# 9449 ✓
Name: Great Eastern Energy & Development Corp.
Address: P.O. Drawer 2436
City/State/Zip: Midland, TX. 79702
Contact Person: Bill Robinson
Phone: 214-220-1080

(Note: Locate well on the Section Plat on reverse side)
County: Graham
Lease Name: Jerome Well #: 1
Field Name: WC

CONTRACTOR: License# 33724 ✓
Name: Warren Drilling, LLC

Is this a Prorated / Spaced Field? Yes No
Target Formation(s): Arbuckle
Nearest Lease or unit boundary: 1240
Ground Surface Elevation: 2159 feet MSL

Well Drilled For: Oil Enh Rec Infield Mud Rotary ✓
 Gas Storage Pool Ext. Air Rotary
 O W O Disposal Wildcat ✓ Cable
 Seismic; # of Holes Other
 Other

Water well within one-quarter mile: Yes No
Public water supply well within one mile: Yes No
Depth to bottom of fresh water: 150
Depth to bottom of usable water: 950

If O W W O: old well information as follows:
Operator: Denis Roberts
Well Name: Benoit 33
Original Completion Date: D/A 8-24-04 Original Total Depth: 3736

Surface Pipe by Alternate: 1 2
Length of Surface Pipe ~~Planned to be set:~~ 200 230
Length of Conductor Pipe required: na
Projected Total Depth: 3736
Formation at Total Depth: Arbuckle

Directional, Deviated or Horizontal wellbore? Yes No
If Yes, true vertical depth: _____
Bottom Hole Location: _____
KCC DKT #: _____

Water Source for Drilling Operations:
 Well Farm Pond Other truck
DWR Permit #: _____
(Note: Apply for Permit with DWR)
Will Cores be taken? Yes No
If Yes, proposed zone: _____

Oil & Gas Lease Attached

AFFIDAVIT

The undersigned hereby affirms that the drilling, completion and eventual plugging of this well will comply with K.S.A. 55 et. seq.
It is agreed that the following minimum requirements will be met:

1. Notify the appropriate district office **prior** to spudding of well;
2. A copy of the approved notice of intent to drill **shall be** posted on each drilling rig;
3. The minimum amount of surface pipe as specified below **shall be set** by circulating cement to the top; in all cases surface pipe **shall be set** through all unconsolidated materials plus a minimum of 20 feet into the underlying formation.
4. If the well is dry hole, an agreement between the operator and the district office on plug length and placement is necessary **prior to plugging**;
5. The appropriate district office will be notified before well is either plugged or production casing is cemented in;
6. If an ALTERNATE II COMPLETION, production pipe shall be cemented from below any usable water to surface within **120 days** of spud date.
Or pursuant to Appendix "B" - Eastern Kansas surface casing order #133,891-C, which applies to the KCC District 3 area, alternate II cementing must be completed within 30 days of the spud date or the well shall be plugged. **In all cases, NOTIFY district office** prior to any cementing.

I hereby certify that the statements made herein are true and to the best of my knowledge and belief.

Date: 9-10-07 Signature of Operator or Agent: B. RO Title: agent

For KCC Use ONLY
API # 15 - 065-22994-00-01
Conductor pipe required None feet
Minimum surface pipe required 230 feet per Alt. XO 2
Approved by: km 9-13-07
This authorization expires: 3-13-08
(This authorization void if drilling not started within 6 months of approval date.)
Spud date: _____ Agent: _____

- Remember to:**
- File Drill Pit Application (form CDP-1) with Intent to Drill;
 - File Completion Form ACO-1 within 120 days of spud date;
 - File acreage attribution plat according to field proration orders;
 - Notify appropriate district office 48 hours prior to workover or re-entry;
 - Submit plugging report (CP-4) after plugging is completed;
 - Obtain written approval before disposing or injecting salt water.
 - If this permit has expired (See: authorized expiration date) please check the box below and return to the address below.
- Well Not Drilled - Permit Expired
Signature of Operator or Agent: _____
Date: _____

Mail to: KCC - Conservation Division, 130 S. Market - Room 2078, Wichita, Kansas 67202

11
7
21W

IN ALL CASES PLOT THE INTENDED WELL ON THE PLAT BELOW

SEP 12 2007

Plat of acreage attributable to a well in a prorated or spaced field

If the intended well is in a prorated or spaced field, please fully complete this side of the form. If the intended well is in a prorated or spaced field complete the plat below showing that the well will be properly located in relationship to other wells producing from the common source of supply. Please show all the wells and within 1 mile of the boundaries of the proposed acreage attribution unit for gas wells and within 1/2 mile of the boundaries of the proposed acreage attribution unit for oil wells.

API No. 15 - 065-22994-00-01
 Operator: Great Eastern Energy & Development Corp.
 Lease: Jerome
 Well Number: 1
 Field: WC
 Number of Acres attributable to well: _____
 QTR / QTR / QTR of acreage: CE/2 - E/2 - NW

Location of Well: County: Graham
 1400 feet from N / S Line of Section
 2400 feet from E / W Line of Section
 Sec. 11 Twp. 7 S. R. 21 East West

Is Section: Regular or Irregular

If Section is Irregular, locate well from nearest corner boundary.

Section corner used: NE NW SE SW

PLAT

*(Show location of the well and shade attributable acreage for prorated or spaced wells.)
 (Show footage to the nearest lease or unit boundary line.)*

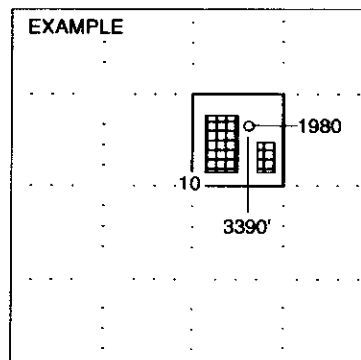
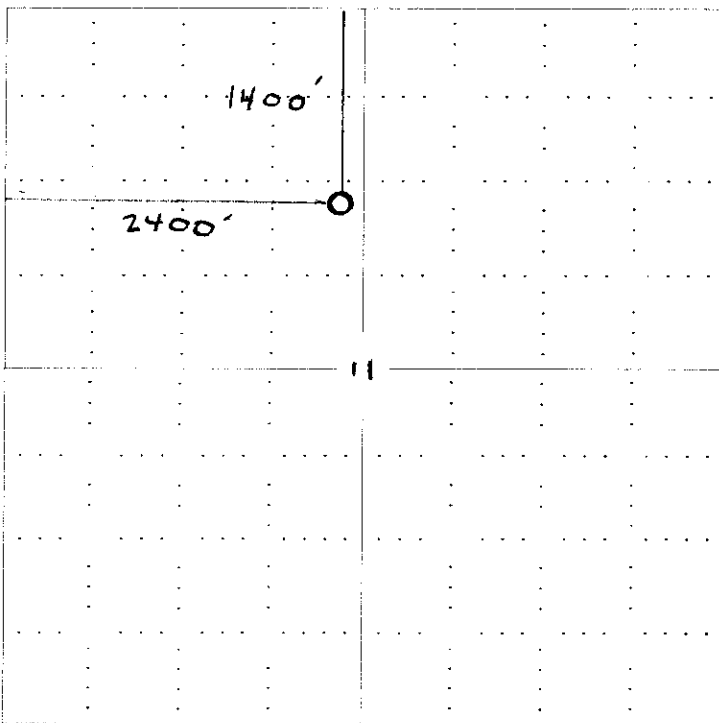

NOTE: In all cases locate the spot of the proposed drilling location.

In plotting the proposed location of the well, you must show:

1. The manner in which you are using the depicted plat by identifying section lines, i.e. 1 section, 1 section with 8 surrounding sections, 4 sections, etc.
2. The distance of the proposed drilling location from the section's south / north and east / west.
3. The distance to the nearest lease or unit boundary line.
4. If proposed location is located within a prorated or spaced field a certificate of acreage attribution plat must be attached: (C0-7 for oil wells; CG-8 for gas wells).

KANSAS CORPORATION COMMISSION
OIL & GAS CONSERVATION DIVISION
APPLICATION FOR SURFACE PIT

SEP 12 2007

Form CDP-1
April 2004
Form must be Typed

Submit in Duplicate

Operator Name: Great Eastern Energy & Development Corp.		License Number: 9449	
Operator Address: P.O. Box 2436 Midland, TX. 79702			
Contact Person: Bill Robinson		Phone Number: (214) 220 - 1080	
Lease Name & Well No.: Jerome #1		Pit Location (QQQQ): NE SE NW	
Type of Pit: <input type="checkbox"/> Emergency Pit <input type="checkbox"/> Burn Pit <input type="checkbox"/> Settling Pit <input checked="" type="checkbox"/> Drilling Pit <input type="checkbox"/> Workover Pit <input type="checkbox"/> Haul-Off Pit (If WP Supply API No. or Year Drilled)		Pit is: <input checked="" type="checkbox"/> Proposed <input type="checkbox"/> Existing If Existing, date constructed: _____ Pit capacity: _____ (bbls)	
Is the pit located in a Sensitive Ground Water Area? <input type="checkbox"/> Yes <input checked="" type="checkbox"/> No		Chloride concentration: _____ mg/l (For Emergency Pits and Settling Pits only)	
Is the bottom below ground level? <input checked="" type="checkbox"/> Yes <input type="checkbox"/> No		Artificial Liner? <input checked="" type="checkbox"/> Yes <input type="checkbox"/> No	
How is the pit lined if a plastic liner is not used?			
Pit dimensions (all but working pits): 100 Length (feet) 100 Width (feet) N/A: Steel Pits Depth from ground level to deepest point: 6 (feet)			
If the pit is lined give a brief description of the liner material, thickness and installation procedure.		Describe procedures for periodic maintenance and determining liner integrity, including any special monitoring.	
Distance to nearest water well within one-mile of pit N/A feet Depth of water well _____ feet		Depth to shallowest fresh water 150 feet. Source of information: <input checked="" type="checkbox"/> measured _____ well owner _____ electric log _____ KDWR	
Emergency, Settling and Burn Pits ONLY: Producing Formation: _____ Number of producing wells on lease: _____ Barrels of fluid produced daily: _____ Does the slope from the tank battery allow all spilled fluids to flow into the pit? <input type="checkbox"/> Yes <input type="checkbox"/> No		Drilling, Workover and Haul-Off Pits ONLY: Type of material utilized in drilling/workover: chemical mud Number of working pits to be utilized: 3 Abandonment procedure: backfill after evaporation Drill pits must be closed within 365 days of spud date.	
I hereby certify that the above statements are true and correct to the best of my knowledge and belief.			
_____ Date 9-10-07		_____ Signature of Applicant or Agent B. D.	

15-005-22994-00-01

KCC OFFICE USE ONLY			
Date Received: 9/12/07	Permit Number: _____	Permit Date: 9/12/07	Lease Inspection: <input type="checkbox"/> Yes <input checked="" type="checkbox"/> No

Mail to: KCC - Conservation Division, 130 S. Market - Room 2078, Wichita, Kansas 67202

TO:
STATE CORPORATION COMMISSION
CONSERVATION DIVISION - PLUGGING
130 SOUTH MARKET, SUITE 2078
WICHITA, KANSAS 67202

API Well Number: 15-065-22994-00-00
Spot: E2E2NW Sec/Twnshp/Rge: 11-7S-21W
1400 feet from N Section Line, 2400 feet from W Section Line
Lease Name: BENOIT Well #: 33
County: GRAHAM Total Vertical Depth: 3736 feet

Operator License No.: 32322
Op Name: DENIS F. ROBERTS
Address: BOX 1252 3904 FAIRWAY DR.
HAYS, KS 67601

SURF Size: 8.625 feet: 230

121 42

Well Type: DH UIC Docket No: _____ Date/Time to Plug: 08/29/2004 11:00 PM
Plug Co. License No.: 31548 Plug Co. Name: DISCOVERY DRILLING
Proposal Rcvd. from: TOM ALM Company: DISCOVERY DRILLING Phone: (785) 623-2920

Proposed Plugging Method: Order 200 sxs 60/40 pozmix - 6% gel with 1/4# flocele per sack.
Space all plugs with heavy drilling mud through drill pipe.
Arbuckle fount but tite.

Plugging Proposal Received By: HERB DEINES Witness Type: NONE
Date/Time Plugging Completed: 08/29/2004 12:00 AM KCC Agent: HERB DEINES

Actual Plugging Report:

1st Plug at 1750' w/25 sxs.
2nd. Plug at 1000' w/100 sxs.
3rd. Plug at 280' w/40 sxs.
4th. Plug at 40' w/10 sxs.
Rathole with 15 sxs.
Mousehole with 10 sxs.

Perfs:

RECEIVED
SEP 02 2004
KCC WICHITA

Remarks: ALLIED CEMENTING COMPANY.

Plugged through: DP

District: 04

Signed

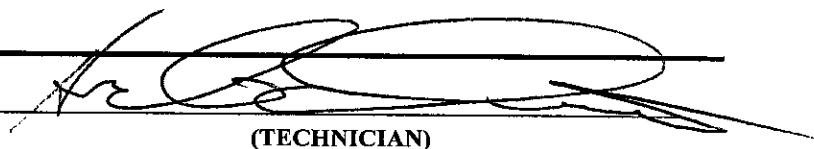

(TECHNICIAN)

INVOICE

DATE 9-3-04
INV. NO. 2005060491

Form CP-2/3

AUG 30 2004