

STATE CORPORATION COMMISSION
CONSERVATION DIVISION - PLUGGING
130 SOUTH MARKET, SUITE 2078
WICHITA, KANSAS 67202

API Well Number: 15-063-21431-00-00
Spot: NWNWSE Sec/Twnshp/Rge: 36-15S-27W
2290 feet from S Section Line, 2310 feet from E Section Line
Lease Name: CURTIS Well #: 1
County: GOVE Total Vertical Depth: 4400 feet

Operator License No.: 5135
Op Name: FARMER, JOHN O., INC.
Address: 370 W WICHITA AVE PO BOX 352
RUSSELL, KS 67665

| String | Size | Depth (ft) | Pulled (ft) | Comment |
|--------|-------|------------|-------------|---------|
| PROD | 4.5 | 4371 | 0 | 150 SX |
| SURF | 8.625 | 218 | 0 | 140 SX |

\$ 143.00

Well Type: OIL UIC Docket No: _____ Date/Time to Plug: 05/24/2007 10:00 AM
Plug Co. License No.: 31172 Plug Co. Name: L & M WELL SERVICING, INC.
Proposal Rcvd. from: VAL DREHER Company: FARMER, JOHN O., INC. Phone: (785) 483-3144

Proposed Plugging Method: Ordered 250 sxs 60/40 pozmix - 10% gel - 600# hulls.
Plug through tubing.

Plugging Proposal Received By: HERB DEINES Witness Type: COMPLETE (100%)
Date/Time Plugging Completed: 05/24/2007 3:00 PM KCC Agent: DARREL DIPMAN

Actual Plugging Report:

8 5/8" surface casing set at 218' w/140 sxs cement.
4 1/2" production casing set at 4371' w/150 sxs cement.
TD at 4400'. PBTD 4364'. Stage collar at 1897' w/450 sxs.
Junk in the hole at 4310'. Production casing had holes.
Ran tubing to 4275' - pumped 100 sxs cement with 0# hulls.
Pulled tubing to 2000' - pumped 35 sxs cement with 0# hulls - cement to surface.
Pulled tubing to surface.
Connected to 4 1/2" production casing - pumped 15 sxs cement.
Max. P.S.I. 1000#. S.I.P. 1000#.
Connected to 8 5/8" surface casing - pumped one sack cement.
Max. P.S.I. 500#. S.I.P. 500#.

Perfs:

| Top | Bot | Thru | Comments |
|------|------|------|----------|
| 4328 | 4334 | | |

INVOICED
DATE 6-12-07
INV. NO. 2007061888

Remarks: QUALITY CEMENT COMPANY-TICKET #1527.

Plugged through: TBG

District: 04

Signed Darrel Dipman
(TECHNICIAN)

RECEIVED
KANSAS CORPORATION COMMISSION

JUN 06 2007

Form CP-2/3

CONSERVATION DIVISION
WICHITA, KS

MAY 25 2007

Handwritten initials

STATE: KANSAS COUNTY: GOVE REISSUE 36-15S-27W
FIELD: WHITNEY SOUTH NW NW SE
OPER: FARMER JOHN O INC 2290 FSL 2310 FEL SEC
WELL: 1 CURTIS WELL CLASS: DO ELEV: 2455 KB
API: 15-063-21431 STATUS: OIL 2450 GR
SPUD: 05/06/92 COMP: 08/17/92
DTD: 4400 LTD: FTD: MISSISSIPPIAN PBTD:

LOC: 5 3/4 MI NW UTCA, KS

IP: COMP 8/17/92, IPP 30 BO, 3 BWP, GTY 39 PROD ZONE- MISSISSIPPIAN
4328-4334
NO CORES, FOUR DSTS

LOG TOPS:

| | | | |
|-------------|------------|---------------|------------|
| ANHYDRITE | 1894 561 | PAWNEE | 4174 -1719 |
| HEEBNER | 3668 -1213 | FORT SCOTT | 4231 -1776 |
| LANSING | 3728 -1273 | CHEROKEE | 4256 -1801 |
| STARK | 3974 -1519 | MISSISSIPPIAN | 4325 -1870 |
| KANSAS CITY | 4035 -1580 | | |
| TD | 4400 -1945 | | |

LOG TYPES: CBL, DI, VD;

CSGS: 8 5/8 @ 218 W/140 SX, 4 1/2 @ 4371 W/150 SX; DRLG COMP 05/14/92 RIG REL
05/15/92

STATE: KANSAS COUNTY: GOVE REISSUE 36-15S-27W
FIELD: WHITNEY SOUTH NW NW SE
OPER: FARMER JOHN O INC 2290 FSL 2310 FEL SEC
WELL: 1 CURTIS WELL CLASS: DO
(CONTINUED)

DSTS: DST # 1 (LANSING) 3885-3930, OP 45 MIN, SI 45 MIN, OP 45 MIN, SI 1 HR, REC:
120 FT MSW, IFP 67, FFP 76, IFP 86, FFP 86, ISIP 990, FSIP 1076, IHP 1949, FHP
1891, BHT 109 DST # 2 (MISSISSIPPIAN) 4325-4333, OP 45 MIN, SI 45 MIN, OP 1
HR, SI 1 HR, REC: 200 FT G, 124 FT O, 25 FT OCWM, IFP 48, FFP 57, IFP 67, FFP
76, ISIP 1248, FSIP 1200, IHP 2267, FHP 2200, BHT 114 DST # 3 (MISSISSIPPIAN)
4332-4340, OP 45 MIN, SI 45 MIN, OP 1 HR, SI 1 HR, REC: 150 FT O, 65 FT SOGW,
IFP 57, FFP 67, IFP 96, FFP 105, ISIP 1219, FSIP 1181, IHP 2257, FHP 2219, BHT 114
DST # 4 (LANSING - STRD) 3965-4029, OP 30 MIN, SI 30 MIN, OP 30 MIN, SI 30
MIN, REC: 25 FT M, IFP 67, FFP 67, IFP 76, FFP 76, ISIP 1019, FSIP 1009, IHP 2113,
FHP 2046, BHT 110;

PERFS: PERF (MISSISSIPPIAN) 4328-4334 W/4 PF, ACID W/300 GALS,
PRODUCING INTERVAL: PERF (MISSISSIPPIAN) 4328-4334,

OPER ADD: P O BOX 352, RUSSELL, KS, 67665 PHONE (913) 483-3144;

CONTR: EMPHASIS DRLG RIG # 8

WELL ID CHANGES: SPOT & FTG CHGD FROM NW NW SE 2310 FSL 2310 FEL FTG CHGD
FROM 2210 FSL 2310 FEL;

(CONTINUED ON NEXT CARD)

FOR KCC USE:

EFFECTIVE DATE: 5-2-92
DISTRICT # 4
SGA7... Yes No

State of Kansas
NOTICE OF INTENTION TO DRILL

001

Must be approved by the K.C.C. five (5) days prior to commencing well

Expected Spud Date 5 month 8 day 92 year
Spot NW SE Sec 36 Twp 15 S. Rg 27 East
X West

OPERATOR: License # 5135
Name: John O. Farmer, Inc.
Address: P.O. Box 352
City/State/Zip: Russell, KS 67665
Contact Person: Martin K. Dubois
Phone: (913) 483-3144

2310 feet from South ~~NORTH~~ line of Section
2310 feet from East ~~WEST~~ line of Section
IS SECTION X REGULAR IRREGULAR?

(NOTE: Locate well on the Section Plat on Reverse Side)
County: Gove
Lease Name: Curtis Well #: 1
Field Name: Whitney South (Abandoned)
Is this a Prorated/Spaced Field? yes X no
Target Formation(s): Lansing/Kansas City
Nearest lease or unit boundary: 330'
Ground Surface Elevation: 2490 (est.) feet MSL
Water well within one-quarter mile: yes X no
Public water supply well within one mile: yes X no
Depth to bottom of fresh water: 100'
Depth to bottom of usable water: 1600'
Surface Pipe by Alternate: 1 X 2
Length of Surface Pipe Planned to be set: 200'
Length of Conductor pipe required:
Projected Total Depth: 4430'
Formation at Total Depth: Mississippian
Water Source for Drilling Operations:
... well X farm pond ... other
DWR Permit #:
Will Cores Be Taken?: yes X no
If yes, proposed zone:

CONTRACTOR: License #: unknown
Name: unknown

Well Drilled For: Well Class: Type Equipment:
X Oil ... Enh Rec ... Infield X Mud Rotary
Gas ... Storage ... Pool Ext. ... Air Rotary
OWWO ... Disposal ... Wildcat ... Cable
Seismic; # of Holes X Other
Other Pool Revival
If OWWO: old well information as follows:
Operator: NA
Well Name:
Comp. Date: Old Total Depth

Directional, Deviated or Horizontal wellbore? yes X no
If yes, true vertical depth:
Bottom Hole Location:

* was 2310' fs | NW NWSE

AFFIDAVIT * is 20' S. of NNNWSE & 2290' F

The undersigned hereby affirms that the drilling, completion and eventual plugging of this well will comply with K.S.A. 55-101, et. seq.
It is agreed that the following minimum requirements will be met:

- 1. Notify the appropriate district office prior to spudding of well;
- 2. A copy of the approved notice of intent to drill shall be posted on each drilling rig;
- 3. The minimum amount of surface pipe as specified below shall be set by circulating cement to the top; in all cases surface pipe shall be set through all unconsolidated materials plus a minimum of 20 feet into the underlying formation;
- 4. If the well is dry hole, an agreement between the operator and the district office on plug length and placement is necessary prior to plugging;
- 5. The appropriate district office will be notified before well is either plugged or production casing is cemented in;
- 6. IF AN ALTERNATE II COMPLETION, PRODUCTION PIPE SHALL BE CEMENTED FROM BELOW ANY USABLE WATER TO SURFACE WITHIN 120 DAYS OF SPUD DATE. IN ALL CASES, NOTIFY DISTRICT OFFICE PRIOR TO ANY CEMENTING.

I hereby certify that the statements made herein are true and to the best of my knowledge and belief.
Date: 4-24-92 Signature of Operator or Agent: Martin K. Dubois Title: Geologist

FOR KCC USE:
API # 15- 063-21431
Conductor pipe required None feet
Minimum surface pipe required 200 feet per Alt. X (2)
Approved by: DA 4-27-92
This authorization expires: 10-27-92
(This authorization void if drilling not started within 6 months of effective date.)
Spud date: Agent:

Col 7/22/92
RECEIVED
APR 27 1992
CONSERVATION DIVISION
Wichita, Kansas

36
15
27

REMEMBER TO:

- File Drill Pit Application (form CDP-1) with Intent to Drill;
- File Completion Form ACD-1 within 120 days of spud date;
- File acreage attribution plat according to field proration orders;
- Notify appropriate district office 48 hours prior to workover or re-entry;
- Submit plugging report (CP-4) after plugging is completed;
- Obtain written approval before disposing or injecting salt water.

Mail to: Conservation Division, 200 Colorado Derby Building, 202 W. First St., Wichita, Kansas 67202-1286.

IN ALL CASES PLOT THE INTENDED WELL ON THE PLAT BELOW

PLAT OF ACREAGE ATTRIBUTABLE TO A WELL IN A PRORATED OR SPACED FIELD

If the intended well is in a prorated or spaced field, please fully complete this side of the form. If the intended well is in a prorated or spaced field complete the plat below showing that the well will be properly located in relationship to other wells producing from the common source of supply. Please show all the wells within 1 mile of the boundaries of the proposed acreage attribution unit for gas wells and within 1/2 mile of the boundaries of the proposed acreage attribution unit for oil wells.

API NO. 15- _____
 OPERATOR _____ LOCATION OF WELL: COUNTY _____
 LEASE _____ feet from south/north line of section _____
 WELL NUMBER _____ feet from east/west line of section _____
 FIELD _____ SECTION _____ TWP _____ RG _____

NUMBER OF ACRES ATTRIBUTABLE TO WELL _____ IS SECTION _____ REGULAR or _____ IRREGULAR
 QTR/QTR/QTR OF ACREAGE _____ IF SECTION IS IRREGULAR, LOCATE WELL FROM NEAREST
CORNER BOUNDARY.

Section corner used: _____ NE _____ NW _____ SE _____ SW

PLAT

(Show location of the well and shade attributable acreage for prorated or spaced wells.)
 (Show footage to the nearest lease or unit boundary line.)

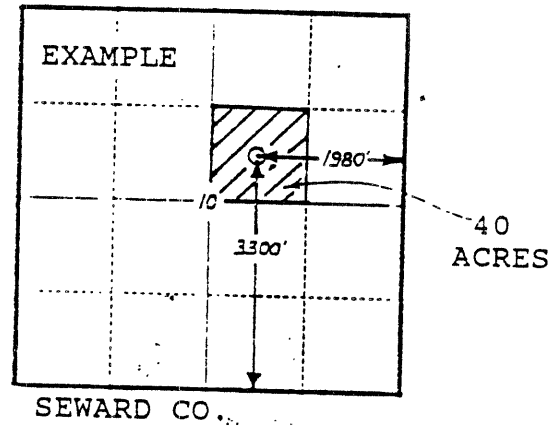
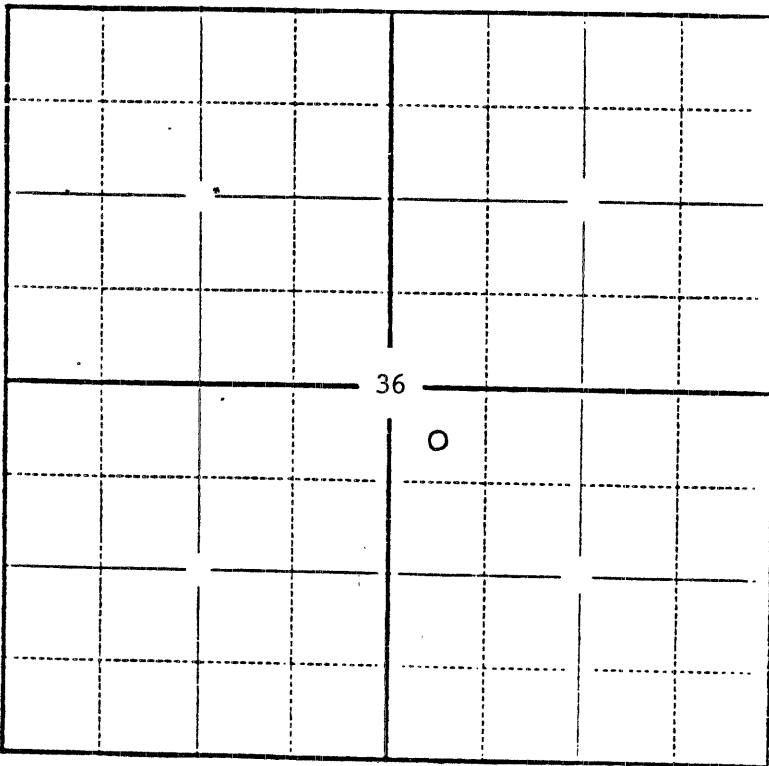

In plotting the proposed location of the well, you must show:

- 1) The manner in which you are using the depicted plat by identifying section lines, i.e. 1 section, 1 section with 8 surrounding sections, 4 sections, etc.;
- 2) the distance of the proposed drilling location from the section's south/north and east/west lines; and
- 3) the distance to the nearest lease or unit boundary line.