

STATE CORPORATION COMMISSION OF KANSAS
OIL & GAS CONSERVATION DIVISION

WELL COMPLETION OR RECOMPLETION FORM
ACO-1 WELL HISTORY

DESCRIPTION OF WELL AND LEASE

Operator: license # 6762
name Mid Kansas Exploration Co.
address 210 East 6th
Box 580
City/State/Zip South Hutchinson, KS 67504

Operator Contact Person James T. Perry
Phone (316) 662-4401

Contractor: license # 5422
name Abercrombie Drilling, Inc.

Wellsite Geologist F. Calvin Jones
Phone (316) 264-9281

PURCHASER
Designate Type of Completion
 New Well Re-Entry Workover

- Oil SWD Temp Abd
- Gas Inj Delayed Comp.
- Dry Other (Core, Water Supply etc.)

If OWWO: old well info as follows:
Operator
Well Name
Comp. Date Old Total Depth

WELL HISTORY

Drilling Method: Mud Rotary Air Rotary Cable
7/5/84 7/12/84 8/1/84
Spud Date Date Reached TD Completion Date
3450' 3407'
Total Depth PBTD
Amount of Surface Pipe Set and Cemented at 262 feet
Multiple Stage Cementing Collar Used? Yes No
If Yes, Show Depth Set 1320 feet
If alternate 2 completion, cement circulated
from 1320 feet depth to surface w/ 400' SX cmt

API NO. 15-163-22,123 0000
County Rooks
NW SE SE Sec 22 Twp 8S Rge 18W
990 Ft North from Southeast Corner of Section
330 Ft West from Southeast Corner of Section
(Note: locate well in section plat below)

Lease Name Kellogg Well# 2
Field Name
Producing Formation
Elevation: Ground 1921' KB 1926'

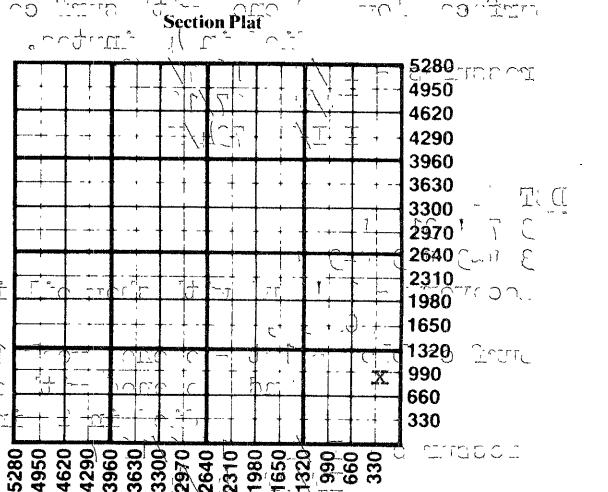

WATER SUPPLY INFORMATION

Source of Water:
Division of Water Resources Permit #
 Groundwater Ft North From Southeast Corner and
(Well) Ft. West From Southeast Corner of
Sec Twp Rge East West
 Surface Water 4290 Ft North From Southeast Corner and
(Stream, Pond etc.) 5280 Ft West From Southeast Corner
Sec 26 Twp 8S Rge 19 East West
 Other (explain)
(purchased from city, R.W.D.#)

Disposition of Produced Water: Disposal Repressuring
Docket #

INSTRUCTIONS: This form shall be completed in duplicate and filed with the Kansas Corporation Commission, 200 Colorado Derby Building, Wichita, Kansas 67202, within 90 days after completion or recompletion of any well. Rules 82-3-130 and 82-3-107 apply.
Information on side two of this form will be held confidential for a period of 12 months if requested in writing and submitted with the form. See rule 82-3-107 for confidentiality in excess of 12 months.
One copy of all wireline logs and drillers time log shall be attached with this form. Submit CP-4 form with all plugged wells. Submit CP-111 form with all temporarily abandoned wells.

All requirements of the statutes, rules, and regulations promulgated to regulate the oil and gas industry have been fully complied with and the statements herein are complete and correct to the best of my knowledge.

Signature James T. Perry
Title President, Mid Kansas Exploration Co. Date 10/4/84
Subscribed and sworn to before me this 4th day of October 1984
Notary Public Sandra K. Mosier
Date Commission Expires 5/1/88

RECEIVED
OCT 05 1984
STATE CORPORATION COMMISSION
WICHITA, KANSAS

K.C.C. OFFICE USE ONLY
F Letter of Confidentiality Attached
C Wireline Log Received
C Drillers Timelog Received
Distribution
 KCC SWD/Rep NGPA
 KGS Plug Other
(Specify)

NOTARY PUBLIC - State of Kansas
SANDRA K. MOSIER
My Appt. Exp. 5/1/88

SIDE TWO

Operator Name Mid. Kansas Exploration Co. Lease Name Kellogg Well# 2 SEC. 22 TWP. 8S RGE. 18W East West

WELL LOG

INSTRUCTIONS: Show important tops and base of formations penetrated. Detail all cores. Report all drill stem tests giving interval tested, time tool open and closed, flowing and shut-in pressures, whether shut-in pressure reached static level, hydrostatic pressures, bottom hole temperature, fluid recovery, and flow rates if gas to surface during test. Attach extra sheet if more space is needed. Attach copy of log.

Drill Stem Tests Taken Yes No
 Samples Sent to Geological Survey Yes No
 Cores Taken Yes No

Formation Description
 Log Sample

DST #1

3039'-3055'
 15"-15"-NA-NA
 Recovery - 5' of mud with show of oil in top of tool.
 CL 85,000 ppm
 Surface Blow - Opened with surface bubbles -
 died in 4 minutes.
 Pressures - IH/FH 1607/1587
 IF/FF 27/18
 ISI/NA 734/NA

Name	Top	Bottom
Anhydrite	1341	
Base Anhydrite	1380	
Topeka	2860	
Heebner	3067	
Toronto	3092	
Lansing	3109	
Basal Pennsylvanian		
Conglomerate	3324	
Arbuckle	3357	

DST #2

3070'-3120'
 30"-30"-30"-30"
 Recovery - 12' mud with show oil in top of tool.
 CL 58,000 ppm
 Surface blow - 1st - opened weak 1/8" died in 18 minutes.
 2nd - opened with surface bubbles -
 died in 2 minutes
 Pressures - IH/FH 1626/1607
 IF/FF 46/46
 ISI/FSI 495/447
 IF/FF 50/50

CASING RECORD <input checked="" type="checkbox"/> new <input type="checkbox"/> used							
Report all strings set - conductor, surface, intermediate, production, etc.							
Purpose of string	size hole drilled	size casing set (in O.D.)	weight lbs/ft.	setting depth	type of cement	# sacks used	type and percent additives
Surface Production	12 1/2" 7 7/8"	8 5/8" 5 1/2"	23# 14#	262.90' 3447.51'	60-40 per EA2 Hal. Lt. Salt flush 20 bbls.	210 175 400	2% gel, 3% c.c. .75% CFR2 1/4# Floccel
PERFORATION RECORD				Acid, Fracture, Shot, Cement Squeeze Record			
shots per foot	specify footage of each interval perforated			(amount and kind of material used)			Depth
3	3372'-75'			250 gal. - 15% INS. Acid			3366'
3	3402'-05'			750 gal. - 15% INS. Acid			3372-75'
2	3418'-20'			2000 gal. - 15% INS. Acid			3402-05'
				2000 Gal. - 15% INS. Acid			3418-20'
TUBING RECORD					Liner Run <input type="checkbox"/> Yes <input type="checkbox"/> No		
Date of First Production	Producing method	<input type="checkbox"/> flowing <input type="checkbox"/> pumping <input type="checkbox"/> gas lift <input type="checkbox"/> Other (explain)					
Estimated Production Per 24 Hours	Oil	Gas	Water	Gas-Oil Ratio	Gravity		
	Bbls	MCF	Bbls	CFPB			

Disposition of gas: vented sold used on lease

METHOD OF COMPLETION open hole perforation other (specify) _____

PRODUCTION INTERVAL Dually Completed. Commingled