

For KCC Use: 9-22-07  
 Effective Date: \_\_\_\_\_  
 District # 1  
 SGA?  Yes  No

**KANSAS CORPORATION COMMISSION**  
**OIL & GAS CONSERVATION DIVISION**  
**NOTICE OF INTENT TO DRILL**

Form C-1  
 December 2002  
**Form must be Typed**  
**Form must be Signed**  
**All blanks must be Filled**

Must be approved by KCC five (5) days prior to commencing well

Expected Spud Date 11/01/07  
 month day year

OPERATOR: License# 30535  
 Name: HARTMAN OIL CO., INC.  
 Address: 12950 E. 13TH STREET  
 City/State/Zip: WICHITA, KS 67230  
 Contact Person: STAN MITCHELL  
 Phone: (620) 277-2511

CONTRACTOR: License# 33793  
 Name: H2 DRILLING, LLC

<input checked="" type="checkbox"/> Oil	<input type="checkbox"/> Enh Rec	<input checked="" type="checkbox"/> Infield	<input checked="" type="checkbox"/> Mud Rotary
<input type="checkbox"/> Gas	<input type="checkbox"/> Storage	<input type="checkbox"/> Pool Ext.	<input type="checkbox"/> Air Rotary
<input type="checkbox"/> OWWO	<input type="checkbox"/> Disposal	<input type="checkbox"/> Wildcat	<input type="checkbox"/> Cable
<input type="checkbox"/> Seismic; # of Holes	<input type="checkbox"/> Other		
<input type="checkbox"/> Other			

If OWWO: old well information as follows:  
 Operator: \_\_\_\_\_  
 Well Name: \_\_\_\_\_  
 Original Completion Date: \_\_\_\_\_ Original Total Depth: \_\_\_\_\_  
 Directional, Deviated or Horizontal wellbore?  Yes  No  
 If Yes, true vertical depth: \_\_\_\_\_  
 Bottom Hole Location: \_\_\_\_\_  
 KCC DKT #: \_\_\_\_\_

Spot SE SE NW Sec. 18 Twp. 21S S. R. 22  East  West  
 2310 feet from  N /  S Line of Section  
 2310 feet from  E /  W Line of Section  
 Is SECTION  Regular  Irregular?

(Note: Locate well on the Section Plat on reverse side)  
 County: HODGEMAN  
 Lease Name: Antrim Well #: 6  
 Field Name: Wieland West  
 Is this a Prorated / Spaced Field?  Yes  No  
 Target Formation(s): Ft. Scott/Mississippian  
 Nearest Lease or unit boundary: 330'  
 Ground Surface Elevation: 2280 feet MSL  
 Water well within one-quarter mile:  Yes  No  
 Public water supply well within one mile:  Yes  No  
 Depth to bottom of fresh water: 180'  
 Depth to bottom of usable water: 650'  
 Surface Pipe by Alternate:  1  2  
 Length of Surface Pipe Planned to be set: 300'  
 Length of Conductor Pipe required: none  
 Projected Total Depth: 4460'  
 Formation at Total Depth: MISSISSIPPIAN  
 Water Source for Drilling Operations:  
 Well  Farm Pond  Other Hauling  
 DWR Permit #: \_\_\_\_\_  
 (Note: Apply for Permit with DWR )  
 Will Cores be taken?  Yes  No  
 If Yes, proposed zone: \_\_\_\_\_

**RECEIVED**  
 KANSAS CORPORATION COMMISSION

**AFFIDAVIT**

The undersigned hereby affirms that the drilling, completion and eventual plugging of this well will comply with K.S.A. 55 et. seq. **SEP 14 2007**

- It is agreed that the following minimum requirements will be met:
1. Notify the appropriate district office **prior** to spudding of well;
  2. A copy of the approved notice of intent to drill **shall be** posted on each drilling rig;
  3. The minimum amount of surface pipe as specified below **shall be set** by circulating cement to the top; in all cases surface pipe **shall be set** through all unconsolidated materials plus a minimum of 20 feet into the underlying formation.
  4. If the well is dry hole, an agreement between the operator and the district office on plug length and placement is necessary **prior to plugging**;
  5. The appropriate district office will be notified before well is either plugged or production casing is cemented in;
  6. If an ALTERNATE II COMPLETION, production pipe shall be cemented from below any usable water to surface within **120 days** of spud date.  
 Or pursuant to Appendix "B" - Eastern Kansas surface casing order #133,891-C, which applies to the KCC District 3 area, alternate II cementing must be completed within 30 days of the spud date or the well shall be plugged. **In all cases, NOTIFY district office** prior to any cementing.

I hereby certify that the statements made herein are true and to the best of my knowledge and belief.  
 Date: 9/13/07 Signature of Operator or Agent: Chris Patten Title: GEOLOGIST

**For KCC Use ONLY**  
 API # 15 - 083-21536-0000  
 Conductor pipe required None feet  
 Minimum surface pipe required 200 feet per Alt. **X2**  
 Approved by: Pat 9-17-07  
 This authorization expires: 3-17-08  
 (This authorization void if drilling not started within 6 months of approval date.)  
 Spud date: \_\_\_\_\_ Agent: \_\_\_\_\_

**Remember to:**

- File Drill Pit Application (form CDP-1) with Intent to Drill;
- File Completion Form ACO-1 within 120 days of spud date;
- File acreage attribution plat according to field proration orders;
- Notify appropriate district office 48 hours prior to workover or re-entry;
- Submit plugging report (CP-4) after plugging is completed;
- Obtain written approval before disposing or injecting salt water.

- If this permit has expired (See: authorized expiration date) please check the box below and return to the address below.  
 Well Not Drilled - Permit Expired  
 Signature of Operator or Agent: \_\_\_\_\_  
 Date: \_\_\_\_\_

Mail to: KCC - Conservation Division, 130 S. Market - Room 2078, Wichita, Kansas 67202

18  
 21  
 22W

### IN ALL CASES PLOT THE INTENDED WELL ON THE PLAT BELOW

Plat of acreage attributable to a well in a prorated or spaced field

If the intended well is in a prorated or spaced field, please fully complete this side of the form. If the intended well is in a prorated or spaced field complete the plat below showing that the well will be properly located in relationship to other wells producing from the common source of supply. Please show all the wells and within 1 mile of the boundaries of the proposed acreage attribution unit for gas wells and within 1/2 mile of the boundaries of the proposed acreage attribution unit for oil wells.

API No. 15 - 081-21536-0000  
Operator: HARTMAN OIL CO., INC.  
Lease: Antrim  
Well Number: 6  
Field: Wieland West

Location of Well: County: HODGEMAN  
2310 feet from  N /  S Line of Section  
2310 feet from  E /  W Line of Section  
Sec. 18 Twp. 21S S. R. 22  East  West

Number of Acres attributable to well: \_\_\_\_\_  
QTR / QTR / QTR of acreage: SE - SE - NW

Is Section:  Regular or  Irregular

If Section is Irregular, locate well from nearest corner boundary.

Section corner used:  NE  NW  SE  SW

### PLAT

(Show location of the well and shade attributable acreage for prorated or spaced wells.)

(Show footage to the nearest lease or unit boundary line.)

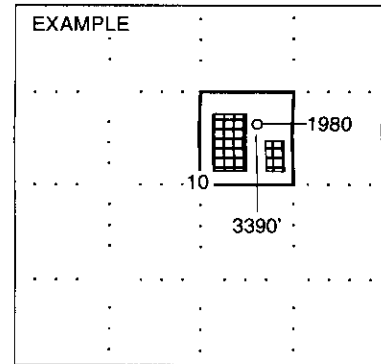
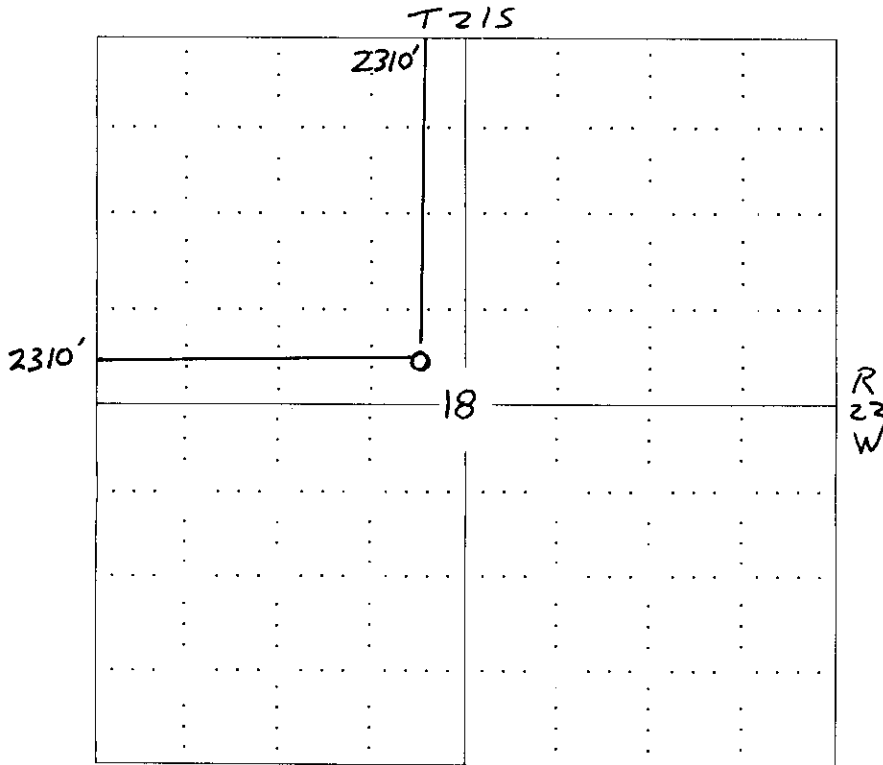

NOTE: In all cases locate the spot of the proposed drilling location.

RECEIVED  
KANSAS CORPORATION COMMISSION

SEP 14 2007

#### In plotting the proposed location of the well, you must show:

1. The manner in which you are using the depicted plat by identifying section lines, i.e. 1 section, 1 section with 8 surrounding sections, 4 sections, etc.
2. The distance of the proposed drilling location from the section's south / north and east / west.
3. The distance to the nearest lease or unit boundary line.
4. If proposed location is located within a prorated or spaced field a certificate of acreage attribution plat must be attached: (C0-7 for oil wells; CG-8 for gas wells).

CONSERVATION DIVISION  
WICHITA, KS

**KANSAS CORPORATION COMMISSION  
OIL & GAS CONSERVATION DIVISION  
APPLICATION FOR SURFACE PIT**

Form CDP-1  
April 2004  
Form must be Typed

*Submit in Duplicate*

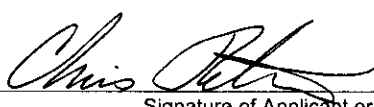
Operator Name: <b>HARTMAN OIL CO., INC.</b>		License Number: <b>30535</b>
Operator Address: <b>12950 E. 13TH ST. N.</b>		
Contact Person: <b>STAN MITCHELL</b>		Phone Number: ( <b>620</b> ) <b>277 - 2511</b>
Lease Name & Well No.: <b>Antrim #6</b>		Pit Location (QQQQ): <b>SE SE NW</b>
Type of Pit: <input type="checkbox"/> Emergency Pit <input type="checkbox"/> Burn Pit <input type="checkbox"/> Settling Pit <input checked="" type="checkbox"/> Drilling Pit <input type="checkbox"/> Workover Pit <input type="checkbox"/> Haul-Off Pit <small>(If WP Supply API No. or Year Drilled)</small>	Pit is: <input checked="" type="checkbox"/> Proposed <input type="checkbox"/> Existing If Existing, date constructed: _____ Pit capacity: _____ (bbls)	Sec. <u>18</u> Twp. <u>21S</u> R. <u>22</u> <input type="checkbox"/> East <input checked="" type="checkbox"/> West <u>2310</u> Feet from <input checked="" type="checkbox"/> North / <input type="checkbox"/> South Line of Section <u>2310</u> Feet from <input type="checkbox"/> East / <input checked="" type="checkbox"/> West Line of Section <b>HODGEMAN</b> _____ County
Is the pit located in a Sensitive Ground Water Area? <input type="checkbox"/> Yes <input checked="" type="checkbox"/> No		Chloride concentration: _____ mg/l <small>(For Emergency Pits and Settling Pits only)</small>
Is the bottom below ground level? <input checked="" type="checkbox"/> Yes <input type="checkbox"/> No	Artificial Liner? <input checked="" type="checkbox"/> Yes <input type="checkbox"/> No	How is the pit lined if a plastic liner is not used?
Pit dimensions (all but working pits): <u>70</u> Length (feet) <u>70</u> Width (feet) <b>N/A: Steel Pits</b> Depth from ground level to deepest point: <u>5</u> (feet)		
If the pit is lined give a brief description of the liner material, thickness and installation procedure. <b>10 Mil Plastic, held in place by earthen berm</b>		Describe procedures for periodic maintenance and determining liner integrity, including any special monitoring. <b>monitor hourly</b>
Distance to nearest water well within one-mile of pit <u>N/A</u> feet    Depth of water well _____ feet		Depth to shallowest fresh water <u>120</u> feet. Source of information: _____ measured <input checked="" type="checkbox"/> well owner _____ electric log _____ KDWR
<b>Emergency, Settling and Burn Pits ONLY:</b> Producing Formation: _____ Number of producing wells on lease: _____ Barrels of fluid produced daily: _____ Does the slope from the tank battery allow all spilled fluids to flow into the pit? <input type="checkbox"/> Yes <input type="checkbox"/> No		<b>Drilling, Workover and Haul-Off Pits ONLY:</b> Type of material utilized in drilling/workover: <u>drilling mud/chemical</u> Number of working pits to be utilized: <u>one</u> Abandonment procedure: <u>empty fluid-fluid kept 2' below ground level to dry out, close within 1 year</u> Drill pits must be closed within 365 days of spud date.
I hereby certify that the above statements are true and correct to the best of my knowledge and belief.		<b>RECEIVED KANSAS CORPORATION COMMISSION</b>
<u>9/13/07</u> Date	 Signature of Applicant or Agent	<b>SEP 14 2007</b>

15-081-21536-0000

<b>KCC OFFICE USE ONLY</b>		<small>CONSERVATION DIVISION WICHITA, KS</small>	
Date Received: <u>9/14/07</u>	Permit Number: _____	Permit Date: <u>9/14/07</u>	Lease Inspection: <input type="checkbox"/> Yes <input checked="" type="checkbox"/> No

Mail to: KCC - Conservation Division, 130 S. Market - Room 2078, Wichita, Kansas 67202