

For KCC Use:
Effective Date: 9-23-07
District # 3
SGA? Yes No

KANSAS CORPORATION COMMISSION 1012122
OIL & GAS CONSERVATION DIVISION

Form C-1
November 2005
Form must be Typed
Form must be Signed
All blanks must be Filled

NOTICE OF INTENT TO DRILL
Must be approved by KCC five (5) days prior to commencing well

Expected Spud Date: 09/20/2007
month day year

OPERATOR: License# 5150
Name: Colt Energy Inc
Address 1: PO BOX 388
Address 2: _____
City: IOLA State: KS Zip: 66749 + 0388
Contact Person: DENNIS KERSHNER
Phone: 620-365-3111
CONTRACTOR: License# 5989
Name: Finney, Kurt

Well Drilled For: Oil Gas
Well Class: Enh Rec Storage Disposal
Type Equipment: Mud Rotary Air Rotary Cable
 Seismic; # of Holes _____
 Other: _____

If OWWO: old well information as follows:
Operator: _____
Well Name: _____
Original Completion Date: _____ Original Total Depth: _____

Directional, Deviated or Horizontal wellbore? Yes No
If Yes, true vertical depth: _____
Bottom Hole Location: _____
KCC DKT #: _____

Spot Description: _____
NE - SW - SE - NW Sec. 12 Twp. 23 S. R. 16 E W
(a/a/a) 1,980 feet from N / S Line of Section
1,900 feet from E / W Line of Section

Is SECTION: Regular Irregular?
(Note: Locate well on the Section Plat on reverse side)
County: Coffey

Lease Name: BEARD Well #: 12-27
Field Name: NEOSHO FALLS-LEROY
Is this a Prorated / Spaced Field? Yes No
Target Formation(s): LOWER SQUIRREL

Nearest Lease or unit boundary line (in footage): 1900
Ground Surface Elevation: 988 feet MSL
Water well within one-quarter mile: Yes No
Public water supply well within one mile: Yes No
Depth to bottom of fresh water: 100
Depth to bottom of usable water: 200
Surface Pipe by Alternate: I II
Length of Surface Pipe Planned to be set: 40
Length of Conductor Pipe (if any): _____
Projected Total Depth: 1100
Formation at Total Depth: LOWER SQUIRREL

Water Source for Drilling Operations:
 Well Farm Pond Other: _____
DWR Permit #: _____
(Note: Apply for Permit with DWR)
Will Cores be taken? Yes No
If Yes, proposed zone: LOWER SQUIRREL

AFFIDAVIT

RECEIVED
KANSAS CORPORATION COMMISSION

The undersigned hereby affirms that the drilling, completion and eventual plugging of this well will comply with K.S.A. 55 et. seq.
It is agreed that the following minimum requirements will be met:

1. Notify the appropriate district office **prior** to spudding of well;
2. A copy of the approved notice of intent to drill **shall be** posted on each drilling rig;
3. The minimum amount of surface pipe as specified below **shall be set** by circulating cement to the top; in all cases surface pipe **shall be set** through all unconsolidated materials plus a minimum of 20 feet into the underlying formation.
4. If the well is dry hole, an agreement between the operator and the district office on plug length and placement is necessary **prior to plugging**;
5. The appropriate district office will be notified before well is either plugged or production casing is cemented in;
6. If an ALTERNATE II COMPLETION, production pipe shall be cemented from below any usable water to surface within **120 DAYS** of spud date. Or pursuant to Appendix "B" - Eastern Kansas surface casing order #133,891-C, which applies to the KCC District 3 area, alternate II cementing must be completed within 30 days of the spud date or the well shall be plugged. **In all cases, NOTIFY district office** prior to any cementing.

I hereby certify that the statements made herein are true and to the best of my knowledge and belief.

Date: 9-13-07 Signature of Operator or Agent: Shirley Stotler Title: Production Clerk

For KCC Use ONLY
API # 15 - 031-22328-0000
Conductor pipe required 0 feet
Minimum surface pipe required 40 feet per ALT. I II
Approved by: Kum 9-18-07
This authorization expires: 3-18-08
(This authorization void if drilling not started within 6 months of approval date.)
Spud date: _____ Agent: _____

Remember to:

- File Drill Pit Application (form CDP-1) with Intent to Drill;
- File Completion Form ACO-1 within 120 days of spud date;
- File acreage attribution plat according to field proration orders;
- Notify appropriate district office 48 hours prior to workover or re-entry;
- Submit plugging report (CP-4) after plugging is completed (within 60 days);
- Obtain written approval before disposing or injecting salt water.
- If this permit has expired (See: authorized expiration date) please check the box below and return to the address below.

Well Not Drilled - Permit Expired Date: _____
Signature of Operator or Agent: _____

12
23
16
 E
 W



1012122

IN ALL CASES PLOT THE INTENDED WELL ON THE PLAT BELOW

Plat of acreage attributable to a well in a prorated or spaced field

If the intended well is in a prorated or spaced field, please fully complete this side of the form. If the intended well is in a prorated or spaced field complete the plat below showing that the well will be properly located in relationship to other wells producing from the common source of supply. Please show all the wells and within 1 mile of the boundaries of the proposed acreage attribution unit for gas wells and within 1/2 mile of the boundaries of the proposed acreage attribution unit for oil wells.

API No. 15 - 031-22328-0000

Operator: Colt Energy Inc

Lease: BEARD

Well Number: 12-27

Field: NEOSHO FALLS-LEROY

Number of Acres attributable to well: _____

QTR/QTR/QTR/QTR of acreage: NE - SW - SE - NW

Location of Well: County: Coffey

1,980 feet from N / S Line of Section

1,900 feet from E / W Line of Section

Sec. 12 Twp. 23 S. R. 16 E W

Is Section: Regular or Irregular

If Section is Irregular, locate well from nearest corner boundary.

Section corner used: NE NW SE SW

PLAT

*(Show location of the well and shade attributable acreage for prorated or spaced wells.)
(Show footage to the nearest lease or unit boundary line.)*

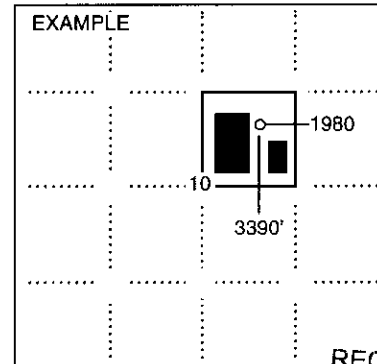
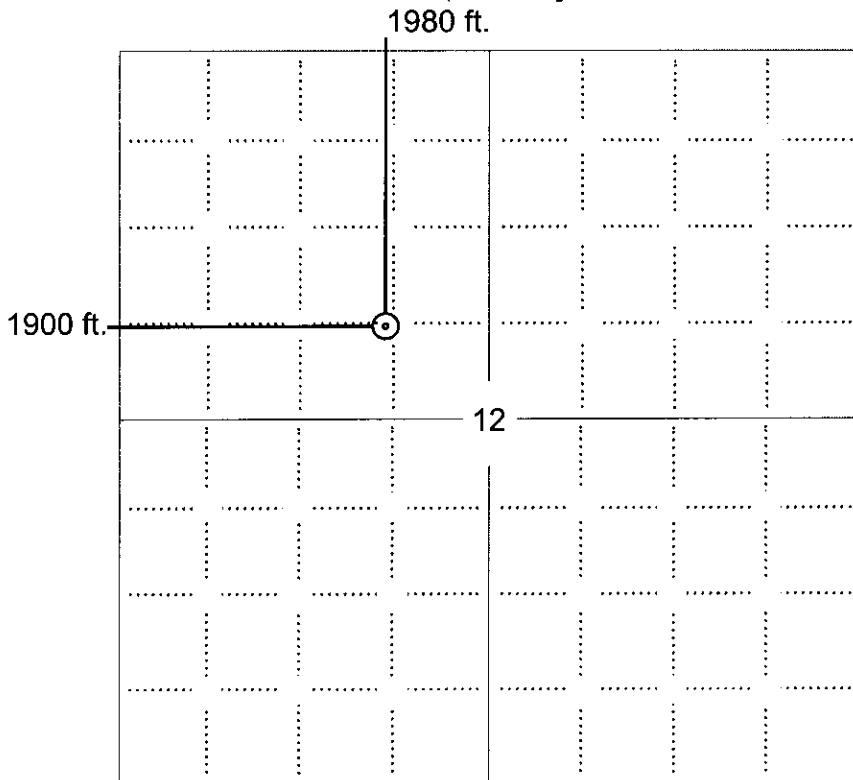

RECEIVED
SEWARD CO. KANSAS CORPORATION COMMISSION

SEP 17 2007

CONSERVATION DIVISION
WICHITA, KS

In plotting the proposed location of the well, you must show:

1. The manner in which you are using the depicted plat by identifying section lines, i.e. 1 section, 1 section with 8 surrounding sections, 4 sections, etc.
2. The distance of the proposed drilling location from the south / north and east / west outside section lines.
3. The distance to the nearest lease or unit boundary line (in footage).
4. If proposed location is located within a prorated or spaced field a certificate of acreage attribution plat must be attached: (CO-7 for oil wells; CG-8 for gas wells).



KANSAS CORPORATION COMMISSION 1012122
OIL & GAS CONSERVATION DIVISION

Form CDP-1
April 2004
Form must be Typed

APPLICATION FOR SURFACE PIT

Submit in Duplicate

Operator Name: Colt Energy Inc		License Number: 5150	
Operator Address: PO BOX 388		IOLA KS 66749	
Contact Person: DENNIS KERSHNER		Phone Number: 620-365-3111	
Lease Name & Well No.: BEARD 12-27		Pit Location (QQQQ): NE SW SE NW Sec. <u>12</u> Twp. <u>23</u> R. <u>16</u> <input checked="" type="checkbox"/> East <input type="checkbox"/> West <u>1,980</u> Feet from <input checked="" type="checkbox"/> North / <input type="checkbox"/> South Line of Section <u>1,900</u> Feet from <input type="checkbox"/> East / <input checked="" type="checkbox"/> West Line of Section Coffey County	
Type of Pit: <input type="checkbox"/> Emergency Pit <input type="checkbox"/> Burn Pit <input type="checkbox"/> Settling Pit <input checked="" type="checkbox"/> Drilling Pit <input type="checkbox"/> Workover Pit <input type="checkbox"/> Haul-Off Pit <small>(If WP Supply API No. or Year Drilled)</small>	Pit is: <input checked="" type="checkbox"/> Proposed <input type="checkbox"/> Existing If Existing, date constructed: _____ Pit capacity: 80 (bbls)		
Is the pit located in a Sensitive Ground Water Area? <input checked="" type="checkbox"/> Yes <input type="checkbox"/> No		Chloride concentration: _____ mg/l <small>(For Emergency Pits and Settling Pits only)</small>	
Is the bottom below ground level? <input checked="" type="checkbox"/> Yes <input type="checkbox"/> No		Artificial Liner? <input type="checkbox"/> Yes <input checked="" type="checkbox"/> No	
		How is the pit lined if a plastic liner is not used? NATIVE CLAY SOIL	
Pit dimensions (all but working pits): <u>30</u> Length (feet) <u>15</u> Width (feet) <input type="checkbox"/> N/A: Steel Pits Depth from ground level to deepest point: <u>5</u> (feet) <input type="checkbox"/> No Pit			
If the pit is lined give a brief description of the liner material, thickness and installation procedure.		Describe procedures for periodic maintenance and determining liner integrity, including any special monitoring.	
Distance to nearest water well within one-mile of pit <u>N/A</u> feet Depth of water well _____ feet		Depth to shallowest fresh water _____ feet. Source of information: <input type="checkbox"/> measured <input type="checkbox"/> well owner <input type="checkbox"/> electric log <input checked="" type="checkbox"/> KDWR	
Emergency, Settling and Burn Pits ONLY: Producing Formation: _____ Number of producing wells on lease: _____ Barrels of fluid produced daily: _____ Does the slope from the tank battery allow all spilled fluids to flow into the pit? <input type="checkbox"/> Yes <input type="checkbox"/> No		Drilling, Workover and Haul-Off Pits ONLY: Type of material utilized in drilling/workover: NATIVE SOIL Number of working pits to be utilized: <u>1</u> Abandonment procedure: PUMP FLUID OUT - PUSH PIT IN Drill pits must be closed within 365 days of spud date.	
I hereby certify that the above statements are true and correct to the best of my knowledge and belief.		RECEIVED KANSAS CORPORATION COMMISSION	
<u>9-13-07</u> Date		<u>Smiley Stotler</u> Signature of Applicant or Agent	
		SEP 17 2007 CONSERVATION DIVISION WICHITA KS	

15-031-22328-0000

KCC OFFICE USE ONLY

Steel Pit RFAC RFAS

Date Received: 9/17/07 Permit Number: _____ Permit Date: 9/17/07 Lease Inspection: Yes No

Mail to: KCC - Conservation Division, 130 S. Market - Room 2078, Wichita, Kansas 67202