

For KCC Use: Effective Date: 8-27-07 District # SGA? Yes No

KANSAS CORPORATION COMMISSION OIL & GAS CONSERVATION DIVISION

CORRECTED 7-14-07

Form must be Typed Form must be Signed All blanks must be Filled

NOTICE OF INTENT TO DRILL

Must be approved by KCC five (5) days prior to commencing well

Expected Spud Date August 28, 2007 month day year

OPERATOR: License# 33344 Name: Quest Cherokee LLC Address: 9520 North May Avenue, Suite 300 City/State/Zip: Oklahoma City, Oklahoma 73120 Contact Person: Richard Marlin Phone: (405) 463-6880

CONTRACTOR: License# Will be licensed by the KCC Name: Will advise on the ACO-1

Well Drilled For: Oil Gas OWWO Seismic Other Coalbed Methane Well Class: Enh Rec Storage Disposal Infield Pool Ext Wildcat Other Type Equipment: Mud Rotary Air Rotary Cable

If OWWO: old well information as follows: Operator: Well Name: Original Completion Date: Original Total Depth:

Directional, Deviated or Horizontal wellbore? Yes No

If Yes, true vertical depth: Bottom Hole Location: KCC DKT #:

* WAS: NE-SE 1980' FSL, 525' FEL IS: NE-SW-SE 1035' FSL, 1515' FEL

Spot NE NE SE Sec. 30 Twp. 28 S. R. 19 East West 1980 1035 feet from N S Line of Section 525 1515 feet from E W Line of Section Is SECTION Regular Irregular?

(Note: Locate well on the Section Plat on reverse side)

County: Neosho

Lease Name: Neely, William G. Well #: 30-2

Field Name: Cherokee Basin CBM

Is this a Prorated / Spaced Field? Yes No

Target Formation(s): Cherokee Coals

Nearest Lease or unit boundary: 525

Ground Surface Elevation: 944 feet MSL

Water well within one-quarter mile: Yes No

Public water supply well within one mile: Yes No

Depth to bottom of fresh water: 100

Depth to bottom of usable water: 150

Surface Pipe by Alternate: 1 2

Length of Surface Pipe Planned to be set: 25

Length of Conductor Pipe required:

Projected Total Depth: 1300

Formation at Total Depth: Cherokee Coals

Water Source for Drilling Operations: Well Farm Pond Other Air

DWR Permit #:

(Note: Apply for Permit with DWR)

Will Cores be taken? Yes No

If Yes, proposed zone:

AFFIDAVIT

RECEIVED KANSAS CORPORATION COMMISSION WICHITA, KS

The undersigned hereby affirms that the drilling, completion and eventual plugging of this well will comply with K.S.A. 55 et. seq. It is agreed that the following minimum requirements will be met:

SEP 17 2007

AUG 22 2007

- 1. Notify the appropriate district office prior to spudding of well; 2. A copy of the approved notice of intent to drill shall be posted on each drilling rig; 3. The minimum amount of surface pipe as specified below shall be set by circulating cement to the top of all cases surface pipe shall be set through all unconsolidated materials plus a minimum of 20 feet into the underlying formation. 4. If the well is dry hole, an agreement between the operator and the district office on plug length and placement is necessary prior to plugging; 5. The appropriate district office will be notified before well is either plugged or production casing is cemented in; 6. If an ALTERNATE II COMPLETION, production pipe shall be cemented from below any usable water to surface within 120 days of spud date. Or pursuant to Appendix "B" - Eastern Kansas surface casing order #133,891-C, which applies to the KCC District 3 area, alternate II cementing must be completed within 30 days of the spud date or the well shall be plugged. In all cases, NOTIFY district office prior to any cementing.

I hereby certify that the statements made herein are true and to the best of my knowledge and belief.

Date: August 21, 2007 Signature of Operator or Agent: Richard Marlin Title: VP

For KCC Use ONLY API # 15 - 133-27139-0000 Conductor pipe required None feet Minimum surface pipe required 20 feet per Alt. Approved by: 8-22-07 / RMM 98-07 This authorization expires: 2-22-08 (This authorization void if drilling not started within 6 months of approval date.) Spud date: Agent:

- Remember to: File Drill Pit Application (form CDP-1) with Intent to Drill; File Completion Form ACO-1 within 120 days of spud date; File acreage attribution plat according to field proration orders; Notify appropriate district office 48 hours prior to workover or re-entry; Submit plugging report (CP-4) after plugging is completed; Obtain written approval before disposing or injecting salt water. If this permit has expired (See: authorized expiration date) please check the box below and return to the address below. Well Not Drilled - Permit Expired Signature of Operator or Agent: Date:

30 28 19E

CORRECTED

IN ALL CASES PLOT THE INTENDED WELL ON THE PLAT BELOW

Plat of acreage attributable to a well in a prorated or spaced field

If the intended well is in a prorated or spaced field, please fully complete this side of the form. If the intended well is in a prorated or spaced field complete the plat below showing that the well will be properly located in relationship to other wells producing from the common source of supply. Please show all the wells and within 1 mile of the boundaries of the proposed acreage attribution unit for gas wells and within 1/2 mile of the boundaries of the proposed acreage attribution unit for oil wells.

API No. 15 - 133-27139-0000
 Operator: Quest Cherokee LLC
 Lease: Neely, William G.
 Well Number: 30-2
 Field: Cherokee Basin CBM
 Number of Acres attributable to well: _____
 QTR / QTR / QTR of acreage: _____ NE _____ SE

Location of Well: County: Neosho
 1980 1035 feet from N / S Line of Section
 525 1515 feet from E / W Line of Section
 Sec. 30 Twp. 28 S. R. 19 East West
 Is Section: Regular or Irregular
 If Section is Irregular, locate well from nearest corner boundary.
 Section corner used: NE NW SE SW

PLAT

*(Show location of the well and shade attributable acreage for prorated or spaced wells.)
 (Show footage to the nearest lease or unit boundary line.)*

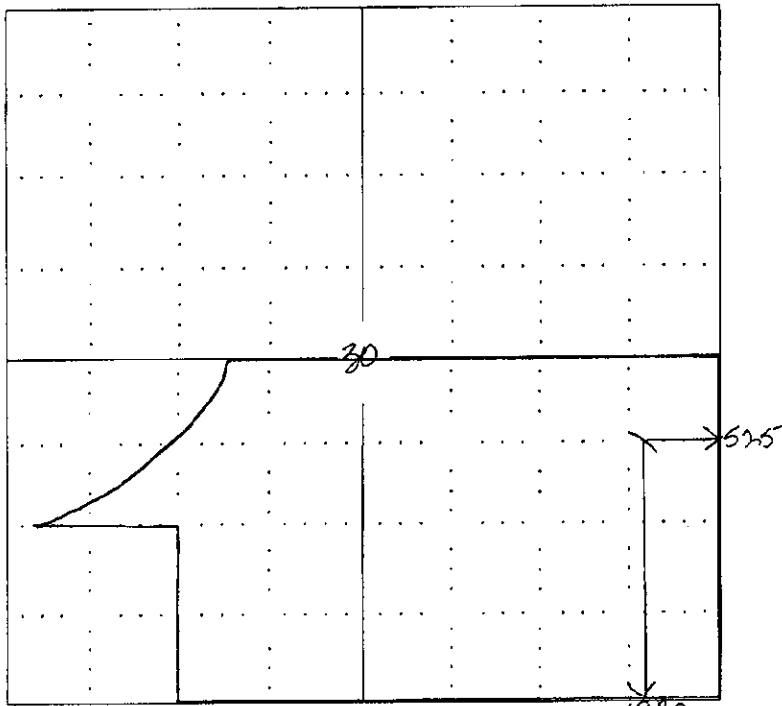

NOTE: In all cases locate the spot of the proposed drilling location.

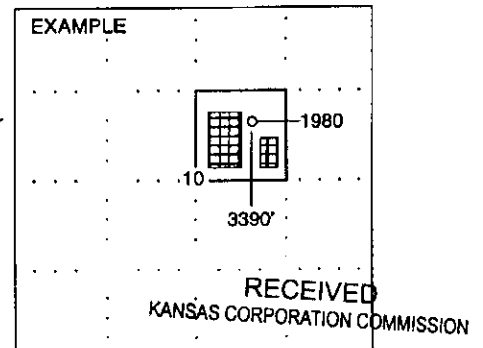

SEWARD CO.

SEP 17 2007

CONSERVATION DIVISION
WICHITA, KS

In plotting the proposed location of the well, you must show:

1. The manner in which you are using the depicted plat by identifying section lines, i.e. 1 section, 1 section with 8 surrounding sections, 4 sections, etc.
2. The distance of the proposed drilling location from the section's south / north and east / west.
3. The distance to the nearest lease or unit boundary line.
4. If proposed location is located within a prorated or spaced field a certificate of acreage attribution plat must be attached: (CD-7 for oil wells; CG-8 for gas wells).

**KANSAS CORPORATION COMMISSION
OIL & GAS CONSERVATION DIVISION
APPLICATION FOR SURFACE PIT**

Form CDP-1
April 2004
Form must be Typed

Submit in Duplicate

Operator Name: Quest Cherokee LLC		License Number: 33344
Operator Address: 9520 North May Avenue, Suite 300 Oklahoma City, Oklahoma 73120		
Contact Person: Richard Marlin		Phone Number: (405) 463 - 6880
Lease Name & Well No.: Neely, William G. #30-2		Pit Location (QQQQ): NE^{SW} SE
Type of Pit: <input type="checkbox"/> Emergency Pit <input type="checkbox"/> Burn Pit <input type="checkbox"/> Settling Pit <input checked="" type="checkbox"/> Drilling Pit <input type="checkbox"/> Workover Pit <input type="checkbox"/> Haul-Off Pit <small>(If WP Supply API No. or Year Drilled)</small>	Pit is: <input checked="" type="checkbox"/> Proposed <input type="checkbox"/> Existing If Existing, date constructed: _____ Pit capacity: 300 (bbls)	Sec. 30 Twp. 28 R. 19 <input checked="" type="checkbox"/> East <input type="checkbox"/> West 1980 1035 Feet from <input type="checkbox"/> North / <input checked="" type="checkbox"/> South Line of Section 525 1515 Feet from <input checked="" type="checkbox"/> East / <input type="checkbox"/> West Line of Section Neosho County
Is the pit located in a Sensitive Ground Water Area? <input checked="" type="checkbox"/> Yes <input checked="" type="checkbox"/> No		Chloride concentration: _____ mg/l <small>(For Emergency Pits and Settling Pits only)</small>
Is the bottom below ground level? <input type="checkbox"/> Yes <input checked="" type="checkbox"/> No	Artificial Liner? <input type="checkbox"/> Yes <input checked="" type="checkbox"/> No	How is the pit lined if a plastic liner is not used?
Pit dimensions (all but working pits): 30 Length (feet) 10 Width (feet) _____ N/A: Steel Pits Depth from ground level to deepest point: 10 (feet)		
If the pit is lined give a brief description of the liner material, thickness and installation procedure.		Describe procedures for periodic maintenance and determining liner integrity, including any special monitoring. Air Drilling Operation lasting approx 3 days
Distance to nearest water well within one-mile of pit N/A feet Depth of water well _____ feet		Depth to shallowest fresh water _____ feet. Source of information: _____ measured _____ well owner _____ electric log _____ KDWR
Emergency, Settling and Burn Pits ONLY: Producing Formation: _____ Number of producing wells on lease: _____ Barrels of fluid produced daily: _____ Does the slope from the tank battery allow all spilled fluids to flow into the pit? <input type="checkbox"/> Yes <input type="checkbox"/> No		Drilling, Workover and Haul-Off Pits ONLY: Type of material utilized in drilling/workover: Air Drilled Number of working pits to be utilized: One Abandonment procedure: Air Dry, Back Fill and Cover Drill pits must be closed within 365 days of spud date
I hereby certify that the above statements are true and correct to the best of my knowledge and belief.		RECEIVED KANSAS CORPORATION COMMISSION AUG 22 2007 CONSERVATION DIVISION WICHITA, KS
_____ August 21, 2007 Date	<i>Richard Marlin</i> Signature of Applicant or Agent	SEP 17 2007 RECEIVED KANSAS CORPORATION COMMISSION WICHITA, KS
KCC OFFICE USE ONLY		
Date Received: 8/22/07	Permit Number: _____	Permit Date: 8/22/07 Lease Inspection: <input type="checkbox"/> Yes <input checked="" type="checkbox"/> No

CORRECTED

15-133-27139-0000

Mail to: KCC - Conservation Division, 130 S. Market - Room 2078, Wichita, Kansas 67202