

For KCC Use: Effective Date: 9-26-07
District # 4
SGA? Yes No

KANSAS CORPORATION COMMISSION
OIL & GAS CONSERVATION DIVISION

NOTICE OF INTENT TO DRILL

Must be approved by KCC five (5) days prior to commencing well

Form C-1
December 2002
Form must be Typed
Form must be Signed
All blanks must be Filled

Expected Spud Date October 10, 2007
month day year

OPERATOR: License# 6931
Name: Bowman Oil Company
Address: 805 Codell Road
City/State/Zip: Codell, Kansas 67663
Contact Person: Louis "Don" Bowman
Phone: 785-434-2286 M-F 7-12 AM

CONTRACTOR: License# 33237
Name: Anderson Drilling Company

Well Drilled For:	Well Class:	Type Equipment:
<input checked="" type="checkbox"/> Oil	<input type="checkbox"/> Enh Rec	<input checked="" type="checkbox"/> Infield
<input type="checkbox"/> Gas	<input type="checkbox"/> Storage	<input type="checkbox"/> Pool Ext.
<input type="checkbox"/> OWWO	<input type="checkbox"/> Disposal	<input type="checkbox"/> Wildcat
<input type="checkbox"/> Seismic: # of Holes	<input type="checkbox"/> Other	<input checked="" type="checkbox"/> Mud Rotary
<input type="checkbox"/> Other		<input type="checkbox"/> Air Rotary
		<input type="checkbox"/> Cable

If OWWO: old well information as follows:
Operator: N/A
Well Name: _____
Original Completion Date: _____ Original Total Depth: _____
Directional, Deviated or Horizontal wellbore? Yes No
If Yes, true vertical depth: N/A
Bottom Hole Location: _____
KCC DKT #: _____

Spot East
SE SW SE/4 Sec. 31 Twp. 6S S. R. 20 West
520 feet from N / S Line of Section
1773 feet from E / W Line of Section

Is SECTION Regular Irregular?
(Note: Locate well on the Section Plat on reverse side)

County: Rooks County, Kansas
Lease Name: Lunney/Schuck SE Well #: 1

Field Name: _____
Is this a Prorated / Spaced Field? Yes No

Target Formation(s): Arbuckle
Nearest Lease or unit boundary: 520' FSL

Ground Surface Elevation: estimated 2249' feet MSL
Water well within one-quarter mile: Yes No

Public water supply well within one mile: Yes No
Depth to bottom of fresh water: 180'

Depth to bottom of usable water: 200' / 1100'

Surface Pipe by Alternate: 1 2
Length of Surface Pipe Planned to be set: 200'

Length of Conductor Pipe required: N/A
Projected Total Depth: Approximately 3600'

Formation at Total Depth: Arbuckle
Water Source for Drilling Operations:
 Well Farm Pond Other

DWR Permit #: _____
(Note: Apply for Permit with DWR)

Will Cores be taken? Yes No
If Yes, proposed zone: N/A

AFFIDAVIT

The undersigned hereby affirms that the drilling, completion and eventual plugging of this well will comply with K.S.A. 55 et. seq.

It is agreed that the following minimum requirements will be met:

1. Notify the appropriate district office **prior** to spudding of well;
2. A copy of the approved notice of intent to drill **shall be** posted on each drilling rig;
3. The minimum amount of surface pipe as specified below **shall be set** by circulating cement to the top; in all cases surface pipe **shall be set** through all unconsolidated materials plus a minimum of 20 feet into the underlying formation.
4. If the well is dry hole, an agreement between the operator and the district office on plug length and placement is necessary **prior to plugging**;
5. The appropriate district office will be notified before well is either plugged or production casing is cemented in;
6. If an ALTERNATE II COMPLETION, production pipe shall be cemented from below any usable water to surface within **120 days** of spud date.
Or pursuant to Appendix "B" - Eastern Kansas surface casing order #133,891-C, which applies to the KCC District 3 area, alternate II cementing must be completed within 30 days of the spud date or the well shall be plugged. **In all cases, NOTIFY district office** prior to any cementing.

I hereby certify that the statements made herein are true and to the best of my knowledge and belief.

Date: September 19, 2007 Signature of Operator or Agent Connie J. Austin Title: Agent

For KCC Use ONLY
API # 15 - 163-23650-0000
Conductor pipe required None feet
Minimum surface pipe required 200 feet per Alt. XO 2
Approved by: LMA 9-21-07
This authorization expires: 3-21-08
(This authorization void if drilling not started within 6 months of approval date.)
Spud date: _____ Agent: _____

Remember to:

- File Drill Pit Application (form CDP-1) with Intent to Drill;
- File Completion Form ACO-1 within 120 days of spud date;
- File acreage attribution plat according to field proration orders;
- Notify appropriate district office 48 hours prior to workover or re-entry;
- Submit plugging report (CP-4) after plugging is completed;
- Obtain written approval before disposing or injecting salt water.

- If this permit has expired (See: authorized expiration date) please check the box below and return to the address below.

Well Not Drilled - Permit Expired

Signature of Operator or Agent: _____ RECEIVED
Date: _____ KANSAS CORPORATION COMMISSION

Mail to: KCC - Conservation Division, 130 S. Market - Room 2078, Wichita, Kansas 67202

SEP 21 2007

CONSERVATION DIVISION
WICHITA KS

IN ALL CASES PLOT THE INTENDED WELL ON THE PLAT BELOW

Plat of acreage attributable to a well in a prorated or spaced field

If the intended well is in a prorated or spaced field, please fully complete this side of the form. If the intended well is in a prorated or spaced field complete the plat below showing that the well will be properly located in relationship to other wells producing from the common source of supply. Please show all the wells and within 1 mile of the boundaries of the proposed acreage attribution unit for gas wells and within 1/2 mile of the boundaries of the proposed acreage attribution unit for oil wells.

API No. 15 - 103-23650-0000
Operator: Bowman Oil Company
Lease: Lunney/Schuck SE
Well Number: 1
Field: _____
Number of Acres attributable to well: _____
QTR / QTR / QTR of acreage: SE - SW - SE/4

Location of Well: County: Rooks County, Kansas
520 feet from N / S Line of Section
1773 feet from E / W Line of Section
Sec. 31 Twp. 6S S. R. 20 East West
Is Section: Regular or Irregular
If Section is Irregular, locate well from nearest corner boundary.
Section corner used: NE NW SE SW

PLAT

*(Show location of the well and shade attributable acreage for prorated or spaced wells.)
(Show footage to the nearest lease or unit boundary line.)*

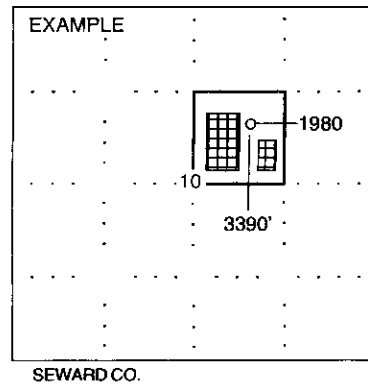
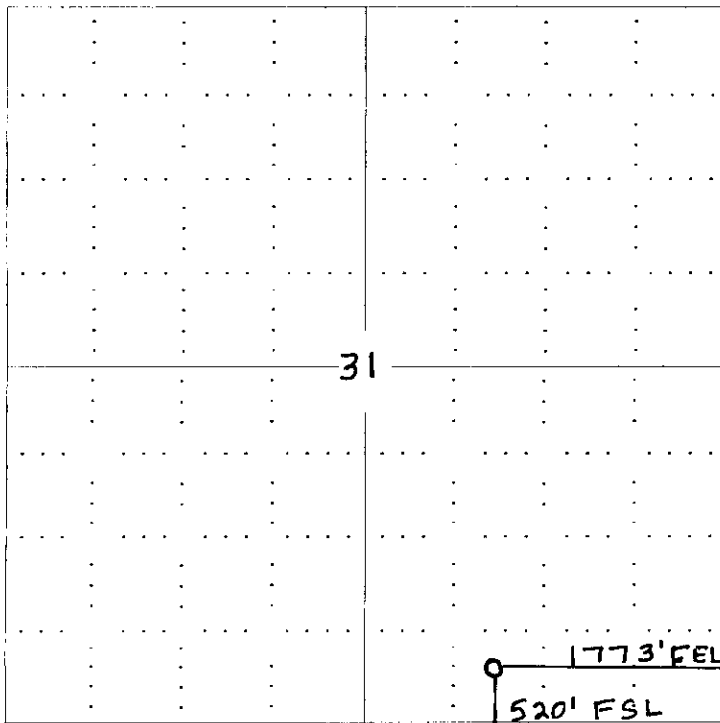

NOTE: In all cases locate the spot of the proposed drilling location.

In plotting the proposed location of the well, you must show:

1. The manner in which you are using the depicted plat by identifying section lines, i.e. 1 section, 1 section with 8 surrounding sections, 4 sections, etc.
2. The distance of the proposed drilling location from the section's south / north and east / west.
3. The distance to the nearest lease or unit boundary line.
4. If proposed location is located within a prorated or spaced field a certificate of acreage attribution plat must be attached: (CG-8 for gas wells).

RECEIVED
KANSAS CORPORATION COMMISSION
SEP 21 2007
CONSERVATION DIVISION
TOPEKA, KS

**KANSAS CORPORATION COMMISSION
OIL & GAS CONSERVATION DIVISION
APPLICATION FOR SURFACE PIT**

Form CDP-1
April 2004
Form must be Typed

Submit in Duplicate

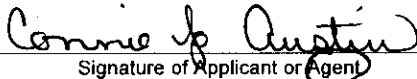
Operator Name: Bowman Oil Company		License Number: 6931
Operator Address: 805 Codell Road Codell, Kansas 67663		
Contact Person: Louis "Don" Bowman		Phone Number: (785) 434 - 2286 M-F 7-12 AM
Lease Name & Well No.: Lunney/Schuck SE #1		Pit Location (QQQQ): _____ SE _____ SW _____ SE/4
Type of Pit: <input type="checkbox"/> Emergency Pit <input type="checkbox"/> Burn Pit <input type="checkbox"/> Settling Pit <input checked="" type="checkbox"/> Drilling Pit <input type="checkbox"/> Workover Pit <input type="checkbox"/> Haul-Off Pit <small>(If WP Supply API No. or Year Drilled)</small>	Pit is: <input checked="" type="checkbox"/> Proposed <input type="checkbox"/> Existing If Existing, date constructed: _____ Pit capacity: 500 (bbls)	Sec. 31 Twp. 6S R. 20 <input type="checkbox"/> East <input checked="" type="checkbox"/> West 520 Feet from <input type="checkbox"/> North / <input checked="" type="checkbox"/> South Line of Section 1773 Feet from <input checked="" type="checkbox"/> East / <input type="checkbox"/> West Line of Section Rooks County, Kansas _____ County
Is the pit located in a Sensitive Ground Water Area? <input type="checkbox"/> Yes <input checked="" type="checkbox"/> No		Chloride concentration: <u>less than 500</u> mg/l <small>(For Emergency Pits and Settling Pits only)</small>
Is the bottom below ground level? <input checked="" type="checkbox"/> Yes <input type="checkbox"/> No	Artificial Liner? <input checked="" type="checkbox"/> Yes <input type="checkbox"/> No	How is the pit lined if a plastic liner is not used?
Pit dimensions (all but working pits): <u>40</u> Length (feet) <u>12</u> Width (feet) _____ N/A: Steel Pits Depth from ground level to deepest point: <u>6</u> (feet)		
If the pit is lined give a brief description of the liner material, thickness and installation procedure. Standard Black Plastic		Describe procedures for periodic maintenance and determining liner integrity, including any special monitoring. Daily Visual Inspection
Distance to nearest water well within one-mile of pit <u>approx. 4600</u> feet Depth of water well <u>42</u> feet		Depth to shallowest fresh water <u>unknown</u> feet. Source of information: _____ measured _____ well owner _____ electric log _____ KDWR
Emergency, Settling and Burn Pits ONLY: Producing Formation: _____ Number of producing wells on lease: _____ Barrels of fluid produced daily: _____ Does the slope from the tank battery allow all spilled fluids to flow into the pit? <input type="checkbox"/> Yes <input type="checkbox"/> No		Drilling, Workover and Haul-Off Pits ONLY: Type of material utilized in drilling/workover: <u>Rotary Mud</u> Number of working pits to be utilized: <u>3</u> Abandonment procedure: <u>Waste will be transferred, Pit will be allowed to Air Dry, then Pit will be filled back to Ground Level</u> Drill pits must be closed within 365 days of spud date.
I hereby certify that the above statements are true and correct to the best of my knowledge and belief.		
September 19, 2007 Date		 Signature of Applicant or Agent

15-163-23650-0000

KCC OFFICE USE ONLY			
Date Received: <u>9/21/07</u>	Permit Number: _____	Permit Date: <u>9/21/07</u>	Lease Inspection: <input type="checkbox"/> Yes <input checked="" type="checkbox"/> No

Mail to: KCC - Conservation Division, 130 S. Market - Room 2078, Wichita, Kansas 67202

RECEIVED
KANSAS CORPORATION COMMISSION

SEP 21 2007

CONSERVATION DIVISION
WICHITA, KS