

For KCC Use: 9-2907
 Effective Date: 3
 District #: 3
 SGA? Yes No

KANSAS CORPORATION COMMISSION
 OIL & GAS CONSERVATION DIVISION
NOTICE OF INTENT TO DRILL

Form C-1
 December 2002
Form must be Typed
Form must be Signed
All blanks must be Filled

Must be approved by KCC five (5) days prior to commencing well

Expected Spud Date October 1, 2007
month day year

OPERATOR: License# 33074 ✓
 Name: Dart Cherokee Basin Operating Co. LLC
 Address: 211 W. Myrtle
 City/State/Zip: Independence KS 67301
 Contact Person: Tony Williams
 Phone: 620-331-7870

CONTRACTOR: License# 5675 ✓
 Name: McPherson Drilling

Well Drilled For:	Well Class:	Type Equipment:
<input type="checkbox"/> Oil	<input type="checkbox"/> Enh Rec	<input type="checkbox"/> Infield
<input checked="" type="checkbox"/> Gas	<input type="checkbox"/> Storage	<input checked="" type="checkbox"/> Pool Ext.
<input type="checkbox"/> OWO	<input type="checkbox"/> Disposal	<input type="checkbox"/> Wildcat
<input type="checkbox"/> Seismic; # of Holes	<input type="checkbox"/> Other	<input type="checkbox"/> Mud Rotary
<input type="checkbox"/> Other		<input checked="" type="checkbox"/> Air Rotary
		<input type="checkbox"/> Cable

If OWWO: old well information as follows:
 Operator: _____
 Well Name: _____
 Original Completion Date: _____ Original Total Depth: _____

Directional, Deviated or Horizontal wellbore? Yes No

If Yes, true vertical depth: _____

Bottom Hole Location: _____

KCC DKT #: _____

Spot East
 SW SE NE Sec. 25 Twp. 29 S. R. 15 West
3050 FSL feet from N / S Line of Section
860 FEL feet from E / W Line of Section
 Is SECTION Regular Irregular?

(Note: Locate well on the Section Plat on reverse side)

County: Wilson
 Lease Name: Frankenberry Well #: B4-25
 Field Name: Cherokee Basin Coal Gas Area

Is this a Prorated / Spaced Field? Yes No

Target Information(s): Mississippian

Nearest Lease or unit boundary: 410 Feet

Ground Surface Elevation: 946 feet MSL

Water well within one-quarter mile: Yes No

Public water supply well within one mile: Yes No

Depth to bottom of fresh water: 150

Depth to bottom of usable water: 200 150

Surface Pipe by Alternate: 1 2

Length of Surface Pipe Planned to be set: 40'

Length of Conductor Pipe required: _____

Projected Total Depth: 1536

Formation at Total Depth: Mississippian

Water Source for Drilling Operations:

Well Farm Pond Other

DWR Permit #: _____

(Note: Apply for Permit with DWR)

Will Cores be taken? Yes No

If Yes, proposed zone: _____

AFFIDAVIT

The undersigned hereby affirms that the drilling, completion and eventual plugging of this well will comply with K.S.A. 55 et. seq.

It is agreed that the following minimum requirements will be met:

1. Notify the appropriate district office **prior** to spudding of well;
2. A copy of the approved notice of intent to drill **shall be** posted on each drilling rig;
3. The minimum amount of surface pipe as specified below **shall be set** by circulating cement to the top; in all cases surface pipe ~~shall be set~~ through all unconsolidated materials plus a minimum of 20 feet into the underlying formation.
4. If the well is dry hole, an agreement between the operator and the district office on plug length and placement is necessary **prior to plugging**;
5. The appropriate district office will be notified before well is either plugged or production casing is cemented in;
6. If an ALTERNATE II COMPLETION, production pipe shall be cemented from below any usable water to surface within **120 days** of spud date. Or pursuant to Appendix "B" - Eastern Kansas surface casing order #133,891-C, which applies to the KCC District 3 area, alternate II cementing must be completed within 30 days of the spud date or the well shall be plugged. **In all cases, NOTIFY district office** prior to any cementing.

I hereby certify that the statements made herein are true and to the best of my knowledge and belief.

Date: September 21, 2007 Signature of Operator or Agent: Tony Williams Title: Safety & Environmental Manager

RECEIVED
 KANSAS CORPORATION COMMISSION

SEP 24 2007

CONSERVATION DIVISION

Remember to:

- File Drill Pit Application (form CDP-1) with Intent to Drill;
- File Completion Form ACO-1 within 120 days of spud date;
- File acreage attribution plat according to field proration orders;
- Notify appropriate district office 48 hours prior to workover or re-entry;
- Submit plugging report (CP-4) after plugging is completed;
- Obtain written approval before disposing or injecting salt water.
- If this permit has expired (See: authorized expiration date) please check the box below and return to the address below.

Well Not Drilled - Permit Expired

Signature of Operator or Agent: _____

Date: _____

25
29
15E

For KCC Use ONLY
 API # 15 - 205-27308-0000
 Conductor pipe required None feet
 Minimum surface pipe required 20 feet per Alt. 102
 Approved by: 9-24-07
 This authorization expires: 3-24-08
 (This authorization void if drilling not started within 6 months of effective date.)
 Spud date: _____ Agent: _____

Mail to: KCC - Conservation Division, 130 S. Market - Room 2078, Wichita, Kansas 67202

IN ALL CASES PLOT THE INTENDED WELL ON THE PLAT BELOW

Plat of acreage attributable to a well in a prorated or spaced field

If the intended well is in a prorated or spaced field, please fully complete this side of the form. If the intended well is in a prorated or spaced field complete the plat below showing that the well will be properly located in relationship to other wells producing from the common source of supply. Please show all the wells and within 1 mile of the boundaries of the proposed acreage attribution unit for gas wells and within 1/2 mile of the boundaries of the proposed acreage attribution unit for oil wells.

API No. 15 - 205-27308-0000
 Operator: Dart Cherokee Basin Operating Co. LLC
 Lease: Frankenberry
 Well Number: B4-25
 Field: Cherokee Basin Coal Gas Area
 Number of Acres attributable to well: 40
 QTR / QTR / QTR of acreage: SW - SE - NE

Location of Well: County: Wilson
 3050 FSL _____ feet from N / S Line of Section
 860 FEL _____ feet from E / W Line of Section
 Sec. 25 Twp. 29 S. R. 15 East West

Is Section: Regular or Irregular

If Section is Irregular, locate well from nearest corner boundary.

Section corner used: NE NW SE SW

PLAT

(Show location of the well and shade attributable acreage for prorated or spaced wells.)

(Show footage to the nearest lease or unit boundary line.)

T29S

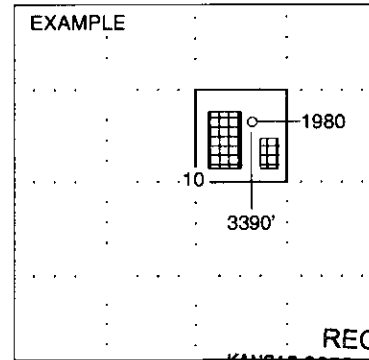
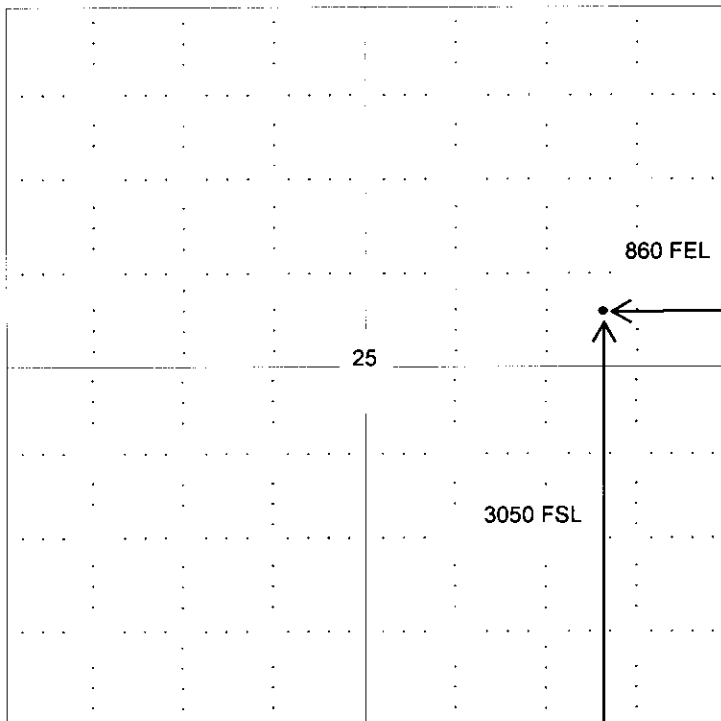

NOTE: in all cases locate the spot of the proposed drilling location.

Wilson Co.

RECEIVED
 KANSAS CORPORATION COMMISSION

SEP 24 2007

In plotting the proposed location of the well, you must show:

1. The manner in which you are using the depicted plat by identifying section lines, i.e. 1 section, 1 section with 8 surrounding sections, 4 sections, etc.
2. The distance of the proposed drilling location from the section's south / north and east / west.
3. The distance to the nearest lease or unit boundary line.
4. If proposed location is located within a prorated or spaced field a certificate of acreage attribution plat must be attached: (CO-7 for oil wells; CG-8 for gas wells).

CONSERVATION DIVISION
 WICHITA, KS

**KANSAS CORPORATION COMMISSION
OIL & GAS CONSERVATION DIVISION
APPLICATION FOR SURFACE PIT**

Form CDP-1
April 2004
Form must be Typed

Submit in Duplicate

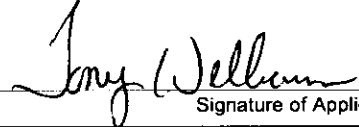
Operator Name: Dart Cherokee Basin Operating Co. LLC		License Number: 33074
Operator Address: 211 W. Myrtle		Independence KS 67301
Contact Person: Tony Williams		Phone Number: (620) 331 -7870
Lease Name & Well No.: Frankenberry B4-25		Pit Location (QQQQ): _____ SW _____ SE _____ NE Sec. 25 Twp. 29 R. 15 <input checked="" type="checkbox"/> East <input type="checkbox"/> West 3050 FSL Feet from <input type="checkbox"/> North / <input checked="" type="checkbox"/> South Line of Section 860 FEL Feet from <input checked="" type="checkbox"/> East / <input type="checkbox"/> West Line of Section Wilson County
Type of Pit: <input type="checkbox"/> Emergency Pit <input type="checkbox"/> Burn Pit <input type="checkbox"/> Settling Pit <input checked="" type="checkbox"/> Drilling Pit <input type="checkbox"/> Workover Pit <input type="checkbox"/> Haul-Off Pit <small>(If WP Supply API No. or Year Drilled)</small>	Pit is: <input checked="" type="checkbox"/> Proposed <input type="checkbox"/> Existing If Existing, date constructed: _____ Pit capacity: 926 (bbls)	
Is the pit located in a Sensitive Ground Water Area? <input checked="" type="checkbox"/> Yes <input checked="" type="checkbox"/> No		Chloride concentration: _____ mg/l <small>(For Emergency Pits and Settling Pits only)</small>
Is the bottom below ground level? <input checked="" type="checkbox"/> Yes <input type="checkbox"/> No	Artificial Liner? <input type="checkbox"/> Yes <input checked="" type="checkbox"/> No	How is the pit lined if a plastic liner is not used? Natural Clays
Pit dimensions (all but working pits): <u>35</u> Length (feet) <u>30</u> Width (feet) N/A: Steel Pits Depth from ground level to deepest point: <u>5</u> (feet)		
If the pit is lined give a brief description of the liner material, thickness and installation procedure.		Describe procedures for periodic maintenance and determining liner integrity, including any special monitoring.
Distance to nearest water well within one-mile of pit <u>N/A</u> feet Depth of water well _____ feet	Depth to shallowest fresh water _____ feet. Source of information: _____ measured _____ well owner _____ electric log _____ KDWR	
Emergency, Settling and Burn Pits ONLY: Producing Formation: _____ Number of producing wells on lease: _____ Barrels of fluid produced daily: _____ Does the slope from the tank battery allow all spilled fluids to flow into the pit? <input type="checkbox"/> Yes <input type="checkbox"/> No	Drilling, Workover and Haul-Off Pits ONLY: Type of material utilized in drilling/workover: <u>Air</u> Number of working pits to be utilized: <u>one</u> Abandonment procedure: <u>Air dry, fill</u> Drill pits must be closed within 365 days of spud date. RECEIVED KANSAS CORPORATION COMMISSION	
I hereby certify that the above statements are true and correct to the best of my knowledge and belief.		
September 21, 2007 Date	 Signature of Applicant or Agent	SEP 24 2007 CONSERVATION DIVISION WICHITA, KS
KCC OFFICE USE ONLY		
Date Received: <u>9/24/07</u> Permit Number: _____	Permit Date: <u>9/24/07</u> Lease Inspection: <input type="checkbox"/> Yes <input checked="" type="checkbox"/> No	

15-205-27308-0000

Mail to: KCC - Conservation Division, 130 S. Market - Room 2078, Wichita, Kansas 67202