



For KCC Use: 9-29-07
 Effective Date: 9-29-07
 District # 1
 SGA? Yes No

KANSAS CORPORATION COMMISSION 1012344
 OIL & GAS CONSERVATION DIVISION

Form C-1
 November 2005
 Form must be Typed
 Form must be Signed
 All blanks must be Filled

NOTICE OF INTENT TO DRILL

Must be approved by KCC five (5) days prior to commencing well

Expected Spud Date: 09/28/2007
month day year

Spot Description: W2 - SE - SW - SW Sec. 18 Twp. 35 S. R. 37 E W
(20/0/0) 330 feet from N / S Line of Section
700 feet from E / W Line of Section

OPERATOR: License# 5278
 Name: EOG Resources, Inc.
 Address 1: 3817 NW EXPRESSWAY STE 500
 Address 2: _____
 City: OKLAHOMA CITY State: OK Zip: 73112 + 1483
 Contact Person: Melissa Sturm
 Phone: 405-246-3132

Is SECTION: Regular Irregular?

(Note: Locate well on the Section Plat on reverse side)

CONTRACTOR: License# 34000
 Name: Kenai Mid-Continent, Inc.

County: Stevens
 Lease Name: Norma Well #: 18 #1
 Field Name: Wildcat

Is this a Prorated / Spaced Field? Yes No
 Target Formation(s): Morrow, Mississippian

Well Drilled For: Well Class: Type Equipment:
 Oil Enh Rec Infield Mud Rotary
 Gas Storage Pool Ext. Air Rotary
 Disposal Wildcat Cable
 Seismic; # of Holes Other
 Other: _____

Nearest Lease or unit boundary line (in footage): 330
 Ground Surface Elevation: 3165 feet MSL

Water well within one-quarter mile: Yes No
 Public water supply well within one mile: Yes No

Depth to bottom of fresh water: 640
 Depth to bottom of usable water: 640

Surface Pipe by Alternate: I II
 Length of Surface Pipe Planned to be set: 1700

Length of Conductor Pipe (if any): 40
 Projected Total Depth: 7050

Formation at Total Depth: Mississippian
 Water Source for Drilling Operations:
 Well Farm Pond Other: _____

DWR Permit #: _____
 (Note: Apply for Permit with DWR)

Will Cores be taken? Yes No

If Yes, proposed zone: _____
 RECEIVED
 KANSAS CORPORATION COMMISSION

If OWWO: old well information as follows:

Operator: _____
 Well Name: _____
 Original Completion Date: _____ Original Total Depth: _____

Directional, Deviated or Horizontal wellbore? Yes No

If Yes, true vertical depth: _____

Bottom Hole Location: _____

KCC DKT #: PVPA 090704

PRORATED & SPACED: HUGOTON-PANOMA

AFFIDAVIT

The undersigned hereby affirms that the drilling, completion and eventual plugging of this well will comply with K.S.A. 55 et. seq. **SEP 24 2007**

It is agreed that the following minimum requirements will be met:

CONSERVATION DIVISION
 WICHITA, KS

1. Notify the appropriate district office **prior** to spudding of well;
2. A copy of the approved notice of intent to drill **shall be** posted on each drilling rig;
3. The minimum amount of surface pipe as specified below **shall be set** by circulating cement to the top; in all cases surface pipe **shall be set** through all unconsolidated materials plus a minimum of 20 feet into the underlying formation.
4. If the well is dry hole, an agreement between the operator and the district office on plug length and placement is necessary **prior to plugging**;
5. The appropriate district office will be notified before well is either plugged or production casing is cemented in;
6. If an ALTERNATE II COMPLETION, production pipe shall be cemented from below any usable water to surface within **120 DAYS** of spud date. Or pursuant to Appendix "B" - Eastern Kansas surface casing order #133,891-C, which applies to the KCC District 3 area, alternate II cementing must be completed within 30 days of the spud date or the well shall be plugged. **In all cases, NOTIFY district office** prior to any cementing.

I hereby certify that the statements made herein are true and to the best of my knowledge and belief.

Date: 9-20-07 Signature of Operator or Agent: Melissa Sturm Title: Sr. Operations Asst

For KCC Use ONLY
 API # 15 - 189-22614-0000
 Conductor pipe required 0 feet
 Minimum surface pipe required 660 feet per ALT. I II
 Approved by: MA 9-24-07
 This authorization expires: 3-24-08
 (This authorization void if drilling not started within 6 months of approval date.)
 Spud date: _____ Agent: _____

Remember to:

- File Drill Pit Application (form CDP-1) with Intent to Drill;
- File Completion Form ACO-1 within 120 days of spud date;
- File acreage attribution plat according to field proration orders;
- Notify appropriate district office 48 hours prior to workover or re-entry;
- Submit plugging report (CP-4) after plugging is completed (within 60 days);
- Obtain written approval before disposing or injecting salt water.
- If this permit has expired (See: authorized expiration date) please check the box below and return to the address below.

Well Not Drilled - Permit Expired Date: _____
 Signature of Operator or Agent: _____

18
35
37
 E
 W



1012344

IN ALL CASES PLOT THE INTENDED WELL ON THE PLAT BELOW

Plat of acreage attributable to a well in a prorated or spaced field

If the intended well is in a prorated or spaced field, please fully complete this side of the form. If the intended well is in a prorated or spaced field complete the plat below showing that the well will be properly located in relationship to other wells producing from the common source of supply. Please show all the wells and within 1 mile of the boundaries of the proposed acreage attribution unit for gas wells and within 1/2 mile of the boundaries of the proposed acreage attribution unit for oil wells.

API No. 15 - 189-22614-0000
Operator: EOG Resources, Inc.
Lease: Norma
Well Number: 18 #1
Field: Wildcat

Location of Well: County: Stevens
330 feet from N / S Line of Section
700 feet from E / W Line of Section
Sec. 18 Twp. 35 S. R. 37 E W

Number of Acres attributable to well: _____
QTR/QTR/QTR/QTR of acreage: W2 - SE - SW - SW

Is Section: Regular or Irregular

If Section is Irregular, locate well from nearest corner boundary.

Section corner used: NE NW SE SW

PLAT

(Show location of the well and shade attributable acreage for prorated or spaced wells.)

(Show footage to the nearest lease or unit boundary line.)

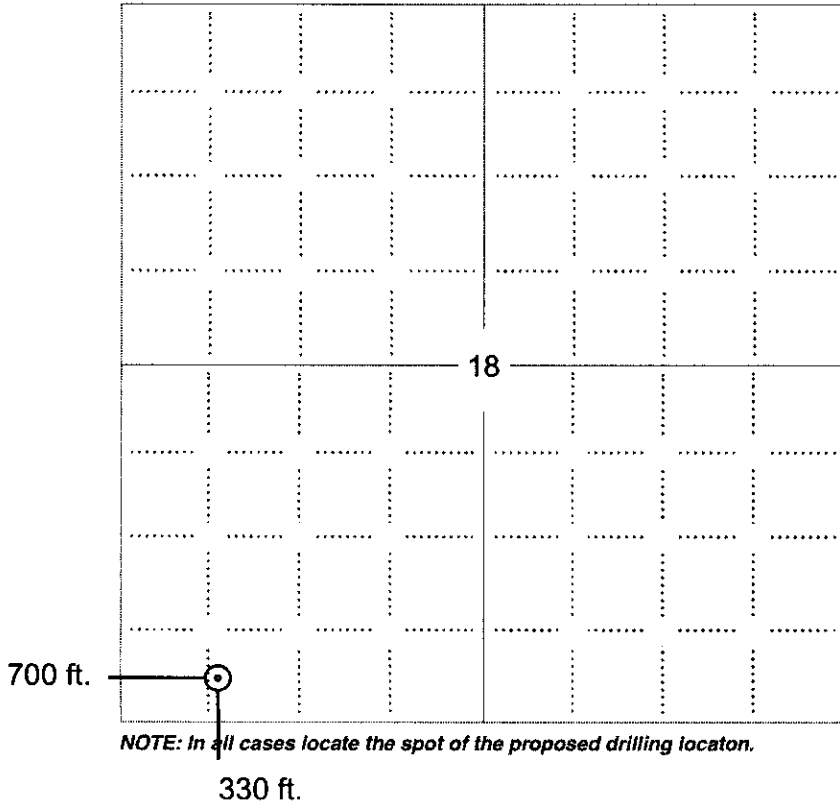

NOTE: In all cases locate the spot of the proposed drilling location.

RECEIVED
KANSAS CORPORATION COMMISSION
SEP 24 2007
CONSERVATION DIVISION
WICHITA, KS

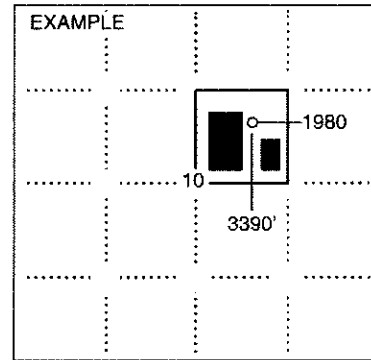

In plotting the proposed location of the well, you must show:

1. The manner in which you are using the depicted plat by identifying section lines, i.e. 1 section, 1 section with 8 surrounding sections, 4 sections, etc.
2. The distance of the proposed drilling location from the south / north and east / west outside section lines.
3. The distance to the nearest lease or unit boundary line (in footage).
4. If proposed location is located within a prorated or spaced field a certificate of acreage attribution plat must be attached: (CO-7 for oil wells; CG-8 for gas wells).



KANSAS CORPORATION COMMISSION 1012344
OIL & GAS CONSERVATION DIVISION

Form CDP-1
April 2004
Form must be Typed

APPLICATION FOR SURFACE PIT

Submit in Duplicate

Operator Name: EOG Resources, Inc.		License Number: 5278	
Operator Address: 3817 NW EXPRESSWAY STE 500		OKLAHOMA CITY OK 73112	
Contact Person: Melissa Sturm		Phone Number: 405-246-3132	
Lease Name & Well No.: Norma 18 #1		Pit Location (QQQQ): W2 SE SW SW	
Type of Pit: <input type="checkbox"/> Emergency Pit <input type="checkbox"/> Burn Pit <input type="checkbox"/> Settling Pit <input checked="" type="checkbox"/> Drilling Pit <input type="checkbox"/> Workover Pit <input type="checkbox"/> Haul-Off Pit <small>(If WP Supply API No. or Year Drilled)</small>	Pit is: <input checked="" type="checkbox"/> Proposed <input type="checkbox"/> Existing If Existing, date constructed: _____ Pit capacity: 12,500 (bbls)	Sec. 18 Twp. 35 R. 37 <input type="checkbox"/> East <input checked="" type="checkbox"/> West 330 Feet from <input type="checkbox"/> North / <input checked="" type="checkbox"/> South Line of Section 700 Feet from <input type="checkbox"/> East / <input checked="" type="checkbox"/> West Line of Section Stevens County	
Is the pit located in a Sensitive Ground Water Area? <input type="checkbox"/> Yes <input checked="" type="checkbox"/> No		Chloride concentration: _____ mg/l <small>(For Emergency Pits and Settling Pits only)</small>	
Is the bottom below ground level? <input checked="" type="checkbox"/> Yes <input type="checkbox"/> No	Artificial Liner? <input type="checkbox"/> Yes <input checked="" type="checkbox"/> No	How is the pit lined if a plastic liner is not used? Soil compaction	
Pit dimensions (all but working pits): 125 Length (feet) 125 Width (feet) <input type="checkbox"/> N/A: Steel Pits Depth from ground level to deepest point: 5 (feet) <input type="checkbox"/> No Pit			
If the pit is lined give a brief description of the liner material, thickness and installation procedure.		Describe procedures for periodic maintenance and determining liner integrity, including any special monitoring. RECEIVED KANSAS CORPORATION COMMISSION SEP 24 2007 CONSERVATION DIVISION WICHITA, KS	
Distance to nearest water well within one-mile of pit N/A feet Depth of water well _____ feet	Depth to shallowest fresh water _____ feet. Source of information: <input type="checkbox"/> measured <input type="checkbox"/> well owner <input type="checkbox"/> electric log <input checked="" type="checkbox"/> KDWR		
Emergency, Settling and Burn Pits ONLY: Producing Formation: _____ Number of producing wells on lease: _____ Barrels of fluid produced daily: _____ Does the slope from the tank battery allow all spilled fluids to flow into the pit? <input type="checkbox"/> Yes <input type="checkbox"/> No	Drilling, Workover and Haul-Off Pits ONLY: Type of material utilized in drilling/workover: Gel Number of working pits to be utilized: 0 Abandonment procedure: Evaporation / dewater and backfilling of reserve pit Drill pits must be closed within 365 days of spud date.		
I hereby certify that the above statements are true and correct to the best of my knowledge and belief.			
<u>9-20-07</u> Date		<u>Melissa Sturm</u> Signature of Applicant or Agent	
KCC OFFICE USE ONLY			
Date Received: <u>9/24/07</u> Permit Number: _____		Steel Pit <input type="checkbox"/> RFAC <input type="checkbox"/> RFAS <input type="checkbox"/>	
Permit Date: <u>9/24/07</u> Lease Inspection: <input type="checkbox"/> Yes <input checked="" type="checkbox"/> No			

15-189-22614-0000

**KANSAS CORPORATION COMMISSION
CONSERVATION DIVISION
130 S. Market - Room 2078
Wichita, Kansas 67202**

Form VPA-1
4/01

**VERIFIED AFFIDAVIT FOR USE OF MUD AS AN
ALTERNATIVE TO THE CEMENTING REQUIREMENT IN ¶18(D)
OF THE PANOMA COUNCIL GROVE B.P.O.**

FORM MUST BE TYPED

Submit in Duplicate
Attach to Drilling Permit

Operator Name EOG Resources, Inc.				KCC License No. 5278	
Operator Address 3817 NW Expressway Suite #500 Oklahoma City, OK 73112					
Contact Person Melissa Sturm				Telephone No. (405) 246-3234	
Lease Name & No. Norma 18 #1		API No. 15-189-22614-000		KCC Lease Code No.	
Location Quarter SW/4	Section 18	Township 35S	Range 37	330 E/W (circle one) 700	FL from N/S (circle one) Line of Sec. FL from E/W (circle one) Line of Sec.
County Stevens	Field Name Wildcat	Producing Formation Group Morrow & Mississippian		Mud Weight 8.7	

AFFIDAVIT CERTIFICATE OF SERVICE

All requirements of the statutes, rules and regulations promulgated to regulate the oil and gas industry have been fully complied with and the statements here are complete and correct to the best of my knowledge. The well subscribed to in this Affidavit will be completed in accordance with all applicable rules and regulations of the KCC. However, applicant intends to use drilling mud of sufficient weight across the interval between the base of the Council Grove Group and the top of the Chase Group as an alternative to the cementing requirements found in paragraph 18(D) of the Panoma Council Grove B.P.O. unless an objection is filed within 15 days of service of this Affidavit. I hereby certify that I caused a true and correct copy of the foregoing Affidavit and any attachments of said Affidavit to be served by placing the same in the United States mail, postage prepaid, to the following parties, which represent all of the operators or lessees of record and the owners of record of unleased acreage within a one mile radius of the well, including operators and working interest owners having interests in the lands covered by the unit on which the well is to be drilled:

RECEIVED
KANSAS CORPORATION COMMISSION

SEP 24 2007

CONSERVATION DIVISION
WICHITA, KS

Signature Melissa Sturm Date 9/20/07

Title Sr. Operations Assistant

Subscribed and sworn to before me this 20th day of September, 2007

Notary Public Kaye Dawn Rockel

Date Commission Expires _____



 KAYE DAWN ROCKEL
 Notary Public
 State of Oklahoma
 Commission # 04,009,575 Expires 10/21/08

15-189-22614-0000

Exhibit "A"
Norma 18 #1
Section 18-35S-37W
Stevens County, Kansas

Page 1 of 1

1. ExxonMobil Production Company
P.O. Box 4610
Houston, TX 77210-4610

End of Exhibit "A"

RECEIVED
KANSAS CORPORATION COMMISSION

SEP 24 2007

CONSERVATION DIVISION
WICHITA, KS



EOG Resources, Inc.
3817 NW Expressway
Suite 500
Oklahoma City, OK 73112-1483
(405) 246-3100

September 20, 2007

Mr. Rick Hestermann
Kansas Corporation Commission
Conservation Division
Wichita State Office Building
130 S. Market, Room 2078
Wichita, KS 67202-3802

Re: BPO Mud Affidavit
Norma 18 #1
Sec 18-35S-37W
Stevens County
330' FSL & 700' FWL

Dear Mr. Hestermann:

Enclosed is a C-1 Notice of Intent to Drill with a BPO Mud Affidavit. We understand the 15-day period is not yet up, but we are requesting that the permit be approved. If the VPA-1 Mud Affidavit were to be protested, we understand that we will be required to cement across the interval between the base of the Council Grove group and the top of the Chase group of the Panoma Council Grove BPO.

If you have any questions or concerns, please contact me at (405) 246-3234.

Thank you,

A handwritten signature in cursive script that reads "Melissa Sturm".

Melissa Sturm
Sr. Operations Assistant

RECEIVED
KANSAS CORPORATION COMMISSION

SEP 24 2007

CONSERVATION DIVISION
WICHITA, KS



*Kathleen Sebelius, Governor
Thomas E. Wright, Chairman
Robert E. Krehbiel, Commissioner
Michael C. Moffet, Commissioner*

September 24, 2007

Melissa Sturm
EOG Resources, Inc.
3817 NW Expressway, Suite 500
Oklahoma City, OK 73112

Re: Norma 18 #1, API #15-189-22614-0000
Docket # PVPA 090704
SW Sec. 18-T35S-R37W
Stevens County, Kansas

Dear Ms. Sturm,

The form VPA-1 affidavit filed for the above-referenced well stated that service of the affidavit was mailed on September 20, 2007. The fifteen (15) day protest period has not expired. Per your letter of September 20, 2007, EOG Resources, Inc. anticipates spudding this well before the fifteen-day protest period has expired. EOG Resources, Inc. also stipulates that should any protests be received before the protest period has expired, the cementing required across the Council Grove and Chase Formations per the Panoma-Council Grove Proration Order will be done. Therefore, we are advising you that the drilling of this well may commence and, unless protests to your VPA-1 are received, drilling mud of the weight specified in your affidavit may be used across the interval between the base of the Council Grove group and the top of the Chase group.

Sincerely,

A handwritten signature in black ink that reads "Rick Hestermann". The signature is fluid and includes a long, sweeping horizontal stroke at the end.

Rick Hestermann
Production Department