

Owwo

For KCC Use: Effective Date: 9-30-07 District # 2 SGA? Yes No

KANSAS CORPORATION COMMISSION OIL & GAS CONSERVATION DIVISION

Form C-1 December 2002 Form must be Typed Form must be Signed All blanks must be Filled

NOTICE OF INTENT TO DRILL

Must be approved by KCC five (5) days prior to commencing well

Expected Spud Date 10 08 07 month day year

OPERATOR: License# 5920 Name: TE-PE OIL & GAS Address: P.O. BOX 522 City/State/Zip: CANTON, KANSAS 67428 Contact Person: TERRY P. BANDY Phone: 620-628-4428

CONTRACTOR: License# 32701 Name: C & G DRILLING

Well Drilled For: Oil Gas OWWO Seismic; # of Holes Other Well Class: Enh Rec Storage Disposal Wildcat Other Well Class: Infield Pool Ext. Wildcat Other Type Equipment: Mud Rotary Air Rotary Cable

If OWWO: old well information as follows: Operator: OIL PROPERTIES INVESTMENT CORP. Well Name: 3#A NICKLAUS Original Completion Date: 7/20/85 Original Total Depth: 2560

Directional, Deviated or Horizontal wellbore? Yes No If Yes, true vertical depth: Bottom Hole Location: KCC DKT #:

Spot E/2 E/2 SE Sec. 08 Twp. 22 S. R. 04 East West 1320 feet from N / S Line of Section 330 feet from E / W Line of Section Is SECTION Regular Irregular?

(Note: Locate well on the Section Plat on reverse side) County: MARION Lease Name: NICKLAUS Well #: 3 Field Name: PEABODY

Is this a Prorated / Spaced Field? Yes No Target Formation(s): ARBUCKLE Nearest Lease or unit boundary: 330' Ground Surface Elevation: 1448 feet MSL Water well within one-quarter mile: Yes No Public water supply well within one mile: Yes No Depth to bottom of fresh water: 75' Depth to bottom of usable water: 120' Surface Pipe by Alternate: 1 2 Length of Surface Pipe Planned to be set: ALREADY SET 240' Length of Conductor Pipe required: Projected Total Depth: 3060 Formation at Total Depth: ARBUCKLE

Water Source for Drilling Operations: Well Farm Pond Other DWR Permit #: (Note: Apply for Permit with DWR)

Will Cores be taken? Yes No If Yes, proposed zone: RECEIVED

KANSAS CORPORATION COMMISSION

AFFIDAVIT

The undersigned hereby affirms that the drilling, completion and eventual plugging of this well will comply with K.S.A. 55 et. seq. SEP 24 2007

It is agreed that the following minimum requirements will be met:

- 1. Notify the appropriate district office prior to spudding of well;
2. A copy of the approved notice of intent to drill shall be posted on each drilling rig;
3. The minimum amount of surface pipe as specified below shall be set by circulating cement to the top; in all cases surface pipe shall be set through all unconsolidated materials plus a minimum of 20 feet into the underlying formation.
4. If the well is dry hole, an agreement between the operator and the district office on plug length and placement is necessary prior to plugging;
5. The appropriate district office will be notified before well is either plugged or production casing is cemented in;
6. If an ALTERNATE II COMPLETION, production pipe shall be cemented from below any usable water to surface within 120 days of spud date.
Or pursuant to Appendix "B" - Eastern Kansas surface casing order #133,891-C, which applies to the KCC District 3 area, alternate II cementing must be completed within 30 days of the spud date or the well shall be plugged. In all cases, NOTIFY district office prior to any cementing.

I hereby certify that the statements made herein are true and to the best of my knowledge and belief.

Date: 9/21/07 Signature of Operator or Agent: Terry Bandy Title: OPERATOR

For KCC Use ONLY API # 15 - 115-21186-00-01 Conductor pipe required None feet Minimum surface pipe required 200 feet per Alt. 1 Approved by: PA 9-25-07 This authorization expires: 3-25-08 (This authorization void if drilling not started within 6 months of approval date.) Spud date: Agent:

Remember to:

- File Drill Pit Application (form CDP-1) with Intent to Drill;
- File Completion Form ACO-1 within 120 days of spud date;
- File acreage attribution plat according to field proration orders;
- Notify appropriate district office 48 hours prior to workover or re-entry;
- Submit plugging report (CP-4) after plugging is completed;
- Obtain written approval before disposing or injecting salt water.
- If this permit has expired (See: authorized expiration date) please check the box below and return to the address below.

Well Not Drilled - Permit Expired Signature of Operator or Agent: Date:

8 22 4/E

IN ALL CASES PLOT THE INTENDED WELL ON THE PLAT BELOW

Plat of acreage attributable to a well in a prorated or spaced field

If the intended well is in a prorated or spaced field, please fully complete this side of the form. If the intended well is in a prorated or spaced field complete the plat below showing that the well will be properly located in relationship to other wells producing from the common source of supply. Please show all the wells and within 1 mile of the boundaries of the proposed acreage attribution unit for gas wells and within 1/2 mile of the boundaries of the proposed acreage attribution unit for oil wells.

API No. 15 - 115-21,186 -00-01
 Operator: TE-PE OIL & GAS
 Lease: NICKLAUS
 Well Number: 3
 Field: PEABODY

Location of Well: County: MARION
1320 feet from N / S Line of Section
330 feet from E / W Line of Section
 Sec. 08 Twp. 22 S. R. 04 East West

Number of Acres attributable to well: _____
 QTR / QTR / QTR of acreage: E/2 - E/2 - SE

Is Section: Regular or Irregular

If Section is Irregular, locate well from nearest corner boundary.

Section corner used: NE NW SE SW

PLAT

(Show location of the well and shade attributable acreage for prorated or spaced wells.)

(Show footage to the nearest lease or unit boundary line.)

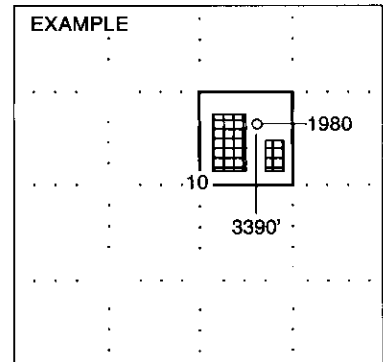
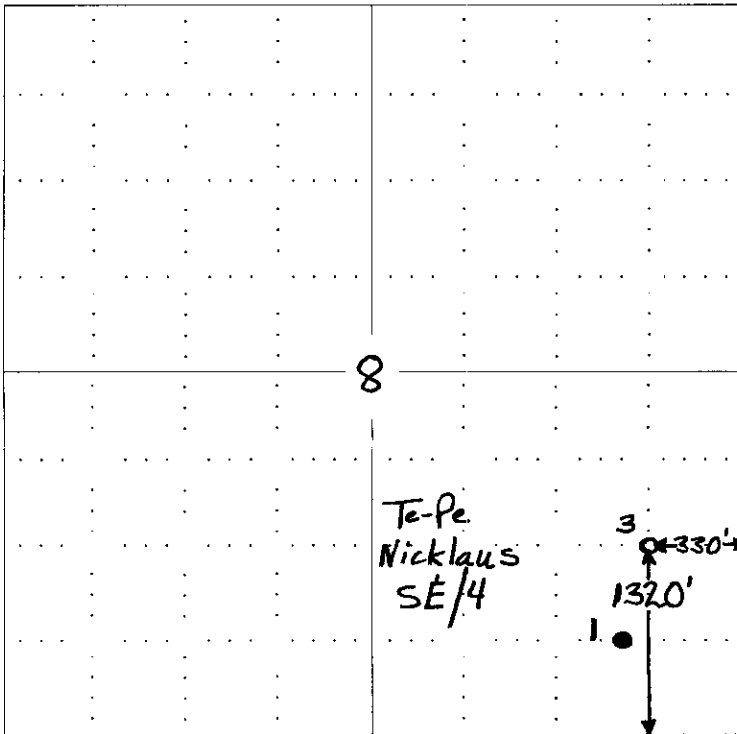

SEWARD CO.

NOTE: In all cases locate the spot of the proposed drilling location.

In plotting the proposed location of the well, you must show:

1. The manner in which you are using the depicted plat by identifying section lines, i.e. 1 section, 1 section with 8 surrounding sections, 4 sections, etc.
2. The distance of the proposed drilling location from the section's south / north and east / west.
3. The distance to the nearest lease or unit boundary line.
4. If proposed location is located within a prorated or spaced field a certificate of acreage attribution plat must be attached: (CO-7 for oil wells; CG-8 for gas wells).

RECEIVED
 KANSAS CORPORATION COMMISSION

SEP 24 2007

CONSERVATION DIVISION
 WICHITA, KS

KANSAS CORPORATION COMMISSION
OIL & GAS CONSERVATION DIVISION
APPLICATION FOR SURFACE PIT

Form CDP-1
April 2004
Form must be Typed

Submit in Duplicate

Operator Name: TE-PE OIL & GAS		License Number: 5920
Operator Address: P.O. BOX 522, CANTON, KANSAS 67428		
Contact Person: TERRY P BANDY		Phone Number: (620) 628 - 4428
Lease Name & Well No.: NICKLAUS #3		Pit Location (QQQQ): C E/2 E/2 SE/4
Type of Pit: <input type="checkbox"/> Emergency Pit <input type="checkbox"/> Burn Pit <input type="checkbox"/> Settling Pit <input checked="" type="checkbox"/> Drilling Pit <input type="checkbox"/> Workover Pit <input type="checkbox"/> Haul-Off Pit <i>(If W/P Supply API No. or Year Drilled)</i>	Pit is: <input checked="" type="checkbox"/> Proposed <input type="checkbox"/> Existing If Existing, date constructed: _____ Pit capacity: 200 (bbls)	Sec. 08 Twp. 22 R. 04 <input checked="" type="checkbox"/> East <input type="checkbox"/> West 1320 Feet from <input type="checkbox"/> North / <input checked="" type="checkbox"/> South Line of Section 330 Feet from <input checked="" type="checkbox"/> East / <input type="checkbox"/> West Line of Section MARION County
Is the pit located in a Sensitive Ground Water Area? <input type="checkbox"/> Yes <input checked="" type="checkbox"/> No		Chloride concentration: _____ mg/l <i>(For Emergency Pits and Settling Pits only)</i>
Is the bottom below ground level? <input checked="" type="checkbox"/> Yes <input type="checkbox"/> No	Artificial Liner? <input type="checkbox"/> Yes <input checked="" type="checkbox"/> No	How is the pit lined if a plastic liner is not used? BENTONITE GEL SEALED
Pit dimensions (all but working pits): 30 Length (feet) 20 Width (feet) N/A: Steel Pits Depth from ground level to deepest point: 4 (feet)		
If the pit is lined give a brief description of the liner material, thickness and installation procedure.		Describe procedures for periodic maintenance and determining liner integrity, including any special monitoring.
Distance to nearest water well within one-mile of pit <input checked="" type="checkbox"/> NONE feet Depth of water well _____ feet		Depth to shallowest fresh water 55 feet. Source of information: _____ measured _____ well owner _____ electric log <input checked="" type="checkbox"/> KDWR
Emergency, Settling and Burn Pits ONLY: Producing Formation: _____ Number of producing wells on lease: _____ Barrels of fluid produced daily: _____ Does the slope from the tank battery allow all spilled fluids to flow into the pit? <input type="checkbox"/> Yes <input type="checkbox"/> No		Drilling, Workover and Haul-Off Pits ONLY: Type of material utilized in drilling/workover: FRESHWATER & BENTONITE Number of working pits to be utilized: 2 Abandonment procedure: WHEN PITS ARE SUFFICIENTLY DRY, BACKFILL WITH THE ORIGINAL CONSTRUCTION MATERIAL Drill pits must be closed within 365 days of spud date.
I hereby certify that the above statements are true and correct to the best of my knowledge and belief.		
Date: 9/21/07		Signature of Applicant or Agent:  SEP 24 2007
KCC OFFICE USE ONLY		CONSERVATION DIVISION WICHITA, KS
Date Received: 9/24/07 Permit Number: _____ Permit Date: 9/24/07 Lease Inspection: <input type="checkbox"/> Yes <input checked="" type="checkbox"/> No		

15-115-2112-0001

STATE OF KANSAS
STATE CORPORATION COMMISSION
200 Colorado Derby Building
Wichita, Kansas 67202

K.A.S. - E2-3-117

API NUMBER 115-21,186-000

LEASE NAME Nicklaus

WELL NUMBER #3 "A"

SPOT LOCATION E 1/2 E 1/2 SE

SEC. 8 TWP. 22 RGE. 4E (E) or (S)

COUNTY Marion

Date Well Completed 7/20/85

Plugging Commenced 7/20/85

Plugging Completed 7/20/85

TYPE OR PRINT
NOTICE: Fill out completely
and return to Cons. Div.
office within 30 days.

LEASE OPERATOR Oil Properties Investment Corporation

ADDRESS 2400 N. Woodlawn, Suite 110, Wichita, KS 67220

PHONE # (316) 686-1900 OPERATORS LICENSE NO. 5410

Character of Well _____
(Oil, Gas, D&A, SWD, Input, Water Supply Well)

Did you notify the KCC/KDHE Joint District Office prior to plugging this well? Yes

Which KCC/KDHE Joint Office did you notify? Phil Worley

Is ACO-1 filed? _____ If not, is well log attached? Yes

Producing formation _____ Depth to top _____ bottom T.D. 2560'

Show depth and thickness of all water, oil and gas formations.

OIL, GAS OR WATER RECORDS

CASING RECORD

Formation	Content	From	To	Size	Put in	Pulled out
	Surface	0	200.79	8 5/8	200.79'	0

Describe in detail the manner in which the well was plugged, indicating where the mud fluid was placed and the method or methods used in introducing it into the hole. If cement or other plugs were used state, the character of same and depth placed, from feet to feet each set.

Plug hole 40 sacks cement @ 250', 20 sacks cement @ 60',
10 sacks cement in rathole

(If additional description is necessary, use BACK of this form.)

Name of Plugging Contractor EDCO Drilling Company, Inc. License No. 5676
Address 114 W. Locust, El Dorado, Kansas 67042

STATE OF Kansas COUNTY OF Butler, ss.

(employee of operator) or
(operator) of above-described well, being first duly sworn on oath, says: That
I have knowledge of the facts, statements, and matters herein contained and
the log of the above-described well as filed that the same are true and
correct, so help me God.

(Signature) W. H. [Signature]

(Address) Box 645, El Dorado, KS 67042

SUBSCRIBED AND SWORN TO before me this 29th day of July, 1985

TERESA E. ORR
NOTARY PUBLIC
STATE OF KANSAS

My Commission expires: _____

[Signature]
RECEIVED
STATE CORPORATION COMMISSION

MY APPT. EXP. 10-13-86

JUL 31 1985 Form CP-4 /-1
revised 06-83



*Kathleen Sebelius, Governor
Thomas E. Wright, Chairman
Michael C. Moffet, Commissioner
Joseph F. Harkins, Commissioner*

**NOTICE TO OPERATORS FILING INTENT TO DRILL
FOR DISPOSAL OR ENHANCED RECOVERY
INJECTION WELLS, (CLASS II INJECTION WELL)**

The attached approved Notice of Intent to Drill indicates the proposed well is to be used for injection. An approved "Intent to Drill" does not approve injection authority as a Class II Injection Well in Kansas.

Before any well is used for injection purposes, the operator must file an application for injection authority in accordance with K.A.R. 82-3-401 and provide notice in accordance with K.A.R. 82-3-402. The Conservation Division must issue a written permit granting the application before commencement of injection.

The Conservation Division requirements and restrictions associated with Class II Injection are identified in **K.A.R. 82-3-400 et seq** of our regulations. Associated regulations governing drilling, completion and injection applications may be found in K.A.R. 82-3-135, Table I, Table II, in the Cedar Hills Sandstone Moratorium, (Docket #156,397-C), and the Eastern Kansas Surface Casing Order, (Docket #133,891-C).

If you have questions regarding the approval of injection authority, an injection application may be filed as a "Design Approval" before actual drilling and completion of the well occurs. If you have any questions or concerns regarding Class II injection wells or regulations, call the Underground Injection Control Department at 316-337-6200.

Failure to obtain commission approval before beginning injection is punishable by a penalty, shut-in of the well or both.