

SEP 27 2007

For KCC Use:
Effective Date: 10-2-07
District # 1
SGA? Yes No

KANSAS CORPORATION COMMISSION OIL & GAS CONSERVATION DIVISION

NOTICE OF INTENT TO DRILL

Must be approved by KCC five (5) days prior to commencing well

Form must be Typed
Form must be Signed
All blanks must be Filled

Expected Spud Date 10 12 2007
month day year

OPERATOR: License# 32198
Name: PETROSANTANDER (USA) INC
Address: 6363 WOODWAY suite 350,
City/State/Zip: Houston, Texas 77057
Contact Person: Liliana Hernandez
Phone: 713-784-8700

CONTRACTOR: License# 5362 33784
Name: Cheyenne Drilling Trinidad Drilling Limited Partnership

<input checked="" type="checkbox"/> Oil	<input type="checkbox"/> Enh Rec	<input checked="" type="checkbox"/> Infield	<input checked="" type="checkbox"/> Mud Rotary
<input type="checkbox"/> Gas	<input type="checkbox"/> Storage	<input type="checkbox"/> Pool Ext.	<input type="checkbox"/> Air Rotary
<input type="checkbox"/> OWWO	<input type="checkbox"/> Disposal	<input type="checkbox"/> Wildcat	<input type="checkbox"/> Cable
<input type="checkbox"/> Seismic; # of Holes	<input type="checkbox"/> Other		
<input type="checkbox"/> Other			

If OWWO: old well information as follows:
Operator: _____
Well Name: _____
Original Completion Date: _____ Original Total Depth: _____

Directional, Deviated or Horizontal wellbore? Yes No
If Yes, true vertical depth: _____
Bottom Hole Location: _____
KCC DKT #: _____

Spot
W/2 SW SW Sec. 2 Twp. 33 S. R. 30 East West
660 feet from N / S Line of Section
625 feet from E / W Line of Section
Is SECTION Regular Irregular?

(Note: Locate well on the Section Plat on reverse side)

County: MEADE
Lease Name: Stevens (Morrow) Unit Well #: SMU 213
Field Name: Stevens

Is this a Prorated / Spaced Field? Yes No
Target Formation(s): Morrow

Nearest Lease or unit boundary: 660 feet MSL
Ground Surface Elevation: 2720

Water well within one-quarter mile: Yes No
Public water supply well within one mile: Yes No

Depth to bottom of fresh water: ~540
Depth to bottom of usable water: 580

Surface Pipe by Alternate: 1 2
Length of Surface Pipe Planned to be set: 1500

Length of Conductor Pipe required: (none)
Projected Total Depth: 5900

Formation at Total Depth: Mississippian
Water Source for Drilling Operations:
 Well Farm Pond Other _____

DWR Permit #: _____
(Note: Apply for Permit with DWR)

Will Cores be taken? Yes No
If Yes, proposed zone: _____

AFFIDAVIT

The undersigned hereby affirms that the drilling, completion and eventual plugging of this well will comply with K.S.A. 55 et. seq.
It is agreed that the following minimum requirements will be met:

1. Notify the appropriate district office **prior** to spudding of well;
2. A copy of the approved notice of intent to drill **shall be** posted on each drilling rig;
3. The minimum amount of surface pipe as specified below **shall be set** by circulating cement to the top; in all cases surface pipe **shall be set** through all unconsolidated materials plus a minimum of 20 feet into the underlying formation.
4. If the well is dry hole, an agreement between the operator and the district office on plug length and placement is necessary **prior to plugging**;
5. The appropriate district office will be notified before well is either **plugged** or production casing is cemented in;
6. If an ALTERNATE II COMPLETION, production pipe shall be cemented from below any usable water to surface within **120 days** of spud date. Or pursuant to Appendix "B" - Eastern Kansas surface casing order #133,891-C, which applies to the KCC District 3 area, alternate II cementing must be completed within 30 days of the spud date or the well shall be plugged. **In all cases, NOTIFY district office** prior to any cementing.

I hereby certify that the statements made herein are true and to the best of my knowledge and belief.
Date: 09/26/07 Signature of Operator or Agent: Liliana Hernandez Title: Senior Engineer

For KCC Use ONLY
API # 15 - 119-21187-0000
Conductor pipe required None feet
Minimum surface pipe required 600 feet per Alt. 1
Approved by: PH 9-27-07
This authorization expires: 3-27-08
(This authorization void if drilling not started within 6 months of approval date.)
Spud date: _____ Agent: _____

Remember to:

- File Drill Pit Application (form CDP-1) with Intent to Drill;
- File Completion Form ACO-1 within 120 days of spud date;
- File acreage attribution plat according to field proration orders;
- Notify appropriate district office 48 hours prior to workover or re-entry;
- Submit plugging report (CP-4) after plugging is completed;
- Obtain written approval before disposing or injecting salt water.

- If this permit has expired (See: authorized expiration date) please check the box below and return to the address below.
 Well Not Drilled - Permit Expired
Signature of Operator or Agent: _____
Date: _____

2
33
30W

SEP 27 2007

Side Two

IN ALL CASES PLOT THE INTENDED WELL IN A PRORATED OR SPACED FIELD

PLAT OF ACREAGE ATTRIBUTABLE TO A WELL IN A PRORATED OR SPACED FIELD

If the intended well is in a prorated or spaced field, please fully complete this side of the form. If the intended well is in a prorated or spaced field complete the plat below showing that the well will be properly located in relationship to other wells producing from the common source of supply. Please show all the wells and within 1 mile of the boundaries of the proposed acreage attribution unit for gas wells and within 1/2 mile of the boundaries of the proposed acreage attribution unit for oil wells.

API No. 15- 119-21187-0000
 Operator: PetroSantander (USA) Inc.
 Lease: Stevens (Morrow) Unit
 Well Number: 213
 Field: Stevens

Location of Well: County: Meade
660 feet from S N (circle one) Line of Section
625 feet from W E (circle one) Line of Section
 Sec. 2 Twp. 33S R. 30 East West
 IS SECTION X REGULAR or IRREGULAR

NUMBER OF ACRES ATTRIBUTABLE TO WELL
 QTR/QTR/QTR OF ACREAGE W/2 -SW-SW

If Section is irregular, locate well from nearest corner boundary
 Section corner used: NE NW SE SW

PLAT

(Show location of the well and shade attributable acreage for prorated or spaced wells.)
 (Show footage to the nearest lease or unit boundary line.)

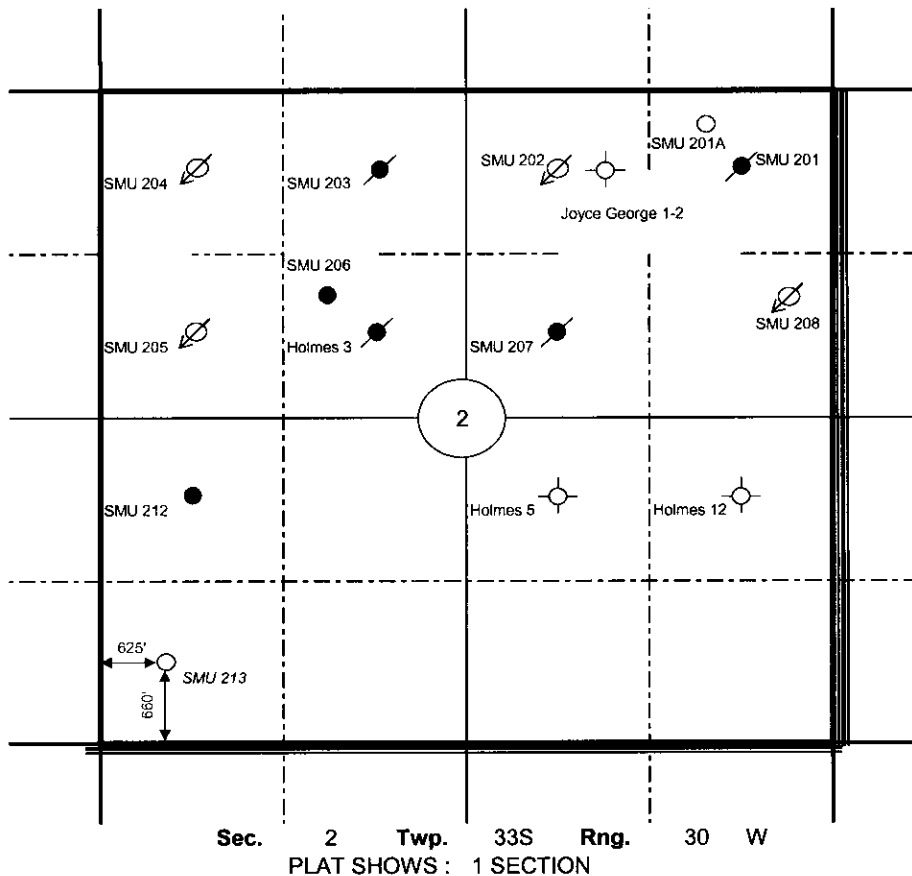

In plotting the proposed location of the well, you must show:

1. The manner in which you are using the depicted plat by identifying section lines, i.e. 1 section, 1 section with 8 surrounding sections, 4 sections, etc.
2. The distance of the proposed drilling location from the section's south / north and east / west.
3. The distance to the nearest lease or unit boundary line.
4. If proposed location is located within a prorated or space field a certificate of acreage attribution plat must be attached: (CO-7 for oil wells; CG-8 for gas wells).

SEP 27 2007

KANSAS CORPORATION COMMISSION
OIL & GAS CONSERVATION DIVISION
APPLICATION FOR SURFACE PIT

Form CDP-1
April 2004
Form must be Typed

Submit in Duplicate

Operator Name: PETROSANTANDER (USA) INC		License Number: 32198
Operator Address: 6363 WOODWAY suite 350, Houston, Texas 77057		
Contact Person: Liliana Hernandez		Phone Number: (713) 784 - 8700
Lease Name & Well No.: SMU 213		Pit Location (QQQQ): W/2 SW SW
Type of Pit: <input type="checkbox"/> Emergency Pit <input type="checkbox"/> Burn Pit <input type="checkbox"/> Settling Pit <input checked="" type="checkbox"/> Drilling Pit <input type="checkbox"/> Workover Pit <input type="checkbox"/> Haul-Off Pit <small>(If WP Supply API No. or Year Drilled)</small>	Pit is: <input checked="" type="checkbox"/> Proposed <input type="checkbox"/> Existing If Existing, date constructed: _____ Pit capacity: 10,000 (bbls)	Sec. 2 Twp. 33S R. 30 <input type="checkbox"/> East <input checked="" type="checkbox"/> West 660 Feet from <input type="checkbox"/> North / <input checked="" type="checkbox"/> South Line of Section 625 Feet from <input type="checkbox"/> East / <input checked="" type="checkbox"/> West Line of Section Meade County
Is the pit located in a Sensitive Ground Water Area? <input type="checkbox"/> Yes <input checked="" type="checkbox"/> No		Chloride concentration: _____ mg/l <small>(For Emergency Pits and Settling Pits only)</small>
Is the bottom below ground level? <input checked="" type="checkbox"/> Yes <input type="checkbox"/> No	Artificial Liner? <input type="checkbox"/> Yes <input checked="" type="checkbox"/> No	How is the pit lined if a plastic liner is not used? Natural clay and drilling mud
Pit dimensions (all but working pits): 125 Length (feet) 125 Width (feet) 3 N/A: Steel Pits Depth from ground level to deepest point: 4 (feet)		
If the pit is lined give a brief description of the liner material, thickness and installation procedure.		Describe procedures for periodic maintenance and determining liner integrity, including any special monitoring.
Distance to nearest water well within one-mile of pit 3624 feet Depth of water well 424 feet		Depth to shallowest fresh water 183 feet. Source of information: _____ measured _____ well owner _____ electric log (a) KDWR
Emergency, Settling and Burn Pits ONLY: Producing Formation: _____ Number of producing wells on lease: _____ Barrels of fluid produced daily: _____ Does the slope from the tank battery allow all spilled fluids to flow into the pit? <input type="checkbox"/> Yes <input type="checkbox"/> No		Drilling, Workover and Haul-Off Pits ONLY: Type of material utilized in drilling/workover: drilling mud Number of working pits to be utilized: 3 - steel Abandonment procedure: backfill and level when sufficiently dryt Drill pits must be closed within 365 days of spud date.
I hereby certify that the above statements are true and correct to the best of my knowledge and belief.		
09/28/07 Date		Liliana Hernandez Signature of Applicant or Agent

15-119-2187-020

KCC OFFICE USE ONLY			
Date Received: 9/27/07	Permit Number: _____	Permit Date: 9/27/07	Lease Inspection: <input type="checkbox"/> Yes <input checked="" type="checkbox"/> No

Mail to: KCC - Conservation Division, 130 S. Market - Room 2078, Wichita, Kansas 67202