



For KCC Use: 10-7-07
 Effective Date: _____
 District # 1
 SGA? Yes No

KANSAS CORPORATION COMMISSION 1012208
 OIL & GAS CONSERVATION DIVISION

Form C-1
 November 2005
 Form must be Typed
 Form must be Signed
 All blanks must be Filled

NOTICE OF INTENT TO DRILL
 Must be approved by KCC five (5) days prior to commencing well

Expected Spud Date: 10/18/2007
 month day year

OPERATOR: License# 8061
 Name: Oil Producers Inc. of Kansas
 Address 1: 1710 WATERFRONT PKWY
 Address 2: _____
 City: WICHITA State: KS Zip: 67206 + 6603
 Contact Person: Lori Zehr
 Phone: 316-682-3022

CONTRACTOR: License# 30606
 Name: Murfin Drilling Co., Inc.

Well Drilled For: Oil Enh Rec Infield Mud Rotary
 Gas Storage Pool Ext. Air Rotary
 Seismic; # of Holes Disposal Wildcat Cable
 Other: _____
 If OWWO: old well information as follows:

Operator: _____
 Well Name: _____
 Original Completion Date: _____ Original Total Depth: _____

Directional, Deviated or Horizontal wellbore? Yes No
 If Yes, true vertical depth: _____
 Bottom Hole Location: _____
 KCC DKT #: _____

Spot Description: Approx. 70' West of
 _____ NW Sec. 4 Twp. 33 S. R. 31 E W
1,320 feet from N / S Line of Section
1,250 feet from E / W Line of Section
 Is SECTION: Regular Irregular?

(Note: Locate well on the Section Plat on reverse side)
 County: Seward
 Lease Name: Burr Well #: 1-4
 Field Name: SIMS-MASSONI GAS AREA
 Is this a Prorated / Spaced Field? Yes No
 Target Formation(s): Herington/Krider of Chase Group
 Nearest Lease or unit boundary line (in footage): 1250
 Ground Surface Elevation: 2780 feet MSL
 Water well within one-quarter mile: Yes No
 Public water supply well within one mile: Yes No
 Depth to bottom of fresh water: 580
 Depth to bottom of usable water: 580
 Surface Pipe by Alternate: I II
 Length of Surface Pipe Planned to be set: 1600
 Length of Conductor Pipe (if any): 0
 Projected Total Depth: 2800
 Formation at Total Depth: Herington/Krider of Chase Group
 Water Source for Drilling Operations:
 Well Farm Pond Other: Haul
 DWR Permit #: _____
 (Note: Apply for Permit with DWR)
 Will Cores be taken? Yes No
 If Yes, proposed zone: _____

AFFIDAVIT

RECEIVED
 KANSAS CORPORATION COMMISSION

The undersigned hereby affirms that the drilling, completion and eventual plugging of this well will comply with K.S.A. 55 et. seq.
 It is agreed that the following minimum requirements will be met:

OCT 02 2007

1. Notify the appropriate district office **prior** to spudding of well;
2. A copy of the approved notice of intent to drill **shall be** posted on each drilling rig;
3. The minimum amount of surface pipe as specified below **shall be set** by circulating cement to the top; in all cases surface pipe **shall be set** through all unconsolidated materials plus a minimum of 20 feet into the underlying formation.
4. If the well is dry hole, an agreement between the operator and the district office on plug length and placement is necessary **prior to plugging**;
5. The appropriate district office will be notified before well is either plugged or production casing is cemented in;
6. If an ALTERNATE II COMPLETION, production pipe shall be cemented from below any usable water to surface within **120 DAYS** of spud date. Or pursuant to Appendix "B" - Eastern Kansas surface casing order #133,891-C, which applies to the KCC District 3 area, alternate II cementing must be completed within 30 days of the spud date or the well shall be plugged. **In all cases, NOTIFY district office** prior to any cementing.

I hereby certify that the statements made herein are true and to the best of my knowledge and belief.

Date: 10.1.07 Signature of Operator or Agent: [Signature] Title: Vice President

For KCC Use ONLY
 API # 15 - 175-22114-0000
 Conductor pipe required 0 feet
 Minimum surface pipe required 600 feet per ALT I II
 Approved by: [Signature]
 This authorization expires: 4-2-08
 (This authorization void if drilling not started within 6 months of approval date.)
 Spud date: _____ Agent: _____

Remember to:

- File Drill Pit Application (form CDP-1) with Intent to Drill;
- File Completion Form ACC-1 within 120 days of spud date;
- File acreage attribution plat according to field proration orders;
- Notify appropriate district office 48 hours prior to workover or re-entry;
- Submit plugging report (CP-4) after plugging is completed (within 60 days);
- Obtain written approval before disposing or injecting salt water.
- If this permit has expired (See: authorized expiration date) please check the box below and return to the address below.

Well Not Drilled - Permit Expired Date: _____
 Signature of Operator or Agent: _____

4
33
31
 E
 W



1012208

IN ALL CASES PLOT THE INTENDED WELL ON THE PLAT BELOW

Plat of acreage attributable to a well in a prorated or spaced field

If the intended well is in a prorated or spaced field, please fully complete this side of the form. If the intended well is in a prorated or spaced field complete the plat below showing that the well will be properly located in relationship to other wells producing from the common source of supply. Please show all the wells and within 1 mile of the boundaries of the proposed acreage attribution unit for gas wells and within 1/2 mile of the boundaries of the proposed acreage attribution unit for oil wells.

API No. 15 - 175-22114-0000
Operator: Oil Producers Inc. of Kansas
Lease: Burr
Well Number: 1-4
Field: SIMS-MASSONI GAS AREA

Number of Acres attributable to well: 480
QTR/QTR/QTR/QTR of acreage: _____ - _____ - _____ - NW

Location of Well: County: Seward
1,320 feet from N / S Line of Section
1,250 feet from E / W Line of Section
Sec. 4 Twp. 33 S. R. 31 E W

Is Section: Regular or Irregular

If Section is Irregular, locate well from nearest corner boundary.

Section corner used: NE NW SE SW

PLAT

(Show location of the well and shade attributable acreage for prorated or spaced wells.)

(Show footage to the nearest lease or unit boundary line.)

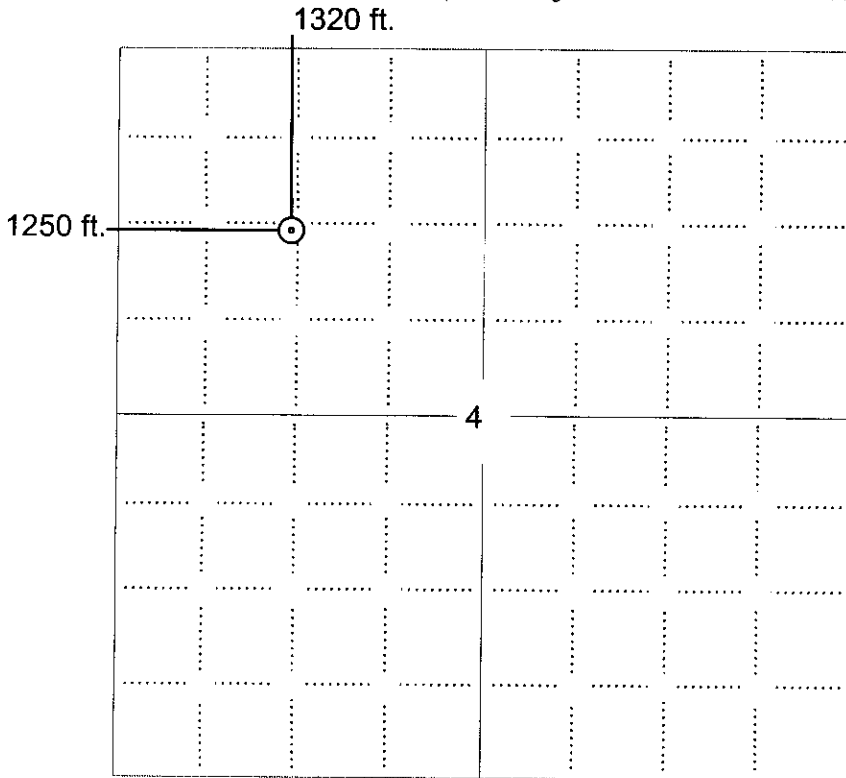

NOTE: In all cases locate the spot of the proposed drilling location.

RECEIVED
KANSAS CORPORATION COMMISSION

OCT 02 2007

CONSERVATION DIVISION
WICHITA, KS

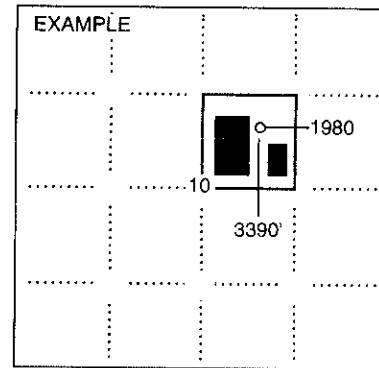

SEWARD CO.

In plotting the proposed location of the well, you must show:

1. The manner in which you are using the depicted plat by identifying section lines, i.e. 1 section, 1 section with 8 surrounding sections, 4 sections, etc.
2. The distance of the proposed drilling location from the south / north and east / west outside section lines.
3. The distance to the nearest lease or unit boundary line (in footage).
4. If proposed location is located within a prorated or spaced field a certificate of acreage attribution plat must be attached: (CO-7 for oil wells; CG-8 for gas wells).

PLAT AND CERTIFICATION OF ACREAGE ATTRIBUTABLE TO A GAS WELL

RECEIVED
KANSAS CORPORATION COMMISSION

Kansas Corporation Commission, Conservation Division
Finney State Office Building, 130 South Market, Room 2078
Wichita, Kansas 67202

OCT 02 2007

CONSERVATION DIVISION
WICHITA, KS

API NUMBER 15- 175-22114-0000

OPERATOR Oil Producers Inc. of Kansas

LEASE Burr

WELL NUMBER #1-4

FIELD Hugoton

LOCATION OF WELL: COUNTY Seward

1320 feet from south/north line of section

1250 feet from east / west line of section

SECTION 4 TWP 33S (S) RG 31 E/W

IS SECTION y REGULAR or IRREGULAR

IF SECTION IS IRREGULAR, LOCATE WELL FROM

NEAREST CORNER BOUNDARY. (check line below)

Section corner used: NE X NW SE SW

NUMBER OF ACRES ATTRIBUTABLE TO WELL 480

QTR/QTR/QTR OF ACREAGE - C - NW

Approx. 100' west of

(Show the location of the well and shade attributable acreage for prorated or spaced wells).
(Show the footage to the nearest lease or unit boundary line; and show footage to the nearest common source supply well).

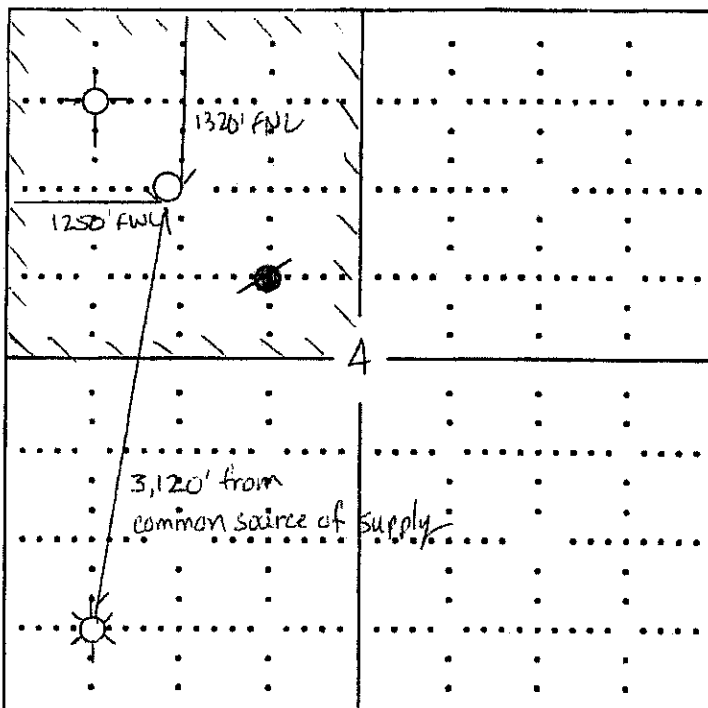

See attached Plat for
complete Unit Acreage

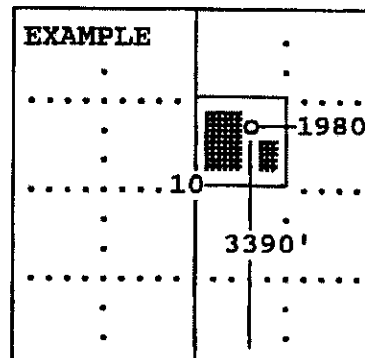

SEWARD CO.

The undersigned hereby certifies as Vice President (title) for

Oil Producers Inc. Of Kansas (Co.), a duly authorized agent, that all information shown hereon is true and correct to the best of my knowledge and belief, that all acreage claimed attributable to the well named herein is held by production from that well and hereby make application for an allowable to be assigned to the well upon the filing of this form and the State test, whichever is later.

Signature [Signature]

Subscribed and sworn to before me on this 18th day of September, 2007

LORIA A. ZEHR
Notary Public - State of Kansas
My Appt. Expires 5/5/10

[Signature]
Notary Public

My Commission expires May 5, 2010

FORM CG-8 (12/94)

15-175-22114-0000

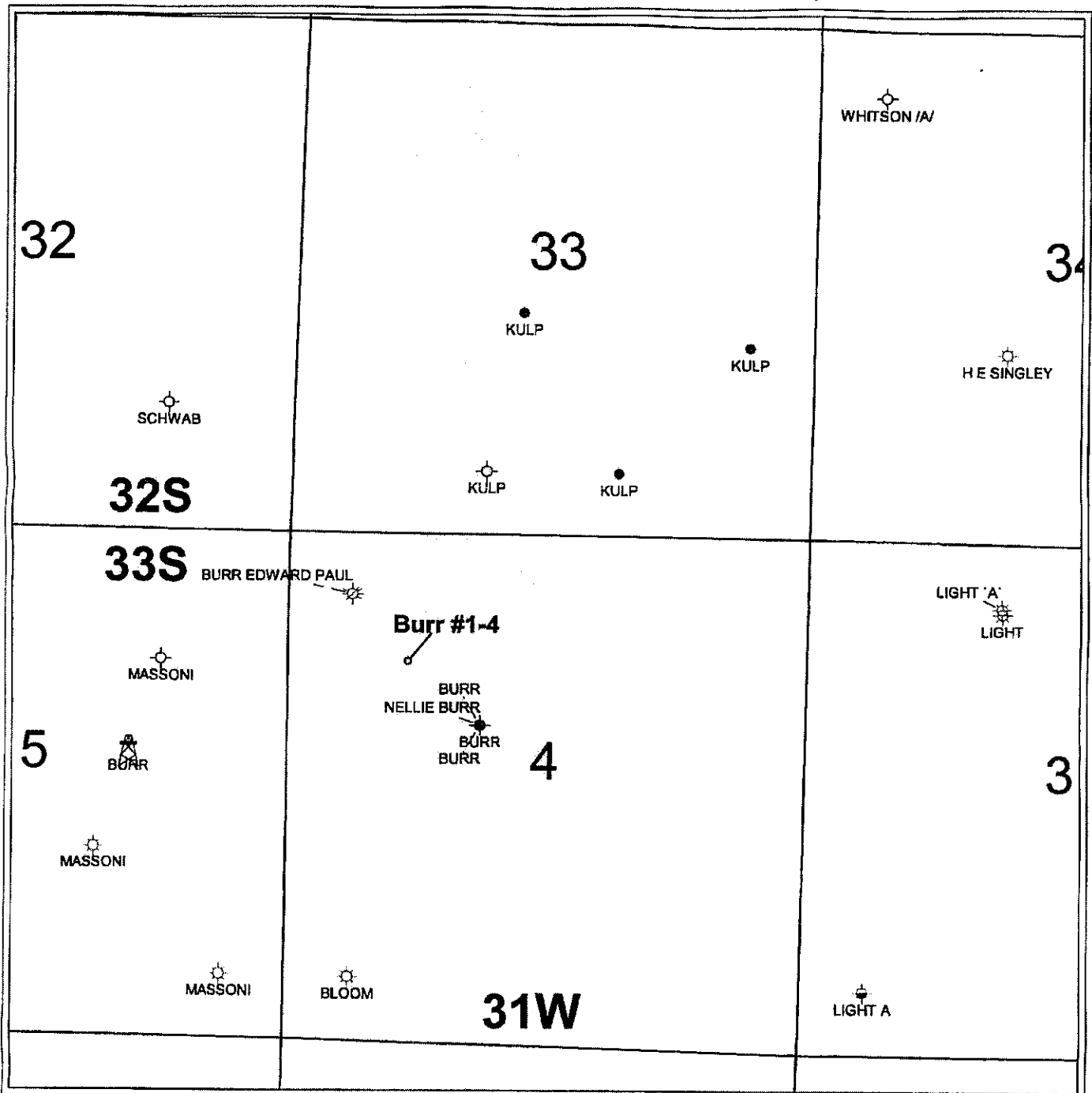

PETRA 10/17/2007 4:20:24 PM

Oil Producers Of Kansas

CG-8 Acreage Plot Map
Seward County, Kansas

- WELL SYMBOLS**
- Dry Hole, With Show of Oil
 - Dry Hole
 - Gas Well
 - Oil Well
 - Plugged & Abandoned Gas Well
 - Drilling Well

Ratio Scale = 1 : 10,000



RECEIVED
KANSAS CORPORATION COMMISSION

OCT 02 2007

CONSERVATION DIVISION
WICHITA, KS



KANSAS CORPORATION COMMISSION 1012208
OIL & GAS CONSERVATION DIVISION

Form CDP-1
April 2004
Form must be Typed

APPLICATION FOR SURFACE PIT

Submit in Duplicate

Operator Name: Oil Producers Inc. of Kansas		License Number: 8061	
Operator Address: 1710 WATERFRONT PKWY		WICHITA KS 67206	
Contact Person: Lori Zehr		Phone Number: 316-682-3022	
Lease Name & Well No.: Burr 1-4		Pit Location (QQQQ): _____ NW	
Type of Pit: <input type="checkbox"/> Emergency Pit <input type="checkbox"/> Burn Pit <input type="checkbox"/> Settling Pit <input checked="" type="checkbox"/> Drilling Pit <input type="checkbox"/> Workover Pit <input type="checkbox"/> Haul-Off Pit <small>(If WP Supply API No. or Year Drilled)</small>		Pit is: <input checked="" type="checkbox"/> Proposed <input type="checkbox"/> Existing If Existing, date constructed: _____ Pit capacity: 512 (bbls)	
Is the pit located in a Sensitive Ground Water Area? <input checked="" type="checkbox"/> Yes <input type="checkbox"/> No		Chloride concentration: _____ mg/l <small>(For Emergency Pits and Settling Pits only)</small>	
Is the bottom below ground level? <input checked="" type="checkbox"/> Yes <input type="checkbox"/> No		Artificial Liner? <input type="checkbox"/> Yes <input checked="" type="checkbox"/> No How is the pit lined if a plastic liner is not used? Mud Shale & Well bore	
Pit dimensions (all but working pits): _____ 80 _____ Length (feet) _____ 8 _____ Width (feet) _____ N/A: Steel Pits Depth from ground level to deepest point: _____ 6 _____ (feet) _____ No Pit			
If the pit is lined give a brief description of the liner material, thickness and installation procedure. Dig pit to above specifications and lay liner. Liner will be plastic and 6 mil in thickness.		Describe procedures for periodic maintenance and determining liner integrity, including any special monitoring. Field Supervisor will inspect on daily basis.	
Distance to nearest water well within one-mile of pit _____ 2919 _____ feet Depth of water well _____ 300 _____ feet		Depth to shallowest fresh water _____ 205 _____ feet. Source of information: <input type="checkbox"/> measured <input type="checkbox"/> well owner <input type="checkbox"/> electric log <input checked="" type="checkbox"/> KDWR	
Emergency, Settling and Burn Pits ONLY: Producing Formation: _____ Number of producing wells on lease: _____ Barrels of fluid produced daily: _____ Does the slope from the tank battery allow all spilled fluids to flow into the pit? <input type="checkbox"/> Yes <input type="checkbox"/> No		Drilling, Workover and Haul-Off Pits ONLY: Type of material utilized in drilling/workover: Chemical Number of working pits to be utilized: _____ 2 _____ Abandonment procedure: Evaporate & Restore Drill pits must be closed within 365 days of spud date.	
I hereby certify that the above statements are true and correct to the best of my knowledge and belief.			
10.1.07 Date		 Signature of Applicant or Agent	
KCC OFFICE USE ONLY			
Date Received: _____		Permit Number: _____	
Permit Date: _____		Lease Inspection: <input checked="" type="checkbox"/> Yes <input type="checkbox"/> No	

RECEIVED
KANSAS CORPORATION COMMISSION

CONSERVATION DIVISION
WICHITA, KS

15175-22114-0000



*Kathleen Sebelius, Governor
Thomas E. Wright, Chairman
Michael C. Moffet, Commissioner
Joseph F. Harkins, Commissioner*

September 28, 2007

Lori Zehr
Oil Producers Inc. of Kansas
1710 WATERFRONT PKWY
WICHITA, KS67206-6603

Re: Drilling Pit Application
Burr Lease Well No. 1-4
NW/4 Sec.04-33S-31W
Seward County, Kansas

Dear Lori Zehr:

District staff has inspected the above referenced location and has determined that the reserve pit shall be constructed **without slots**, the bottom shall be flat and reasonably level, and the free fluids must be removed. The fluids are to be removed from the reserve pit as soon as practical after drilling operations have ceased.

If production casing is set all completion fluids shall be removed from the working pits daily. NO completion fluids or non-exempt wastes shall be placed in the reserve pit.

The fluids should be taken to an authorized disposal well. Please call the District Office at (620) 225-8888 when the fluids have been removed. Please file form CDP-5 (August 2004), Exploration and Production Waste Transfer, within 30 days of fluid removal. Conservation division forms are available through our office and on the KCC web site:
kcc.ks.gov/conservation/forms/

A copy of this letter should be posted in the doghouse along with the approved Intent to Drill. If you have any questions or concerns please feel free to contact the District Office at (620) 225-8888.

RECEIVED
KANSAS CORPORATION COMMISSION

OCT 02 2007

CONSERVATION DIVISION
WICHITA, KS

CONSERVATION DIVISION
Finney State Office Building, 130 S. Market, Room 2078, Wichita, KS 67202-3802
(316) 337-6200 • Fax: (316) 337-6211 • <http://kcc.ks.gov/>