

For KCC Use:
 Effective Date: 10-10-07
 District #: 3
 SGA? Yes No

KANSAS CORPORATION COMMISSION
OIL & GAS CONSERVATION DIVISION
NOTICE OF INTENT TO DRILL

Form C-1
 December 2002
Form must be Typed
Form must be Signed
All blanks must be Filled

Must be approved by KCC five (5) days prior to commencing well

Expected Spud Date 10/2/07
 month day year

OPERATOR: License# 30345
 Name: Piqua Petro., Inc.
 Address: 1331 Xylan Road
Piqua, KS 66761
 Contact Person: Greg Lair
 Phone: 620-433-0099

CONTRACTOR: License# 32079
 Name: John E. Lels

<input checked="" type="checkbox"/> Oil	<input type="checkbox"/> Enh Rec	<input checked="" type="checkbox"/> Infield	<input checked="" type="checkbox"/> Mud Rotary
<input type="checkbox"/> Gas	<input type="checkbox"/> Storage	<input type="checkbox"/> Pool Ext.	<input type="checkbox"/> Air Rotary
<input type="checkbox"/> OWWO	<input type="checkbox"/> Disposal	<input type="checkbox"/> Wildcat	<input type="checkbox"/> Cable
<input type="checkbox"/> Seismic; # of Holes	<input type="checkbox"/> Other		
<input type="checkbox"/> Other			

If OWWO: old well information as follows:
 Operator: _____
 Well Name: _____
 Original Completion Date: _____ Original Total Depth: _____
 Directional, Deviated or Horizontal wellbore? Yes No
 If Yes, true vertical depth: _____
 Bottom Hole Location: _____
 KCC DKT #: _____

Spot East
 SE/4 NE/4 SE/4 Sec. 31 Twp. 23 S. R. 17 West
1340' feet from N / S Line of Section
300' feet from E / W Line of Section
 Is SECTION Regular Irregular?

(Note: Locate well on the Section Plat on reverse side)

County: Woodson
 Lease Name: Sylvia Ellis Well #: 12-07
 Field Name: Neosho Falls

Is this a Prorated / Spaced Field? Yes No

Target Formation(s): Squirrel

Nearest Lease or unit boundary: 300'

Ground Surface Elevation: N/A feet MSL

Water well within one-quarter mile: Yes No

Public water supply well within one mile: Yes No

Depth to bottom of fresh water: 125'

Depth to bottom of usable water: 150'

Surface Pipe by Alternate: 1 2

Length of Surface Pipe Planned to be set: 20'

Length of Conductor Pipe required: none

Projected Total Depth: 1150'

Formation at Total Depth: Squirrel

Water Source for Drilling Operations:
 Well Farm Pond Other

DWR Permit #: _____

(Note: Apply for Permit with DWR)

Will Cores be taken? Yes No

If Yes, proposed zone: _____

AFFIDAVIT

The undersigned hereby affirms that the drilling, completion and eventual plugging of this well will comply with K.S.A. 55 et. seq.

It is agreed that the following minimum requirements will be met:

1. Notify the appropriate district office **prior** to spudding of well;
2. A copy of the approved notice of intent to drill **shall be** posted on each drilling rig;
3. The minimum amount of surface pipe as specified below **shall be set** by circulating cement to the top; in all cases surface pipe **shall be set** through all unconsolidated materials plus a minimum of 20 feet into the underlying formation.
4. If the well is dry hole, an agreement between the operator and the district office on plug length and placement is necessary **prior to plugging**;
5. The appropriate district office will be notified before well is either plugged or production casing is cemented in;
6. If an ALTERNATE II COMPLETION, production pipe shall be cemented from below any usable water to surface within **120 days** of spud date.
 Or pursuant to Appendix "B" - Eastern Kansas surface casing order #133,891-C, which applies to the KCC District 3 area, alternate II cementing must be completed within 30 days of the spud date or the well shall be plugged. **In all cases, NOTIFY district office** prior to any cementing.

I hereby certify that the statements made herein are true and to the best of my knowledge and belief.

Date: 10/1/07 Signature of Operator or Agent: [Signature] Title: Secretary/Agent

Remember to:

- File Drill Pit Application (form CDP-1) with Intent to Drill;
- File Completion Form ACO-1 within 120 days of spud date;
- File acreage attribution plat according to field proration orders;
- Notify appropriate district office 48 hours prior to workover or re-entry;
- Submit plugging report (CP-4) after plugging is completed;
- Obtain written approval before disposing or injecting salt water.
- If this permit has expired (See: authorized expiration date) please check the box below and return to the address below.

Well Not Drilled - Permit Expired

Signature of Operator or Agent: _____

Date: _____

RECEIVED
 KANSAS CORPORATION COMMISSION

OCT 04 2007

Mail to: KCC - Conservation Division, 130 S. Market - Room 2078, Wichita, Kansas 67202

CONSERVATION DIVISION
 WICHITA, KS

For KCC Use ONLY
 API # 15 - 207-27289-0000
 Conductor pipe required None feet
 Minimum surface pipe required 20 feet per Alt. **XO 2**
 Approved by: [Signature]
 This authorization expires: 4-5-08
 (This authorization void if drilling not started within 6 months of approval date.)
 Spud date: _____ Agent: _____

IN ALL CASES PLOT THE INTENDED WELL ON THE PLAT BELOW

Plat of acreage attributable to a well in a prorated or spaced field

If the intended well is in a prorated or spaced field, please fully complete this side of the form. If the intended well is in a prorated or spaced field complete the plat below showing that the well will be properly located in relationship to other wells producing from the common source of supply. Please show all the wells and within 1 mile of the boundaries of the proposed acreage attribution unit for gas wells and within 1/2 mile of the boundaries of the proposed acreage attribution unit for oil wells.

API No. 15 207-27289 0000
 Operator: Piqua Petro., Inc.
 Lease: Sylvia Ellis
 Well Number: 12-07
 Field: Neosho Falls
 Number of Acres attributable to well: _____
 QTR / QTR / QTR of acreage: SE/4 - NE/4 - SE/4

Location of Well: County: Woodson
 1340' _____ feet from N / S Line of Section
 300' _____ feet from E / W Line of Section
 Sec. 31 Twp. 23 S. R. 17 East West

Is Section: Regular or Irregular

If Section is Irregular, locate well from nearest corner boundary.

Section corner used: NE NW SE SW

PLAT

*(Show location of the well and shade attributable acreage for prorated or spaced wells.)
 (Show footage to the nearest lease or unit boundary line.)*

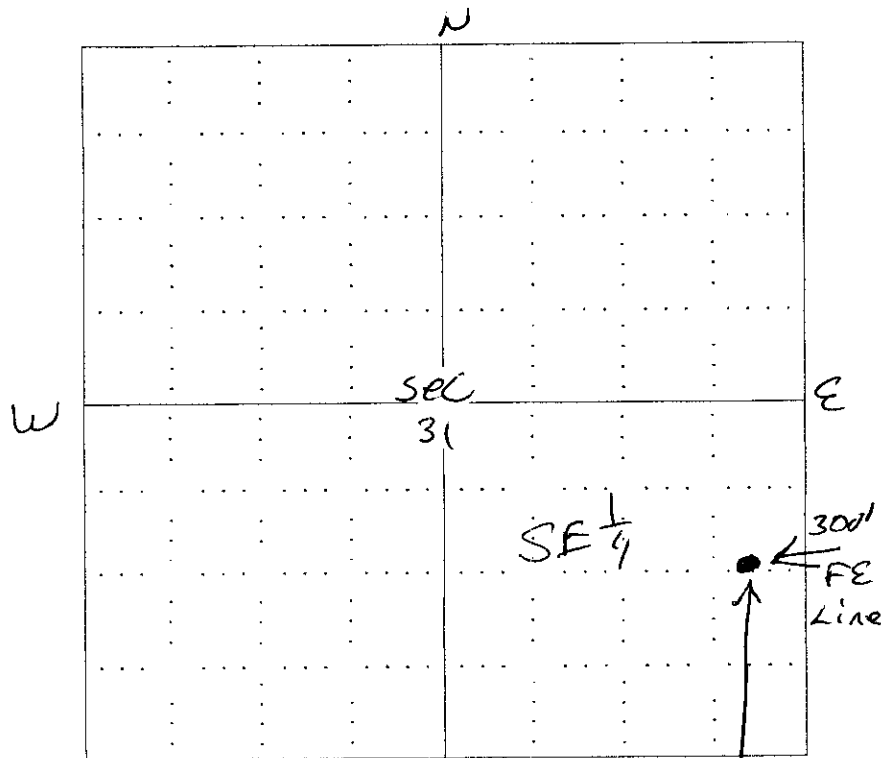

RECEIVED
 KANSAS CORPORATION COMMISSION
 OCT 04 2007
 CONSERVATION DIVISION
 WICHITA, KS

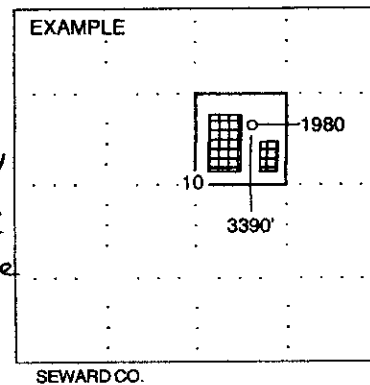

NOTE: In all cases locate the spot of the proposed drilling location.

In plotting the proposed location of the well, you must show:

1. The manner in which you are using the depicted plat by identifying section lines, i.e. 1 section, 1 section with 8 surrounding sections, 4 sections, etc.
2. The distance of the proposed drilling location from the section's south / north and east / west.
3. The distance to the nearest lease or unit boundary line.
4. If proposed location is located within a prorated or spaced field a certificate of acreage attribution plat must be attached: (CO-7 for oil wells; CG-8 for gas wells).

**KANSAS CORPORATION COMMISSION
OIL & GAS CONSERVATION DIVISION
APPLICATION FOR SURFACE PIT**

Form CDP-1
April 2004
Form must be Typed

Submit in Duplicate

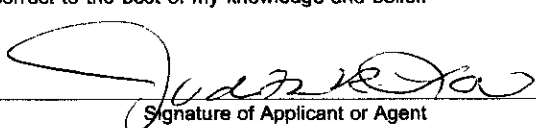
Operator Name: Piqua Petro., Inc.		License Number: 30345
Operator Address: 1331 Xylan Road		
Contact Person: Greg Lair		Phone Number: (620) 433 - 0099
Lease Name & Well No.: Sylvia Ellis N #12-07		Pit Location (QQQQ): SE/4 - NE/4 - SE/4
Type of Pit: <input type="checkbox"/> Emergency Pit <input type="checkbox"/> Burn Pit <input type="checkbox"/> Settling Pit <input checked="" type="checkbox"/> Drilling Pit <input type="checkbox"/> Workover Pit <input type="checkbox"/> Haul-Off Pit <small>(If WP Supply API No. or Year Drilled)</small>	Pit is: <input checked="" type="checkbox"/> Proposed <input type="checkbox"/> Existing If Existing, date constructed: _____ Pit capacity: _____ (bbls)	Sec. 31 Twp. 23 R. 17 <input checked="" type="checkbox"/> East <input type="checkbox"/> West 1340' Feet from <input type="checkbox"/> North / <input checked="" type="checkbox"/> South Line of Section 300' Feet from <input checked="" type="checkbox"/> East / <input type="checkbox"/> West Line of Section Woodson _____ County
Is the pit located in a Sensitive Ground Water Area? <input type="checkbox"/> Yes <input checked="" type="checkbox"/> No		Chloride concentration: _____ mg/l <small>(For Emergency Pits and Settling Pits only)</small>
Is the bottom below ground level? <input checked="" type="checkbox"/> Yes <input type="checkbox"/> No	Artificial Liner? <input type="checkbox"/> Yes <input checked="" type="checkbox"/> No	How is the pit lined if a plastic liner is not used? clay soil
Pit dimensions (all but working pits): 15' Length (feet) 8' Width (feet) N/A: Steel Pits Depth from ground level to deepest point: 3' (feet)		
If the pit is lined give a brief description of the liner material, thickness and installation procedure. N/A		Describe procedures for periodic maintenance and determining liner integrity, including any special monitoring. Watch that clay soil is holding water. <div style="text-align: right;">RECEIVED KANSAS CORPORATION COMMISSION OCT 04 2007 CONSERVATION DIVISION</div>
Distance to nearest water well within one-mile of pit 1000' feet Depth of water well 20' feet		Depth to shallowest fresh water 20' feet. WICHITA, KS Source of information: _____ measured <input checked="" type="checkbox"/> well owner _____ electric log _____ KDWR
Emergency, Settling and Burn Pits ONLY: Producing Formation: _____ Number of producing wells on lease: _____ Barrels of fluid produced daily: _____ Does the slope from the tank battery allow all spilled fluids to flow into the pit? <input type="checkbox"/> Yes <input type="checkbox"/> No		Drilling, Workover and Haul-Off Pits ONLY: Type of material utilized in drilling/workover: shale and limestone Number of working pits to be utilized: one Abandonment procedure: back fill back in _____ Drill pits must be closed within 365 days of spud date.
I hereby certify that the above statements are true and correct to the best of my knowledge and belief.		
_____ 10/2/07 Date		 _____ Signature of Applicant or Agent

15-207-07989-000

KCC OFFICE USE ONLY

Date Received: 10/4/07 Permit Number: _____ Permit Date: 10/4/07 Lease Inspection: Yes No

Mail to: KCC - Conservation Division, 130 S. Market - Room 2078, Wichita, Kansas 67202