

For KCC Use: 10-17-07
Effective Date: 10-17-07
District #: 4
SGA? Yes No

KANSAS CORPORATION COMMISSION
OIL & GAS CONSERVATION DIVISION
NOTICE OF INTENT TO DRILL

Form C-1
December 2002
Form must be Typed
Form must be Signed
All blanks must be Filled

Must be approved by KCC five (5) days prior to commencing well

Expected Spud Date 10 15 2007
month day year

OPERATOR: License# 6509
Name: Cla-Mar Oil Company
Address: P.O. Box 1197
City/State/Zip: Hays, Kansas 67601-1197
Contact Person: Jim Clark
Phone: 785-625-3863

CONTRACTOR: License# 33905
Name: Royal Drilling, Inc.

Well Drilled For:	Well Class:	Type Equipment:
<input checked="" type="checkbox"/> Oil	<input type="checkbox"/> Enh Rec	<input checked="" type="checkbox"/> Infield
<input type="checkbox"/> Gas	<input type="checkbox"/> Storage	<input type="checkbox"/> Pool Ext.
<input type="checkbox"/> OWWO	<input type="checkbox"/> Disposal	<input type="checkbox"/> Wildcat
<input type="checkbox"/> Seismic; # of Holes	<input type="checkbox"/> Other	<input type="checkbox"/> Cable
<input type="checkbox"/> Other		

If OWWO: old well information as follows:

Operator: _____
Well Name: _____
Original Completion Date: _____ Original Total Depth: _____

Directional, Deviated or Horizontal wellbore? Yes No

If Yes, true vertical depth: _____
Bottom Hole Location: _____
KCC DKT #: _____

Spot 40'N + 70'E
NW SW SW Sec. 11 Twp. 13 S. R. 19 East West
1030 feet from N / S Line of Section
400 feet from E / W Line of Section
Is SECTION Regular Irregular?

(Note: Locate well on the Section Plat on reverse side)

County: Ellis
Lease Name: Insley/Price Well #: 1
Field Name: _____

Is this a Prorated / Spaced Field? Yes No

Target Formation(s): Arbuckle

Nearest Lease or unit boundary: 400 feet MSL

Ground Surface Elevation: 2084 feet MSL

Water well within one-quarter mile: Yes No

Public water supply well within one mile: Yes No

Depth to bottom of fresh water: 180'

Depth to bottom of usable water: 650'

Surface Pipe by Alternate: 1 2 200'

Length of Surface Pipe Planned to be set: _____

Length of Conductor Pipe required: None

Projected Total Depth: 3850'

Formation at Total Depth: Arbuckle

Water Source for Drilling Operations:

Well Farm Pond Other _____

DWR Permit #: _____

(Note: Apply for Permit with DWR)

Will Cores be taken? Yes No

If Yes, proposed zone: _____

AFFIDAVIT

RECEIVED
KANSAS CORPORATION COMMISSION

The undersigned hereby affirms that the drilling, completion and eventual plugging of this well will comply with K.S.A. 55 et. seq.

It is agreed that the following minimum requirements will be met:

1. Notify the appropriate district office **prior** to spudding of well;
2. A copy of the approved notice of intent to drill **shall be** posted on each drilling rig;
3. The minimum amount of surface pipe as specified below **shall be set** by circulating cement to the top; in all cases surface pipe **shall be set** through all unconsolidated materials plus a minimum of 20 feet into the underlying formation.
4. If the well is dry hole, an agreement between the operator and the district office on plug length and placement is necessary **prior to plugging**;
5. The appropriate district office will be notified before well is either plugged or production casing is cemented in;
6. If an ALTERNATE II COMPLETION, production pipe shall be cemented from below any usable water to surface within **120 days** of spud date.
Or pursuant to Appendix "B" - Eastern Kansas surface casing order #133,891-C, which applies to the KCC District 3 area, alternate II cementing must be completed within 30 days of the spud date or the well shall be plugged. **In all cases, NOTIFY district office** prior to any cementing.

I hereby certify that the statements made herein are true and to the best of my knowledge and belief.

Date: 10/9/2007 Signature of Operator or Agent: Sherry Payne Title: Agent

For KCC Use ONLY
API # 15 - 051-25700-0000
Conductor pipe required NONE feet
Minimum surface pipe required 200 feet per Alt. (2)
Approved by: Wtm 10-12-07
This authorization expires: 4-12-08
(This authorization void if drilling not started within 6 months of approval date.)
Spud date: _____ Agent: _____

Remember to:

- File Drill Pit Application (form CDP-1) with Intent to Drill;
 - File Completion Form ACO-1 within 120 days of spud date;
 - File acreage attribution plat according to field proration orders;
 - Notify appropriate district office 48 hours prior to workover or re-entry;
 - Submit plugging report (CP-4) after plugging is completed;
 - Obtain written approval before disposing or injecting salt water.
- If this permit has expired (See: authorized expiration date) please check the box below and return to the address below.

Well Not Drilled - Permit Expired

Signature of Operator or Agent: _____

Date: _____

Mail to: KCC - Conservation Division, 130 S. Market - Room 2078, Wichita, Kansas 67202

11
13
19

**KANSAS CORPORATION COMMISSION
OIL & GAS CONSERVATION DIVISION
APPLICATION FOR SURFACE PIT**

Form CDP-1
April 2004
Form must be Typed

Submit in Duplicate

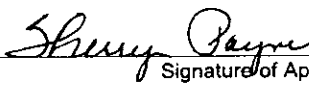
Operator Name: Cla-Mar Oil Company		License Number: 6509
Operator Address: P.O. Box 1197, Hays, Kansas 67601-1197		
Contact Person: Jim Clark		Phone Number: (785) 625 - 3863
Lease Name & Well No.: Insley/Price #1		Pit Location (QQQQ): 40' N 70' E NW SW SW
Type of Pit: <input type="checkbox"/> Emergency Pit <input type="checkbox"/> Burn Pit <input type="checkbox"/> Settling Pit <input checked="" type="checkbox"/> Drilling Pit <input type="checkbox"/> Workover Pit <input type="checkbox"/> Haul-Off Pit <small>(If WP Supply API No. or Year Drilled)</small>	Pit is: <input checked="" type="checkbox"/> Proposed <input type="checkbox"/> Existing If Existing, date constructed: _____ Pit capacity: _____ 400 (bbls)	Sec. 11 Twp. 13S R. 19 <input type="checkbox"/> East <input checked="" type="checkbox"/> West 1030 Feet from <input type="checkbox"/> North / <input checked="" type="checkbox"/> South Line of Section 400 Feet from <input type="checkbox"/> East / <input checked="" type="checkbox"/> West Line of Section Ellis County
Is the pit located in a Sensitive Ground Water Area? <input type="checkbox"/> Yes <input checked="" type="checkbox"/> No		Chloride concentration: _____ mg/l <small>(For Emergency Pits and Settling Pits only)</small>
Is the bottom below ground level? <input checked="" type="checkbox"/> Yes <input type="checkbox"/> No	Artificial Liner? <input type="checkbox"/> Yes <input checked="" type="checkbox"/> No	How is the pit lined if a plastic liner is not used? Native Mud
Pit dimensions (all but working pits): 80 Length (feet) 80 Width (feet) N/A: Steel Pits Depth from ground level to deepest point: 6 (feet)		
If the pit is lined give a brief description of the liner material, thickness and installation procedure.		Describe procedures for periodic maintenance and determining liner integrity, including any special monitoring. <div style="text-align: right;">RECEIVED KANSAS CORPORATION COMMISSION OCT 12 2007 CONSERVATION DIVISION</div>
Distance to nearest water well within one-mile of pit 2087 feet Depth of water well 55 feet		Depth to shallowest fresh water 180 29 feet. Source of information: _____ measured <input checked="" type="checkbox"/> well owner _____ electric log <input checked="" type="checkbox"/> KDWR
Emergency, Settling and Burn Pits ONLY: Producing Formation: _____ Number of producing wells on lease: _____ Barrels of fluid produced daily: _____ Does the slope from the tank battery allow all spilled fluids to flow into the pit? <input type="checkbox"/> Yes <input type="checkbox"/> No		Drilling, Workover and Haul-Off Pits ONLY: Type of material utilized in drilling/workover: Fresh Mud Number of working pits to be utilized: 3 Abandonment procedure: Allow to dry and backfill Drill pits must be closed within 365 days of spud date.
I hereby certify that the above statements are true and correct to the best of my knowledge and belief.		
Date: 10/9/2007		Signature of Applicant or Agent: 

15-051-25780-0000

KCC OFFICE USE ONLY			
Date Received: 10/12/07	Permit Number: _____	Permit Date: 10/12/07	Lease Inspection: <input type="checkbox"/> Yes <input checked="" type="checkbox"/> No

Mail to: KCC - Conservation Division, 130 S. Market - Room 2078, Wichita, Kansas 67202

IN ALL CASES PLOT THE INTENDED WELL ON THE PLAT BELOW

Plat of acreage attributable to a well in a prorated or spaced field

If the intended well is in a prorated or spaced field, please fully complete this side of the form. If the intended well is in a prorated or spaced field complete the plat below showing that the well will be properly located in relationship to other wells producing from the common source of supply. Please show all the wells and within 1 mile of the boundaries of the proposed acreage attribution unit for gas wells and within 1/2 mile of the boundaries of the proposed acreage attribution unit for oil wells.

API No. 15 - 051-25700-0000
 Operator: Cla-Mar Oil Company
 Lease: Insley/Price
 Well Number: 1
 Field: _____
 Number of Acres attributable to well: _____
 QTR / QTR / QTR of acreage: NW - SW - SW

Location of Well: County: Ellis

 1030 feet from N / S Line of Section

 400 feet from E / W Line of Section
 Sec. 11 Twp. 13 S. R. 19 East West

Is Section: Regular or Irregular

If Section is Irregular, locate well from nearest corner boundary.
 Section corner used: NE NW SE SW

PLAT

*(Show location of the well and shade attributable acreage for prorated or spaced wells.)
 (Show footage to the nearest lease or unit boundary line.)*

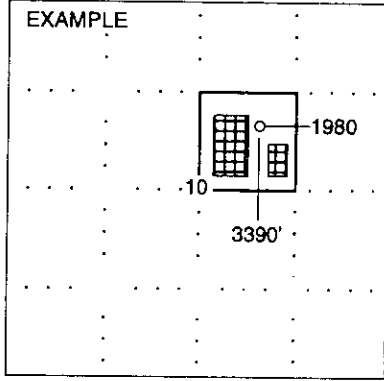
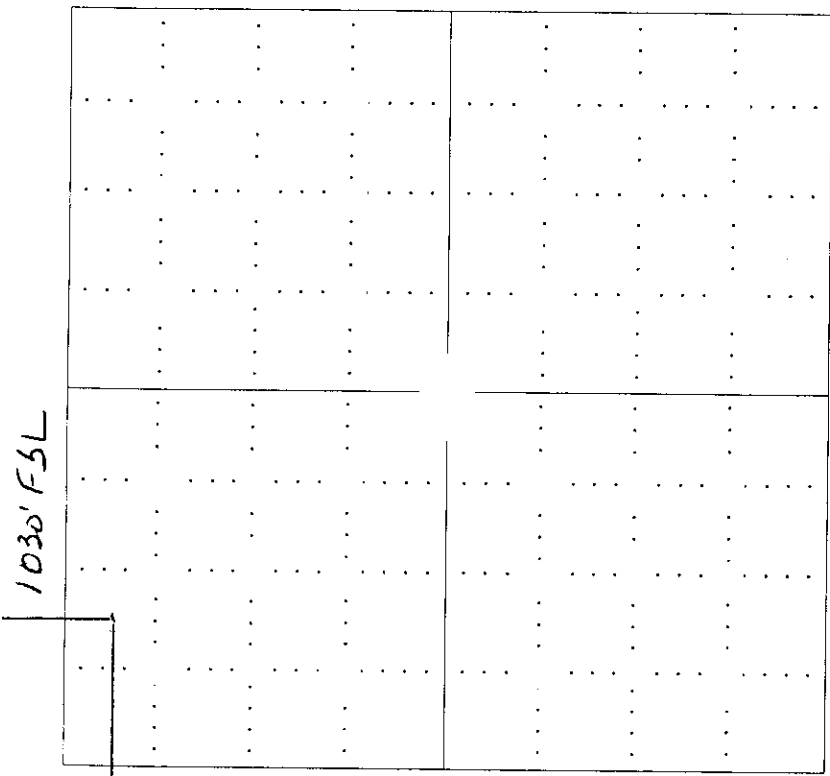

NOTE: In all cases locate the spot of the proposed drilling locaton.

400' FWL

In plotting the proposed location of the well, you must show:

1. The manner in which you are using the depicted plat by identifying section lines, i.e. 1 section, 1 section with 8 surrounding sections, 4 sections, etc.
2. The distance of the proposed drilling location from the section's south / north and east / west.
3. The distance to the nearest lease or unit boundary line.
4. If proposed location is located within a prorated or spaced field a certificate of acreage attribution plat must be attached: (CO-7 for oil wells; CG-8 for gas wells).