

For KCC Use: 10-21-07
 Effective Date: _____
 District # 1
 SGA? Yes No

KANSAS CORPORATION COMMISSION 1012940
 OIL & GAS CONSERVATION DIVISION

Form C-1
 November 2005
 Form must be Typed
 Form must be Signed
 All blanks must be Filled

NOTICE OF INTENT TO DRILL
 Must be approved by KCC five (5) days prior to commencing well

Expected Spud Date: 10/18/2007
 month day year

OPERATOR: License# 5316
 Name: Falcon Exploration, Inc.
 Address 1: 125 N MARKET STE 1252
 Address 2: _____
 City: WICHITA State: KS Zip: 67202 + 1719
 Contact Person: RON SCHRAEDER/MIKE MITCHELL
 Phone: 316-262-1378
 CONTRACTOR: License# 5822
 Name: Val Energy, Inc.

Well Drilled For:	Well Class:	Type Equipment:
<input checked="" type="checkbox"/> Oil	<input type="checkbox"/> Enh Rec	<input checked="" type="checkbox"/> Mud Rotary
<input checked="" type="checkbox"/> Gas	<input type="checkbox"/> Storage	<input type="checkbox"/> Air Rotary
<input type="checkbox"/> Seismic ; _____ # of Holes	<input type="checkbox"/> Disposal	<input type="checkbox"/> Cable
<input type="checkbox"/> Other: _____	<input type="checkbox"/> Wildcat	
	<input type="checkbox"/> Other	

If OWWO: old well information as follows:
 Operator: _____
 Well Name: _____
 Original Completion Date: _____ Original Total Depth: _____

Directional, Deviated or Horizontal wellbore? Yes No
 If Yes, true vertical depth: _____
 Bottom Hole Location: _____
 KCC DKT #: _____

Spot Description: _____
 SW - NE - SW - NE Sec. 10 Twp. 31 S. R. 22 E W
 (or (or)) 1,880 feet from N / S Line of Section
1,680 feet from E / W Line of Section

Is SECTION: Regular Irregular?
 (Note: Locate well on the Section Plat on reverse side)
 County: Clark

Lease Name: GILES RANCH Well #: 3-10
 Field Name: Fish Creek

Is this a Prorated / Spaced Field? Yes No
 Target Formation(s): MORROW;MISSISSIPPIAN

Nearest Lease or unit boundary line (in footage): 760
 Ground Surface Elevation: 2154 feet MSL

Water well within one-quarter mile: Yes No
 Public water supply well within one mile: Yes No

Depth to bottom of fresh water: 120
 Depth to bottom of usable water: 180

Surface Pipe by Alternate: I II
 Length of Surface Pipe Planned to be set: 200

Length of Conductor Pipe (if any): 0
 Projected Total Depth: 5400

Formation at Total Depth: MISSISSIPPIAN
 Water Source for Drilling Operations:

Well Farm Pond Other: _____
 DWR Permit #: _____

(Note: Apply for Permit with DWR)
 Will Cores be taken? Yes No

If Yes, proposed zone: _____

AFFIDAVIT

The undersigned hereby affirms that the drilling, completion and eventual plugging of this well will comply with K.S.A. 55 et. seq.
 It is agreed that the following minimum requirements will be met:

1. Notify the appropriate district office **prior** to spudding of well;
2. A copy of the approved notice of intent to drill **shall be** posted on each drilling rig;
3. The minimum amount of surface pipe as specified below **shall be set** by circulating cement to the top; in all cases surface pipe **shall be set** through all unconsolidated materials plus a minimum of 20 feet into the underlying formation.
4. If the well is dry hole, an agreement between the operator and the district office on plug length and placement is necessary **prior to plugging**;
5. The appropriate district office will be notified before well is either plugged or production casing is cemented in;
6. If an ALTERNATE II COMPLETION, production pipe shall be cemented from below any usable water to surface within **120 DAYS** of spud date. Or pursuant to Appendix "B" - Eastern Kansas surface casing order #133,891-C, which applies to the KCC District 3 area, alternate II cementing must be completed within 30 days of the spud date or the well shall be plugged. **In all cases, NOTIFY district office** prior to any cementing.

I hereby certify that the statements made herein are true and to the best of my knowledge and belief.

Date: 10/15/07 Signature of Operator or Agent: [Signature] Title: Engineer

For KCC Use ONLY
 API # 15 - 025-21432-0000
 Conductor pipe required 0 feet
 Minimum surface pipe required 200 feet per ALT I II
 Approved by: [Signature]
 This authorization expires: 4-16-08
 (This authorization void if drilling not started within 6 months of approval date.)
 Spud date: _____ Agent: _____

Remember to:

- File Drill Pit Application (form CDP-1) with Intent to Drill;
- File Completion Form ACO-1 within 120 days of spud date;
- File acreage attribution plat according to field proration orders;
- Notify appropriate district office 48 hours prior to workover or re-entry;
- Submit plugging report (CP-4) after plugging is completed (within 60 days);
- Obtain written approval before disposing or injecting salt water.
- If this permit has expired (See: authorized expiration date) please check the box below and return to the address below.

Well Not Drilled - Permit Expired Date: RECEIVED
 Signature of Operator or Agent: _____ KANSAS CORPORATION COMMISSION

Mail to: KCC - Conservation Division, 130 S. Market - Room 2078, Wichita, Kansas 67202

OCT 16 2007

CONSERVATION DIVISION
 WICHITA, KS

10
31
22
 E W



1012940

IN ALL CASES PLOT THE INTENDED WELL ON THE PLAT BELOW

Plat of acreage attributable to a well in a prorated or spaced field

If the intended well is in a prorated or spaced field, please fully complete this side of the form. If the intended well is in a prorated or spaced field complete the plat below showing that the well will be properly located in relationship to other wells producing from the common source of supply. Please show all the wells and within 1 mile of the boundaries of the proposed acreage attribution unit for gas wells and within 1/2 mile of the boundaries of the proposed acreage attribution unit for oil wells.

API No. 15 - 025-21432-0000

Operator: Falcon Exploration, Inc.

Lease: GILES RANCH

Well Number: 3-10

Field: Fish Creek

Number of Acres attributable to well: _____

QTR/QTR/QTR/QTR of acreage: SW - NE - SW - NE

Location of Well: County: Clark

1,880 feet from N / S Line of Section

1,680 feet from E / W Line of Section

Sec. 10 Twp. 31 S. R. 22 E W

Is Section: Regular or Irregular

If Section is Irregular, locate well from nearest corner boundary.

Section corner used: NE NW SE SW

PLAT

(Show location of the well and shade attributable acreage for prorated or spaced wells.)
(Show footage to the nearest lease or unit boundary line.)

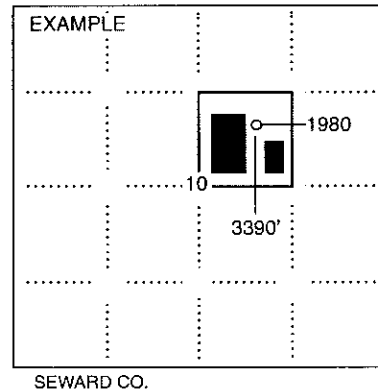
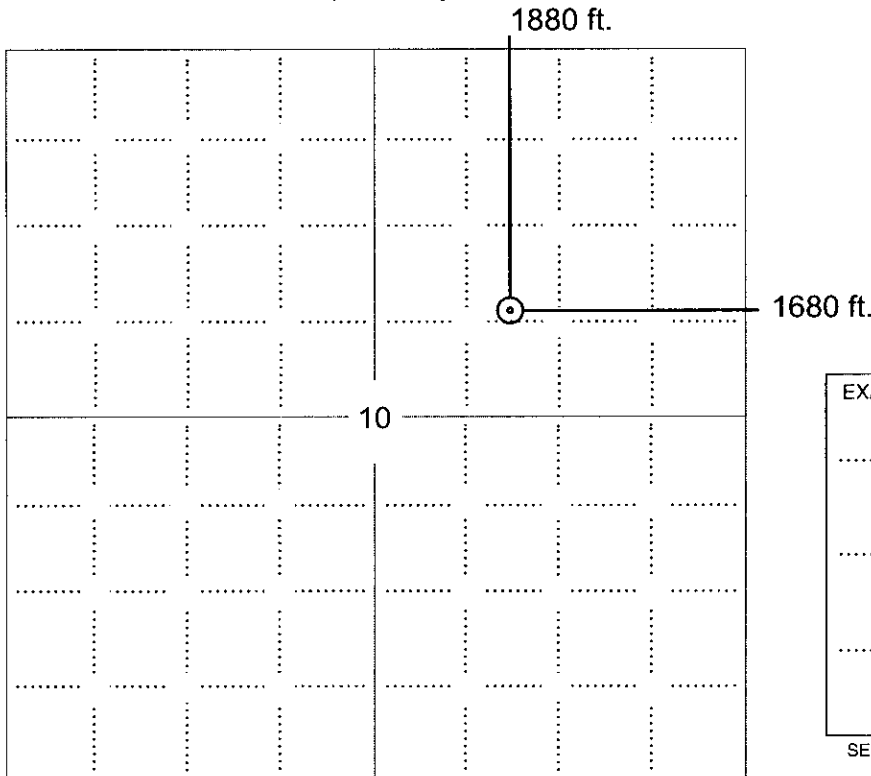

NOTE: In all cases locate the spot of the proposed drilling location.

In plotting the proposed location of the well, you must show:

1. The manner in which you are using the depicted plat by identifying section lines, i.e. 1 section, 1 section with 8 surrounding sections, 4 sections, etc.
2. The distance of the proposed drilling location from the south / north and east / west outside section lines.
3. The distance to the nearest lease or unit boundary line (in footage).
4. If proposed location is located within a prorated or spaced field a certificate of acreage attribution plat must be attached (KANSAS CORPORATION COMMISSION CG-8 for gas wells).

RECEIVED
KANSAS CORPORATION COMMISSION

OCT 16 2007

CONSERVATION DIVISION
WICHITA, KS



KANSAS CORPORATION COMMISSION 1012940
OIL & GAS CONSERVATION DIVISION

Form CDP-1
April 2004
Form must be Typed

APPLICATION FOR SURFACE PIT

Submit in Duplicate

Operator Name: Falcon Exploration, Inc.		License Number: 5316
Operator Address: 125 N MARKET STE 1252		WICHITA KS 67202
Contact Person: RON SCHRAEDER/MIKE MITCHELL		Phone Number: 316-262-1378
Lease Name & Well No.: GILES RANCH 3-10		Pit Location (QQQQ): SW NE SW NE Sec. 10 Twp. 31 R. 22 <input type="checkbox"/> East <input checked="" type="checkbox"/> West 1,880 Feet from <input checked="" type="checkbox"/> North / <input type="checkbox"/> South Line of Section 1,680 Feet from <input checked="" type="checkbox"/> East / <input type="checkbox"/> West Line of Section Clark County
Type of Pit: <input type="checkbox"/> Emergency Pit <input type="checkbox"/> Burn Pit <input type="checkbox"/> Settling Pit <input checked="" type="checkbox"/> Drilling Pit <input type="checkbox"/> Workover Pit <input type="checkbox"/> Haul-Off Pit <small>(If WP Supply API No. or Year Drilled)</small>	Pit is: <input checked="" type="checkbox"/> Proposed <input type="checkbox"/> Existing If Existing, date constructed: _____ Pit capacity: 5,600 (bbls)	
Is the pit located in a Sensitive Ground Water Area? <input checked="" type="checkbox"/> Yes <input type="checkbox"/> No		Chloride concentration: _____ mg/l <small>(For Emergency Pits and Settling Pits only)</small>
Is the bottom below ground level? <input checked="" type="checkbox"/> Yes <input type="checkbox"/> No	Artificial Liner? <input type="checkbox"/> Yes <input checked="" type="checkbox"/> No	How is the pit lined if a plastic liner is not used? NATIVE CLAY AND MUD
Pit dimensions (all but working pits): 80 Length (feet) 100 Width (feet) <input type="checkbox"/> N/A: Steel Pits Depth from ground level to deepest point: 4 (feet) <input type="checkbox"/> No Pit		
If the pit is lined give a brief description of the liner material, thickness and installation procedure.		Describe procedures for periodic maintenance and determining liner integrity, including any special monitoring.
Distance to nearest water well within one-mile of pit 852 feet Depth of water well 80 feet	Depth to shallowest fresh water 35 feet. Source of information: <input type="checkbox"/> measured <input type="checkbox"/> well owner <input type="checkbox"/> electric log <input checked="" type="checkbox"/> KDWR	RECEIVED KANSAS CORPORATION COMMISSION OCT 16 2007 CONSERVATION DIVISION WICHITA, KS
Emergency, Settling and Burn Pits ONLY: Producing Formation: _____ Number of producing wells on lease: _____ Barrels of fluid produced daily: _____ Does the slope from the tank battery allow all spilled fluids to flow into the pit? <input type="checkbox"/> Yes <input type="checkbox"/> No	Drilling, Workover and Haul-Off Pits ONLY: Type of material utilized in drilling/workover: CHEMICAL MUD Number of working pits to be utilized: 3 Abandonment procedure: LET DRY COMPLETELY. THEN BACKFILL WHEN CONDITIONS ALLOW. Drill pits must be closed within 365 days of spud date.	
I hereby certify that the above statements are true and correct to the best of my knowledge and belief. <div style="display: flex; justify-content: space-between;"> <div style="text-align: center;"> 10/15/07 Date </div> <div style="text-align: center;"> Signature of Applicant or Agent </div> </div>		

15025-21422-0000

KCC OFFICE USE ONLY		Steel Pit <input type="checkbox"/>	RFAC <input checked="" type="checkbox"/>	RFAS <input checked="" type="checkbox"/>
Date Received: 10/16/07	Permit Number: _____	Permit Date: 10/16/07	Lease Inspection: <input type="checkbox"/> Yes <input checked="" type="checkbox"/> No	

Mail to: KCC - Conservation Division, 130 S. Market - Room 2078, Wichita, Kansas 67202



*Kathleen Sebelius, Governor
Thomas E. Wright, Chairman
Michael C. Moffet, Commissioner
Joseph F. Harkins, Commissioner*

October 15, 2007

RON SCHRAEDER/MIKE MITCHELL
Falcon Exploration, Inc.
125 N MARKET STE 1252
WICHITA, KS67202-1719

Re: Drilling Pit Application
GILES RANCH Lease Well No. 3-10
NE/4 Sec.10-31S-22W
Clark County, Kansas

Dear RON SCHRAEDER/MIKE MITCHELL:

District staff has inspected the above referenced location and has determined that the reserve pit shall be constructed **without slots**, the bottom shall be flat and reasonably level and the free fluids must be removed. The fluids are to be removed from the reserve pit as soon as the Hutchinson Salt section has been drilled through and displacement of the fluids into the reserve pit has occurred. The fluids should be removed again as soon as practical after drilling operations have ceased.

If production casing is set all completion fluids shall be removed from the working pits daily. NO completion fluids or non-exempt wastes shall be placed in the reserve pit.

The fluids should be taken to an authorized disposal well. Please call the District Office at (620) 225-8888 when the fluids have been removed. Please file form CDP-5 (August 2004), Exploration and Production Waste Transfer, within 30 days of fluid removal. Conservation division forms are available through our office and on the KCC web site: kcc.ks.gov/conservation/forms/

A copy of this letter should be posted in the doghouse along with the approved Intent to Drill. If you have any questions or concerns please feel free to contact the District Office at (620) 225-8888.

RECEIVED
KANSAS CORPORATION COMMISSION
OCT 16 2007
CONSERVATION DIVISION
WICHITA, KS

CONSERVATION DIVISION
Finney State Office Building, 130 S. Market, Room 2078, Wichita, KS 67202-3802
(316) 337-6200 • Fax: (316) 337-6211 • <http://kcc.ks.gov/>