



For KCC Use:  
 Effective Date: 10-22-07  
 District # 1  
 SGA?  Yes  No

KANSAS CORPORATION COMMISSION 1012982  
 OIL & GAS CONSERVATION DIVISION

Form C-1  
 November 2005  
 Form must be Typed  
 Form must be Signed  
 All blanks must be Filled

**NOTICE OF INTENT TO DRILL**  
 Must be approved by KCC five (5) days prior to commencing well

Expected Spud Date: 10/17/2007  
month day year

OPERATOR: License# 5278  
 Name: EOG Resources, Inc.  
 Address 1: 3817 NW EXPRESSWAY STE 500  
 Address 2: \_\_\_\_\_  
 City: OKLAHOMA CITY State: OK Zip: 73112 + 1483  
 Contact Person: Melissa Sturm  
 Phone: 405-246-3234  
 CONTRACTOR: License# 34000  
 Name: Kenai Mid-Continent, Inc.

Spot Description: \_\_\_\_\_  
 NE - SW - NE - SW Sec. 12 Twp. 32 S. R. 36  E  W  
(N20°10')  
1,700 feet from  N /  S Line of Section  
1,860 feet from  E /  W Line of Section

Is SECTION:  Regular  Irregular?  
 (Note: Locate well on the Section Plat on reverse side)

County: Stevens  
 Lease Name: Caliber Well #: 12 #1  
 Field Name: Wildcat

Is this a Prorated / Spaced Field?  Yes  No  
 Target Formation(s): St. Louis

Nearest Lease or unit boundary line (in footage): 1700  
 Ground Surface Elevation: 3043 feet MSL

Water well within one-quarter mile:  Yes  No  
 Public water supply well within one mile:  Yes  No

Depth to bottom of fresh water: 580  
 Depth to bottom of usable water: 580

Surface Pipe by Alternate:  I  II  
 Length of Surface Pipe Planned to be set: 1700

Length of Conductor Pipe (if any): 40  
 Projected Total Depth: 6400

Formation at Total Depth: St. Louis  
 Water Source for Drilling Operations:  
 Well  Farm Pond  Other: \_\_\_\_\_

DWR Permit #: \_\_\_\_\_  
 (Note: Apply for Permit with DWR )

Will Cores be taken?  Yes  No  
 If Yes, proposed zone: \_\_\_\_\_

Well Drilled For:  Oil  Gas  Seismic  Other: \_\_\_\_\_  
 Well Class:  Enh Rec  Storage  Disposal  Other: \_\_\_\_\_  
 Type Equipment:  Mud Rotary  Air Rotary  Cable  Infield  Pool Ext.  Wildcat  Other: \_\_\_\_\_

If OWWO: old well information as follows:  
 Operator: \_\_\_\_\_  
 Well Name: \_\_\_\_\_  
 Original Completion Date: \_\_\_\_\_ Original Total Depth: \_\_\_\_\_

Directional, Deviated or Horizontal wellbore?  Yes  No  
 If Yes, true vertical depth: \_\_\_\_\_  
 Bottom Hole Location: \_\_\_\_\_  
 KCC DKT #: \_\_\_\_\_

**PRORATED & SPACED: HUGOTON-PANOMA**  
PVPA 100701

**AFFIDAVIT**

RECEIVED

The undersigned hereby affirms that the drilling, completion and eventual plugging of this well will comply with K.S.A. 55-1101. It is agreed that the following minimum requirements will be met:

OCT 17 2007

CONSERVATION DIVISION  
 WICHITA, KS

1. Notify the appropriate district office **prior** to spudding of well;
2. A copy of the approved notice of intent to drill **shall be** posted on each drilling rig;
3. The minimum amount of surface pipe as specified below **shall be set** by circulating cement to the top; in all cases surface pipe shall be cemented through all unconsolidated materials plus a minimum of 20 feet into the underlying formation.
4. If the well is dry hole, an agreement between the operator and the district office on plug length and placement is necessary **prior to plugging**;
5. The appropriate district office will be notified before well is either plugged or production casing is cemented in;
6. If an ALTERNATE II COMPLETION, production pipe shall be cemented from below any usable water to surface within **120 DAYS** of spud date. Or pursuant to Appendix "B" - Eastern Kansas surface casing order #133,891-C, which applies to the KCC District 3 area, alternate II cementing must be completed within 30 days of the spud date or the well shall be plugged. **In all cases, NOTIFY district office** prior to any cementing.

I hereby certify that the statements made herein are true and to the best of my knowledge and belief.

Date: 10-16-07 Signature of Operator or Agent: Melissa Sturm Title: Sr. Operations Asst.

**For KCC Use ONLY**  
 API # 15 - 189-22619-0000  
 Conductor pipe required 0 feet  
 Minimum surface pipe required 600 feet per ALT.  I  II  
 Approved by: 10/17/07  
 This authorization expires: 4-17-08  
(This authorization void if drilling not started within 6 months of approval date.)  
 Spud date: \_\_\_\_\_ Agent: \_\_\_\_\_

**Remember to:**

- File Drill Pit Application (form CDP-1) with Intent to Drill;
- File Completion Form ACO-1 within 120 days of spud date;
- File acreage attribution plat according to field proration orders;
- Notify appropriate district office 48 hours prior to workover or re-entry;
- Submit plugging report (CP-4) after plugging is completed (within 60 days);
- Obtain written approval before disposing or injecting salt water.
- If this permit has expired (See: authorized expiration date) please check the box below and return to the address below.

Well Not Drilled - Permit Expired Date: \_\_\_\_\_  
 Signature of Operator or Agent: \_\_\_\_\_

12  
32  
36  
 E  
 W



1012982

**IN ALL CASES PLOT THE INTENDED WELL ON THE PLAT BELOW**

*Plat of acreage attributable to a well in a prorated or spaced field*

**If the intended well is in a prorated or spaced field, please fully complete this side of the form.** If the intended well is in a prorated or spaced field complete the plat below showing that the well will be properly located in relationship to other wells producing from the common source of supply. Please show all the wells and within 1 mile of the boundaries of the proposed acreage attribution unit for gas wells and within 1/2 mile of the boundaries of the proposed acreage attribution unit for oil wells.

API No. 15 - 189-22619-0000  
Operator: EOG Resources, Inc.  
Lease: Caliber  
Well Number: 12 #1  
Field: Wildcat

Location of Well: County: Stevens  
1,700 feet from  N /  S Line of Section  
1,860 feet from  E /  W Line of Section  
Sec. 12 Twp. 32 S. R. 36  E  W

Number of Acres attributable to well: \_\_\_\_\_  
QTR/QTR/QTR/QTR of acreage:  NE  SW  NE  SW

Is Section:  Regular or  Irregular

**If Section is Irregular, locate well from nearest corner boundary.**

Section corner used:  NE  NW  SE  SW

**PLAT**

*(Show location of the well and shade attributable acreage for prorated or spaced wells.)*

*(Show footage to the nearest lease or unit boundary line.)*

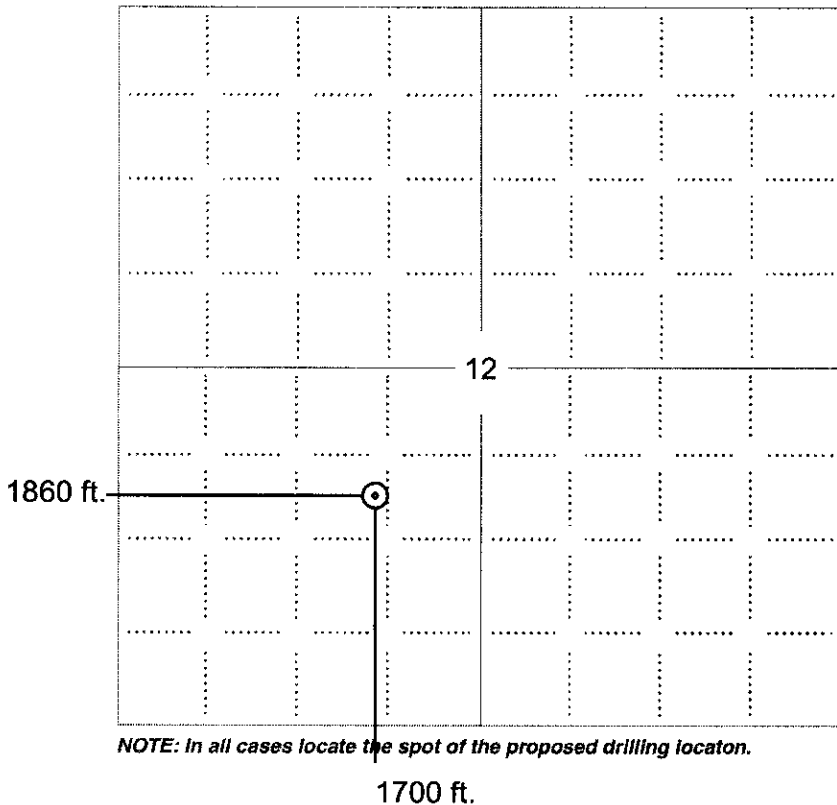

**NOTE: In all cases locate the spot of the proposed drilling location.**

RECEIVED  
KANSAS CORPORATION COMMISSION  
**OCT 17 2007**  
CONSERVATION DIVISION  
WICHITA, KS

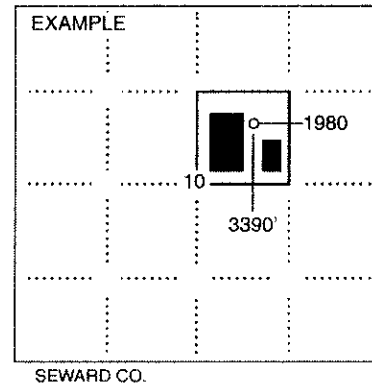

**In plotting the proposed location of the well, you must show:**

1. The manner in which you are using the depicted plat by identifying section lines, i.e. 1 section, 1 section with 8 surrounding sections, 4 sections, etc.
2. The distance of the proposed drilling location from the south / north and east / west outside section lines.
3. The distance to the nearest lease or unit boundary line (in footage).
4. If proposed location is located within a prorated or spaced field a certificate of acreage attribution plat must be attached: (CO-7 for oil wells; CG-8 for gas wells).



KANSAS CORPORATION COMMISSION 1012982  
OIL & GAS CONSERVATION DIVISION

Form GDP-1  
April 2004  
Form must be Typed

**APPLICATION FOR SURFACE PIT**

Submit in Duplicate

Operator Name: <b>EOG Resources, Inc.</b>		License Number: <b>5278</b>	
Operator Address: <b>3817 NW EXPRESSWAY STE 500</b>		OKLAHOMA CITY OK <b>73112</b>	
Contact Person: <b>Melissa Sturm</b>		Phone Number: <b>405-246-3234</b>	
Lease Name & Well No.: <b>Caliber 12 #1</b>		Pit Location (QQQQ): <b>NE SW NE SW</b>	
Type of Pit: <input type="checkbox"/> Emergency Pit <input type="checkbox"/> Burn Pit <input type="checkbox"/> Settling Pit <input checked="" type="checkbox"/> Drilling Pit <input type="checkbox"/> Workover Pit <input type="checkbox"/> Haul-Off Pit <small>(If WP Supply API No. or Year Drilled)</small>		Pit is: <input checked="" type="checkbox"/> Proposed <input type="checkbox"/> Existing If Existing, date constructed: _____ Pit capacity: <b>12,500</b> (bbbls)	
Is the pit located in a Sensitive Ground Water Area? <input type="checkbox"/> Yes <input checked="" type="checkbox"/> No		Chloride concentration: _____ mg/l <small>(For Emergency Pits and Settling Pits only)</small>	
Is the bottom below ground level? <input checked="" type="checkbox"/> Yes <input type="checkbox"/> No		Artificial Liner? <input type="checkbox"/> Yes <input checked="" type="checkbox"/> No	
How is the pit lined if a plastic liner is not used? <b>Steel</b>			
Pit dimensions (all but working pits): _____ Length (feet) _____ Width (feet)		<input checked="" type="checkbox"/> N/A: Steel Pits	
Depth from ground level to deepest point: _____ (feet)		<input type="checkbox"/> No Pit	
If the pit is lined give a brief description of the liner material, thickness and installation procedure.		Describe procedures for periodic maintenance and determining liner integrity, including any special monitoring.	
		RECEIVED KANSAS CORPORATION COMMISSION <b>OCT 17 2007</b> CONSERVATION DIVISION WICHITA, KS	
Distance to nearest water well within one-mile of pit <b>666</b> feet    Depth of water well <b>500</b> feet		Depth to shallowest fresh water <b>187</b> feet. Source of information: <input type="checkbox"/> measured <input type="checkbox"/> well owner <input type="checkbox"/> electric log <input checked="" type="checkbox"/> KDWR	
<b>Emergency, Settling and Burn Pits ONLY:</b> Producing Formation: _____ Number of producing wells on lease: _____ Barrels of fluid produced daily: _____ Does the slope from the tank battery allow all spilled fluids to flow into the pit? <input type="checkbox"/> Yes <input type="checkbox"/> No		<b>Drilling, Workover and Haul-Off Pits ONLY:</b> Type of material utilized in drilling/workover: <u>Gel</u> Number of working pits to be utilized: <u>0</u> Abandonment procedure: <u>Haul to haul-off pit</u> Drill pits must be closed within 365 days of spud date.	
I hereby certify that the above statements are true and correct to the best of my knowledge and belief.			
<u>10-16-07</u> Date		<u>Melissa Sturm</u> Signature of Applicant or Agent	
<b>KCC OFFICE USE ONLY</b>			
		Steel Pit <input checked="" type="checkbox"/> RFAC <input checked="" type="checkbox"/> RFAS <input type="checkbox"/>	
Date Received: <u>10/17/07</u> Permit Number: _____		Permit Date: <u>10/17/07</u> Lease Inspection: <input type="checkbox"/> Yes <input checked="" type="checkbox"/> No	

15-189-22019-0020



*Kathleen Sebelius, Governor  
Thomas E. Wright, Chairman  
Michael C. Moffet, Commissioner  
Joseph F. Harkins, Commissioner*

October 16, 2007

EOG Resources, Inc.  
3817 NW Expressway Ste 500  
Oklahoma City, OK 73112-1483

RE: Drilling Pit Application  
Caliber 12 Lease Well No. 1  
SW/4 Sec. 12-32S-36W  
Stevens County, Kansas

Dear Sir or Madam:

According to the drilling pit application referenced above, no earthen pits are to be used at this location. Steel pits are to be used. Please inform the Commission in writing as to which disposal well you utilized to dispose of the contents in the steel pits and the amount of fluid that was disposed. Please file form CDP-5 (August 2004), Exploration and Production Waste Transfer, within 30 days of fluid removal.

Should a haul-off pit be necessary please file form CDP-1 (April 2004), Application for Surface Pit. This location will have to be inspected prior to approval of the haul-off pit application. Conservation division forms are available through our office and on the KCC web site: [www.kcc.state.ks.us/conservation/forms](http://www.kcc.state.ks.us/conservation/forms).

**A copy of this letter should be posted in the doghouse along with the approved Intent to Drill.** If you have any questions or concerns please feel free to contact the District Office at (620) 225-8888.

RECEIVED  
KANSAS CORPORATION COMMISSION

OCT 17 2007

CONSERVATION DIVISION  
WICHITA, KS

CONSERVATION DIVISION  
Finney State Office Building, 130 S. Market, Room 2078, Wichita, KS 67202-3802  
(316) 337-6200 • Fax: (316) 337-6211 • <http://kcc.ks.gov/>



15-189-22619-0000  
PVPA 100701

**EOG Resources, Inc.**  
3817 NW Expressway  
Suite 500  
Oklahoma City, OK 73112-1483  
(405) 246-3100

October 16, 2007

Mr. Rick Hestermann  
Kansas Corporation Commission  
Conservation Division  
Wichita State Office Building  
130 S. Market, Room 2078  
Wichita, KS 67202-3802

Re: BPO Mud Affidavit  
Caliber 12 #1  
Sec 12-32S-36W  
Stevens County  
1700' FSL & 1860' FWL

RECEIVED  
KANSAS CORPORATION COMMISSION

OCT 17 2007

CONSERVATION DIVISION  
WICHITA, KS

Dear Mr. Hestermann:

Enclosed is a C-1 Notice of Intent to Drill with a BPO Mud Affidavit. We understand the 15-day period is not yet up, but we are requesting that the permit be approved. If the VPA-1 Mud Affidavit were to be protested, we understand that we will be required to cement across the interval between the base of the Council Grove group and the top of the Chase group of the Panoma Council Grove BPO.

If you have any questions or concerns, please contact me at (405) 246-3234.

Thank you,

  
Melissa Sturm  
Sr. Operations Assistant

PVPA 100701

KANSAS CORPORATION COMMISSION  
CONSERVATION DIVISION  
130 S. Market - Room 2078  
Wichita, Kansas 67202

Form VPA-1  
4/01

VERIFIED AFFIDAVIT FOR USE OF MUD AS AN  
ALTERNATIVE TO THE CEMENTING REQUIREMENT IN ¶18(D)  
OF THE PANOMA COUNCIL GROVE B.P.O.

FORM MUST BE TYPED

Submit in Duplicate  
Attach to Drilling Permit

Operator Name EOG Resources, Inc.				KCC License No. 5278	
Operator Address 3817 NW Expressway Suite #500 Oklahoma City, OK 73112					
Contact Person Melissa Sturm				Telephone No. (405) 246-3234	
Lease Name & No. Caliber 12 #1		API No. 15-189-22619-000		KCC Lease Code No.	
Location Quarter SW/4	Section 12	Township 32S	Range 36	1700 E (W) (circle one) 1860	FL from N (S) (circle one) Line of Sec. FL from E (W) (circle one) Line of Sec.
County Stevens	Field Name Wildcat	Producing Formation Group St. Louis		Mud Weight 8.7	

**AFFIDAVIT CERTIFICATE OF SERVICE**

All requirements of the statutes, rules and regulations promulgated to regulate the oil and gas industry have been fully complied with and the statements here are complete and correct to the best of my knowledge. The well subscribed to in this Affidavit will be completed in accordance with all applicable rules and regulations of the KCC. However, applicant intends to use drilling mud of sufficient weight across the interval between the base of the Council Grove Group and the top of the Chase Group as an alternative to the cementing requirements found in paragraph 18(D) of the Panoma Council Grove B.P.O. unless an objection is filed within 15 days of service of this Affidavit. I hereby certify that I caused a true and correct copy of the foregoing Affidavit and any attachments of said Affidavit to be served by placing the same in the United States mail, postage prepaid, to the following parties, which represent all of the operators or lessees of record and the owners of record of unleased acreage within a one mile radius of the well, including operators and working interest owners having interests in the lands covered by the unit on which the well is to be drilled:

RECEIVED  
KANSAS CORPORATION COMMISSION

OCT 17 2007

CONSERVATION DIVISION  
WICHITA, KS

Signature Melissa Sturm Date 10-16-07

Title Sr. Operations Asst.

Subscribed and sworn to before me this 16<sup>th</sup> day of October, 2007.

Notary Public Kaye Dawn Rockel

Date Commission Expires

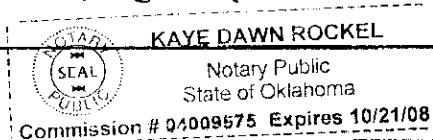

15-189-22619-0000

PVPA 100701

**Exhibit "A"**  
**Caliber 12 #1**  
**Section 12-32S-36W**  
**Stevens County, Kansas**

Page 1 of 1

1. ExxonMobil Production Company  
P.O. Box 4610  
Houston, TX 77210-4610

**End of Exhibit "A"**

RECEIVED  
KANSAS CORPORATION COMMISSION

OCT 17 2007

CONSERVATION DIVISION  
WICHITA, KS



*Kathleen Sebelius, Governor  
Thomas E. Wright, Chairman  
Robert E. Krehbiel, Commissioner  
Michael C. Moffet, Commissioner*

October 17, 2007

Melissa Sturm  
EOG Resources, Inc.  
3817 NW Expressway, Suite 500  
Oklahoma City, OK 73112

Re: Caliber 12 #1, API #15-189-22619-0000  
Docket # PVPA 100701  
SW Sec. 12-T32S-R36W  
Stevens County, Kansas

Dear Ms. Sturm,

The form VPA-1 affidavit filed for the above-referenced well stated that service of the affidavit was mailed on October 16, 2007. The fifteen (15) day protest period has not expired. Per your letter of October 16, 2007, EOG Resources, Inc. anticipates spudding this well before the fifteen-day protest period has expired. EOG Resources, Inc. also stipulates that should any protests be received before the protest period has expired, the cementing required across the Council Grove and Chase Formations per the Panoma-Council Grove Proration Order will be done. Therefore, we are advising you that the drilling of this well may commence and, unless protests to your VPA-1 are received, drilling mud of the weight specified in your affidavit may be used across the interval between the base of the Council Grove group and the top of the Chase group.

Sincerely,

A handwritten signature in black ink, appearing to read "Rick Hestermann", with a long horizontal stroke extending to the right.

Rick Hestermann  
Production Department

CONSERVATION DIVISION

Finney State Office Building, 130 S. Market, Room 2078, Wichita, KS 67202-3802  
(316) 337-6200 • Fax: (316) 337-6211 • <http://kcc.ks.gov/>