

CORRECTED

CORRECTED  
107707

Form C-1

December 2002

Form must be Typed

Form must be Signed

All blanks must be Filled

For KCC Use: 9-16-07  
Effective Date: 9-16-07  
District #: 3  
SGA?  Yes  No

KANSAS CORPORATION COMMISSION  
OIL & GAS CONSERVATION DIVISION

NOTICE OF INTENT TO DRILL

Must be approved by KCC five (5) days prior to commencing well

Expected Spud Date 9/14/07  
month day year

OPERATOR: License# 33539  
Name: Cherokee Wells, LLC  
Address: P.O. Box 298  
City/State/Zip: Fredonia, KS 66736  
Contact Person: Tracy Miller  
Phone: (620) 378-3650

CONTRACTOR: License# 33072  
Name: Well Refined Drilling

Well Drilled For:  Oil  Enh Rec  Gas  CMO  Seismic  Other  
Well Class:  Infield  Pool Ext  Wildcat  Other  
Type Equipment:  Mud Rotary  Air Rotary  Cable

If OWWO: old well information as follows:  
Operator: \_\_\_\_\_  
Well Name: \_\_\_\_\_  
Original Completion Date: \_\_\_\_\_ Original Total Depth: \_\_\_\_\_

Directional, Deviated or Horizontal wellbore?  Yes  No  
If Yes, true vertical depth: \_\_\_\_\_  
Bottom Hole Location: \_\_\_\_\_  
KCC DKT #: \_\_\_\_\_

Spot SW NE SW' Sec. 5 Twp. 29 S. R. 13  
1700 feet from N / S Line of Section  
\* 1970 feet from E / W Line of Section  
Is SECTION  Regular  Irregular?

(Note: Locate well on the Section Plat on reverse side)  
County: Elk

Lease Name: Cross Well #: A-1  
Field Name: Cherokee Basin Coal Gas Area

Is this a Prorated / Spaced Field?  Yes  No  
Target Formation(s): Mississippian

Nearest Lease or unit boundary: 1660'  
Ground Surface Elevation: Unknown feet MSL

Water well within one-quarter mile:  Yes  No  
Public water supply well within one mile:  Yes  No

Depth to bottom of fresh water: 100+  
Depth to bottom of usable water: 225'

Surface Pipe by Alternate:  1  2  
Length of Surface Pipe Planned to be set: 40' Minimum

Length of Conductor Pipe required: N/A  
Projected Total Depth: 1350'

Formation at Total Depth: Mississippian  
Water Source for Drilling Operations:  
 Well  Farm Pond  Other

DWR Permit #: \_\_\_\_\_  
(Note: Apply for Permit with DWR )

Will Cores be taken?  Yes  No  
If Yes, proposed zone: \_\_\_\_\_

\* WAS: 1660 FWL  
IS: 1970' FWL

AFFIDAVIT

RECEIVED

The undersigned hereby affirms that the drilling, completion and eventual plugging of this well will comply with K.S.A. 55 et. seq. It is agreed that the following minimum requirements will be met:

OCT 16 2007

- 1. Notify the appropriate district office prior to spudding of well;
- 2. A copy of the approved notice of intent to drill shall be posted on each drilling rig;
- 3. The minimum amount of surface pipe as specified below shall be set by circulating cement to the top; in all cases surface pipe shall be set through all unconsolidated materials plus a minimum of 20 feet into the underlying formation.
- 4. If the well is dry hole, an agreement between the operator and the district office on plug length and placement is necessary prior to plugging;
- 5. The appropriate district office will be notified before well is either plugged or production casing is cemented in;
- 6. If an ALTERNATE II COMPLETION, production pipe shall be cemented from below any usable water to surface within 120 days of spud date. Or pursuant to Appendix "B" - Eastern Kansas surface casing order #133,891-C, which applies to the KCC District 3 area, alternate II cementing must be completed within 30 days of the spud date or the well shall be plugged. In all cases, NOTIFY district offices prior to any cementing.

I hereby certify that the statements made herein are true and to the best of my knowledge and belief.  
Date: 9/6/07 Signature of Operator or Agent: Tracy Miller Title: Administrative Assistant

For KCC Use ONLY  
API # 15 - 049-22468-00-00  
Conductor pipe required None feet  
Minimum surface pipe required 40 feet per Alt. X (2)  
Approved by: SB 9-11-07/mtt 107707  
This authorization expires: 3-11-08  
(This authorization void if drilling not started within 6 months of approval date.)  
Spud date: \_\_\_\_\_ Agent: \_\_\_\_\_

Remember to:

- File Drill Pit Application (form GDP-1) with intent to Drill;
- File Completion Form ACO-1 within 120 days of spud date;
- File acreage attribution plat according to field proration orders;
- Notify appropriate district office 48 hours prior to workover or re-entry;
- Submit plugging report (CP-4) after plugging is completed;
- Obtain written approval before disposing or injecting.
- If this permit has expired (See: authorized expiration date) please check the box below and return to the address below.

Well Not Drilled - Permit Expired  
Signature of Operator or Agent: \_\_\_\_\_ Date: \_\_\_\_\_

Mail to: KCC - Conservation Division, 130 S. Market - Room 2078, Wichita, Kansas 67202

RECEIVED  
KANSAS CORPORATION COMMISSION  
OCT 10 2007  
WICHITA, KS

# IN ALL CASES PLOT THE INTENDED WELL ON THE PLAT BELOW **CORRECTED**

Plat of acreage attributable to a well in a prorated or spaced field

If the intended well is in a prorated or spaced field, please fully complete this side of the form. If the intended well is in a prorated or spaced field complete the plat below showing that the well will be properly located in relationship to other wells producing from the common source of supply. Please show all the wells and within 1 mile of the boundaries of the proposed acreage attribution unit for gas wells and within 1/2 mile of the boundaries of the proposed acreage attribution unit for oil wells.

API No. 15 - 099-22468-00-00

Operator: Cherokee Wells, LLC

Lease: Cross

Well Number: A-1

Field: Cherokee Basin Coal Gas Area

Number of Acres attributable to well: \_\_\_\_\_

QTR / QTR / QTR of acreage: SW - NE - SW

Location of Well: County: Eik

1700 feet from  N /  S Line of Section

\* 1000 1970 feet from  E /  W Line of Section

Sec. 5 Twp. 29 S. R. 13  East  West

Is Section:  Regular or  Irregular

If Section is Irregular, locate well from nearest corner boundary.

Section corner used:  NE  NW  SE  SW

### PLAT

(Show location of the well and shade attributable acreage for prorated or spaced wells.)  
(Show footage to the nearest lease or unit boundary line.)

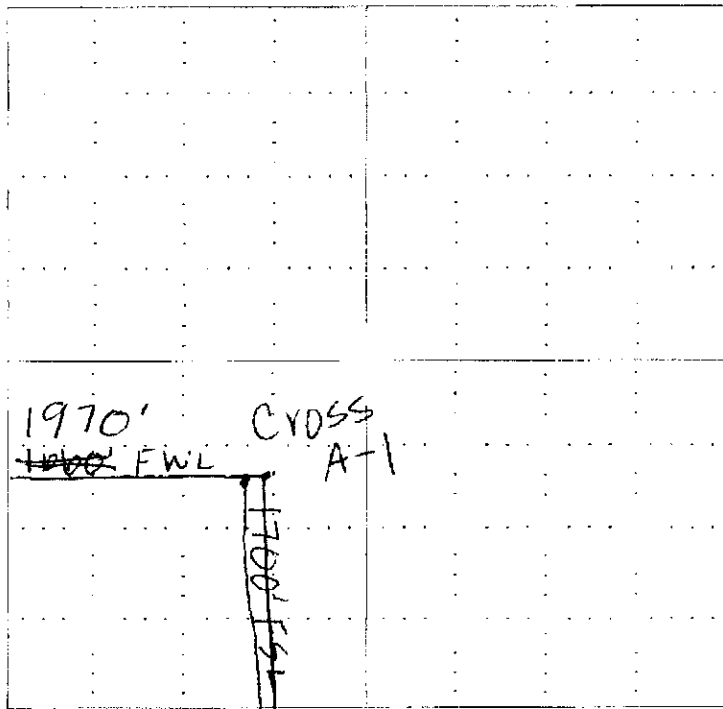

RECEIVED  
KANSAS CORPORATION COMMISSION  
**OCT 16 2007**  
CONSERVATION DIVISION  
WICHITA, KS

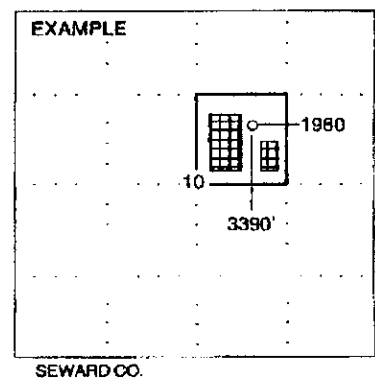

NOTE: In all cases locate the spot of the proposed drilling location.

#### In plotting the proposed location of the well, you must show:

- The manner in which you are using the depicted plat by identifying section lines, i.e. 1 section, 1 section with 8 surrounding sections, 4 sections, etc.
- The distance of the proposed drilling location from the section's south / north and east / west.
- The distance to the nearest lease or unit boundary line.
- If proposed location is located within a prorated or spaced field a certificate of acreage attribution plat must be attached (CG-8 for gas wells).

RECEIVED  
KANSAS CORPORATION COMMISSION  
**SEP 10 2007**  
CONSERVATION DIVISION  
WICHITA, KS

**KANSAS CORPORATION COMMISSION  
OIL & GAS CONSERVATION DIVISION  
APPLICATION FOR SURFACE PIT**

Form GDP-1  
April 2004  
Form must be Typed

*Submit in Duplicate*

**CORRECTED**

Operator Name: <b>Cherokee Wells, LLC</b>		License Number: <b>33539</b>
Operator Address: <b>P.O. Box 296, Fredonia, KS 66736</b>		
Contact Person: <b>Tracy Miller</b>		Phone Number: ( <b>620</b> ) <b>378 - 3650</b>
Lease Name & Well No.: <b>Cross A-1</b>		Pit Location (QQQQ): <b>SW NE SW</b>
Type of Pit: <input type="checkbox"/> Emergency Pit <input type="checkbox"/> Burn Pit <input type="checkbox"/> Settling Pit <input checked="" type="checkbox"/> Drilling Pit <input type="checkbox"/> Workover Pit <input type="checkbox"/> Haul-Off Pit <small>(If WP Supply API No. or Year Drilled)</small>	Pit is: <input checked="" type="checkbox"/> Proposed <input type="checkbox"/> Existing If Existing, date constructed: Pit capacity: <b>800</b> (bbls)	Sec. <b>5</b> Twp. <b>29</b> R. <b>13</b> <input checked="" type="checkbox"/> East <input type="checkbox"/> West <b>1700</b> Feet from <input type="checkbox"/> North / <input checked="" type="checkbox"/> South Line of Section <b>* 1600-1970'</b> Feet from <input type="checkbox"/> East / <input checked="" type="checkbox"/> West Line of Section <b>Elk</b> County
Is the pit located in a Sensitive Ground Water Area? <input type="checkbox"/> Yes <input checked="" type="checkbox"/> No		Chloride concentration: _____ mg/l <small>(For Emergency Pits and Settling Pits only)</small>
Is the bottom below ground level? <input checked="" type="checkbox"/> Yes <input type="checkbox"/> No	Artificial Liner? <input type="checkbox"/> Yes <input checked="" type="checkbox"/> No	How is the pit lined if a plastic liner is not used? <b>Natural Clay &amp; Earth</b>
Pit dimensions (all but working pits): <b>30</b> Length (feet) <b>40</b> Width (feet) <b>N/A: Steel Pits</b> Depth from ground level to deepest point: <b>6</b> (feet)		
If the pit is lined give a brief description of the liner material, thickness and installation procedure.		Describe procedures for periodic maintenance and determine liner integrity, including any special monitoring.
		<b>RECEIVED</b> KANSAS CORPORATION COMMISSION <b>OCT 16 2007</b> CONSERVATION DIVISION WICHITA, KS
Distance to nearest water well within one-mile of pit <b>N/A</b> feet    Depth of water well _____ feet	Depth to shallowest fresh water <b>est. 100+</b> feet. Source of information: _____ measured    _____ well owner <input checked="" type="checkbox"/> electric log    _____ KDWR	
<b>Emergency, Settling and Burn Pits ONLY:</b> Producing Formation: _____ Number of producing wells on lease: _____ Barrels of fluid produced daily: _____ Does the slope from the tank battery allow all spilled fluids to flow into the pit? <input checked="" type="checkbox"/> Yes <input type="checkbox"/> No	<b>Drilling, Workover and Haul-Off Pits ONLY:</b> Type of material utilized in drilling/workover: <b>Fresh Water</b> Number of working pits to be utilized: <b>One</b> Abandonment procedure: <b>Remove Fluids, Allow to Dry and Level Surface</b> Drill pits must be closed within 365 days of spud date.	
I hereby certify that the above statements are true and correct to the best of my knowledge and belief.		
_____ 9/6/07 Date	_____ <i>Tracy Miller</i> Signature of Applicant or Agent	

15-049-22468-00-00

<b>KCC OFFICE USE ONLY</b>			
Date Received: <b>9/10/07</b>	Permit Number: _____	Permit Date: <b>9/10/07</b>	Lease Inception Date: <b>10/16/07</b> <input type="checkbox"/> Yes <input checked="" type="checkbox"/> No

Mail to: KCC - Conservation Division, 130 S. Market - Room 2078, Wichita, Kansas 67202

**RECEIVED**  
KANSAS CORPORATION COMMISSION  
**SEP 10 2007**  
CONSERVATION DIVISION  
WICHITA, KS