

RECEIVED

KANSAS CORPORATION COMMISSION

For KCC Use:

Effective Date: 10-22-07

District #: 3

SGA? [X] Yes [] No

OIL & GAS CONSERVATION DIVISION

NOTICE OF INTENT TO DRILL

Must be approved by KCC five (5) days prior to commencing work.

OCT 17 2007

Form C-1

December 2002

Form must be Typed

Form must be Signed

All blanks must be Filled

Expected Spud Date: October 24, 2007

OPERATOR: License# Quest Cherokee LLC 33344

Name: Quest Cherokee LLC

Address: 9520 North May Avenue, Suite 300

City/State/Zip: Oklahoma City, Oklahoma 73120

Contact Person: Richard Marlin

Phone: (405) 463-6880

CONTRACTOR: License# Will be licensed by the KCC

Name: Will advise on the ACO-1

Well Drilled For: Oil, Gas, OWWO, Seismic, Other. Well Class: Infield, Pool Ext, Wildcat, Other. Type Equipment: Mud Rotary, Air Rotary, Cable.

If OWWO: old well information as follows:

Operator:

Well Name:

Original Completion Date: Original Total Depth:

Directional, Deviated or Horizontal wellbore? [] Yes [X] No

If Yes, true vertical depth:

Bottom Hole Location:

KCC DKT #:

Spot NW SE Sec. 25 Twp. 29 S. R. 15

1980 feet from N / S Line of Section

1980 feet from E / W Line of Section

Is SECTION Regular Irregular?

(Note: Locate well on the Section Plat on reverse side)

County: Wilson

Lease Name: Floyd, John E. Well #: 25-2

Field Name: Cherokee Basin CBM

Is this a Prorated / Spaced Field? [] Yes [X] No

Target Formation(s): Cherokee Coals

Nearest Lease or unit boundary: 660

Ground Surface Elevation: 960 feet MSL

Water well within one-quarter mile: [] Yes [X] No

Public water supply well within one mile: [] Yes [X] No

Depth to bottom of fresh water: 100

Depth to bottom of usable water: 200-150

Surface Pipe by Alternate: [] 1 [X] 2

Length of Surface Pipe Planned to be set: 25

Length of Conductor Pipe required:

Projected Total Depth: 1500

Formation at Total Depth: Cherokee Coals

Water Source for Drilling Operations:

[] Well [] Farm Pond Other Air

DWR Permit #:

(Note: Apply for Permit with DWR [])

Will Cores be taken? [] Yes [X] No

If Yes, proposed zone:

AFFIDAVIT

The undersigned hereby affirms that the drilling, completion and eventual plugging of this well will comply with K.S.A. 55 et. seq.

It is agreed that the following minimum requirements will be met:

- 1. Notify the appropriate district office prior to spudding of well;
2. A copy of the approved notice of intent to drill shall be posted on each drilling rig;
3. The minimum amount of surface pipe as specified below shall be set by circulating cement to the top;
4. If the well is dry hole, an agreement between the operator and the district office on plug length and placement is necessary prior to plugging;
5. The appropriate district office will be notified before well is either plugged or production casing is cemented in;
6. If an ALTERNATE II COMPLETION, production pipe shall be cemented from below any usable water to surface within 120 days of spud date.

I hereby certify that the statements made herein are true and to the best of my knowledge and belief.

Date: October 16, 2007 Signature of Operator or Agent: Richard Marlin Title: VP

For KCC Use ONLY
API # 15 - 205-27334-0000
Conductor pipe required None feet
Minimum surface pipe required 20 feet per Alt. 2
Approved by: RH101707
This authorization expires: 4-17-08

Remember to:

- File Drill Pit Application (form CDP-1) with Intent to Drill;
- File Completion Form ACO-1 within 120 days of spud date;
- File acreage attribution plat according to field proration orders;
- Notify appropriate district office 48 hours prior to workover or re-entry;
- Submit plugging report (CP-4) after plugging is completed;
- Obtain written approval before disposing or injecting salt water.

[] Well Not Drilled - Permit Expired

Signature of Operator or Agent:

Date:

Mail to: KCC - Conservation Division, 130 S. Market - Room 2078, Wichita, Kansas 67202

Handwritten notes: 25, 29, 15E

IN ALL CASES PLOT THE INTENDED WELL ON THE PLAT BELOW

Plat of acreage attributable to a well in a prorated or spaced field

If the intended well is in a prorated or spaced field, please fully complete this side of the form. If the intended well is in a prorated or spaced field complete the plat below showing that the well will be properly located in relationship to other wells producing from the common source of supply. Please show all the wells and within 1 mile of the boundaries of the proposed acreage attribution unit for gas wells and within 1/2 mile of the boundaries of the proposed acreage attribution unit for oil wells.

API No. 15 - 205-27334-0000
 Operator: Quest Cherokee LLC
 Lease: Floyd, John E.
 Well Number: 25-2
 Field: Cherokee Basin CBM
 Number of Acres attributable to well: _____
 QTR / QTR / QTR of acreage: _____ - NW - SE

Location of Well: County: Wilson
1980 feet from N / S Line of Section
1980 feet from E / W Line of Section
 Sec. 25 Twp. 29 S. R. 15 East West
 Is Section: Regular or Irregular
If Section is Irregular, locate well from nearest corner boundary.
 Section corner used: NE NW SE SW

PLAT

*(Show location of the well and shade attributable acreage for prorated or spaced wells.)
 (Show footage to the nearest lease or unit boundary line.)*

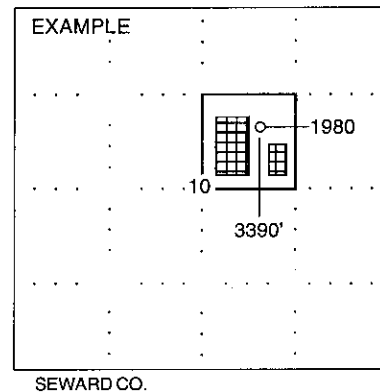
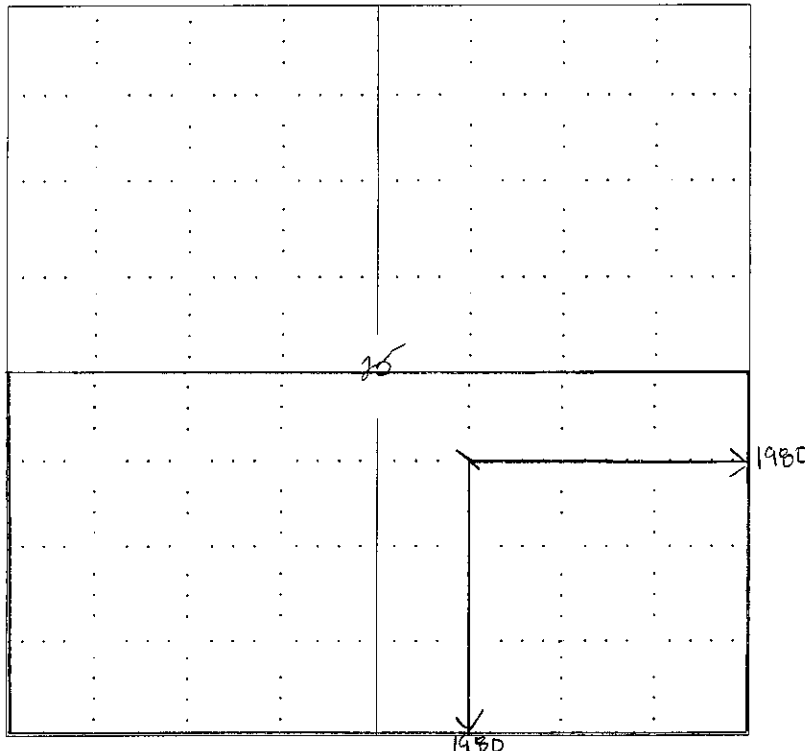

NOTE: In all cases locate the spot of the proposed drilling location.

In plotting the proposed location of the well, you must show:

1. The manner in which you are using the depicted plat by identifying section lines, i.e. 1 section, 1 section with 8 surrounding sections, 4 sections, etc.
2. The distance of the proposed drilling location from the section's south / north and east / west.
3. The distance to the nearest lease or unit boundary line.
4. If proposed location is located within a prorated or spaced field a certificate of acreage attribution plat must be attached: (CO-7 for oil wells; CG-8 for gas wells).

**KANSAS CORPORATION COMMISSION
OIL & GAS CONSERVATION DIVISION
APPLICATION FOR SURFACE PIT**

RECEIVED
KANSAS CORPORATION COMMISSION
Form CDP-1
April 2004
Form must be Typed

OCT 17 2007

CONSERVATION DIVISION
WICHITA, KS

Submit in Duplicate

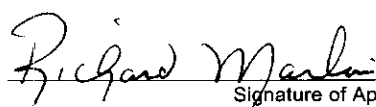
Operator Name: Quest Cherokee LLC		License Number: 33344
Operator Address: 9520 North May Avenue, Suite 300 Oklahoma City, Oklahoma 73120		
Contact Person: Richard Marlin		Phone Number: (405) 463 - 6880
Lease Name & Well No.: Floyd, John E. #25-2		Pit Location (QQQQ): _____ NW _____ SE Sec. <u>25</u> Twp. <u>29</u> R. <u>15</u> <input checked="" type="checkbox"/> East <input type="checkbox"/> West <u>1980</u> Feet from <input type="checkbox"/> North / <input checked="" type="checkbox"/> South Line of Section <u>1980</u> Feet from <input checked="" type="checkbox"/> East / <input type="checkbox"/> West Line of Section Wilson _____ County
Type of Pit: <input type="checkbox"/> Emergency Pit <input type="checkbox"/> Burn Pit <input type="checkbox"/> Settling Pit <input checked="" type="checkbox"/> Drilling Pit <input type="checkbox"/> Workover Pit <input type="checkbox"/> Haul-Off Pit <small>(If WP Supply API No. or Year Drilled)</small>	Pit is: <input checked="" type="checkbox"/> Proposed <input type="checkbox"/> Existing If Existing, date constructed: _____ Pit capacity: <u>300</u> (bbls)	
Is the pit located in a Sensitive Ground Water Area? <input checked="" type="checkbox"/> Yes <input checked="" type="checkbox"/> No		Chloride concentration: _____ mg/l <small>(For Emergency Pits and Settling Pits only)</small>
Is the bottom below ground level? <input type="checkbox"/> Yes <input checked="" type="checkbox"/> No	Artificial Liner? <input type="checkbox"/> Yes <input checked="" type="checkbox"/> No	How is the pit lined if a plastic liner is not used?
Pit dimensions (all but working pits): <u>30</u> Length (feet) <u>10</u> Width (feet) _____ N/A: Steel Pits Depth from ground level to deepest point: <u>10</u> (feet)		
If the pit is lined give a brief description of the liner material, thickness and installation procedure.		Describe procedures for periodic maintenance and determining liner integrity, including any special monitoring. Air Drilling Operation lasting approx 3 days
Distance to nearest water well within one-mile of pit <u>N/A</u> feet Depth of water well _____ feet	Depth to shallowest fresh water _____ feet. Source of information: _____ measured _____ well owner _____ electric log _____ KDWR	
Emergency, Settling and Burn Pits ONLY: Producing Formation: _____ Number of producing wells on lease: _____ Barrels of fluid produced daily: _____ Does the slope from the tank battery allow all spilled fluids to flow into the pit? <input type="checkbox"/> Yes <input type="checkbox"/> No	Drilling, Workover and Haul-Off Pits ONLY: Type of material utilized in drilling/workover: <u>Air Drilled</u> Number of working pits to be utilized: <u>One</u> Abandonment procedure: <u>Air Dry, Back Fill and Cover</u> Drill pits must be closed within 365 days of spud date.	
I hereby certify that the above statements are true and correct to the best of my knowledge and belief.		
<u>October 16, 2007</u> Date	 Signature of Applicant or Agent	

15-205-27334-0000

KCC OFFICE USE ONLY			
Date Received: <u>10/17/07</u>	Permit Number: _____	Permit Date: <u>10/17/07</u>	Lease Inspection: <input type="checkbox"/> Yes <input checked="" type="checkbox"/> No

Mail to: KCC - Conservation Division, 130 S. Market - Room 2078, Wichita, Kansas 67202