

For KCC Use: Effective Date: 10-23-07 District # 3 SGA? Yes No

KANSAS CORPORATION COMMISSION OIL & GAS CONSERVATION DIVISION

Form C-1 December 2002 Form must be Typed Form must be Signed All blanks must be Filled

NOTICE OF INTENT TO DRILL

Must be approved by KCC five (5) days prior to commencing well

Expected Spud Date October 22, 2007 month day year

OPERATOR: License# 33051 Name: C D OIL, Inc. Address: 3236 Virginia Rd City/State/Zip: Wellsville, Ks. 66092 Contact Person: Carl (Clay) Hughes Phone: 913-963-9127

CONTRACTOR: License# 8509 Name: Evans Energy Development, Inc.

Spot NE SE NW Sec. 1 Twp. 15 S. R. 21 East West 3080 feet from N / S Line of Section 3135 feet from E / W Line of Section Is SECTION Regular Irregular?

Well Drilled For: Oil Gas CWWD Seismic; # of Holes Other Enh Rec Storage Disposal Other Well Class: Infield Pool Ext. Wildcat Other Type Equipment: Mud Rotary Air Rotary Cable

(Note: Locate well on the Section Plat on reverse side) County: Johnson Lease Name: Hunt Well #: 1-2 Field Name: Gardner Is this a Prorated / Spaced Field? Yes No Target Formation(s): Bartlesville Nearest Lease or unit boundary: 440 Ground Surface Elevation: na feet MSL Water well within one-quarter mile: Yes No Public water supply well within one mile: Yes No Depth to bottom of fresh water: 100 Depth to bottom of usable water: 300 Surface Pipe by Alternate: 1 2 Length of Surface Pipe Planned to be set: 20 Length of Conductor Pipe required: none Projected Total Depth: 925 Formation at Total Depth: Bartlesville Water Source for Drilling Operations: Well Farm Pond Other DWR Permit #: (Note: Apply for Permit with DWR) Will Cores be taken? Yes No If Yes, proposed zone:

If OWWO: old well information as follows: Operator: Well Name: Original Completion Date: Original Total Depth: Directional, Deviated or Horizontal wellbore? Yes No If Yes, true vertical depth: Bottom Hole Location: KCC DKT #:

AFFIDAVIT

The undersigned hereby affirms that the drilling, completion and eventual plugging of this well will comply with K.S.A. 55 et. seq. It is agreed that the following minimum requirements will be met:

- 1. Notify the appropriate district office prior to spudding of well;
2. A copy of the approved notice of intent to drill shall be posted on each drilling rig;
3. The minimum amount of surface pipe as specified below shall be set by circulating cement to the top; in all cases surface pipe shall be set through all unconsolidated materials plus a minimum of 20 feet into the underlying formation.
4. If the well is dry hole, an agreement between the operator and the district office on plug length and placement is necessary prior to plugging;
5. The appropriate district office will be notified before well is either plugged or production casing is cemented in;
6. If an ALTERNATE II COMPLETION, production pipe shall be cemented from below any usable water to surface within 120 days of spud date. Or pursuant to Appendix "B" - Eastern Kansas surface casing order #133,891-C, which applies to the KCC District 3 area, alternate II cementing must be completed within 30 days of the spud date or the well shall be plugged. In all cases, NOTIFY district office prior to any cementing.

I hereby certify that the statements made herein are true and to the best of my knowledge and belief.

Date: 10/15/07 Signature of Operator or Agent: Carl C Hughes Title: president

RECEIVED KANSAS CORPORATION COMMISSION OCT 17 2007 CONSERVATION DIVISION WICHITA, KS

For KCC Use ONLY API # 15 - 091-23179-0000 Conductor pipe required None feet Minimum surface pipe required 20 feet per Alt. Approved by: Paul 10-18-07 This authorization expires: 4-18-08 (This authorization void if drilling not started within 6 months of approval date.) Spud date: Agent:

Remember to: - File Drill Pit Application (form CDP-1) with Intent to Drill; - File Completion Form ACO-1 within 120 days of spud date; - File acreage attribution plat according to field proration orders; - Notify appropriate district office 48 hours prior to workover or re-entry; - Submit plugging report (CP-4) after plugging is completed; - Obtain written approval before disposing or injecting salt water. - If this permit has expired (See: authorized expiration date) please check the box below and return to the address below. Well Not Drilled - Permit Expired Signature of Operator or Agent: Date:

Mail to: KCC - Conservation Division, 130 S. Market - Room 2078, Wichita, Kansas 67202

1 15 21E

IN ALL CASES PLOT THE INTENDED WELL ON THE PLAT BELOW

Plat of acreage attributable to a well in a prorated or spaced field

If the intended well is in a prorated or spaced field, please fully complete this side of the form. If the intended well is in a prorated or spaced field complete the plat below showing that the well will be properly located in relationship to other wells producing from the common source of supply. Please show all the wells and within 1 mile of the boundaries of the proposed acreage attribution unit for gas wells and within 1/2 mile of the boundaries of the proposed acreage attribution unit for oil wells.

API No. 15 - 091-23179-0000
Operator: C D OIL, Inc.
Lease: Hunt
Well Number: I-2
Field: Gardner
Number of Acres attributable to well: _____
QTR / QTR / QTR of acreage: SE - SE - NW

Location of Well: County: Johnson
3080 feet from N / S Line of Section
3135 feet from E / W Line of Section
Sec. 1 Twp. 15 S. R. 21 East West

Is Section: Regular or Irregular

If Section is Irregular, locate well from nearest corner boundary.

Section corner used: NE NW SE SW

PLAT

*(Show location of the well and shade attributable acreage for prorated or spaced wells.)
(Show footage to the nearest lease or unit boundary line.)*

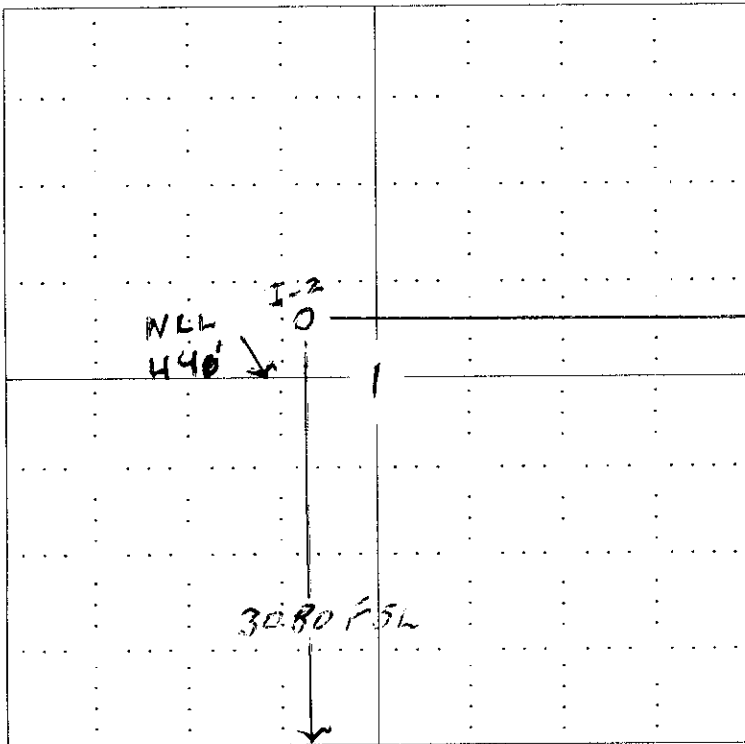

3135 FEL

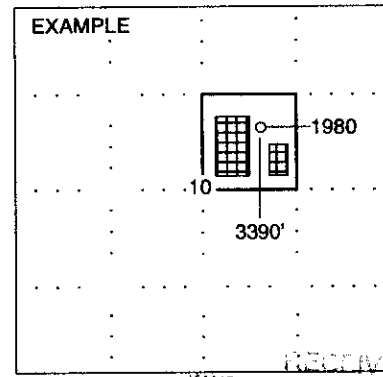

SEWARD CO. KANSAS CORPORATION COMMISSION

NOTE: In all cases locate the spot of the proposed drilling location.

OCT 17 2007

CONSERVATION DIVISION
WICHITA, KS

In plotting the proposed location of the well, you must show:

1. The manner in which you are using the depicted plat by identifying section lines, i.e. 1 section, 1 section with 8 surrounding sections, 4 sections, etc.
2. The distance of the proposed drilling location from the section's south / north and east / west.
3. The distance to the nearest lease or unit boundary line.
4. If proposed location is located within a prorated or spaced field a certificate of acreage attribution plat must be attached: (C0-7 for oil wells; CG-8 for gas wells).

**KANSAS CORPORATION COMMISSION
OIL & GAS CONSERVATION DIVISION
APPLICATION FOR SURFACE PIT**

Form CDP-1
April 2004
Form must be Typed

Submit in Duplicate

Operator Name: C D OIL, Inc.		License Number: 33051
Operator Address: 3236 Virginia Rd Wellsville, Ks. 66092		
Contact Person: Carl (Clay) Hughes		Phone Number: (913) 963 -9127
Lease Name & Well No.: Hunt #1-2		Pit Location (QQQQ): NE SE SE NW
Type of Pit: <input type="checkbox"/> Emergency Pit <input type="checkbox"/> Burn Pit <input type="checkbox"/> Settling Pit <input checked="" type="checkbox"/> Drilling Pit <input type="checkbox"/> Workover Pit <input type="checkbox"/> Haul-Off Pit <small>(If WP Supply API No. or Year Drilled)</small>	Pit is: <input checked="" type="checkbox"/> Proposed <input type="checkbox"/> Existing If Existing, date constructed: _____ Pit capacity: 120 (bbls)	Sec. 1 Twp. 15 R. 21 <input checked="" type="checkbox"/> East <input type="checkbox"/> West 3080 Feet from <input type="checkbox"/> North / <input checked="" type="checkbox"/> South Line of Section 3135 Feet from <input checked="" type="checkbox"/> East / <input type="checkbox"/> West Line of Section Johnson County
Is the pit located in a Sensitive Ground Water Area? <input type="checkbox"/> Yes <input checked="" type="checkbox"/> No		Chloride concentration: _____ mg/l <small>(For Emergency Pits and Settling Pits only)</small>
Is the bottom below ground level? <input checked="" type="checkbox"/> Yes <input type="checkbox"/> No	Artificial Liner? <input type="checkbox"/> Yes <input checked="" type="checkbox"/> No	How is the pit lined if a plastic liner is not used? Native Clay
Pit dimensions (all but working pits): 10 Length (feet) 10 Width (feet) N/A: Steel Pits Depth from ground level to deepest point: 5 (feet)		
If the pit is lined give a brief description of the liner material, thickness and installation procedure.		Describe procedures for periodic maintenance and determining liner integrity, including any special monitoring.
Distance to nearest water well within one-mile of pit 854 feet Depth of water well 178 feet		Depth to shallowest fresh water 10 feet. Source of information: _____ measured _____ well owner _____ electric log <input checked="" type="checkbox"/> KDWR
Emergency, Settling and Burn Pits ONLY: Producing Formation: _____ Number of producing wells on lease: _____ Barrels of fluid produced daily: _____ Does the slope from the tank battery allow all spilled fluids to flow into the pit? <input type="checkbox"/> Yes <input type="checkbox"/> No		Drilling, Workover and Haul-Off Pits ONLY: Type of material utilized in drilling/workover: drilling mud Number of working pits to be utilized: 2 Abandonment procedure: air dry and backfill Drill pits must be closed within 365 days of spud date
I hereby certify that the above statements are true and correct to the best of my knowledge and belief.		RECEIVED KANSAS CORPORATION COMMISSION
<u>10/17/07</u> Date	<u>Carl C. Hughes</u> Signature of Applicant or Agent	OCT 17 2007

15-091-23179-0000

KCC OFFICE USE ONLY		
Date Received: <u>10/17/07</u>	Permit Number: _____	Permit Date: <u>10/17/07</u> Lease Inspection: <input type="checkbox"/> Yes <input checked="" type="checkbox"/> No

Mail to: KCC - Conservation Division, 130 S. Market - Room 2078, Wichita, Kansas 67202